

VI45G

FEATURES

Heavy-duty stainless steel

Powerful blower options

Four LED lights with two brightness settings

Dishwasher-safe filters

Front-mounted electronic controls

Telescoping chimney reaches standard ceiling heights

Rigorously tested in our U.S. manufacturing facilities for decades of use

Exceptional 24/7 support from our Customer Care team in Madison

ACCESSORIES

600 CFM In-Line Blower

Chimney Extension - accommodates most 10' ceilings

Make-up air damper

Recirculating kit and filter for non-ducted applications

Recirculating Filter

Remote Control

Accessories available through an authorized Sub-Zero dealer.
For local dealer information, visit subzero-wolf.com/locator.



BLOWER OPTIONS

- 300 CFM Internal
- 600 CFM Internal
- 600 CFM Inline
- 600 CFM Remote

PRODUCT SPECIFICATIONS

| | |
|------------------------------|---------------------------|
| Model | VI45G |
| Dimensions | 45"W x 2 1/4"H x 26 1/2"D |
| Weight | 92 lb |
| Electrical Supply | 110/120 VAC, 60 Hz |
| Electrical Service | 15 amp dedicated circuit |
| Discharge Location | Vertical |
| Discharge Dimensions | 6" Round |
| Bottom of Hood to Countertop | 24" to 36" |
| Receptacle | 3-prong grounding-type |

ELECTRICAL

TOP VIEW

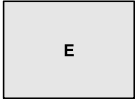

LOCATE ELECTRICAL SUPPLY
ON CEILING
INSIDE TOP OF HOOD

DIMENSIONS

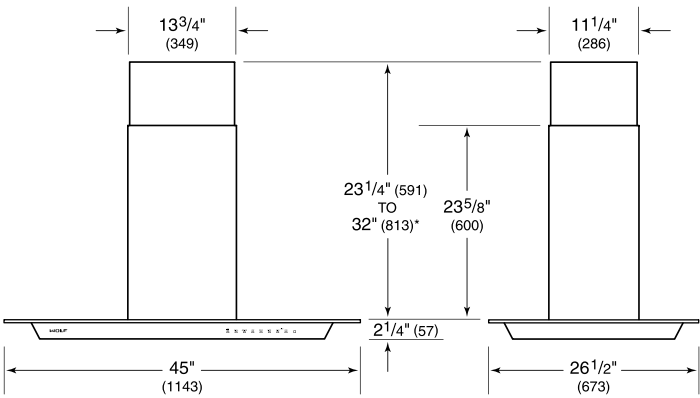

*46 1/4" (1175) to 55" (1397) with accessory flue extension.