

24" Marvel Professional Beverage Center with 3-in-1 Convertible Shelves and Display Wine Rack

Model #MP24BC****

- Dynamic Cooling Technology™ delivers rapid cool down and the industry's best temperature stability
- Thermal-efficient cabinet ensures optimum food preservation and energy efficiency while maximizing capacity
- Even quieter operation thanks to proprietary design enhancements to buffer and minimize sound
- With over 10 functions, MARVEL Intuit™ Integrated Controls allow you to select a precise cabinet temperature from 34°F to 42°F
- Audible and visual alarms signal when door is left ajar to protect food integrity and energy use
- Vacation/Sabbath mode conserves energy during times when the unit is not in use and complies with Star-K requirements
- Control Lockout prevents unintentional changes to settings
- System Indicator continuously monitors the unit
- Sleep/Wake Mode shuts off control display to conserve energy
- 3-in-1 Slide-Out Convertible Shelf™ features removable glass pane with wine rack option to store beverages, food or wine
- Cantilevered, fully adjustable shelving system
- Display wine rack glides out for easy access and holds 5 wine bottles, including magnum sizes
- Tinted, UV-resistant dual pane glass door protects wine from damaging ultra-violet light
- Professional styling: framed stainless steel door, sturdy full-length handle, sleek stainless steel shelf fronts and 4" stainless steel toe kick
- Soft-close integrated hinge provides zero clearance fit for a perfectly seamless built-in installation
- Two-stage, soft blue theatre-style LED lighting and sophisticated midnight black interior
- Optional panel-ready model blends seamlessly into cabinetry—no complicated kits or additional parts required
- Close Door Assist System™ gently and automatically draws door to a close, ensuring door is never left ajar

Door lock to protect your contents

Height adjustment up to 1" with leveling legs

4" black adjustable

Ordering Details	
Stainless Frame, Glass Door With Lock, Integrated Right Hinge	MP24BCG3RS
Stainless Frame, Glass Door With Lock, Integrated Left Hinge	MP24BCG3LS
Panel Overlay Frame Ready Glass Door with lock, Integrated Right Hinge	MP24BCF3RP
Panel Overlay Frame Ready Glass Door with lock, Integrated Left Hinge	MP24BCF3LP

No panel installation kit required.



Storage Capacity

Up to 19 wine bottles total (7 flat)

Up to (108) 12-oz cans

Storage Configuration

(1) 5-bottle gallery roller-glide display wine racks

(2) full-width cantilevered, fully adjustable coated steel-framed glass shelf

Product Dimensions

23⁷/₈" W x 33³/₄" minimum H x 25 ⁵/₈" D (including handle)

Finish/Door Options



Stainless Steel

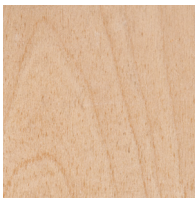

Wood Overlay
(Panel Ready)

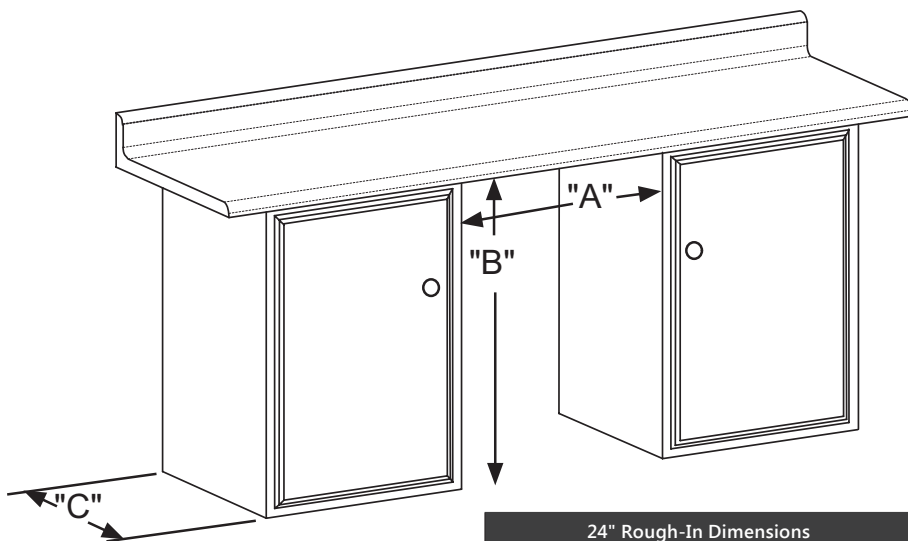

24" Rough-In Dimensions		
"A"	"B"	"C"
24" (61 cm)	34" to 35" (86.4 cm to 88.9 cm)	24" (61 cm)

Cabinet Dimensions		
"D"	"E"	"F"
23 7/8" (60.7 cm)	33 3/4" to 34 3/4" (85.7 to 88.3 cm)	23 23/32" (60.2 cm)
"G"	"H"	"J"
26 7/32" (66.6 cm)	461 3/32" (117.9 cm)	26 7/16" (67.2 cm)

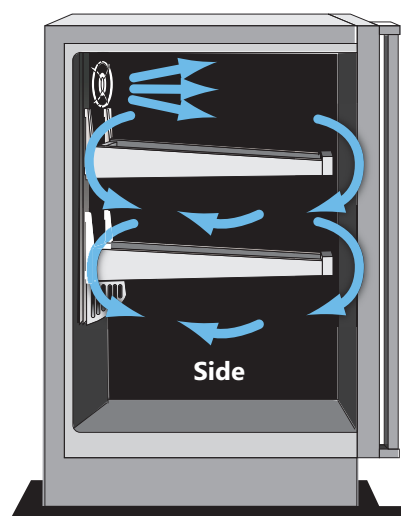
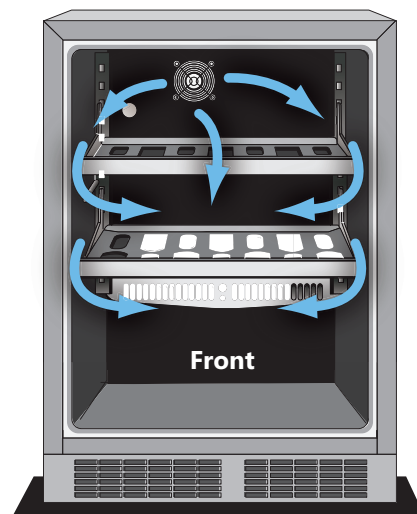
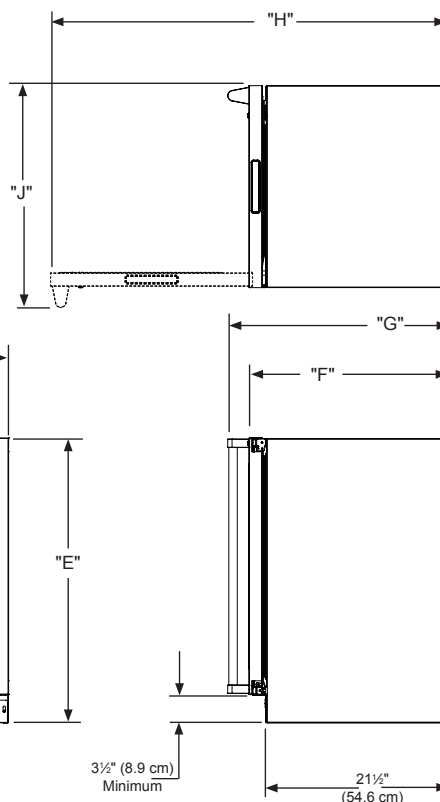

Dynamic Cooling Technology™ delivers rapid cool down and the industry's best temperature stability

The distinctive Marvel design features a thermal-efficient cabinet and door combined with Dynamic Cooling Technology™ for superior temperature stability, faster cooling times and speedy temperature recovery even with high frequency.

Width	23 7/8"
Interior Finish	Black
Capacity	Up to 19 wine bottles Up to 108 12-oz cans
Shelving System	Side Mount Bottle shape wire
Shelf Fronts	Stainless Steel
Other Storage	Display Wine Rack
Interior Lighting	2 LED Pods
Toe Grill Finish	Stainless Steel
Hinge	Soft Close Integrated Hinge
Handle	Professional

Control Type	Intuit™
Temperature Range	34° - 42° F
Lock	Yes
Electrical Requirements	120V / 60Hz / 15A
Length of Power Cord	5'
Product Dimensions	23 7/8" W x 33 3/4" H x 21 1/2" D
Depth to Front of Door	23 23/32"
Depth to Handle	26 7/32"
Depth with door at 90°	46 13/32"
Shipping Weight	160 lbs

Finishes	SS, O
Vacation / Sabbath Mode	Yes
Agency Approvals	CSA

Finishes Key

SS = Stainless Steel
O = Overlay

Overlay Panels

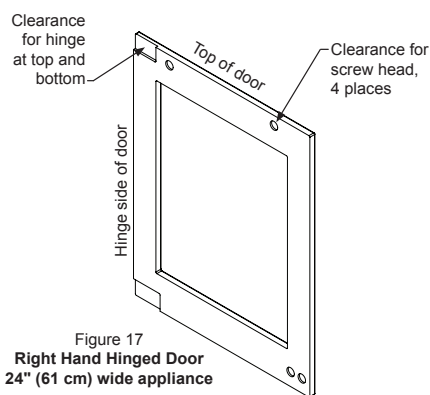

Figure 17
Right Hand Hinged Door
24" (61 cm) wide appliance

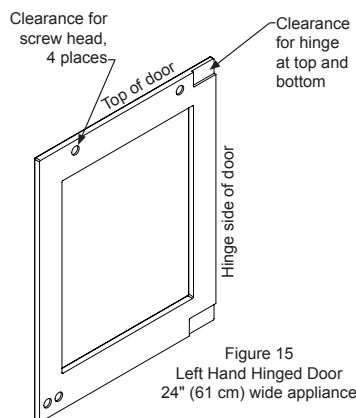

Figure 15
Left Hand Hinged Door
24" (61 cm) wide appliance

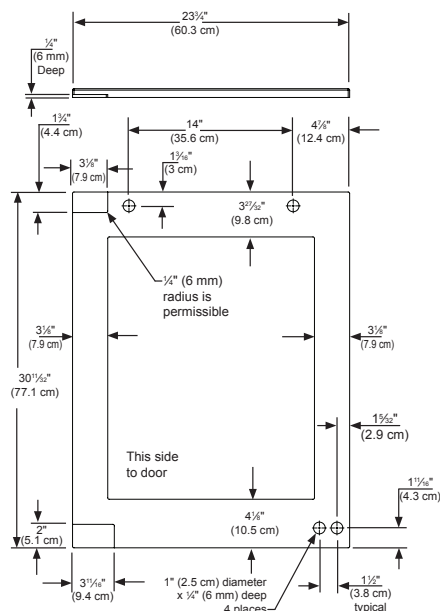

Figure 18
Right Hand Hinged Door
24" (61 cm) wide appliance

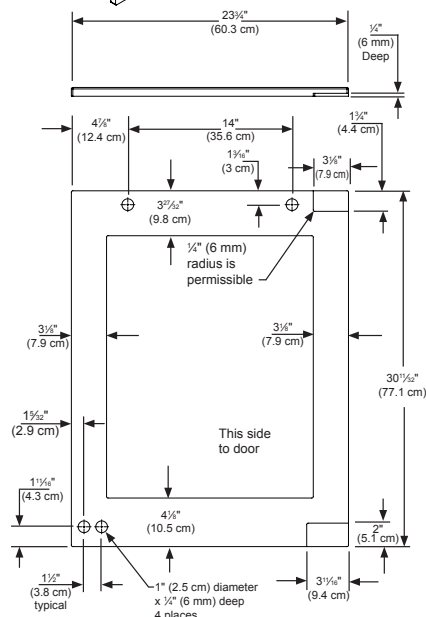

Figure 16
Left Hand Hinged Door
24" (61 cm) wide appliance

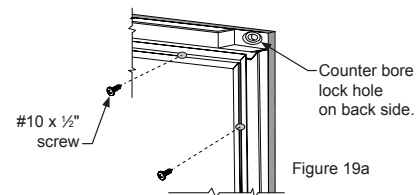

Figure 19a

Material Type	#10 Wood Screw
Hardwood	½" (3.2 mm) Diameter. Pilot Hole
Softwood	⅞" (2.8 mm) Diameter. Pilot Hole

Table C

The preferred method of attaching the panel to the door is to clamp the panel to the door so it cannot move while drilling the screw pilot holes. Use bar clamps or "C" clamps with pads on the clamping surfaces that will not mar the panel or the door. The custom overlay panel should be flush with the top of the door and centered along the width of the door. See Figure 10a. Drill holes through the gasket extrusion using the 10 holes as pilot holes. Use the drill size from the chart in Table "C", being careful not to drill through the front surface of the panel, drill no deeper than 1/2" (12.7 mm) deep. If the overlay panel is thinner than 3/8" (16 mm) thick shorter screws will have to be obtained. Fasten the panel to the door with the 10 screws provided in the literature pack. (See Figure 19a). Remove the clamps and replace the gasket in the gasket extrusion channels of the door. Some force may be required to seat the gasket into the channels. Be sure the gasket corners are seated properly.

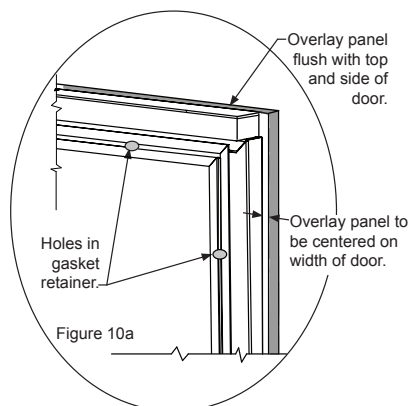

Figure 10a

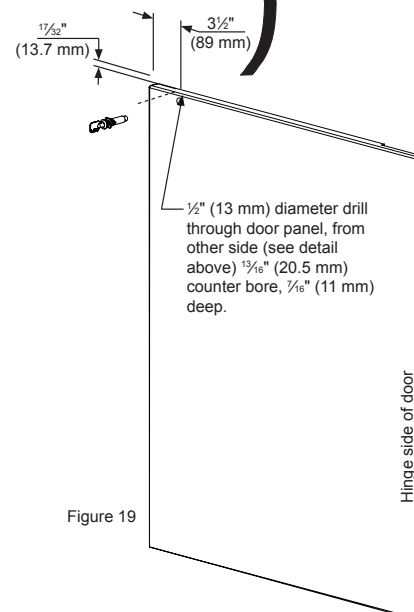

Figure 19

For comprehensive installation instructions,
please visit www.marvelrefrigeration.com