



VENT HOOD

For Outdoor Use
36-VH, 42-VH and 60-VH series

INSTALLATION INSTRUCTIONS AND OWNER'S MANUAL



42-VH-3 model shown

INSTALLER: Leave these instructions with consumer.
CONSUMER: Retain for future reference.

Important: READ THESE INSTRUCTIONS CAREFULLY BEFORE STARTING INSTALLATION OR USE.

WARNINGS AND SAFETY CODES

⚠ DANGER:

IF YOU SMELL GAS:

1. Shut off the gas to the grill this vent hood is installed above.
2. Extinguish any open flame.
3. Open the lid of the grill.
4. If odor continues, keep away from the appliances and **immediately** call your gas supplier or the fire department.

⚠ CAUTION:

IF YOU SMELL GAS:

- For General Ventilating Use Only. Do Not Use To Exhaust Hazardous Or Explosive Materials And Vapors!
- This vent hood is for wall mount installation only.
- Observe all local codes and ordinances when installing this appliance. If no local codes are applicable, wire unit in accordance with the latest National Electrical Code, ANSI/NFPA 70, or the Canadian Electrical Code, CSA C22.1, whichever is applicable.

⚠ WARNING:

To avoid the risk of property damage and/or personal injury, installation work and electrical wiring must be performed by a qualified professional installer. This appliance must be installed in accordance with this instruction.

⚠ WARNING:

1. Do not store or use gasoline or other flammable vapors and liquids in the vicinity of the gas grill this vent hood is installed above, or any other appliance.
2. An LP cylinder not connected for use shall not be stored in the vicinity of the gas grill this vent hood is installed above, or any other appliance.

⚠ WARNING:

Improper installation, adjustment, alteration, service, or maintenance can cause injury or property damage. For proper installation, refer to the installation instructions. For assistance or additional information, consult a qualified professional installer or service agency.

All electrical outlets in the vicinity of the grill and vent hood must be properly grounded in accordance with local codes, or, in the absence of local codes, with the *National Electrical Code, ANSI/NFPA 70*, or the *Canadian Electrical Code, CSA C22.1*, whichever is applicable.

Keep all electrical-supply cords and fuel-supply hoses away from any heated surface.



Certified to: **ANSI Z21.58a-2008**
CSA 1.6a-2008



**INSTRUCTIONS D'INSTALLATION ET
MANUEL DU PROPRIÉTAIRE**

VENT HOOD
Pour l'usage extérieur
36-VH, 42-VH and 60-VH série

INSTALLATEUR: Laissez ces instructions avec le consommateur.
CONSOMMATEUR: Maintenez pour la future référence.

IMPORTANT: LISEZ CES INSTRUCTIONS SOIGNEUSEMENT AVANT DE COMMENCER L'INSTALLATION OU L'UTILISATION

AVERTISSEMENTS ET CODES DE SÛRETÉ

⚠ DANGER:
SI VOUS SENTEZ LE GAZ:

1. Coupez le gaz au gril que ce capot de passage est installé ci-dessus.
2. Éteignez-vous n'importe quelle flamme nue.
3. Ouvrez le couvercle du gril.
4. Si l'odeur continue, gardez à partir des appareils et appelez immédiatement votre fournisseur de gaz ou les corps de sapeurs-pompier ou the fire department.

⚠ AVERTISSEMENT:

1. Ne stockez pas ou employer l'essence ou d'autres vapeurs et liquides inflammables à proximité du gaz grillez ce capot de passage est installé ci-dessus, ou n'importe quel autre appareil.
2. Un cylindre de LP non relié pour l'usage ne sera stocké à proximité du gril de gaz que ce capot de passage est installé ci-dessus, ou d'aucun autre appareil.

⚠ ATTENTION:

- Pour l'usage de aération général seulement. N'employez pas pour épuiser les matériaux dangereux ou explosifs et les vapeurs!
- Ce capot de passage est pour l'installation de bâti de mur seulement.
- Observez tous les codes locaux et ordonnances en installant cet appareil. Si aucun code local ne s'applique, unité de fil selon le plus défunt code électrique national, ANSI/NFPA 70, ou le code électrique canadien, CSA C22.1, celui qui s'applique.

⚠ AVERTISSEMENT:
L'installation, l'ajustement, le changement, le service, ou l'entretien inexact peuvent causer des dommages ou des dégâts matériels. Pour l'installation appropriée, référez-vous aux instructions d'installation. Pour l'aide ou les informations supplémentaires, consultez un installateur ou une agence de service professionnel qualifié.

⚠ AVERTISSEMENT:
Pour éviter le risque de dégâts matériels et/ou de dommage corporel, le travail d'installation et le câblage électrique doivent être exécutés par un installateur professionnel qualifié. Cet appareil doit être installé selon cette instruction.

Toutes les sorties électriques à proximité du capot de gril et de passage doivent être correctement fondues selon des codes locaux, ou, en l'absence des codes locaux, avec le code électrique national, ANSI/NFPA 70, ou le code électrique canadien, CSA C22.1, celui qui s'applique.

Maintenez tout électrique-fournissent des cordes et carburant-fournissent des tuyaux à partir de n'importe quelle surface heated.



**Certified to: ANSI Z21.58a-2008
CSA 1.6a-2008**

CONTENTS

5	IMPORTANT PRE-INSTALLATION AND SAFETY INFORMATION
6	STANDARD REPLACEMENT PARTS LIST
7	SOLAR REPLACEMENT PARTS LIST
8	SPECIFICATIONS
9	INSTALLATION REQUIREMENTS
10	SPACER & SOFFIT
10	TRANSITION
10	INSTALLATION
11	VENT HOOD
12	ELECTRICAL
13	FAN BOX
13	WIRING CONNECTIONS
14	BAFFLE
14	GREASE FILTERS
14	VENT PIPING
14	CONNECT POWER
14	FINISH SOFFIT
15	VENT HOOD FAN
15	GRILL TOP LIGHTING
15	OPERATION
17	STAINLESS STEEL CARE
17	GREASE FILTERS
17	FANS
17	REPLACING LIGHTS
17	SERVICING AND CLEANING
18	REPLACING BATTERIES/FUSE (SOLAR ONLY)
18	SOLAR PANEL (IF EQUIPPED)
19	TROUBLESHOOTING
20	WARRANTY



AVERTISSEMENT!

1. **Lisez toutes les instructions.**
2. Le capot de passage, et le gril de gaz il doit être installé ci-dessus, n'est pas prévu pour être installé dans ou sur des bateaux ou des camping-cars.
3. Pour se protéger contre la décharge électrique, n'immergez pas la corde ou ne branchez pas l'eau ou tout autre liquide.
4. Débranchez de la sortie si non utilisable et avant le nettoyage. Laissez se refroidir avant de mettre dessus ou enlever des pièces.
5. N'actionnez aucun appareil avec une corde endommagée, prise, ou après les défauts de fonctionnement d'appareils ou avez été endommagé de toute façon. Entrez en contact avec le fabricant pour la réparation.
6. Ne laissez pas la corde toucher les surfaces chaudes.
7. N'employez pas un appareil à gaz à cuire extérieur pour des buts autres que prévu.
8. En se reliant, reliez d'abord la prise à l'appareil à gaz à cuire extérieur branchent alors l'appareil à la sortie.
9. Cet appareil doit être fondu. En cas d'un court-circuit électrique, fondre réduit le risque de décharge électrique en fournissant un fil d'évasion pour le courant électrique. Cet appareil équipé avec une corde ayant un fil fondé avec une prise fondante. La prise doit être branchée à une sortie qui est correctement installée et fondue.
10. Utilisez seulement un circuit protégé au sol de l'interrupteur de défaut (GFI) avec cet appareil à gaz à cuire extérieur.
11. N'enlevez jamais la prise fondante ou l'employez avec un adaptateur de 2 fourches.
12. N'employez pas une corde de prolongation. Si la corde d'alimentation d'énergie est trop courte, faites installer à un électricien qualifié une sortie près de l'appareil.
13. Quand la coupure ou le forage dans un mur ou un plafond, n'endommagent pas le câblage électrique et d'autres utilités cachées.
14. Des ventilateurs canalisés doivent toujours être exhalés à l'extérieur.
15. **AVERTISSEMENT** : Pour réduire le risque du feu, employez seulement la canalisation en métal.
16. **AVERTISSEMENT** : Pour réduire le risque d'un dessus de gamme graissez le feu:
 - a. Ne laissez jamais les unités extérieures sans surveillance aux arrangements élevés. Tabagisme de cause de Boilovers et débordements graisseux qui peuvent mettre à feu. Chauffez les huiles lentement sur de bas ou moyens arrangements.
 - b. Tournez toujours le capot SUR en faisant cuire à la chaleur élevée ou en faisant cuire aux nourritures flamboyantes.
 - c. Nettoyez les ventilateurs d'aération fréquemment. On ne devrait pas permettre à la graisse de s'accumuler sur le ventilateur ou le filtre.
 - d. Employez la taille appropriée de casserole. Employez toujours le cookware approprié pour la taille de la surface à cuire.

SAUF CES INSTRUCTIONS



WARNING!

1. **Read all instructions.**
2. The vent hood, and the gas grill it is to be installed above, are not intended to be installed in or on boats or recreational vehicles.
3. To protect against electric shock, do not immerse cord or plugs in water or other liquid.
4. Unplug from the outlet when not in use and before cleaning. Allow to cool before putting on or taking off parts.
5. Do not operate any appliance with a damaged cord, plug, or after the appliance malfunctions or has been damaged in any manner. Contact the manufacturer for repair.
6. Do not let the cord touch hot surfaces.
7. Do not use an outdoor cooking gas appliance for purposes other than intended.
8. When connecting, first connect plug to the outdoor cooking gas appliance then plug appliance into the outlet.
9. This appliance must be grounded. In the event of an electrical short circuit, grounding reduces the risk of electric shock by providing an escape wire for the electric current. This appliance is equipped with a cord having a grounded wire with a grounding plug. The plug must be plugged into an outlet that is properly installed and grounded.
10. Use only a Ground Fault Interrupter (GFI) protected circuit with an outdoor cooking gas appliance.
11. Never remove the grounding plug or use with an adapter of 2 prongs.
12. Do not use an extension cord. If the power supply cord is too short, have a qualified electrician install an outlet near the appliance.
13. When cutting or drilling into a wall or ceiling, do not damage electrical wiring and other hidden utilities.
14. Ducted fans must always be vented to the outdoors.
15. **WARNING:** To reduce the risk of fire, use only metal ductwork.
16. **WARNING:** To reduce the risk of a range top grease fire:
 - a. Never leave surface units unattended at high settings. Boilovers cause smoking and greasy spillovers that may ignite. Heat oils slowly on low or medium settings.
 - b. Always turn hood ON when cooking at high heat or when cooking flaming foods.
 - c. Clean ventilating fans frequently. Grease should not be allowed to accumulate on fan or filter.
 - d. Use proper pan size. Always use cookware appropriate for the size of the cooking surface.

SAVE THESE INSTRUCTIONS

STANDARD REPLACEMENT PARTS LIST

Item	Description	36-VH-(3,4)		42-VH-3		60-VH-3	
		Part No.	Qty.	Part No.	Qty.	Part No.	Qty.
1.	Transition	VH-11	1	VH-11	1	VH-11	1
2.	Wall mount bracket	VH-17	1	VH-19	1	VH-21	1
3.	Complete vent hood assembly	VH-36-01	1	VH-42-01	1	VH-60-01	1
4.	Light assembly (not shown)	VH-12	2	VH-12	2	VH-12	3
5.	Switch assembly	VH-13	2	VH-13	2	VH-13	2
6.	Complete fan box assy. (36-VH-3)	VHF-1400	1	VHF-1400	1	VHF-1400	1
or	Complete fan box assy. (36-VH-4)	VHF-1000	1	n/a	n/a	n/a	n/a
7.	Fan assembly	VH-14	1	VH-14	1	VH-14	1
8.	Power supply assembly	VH-15	1	VH-15	1	VH-15	1
9.	Baffle	VH-36-02	1	VH-42-02	1	VH-60-02	1
10.	Grease filter	VH-16	4	VH-18	4	VH-18	6
11.	Filter spacer (42" models only)	n/a	n/a	VH-42-03	2	n/a	n/a

Replacement parts can be ordered from your local Fire Magic® dealer.

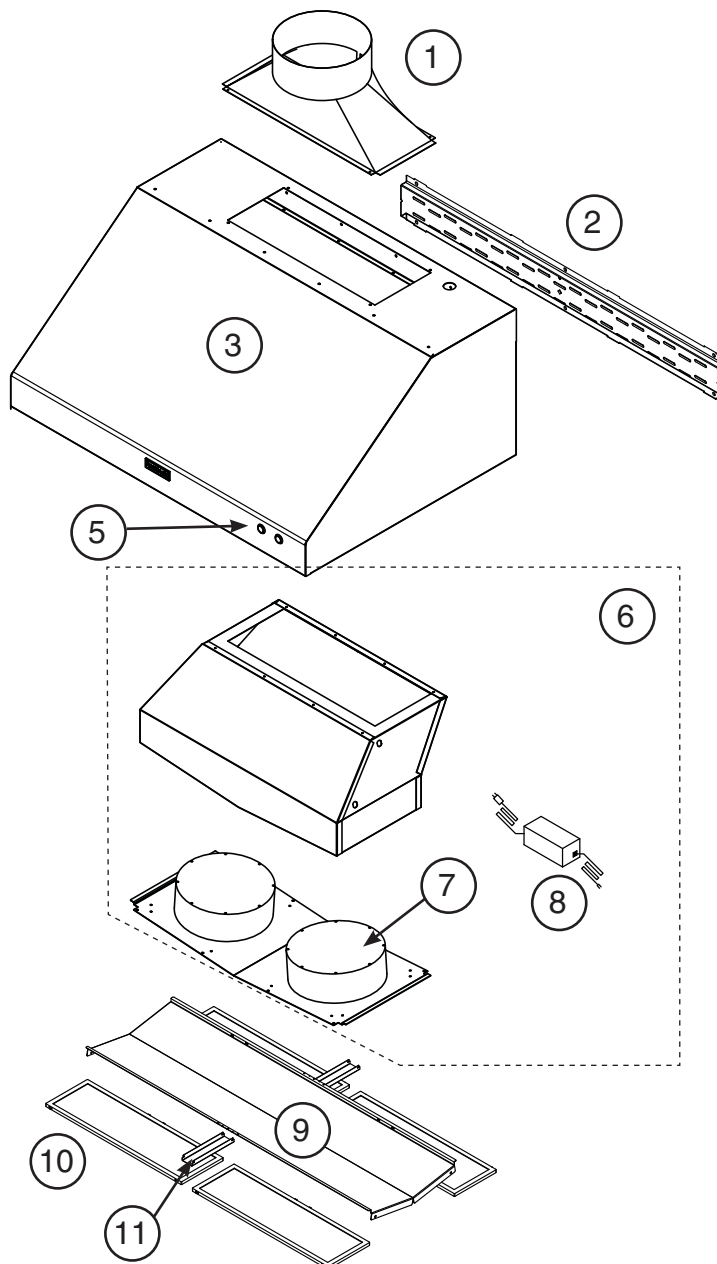

42-VH-3 model shown

IMPORTANT

Remove all packing material (including any protective coatings) and discard prior to use.

SOLAR REPLACEMENT PARTS LIST

Item	Description	42-VH-3-S		60-VH-3-S	
		Part No.	Qty.	Part No.	Qty.
1.	Transition (offset)	VH-11	1	VH-11	1
2.	Wall mount bracket	VH-19	1	VH-21	1
3.	Complete vent hood assembly	VH-42-01	1	VH-60-01	1
4.	Light assembly (not shown)	VH-12	2	VH-12	3
5.	Switch assembly	VH-13	2	VH-13	2
6.	Complete fan box assembly	VHF-1400-S	1	VHF-1400-S	1
7.	Fan assembly	VH-14	1	VH-14	1
8.	Battery charger assembly	VH-16	1	VH-16	1
9.	Battery	VH-17	2	VH-17	2
10.	Baffle	VH-42-02	1	VH-60-02	1
11.	Grease filter	VH-18	4	VH-18	6
12.	Filter spacer (42" models only)	VH-42-03	2	n/a	n/a
13.	Solar panel assy	VH-19	1	VH-19	1

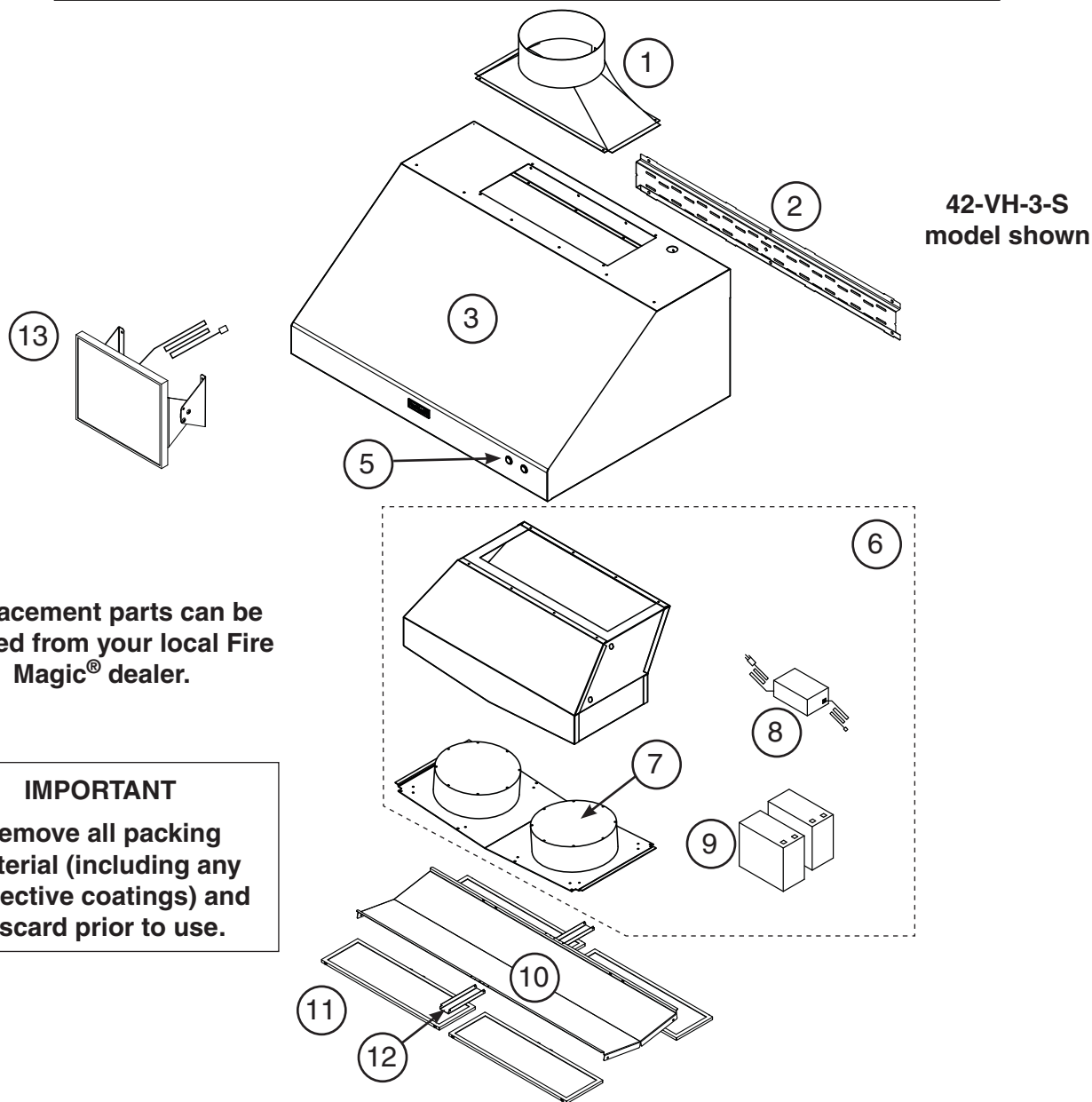

Replacement parts can be ordered from your local Fire Magic® dealer.

IMPORTANT

Remove all packing material (including any protective coatings) and discard prior to use.

SPECIFICATIONS

Specification	36-VH series Value	42-VH series Value	60-VH series Value
Unit height *	18"	18"	18"
Unit width	36"	42"	60"
Unit depth	30"	30"	30"

* Height is of vent hood only (not accounting for transition).

Specification	Value
Electrical requirements	110 volts, 60 hertz, 20 amp; GFI outlet.
Fans	12 VDC, 1400 CFM (1000 CFM for select 36" models)
Power supply †	12 VDC, 60 watts
Battery Charger ‡	12 VDC, 5 amps
Solar Battery ‡	12 V
Solar Panel ‡	10 watts (panel dimensions: 11 7/8 h x 13 7/8 w)

† Standard models only

‡ Solar models only

Table 1 - Specifications Table

INSTALLATION REQUIREMENTS

Below is a diagram of a generic installation. (This install assumes an 8 foot ceiling or higher.)

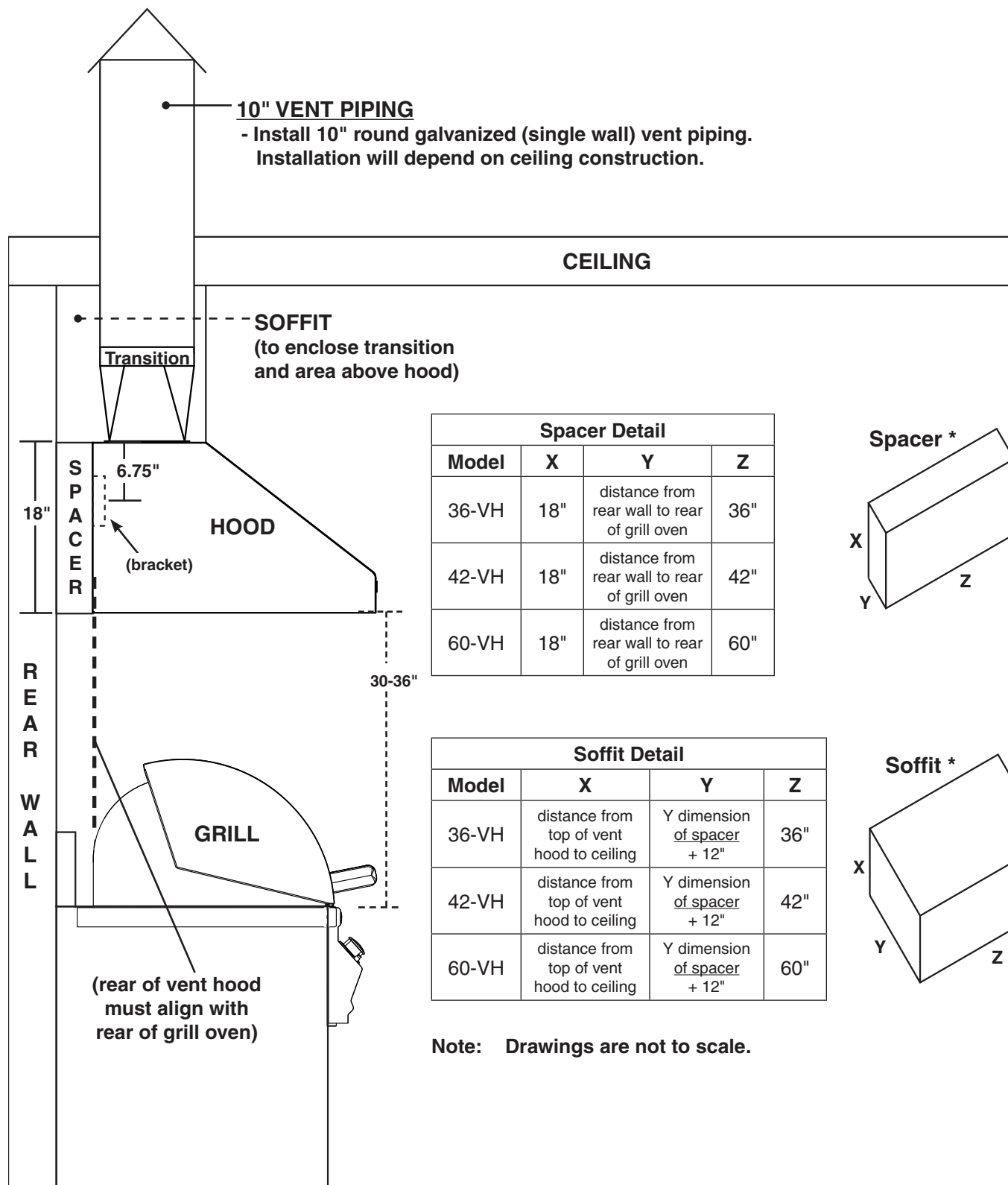

Spacer Detail			
Model	X	Y	Z
36-VH	18"	distance from rear wall to rear of grill oven	36"
42-VH	18"	distance from rear wall to rear of grill oven	42"
60-VH	18"	distance from rear wall to rear of grill oven	60"

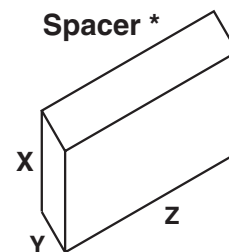

Soffit Detail			
Model	X	Y	Z
36-VH	distance from top of vent hood to ceiling	Y dimension of spacer + 12"	36"
42-VH	distance from top of vent hood to ceiling	Y dimension of spacer + 12"	42"
60-VH	distance from top of vent hood to ceiling	Y dimension of spacer + 12"	60"

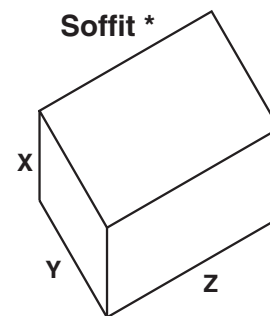

Note: Drawings are not to scale.

* Spacer/soffit may be constructed of wood, metal framing, etc. Upon install completion; the exposed sides of the spacer/soffit may be finished with drywall or other appropriate materials. Dimensions provided here include any finishing substrate. The front of the spacer (that is exposed to the rear of the vent hood); must include a solid wall to allow for the vent hood to be properly secured into it. The soffit must allow permanent interior access (i.e. access panel/door).

**REFER TO INSTALLATION SECTION FOR COMPLETE DETAILS
REGARDING ALL INFORMATION FOUND ON THIS PAGE.**

INSTALLATION

To ensure safety and proper performance; the vent hood installation must be done by a qualified professional. Reference the INSTALLATION REQUIREMENTS section during the course of the install for dimensions and overall orientation.

If possible, the grill should be removed for ease of installation and to prevent damage to the grill.

SPACER & SOFFIT

Construct the spacer and soffit frame according to your individual install preference, while following the guidelines found in the INSTALLATION REQUIREMENTS section. The front of the spacer (that is exposed to the rear of the vent hood); must include a solid wall to allow for the vent hood to be properly secured into it. When designing the spacer and soffit; account for the thickness of your finishing substrate so that overall dimensions are flush with the vent hood.

1. Locate and mark the rear wall studs.
2. Using appropriate mounting hardware for the spacer and rear wall construction; secure it into the rear wall. **The spacer should be installed 30-36" above the grill, centered, and level.**
3. Using appropriate mounting hardware for the soffit and rear wall construction; secure it into the rear wall. The soffit will rest directly above spacer.

Important: THE SPACER AND SOFFIT MUST BE SECURED INTO MULTIPLE WALL STUDS, USING THE APPROPRIATE HARDWARE, TO ENSURE PROPER SUPPORT. METAL FRAMEWORK WILL REQUIRE ADDITIONAL WALL STUDS AND SCREWS FOR PROPER SUPPORT. CONSULT A PROFESSIONAL CONTRACTOR FOR YOUR INDIVIDUAL SETUP.

4. Install finishing substrate to left and right sides, and bottom of spacer as appropriate.

DO NOT FINISH SOFFIT AT THIS POINT, TO ALLOW FOR ADDITIONAL INSTALLATION STEPS.

TRANSITION

1. Rest the vent hood on its rear panel.
2. Apply a bead of silicone along the bottom of the mounting flange of the transition before installation.
3. Position the transition in place and secure using the provided screws. Reach into and fasten the screws from inside the vent hood. (An additional person should hold the transition in place while it is being fastened from inside.) See Fig. 10-2.

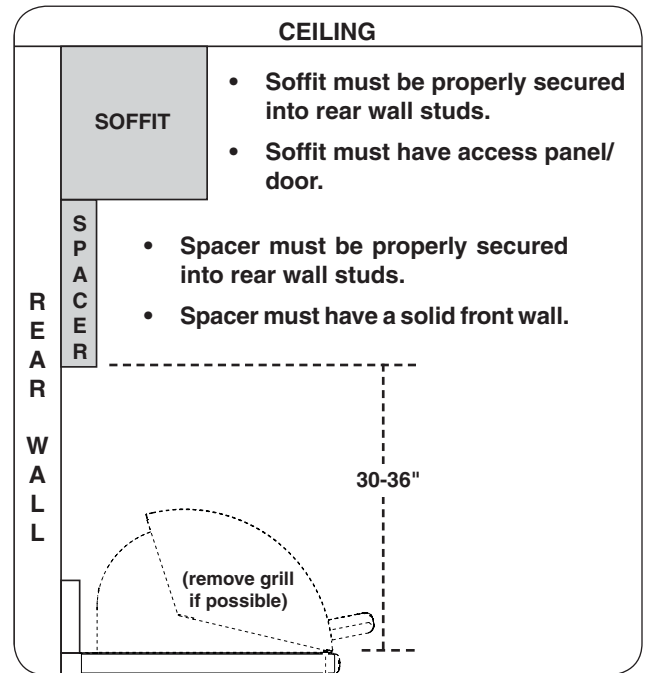

Fig. 10-1

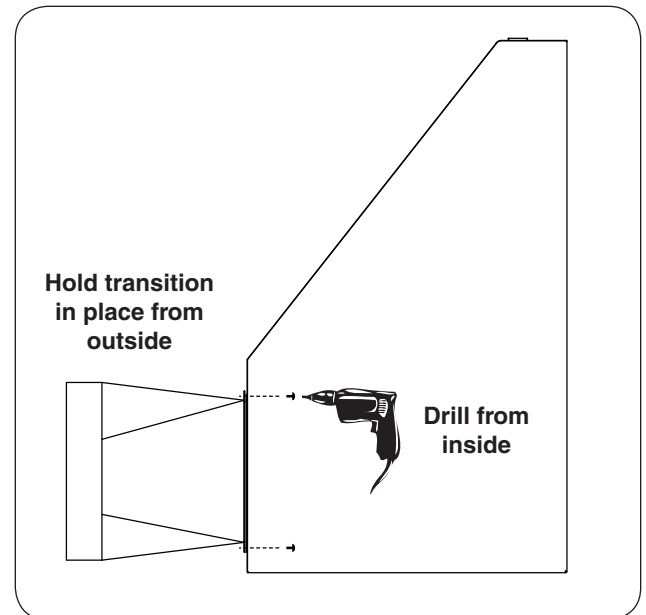

Fig. 10-2

VENT HOOD

The wall mount bracket must be installed into the spacer to assist in supporting the vent hood. The bracket should be centered from left to right on the spacer. The vertical (center) position of the bracket must be 6.75 inches down from the top of the vent hood/spacer. Alignment notches are provided on the top, bottom, center, and sides of the bracket to aid in proper location and leveling.

1. Locate the (left to right) center of the spacer and pencil a vertical line. Pencil a horizontal line 6.75" down from the top of the spacer (see Fig. 11-1).
2. Place the bracket over the two lines. Use the alignment notches in the top, bottom, center, and sides of the bracket to properly locate and assist in leveling.
3. Using appropriate mounting hardware for the spacer construction; secure the bracket into the spacer (see Fig. 11-1).

Important: The bracket must be secured into the spacer studs to ensure proper support. A minimum of 4 screws with fender washers must be evenly distributed and fastened into two studs. Additional screws will be required across the bracket into the spacer wall, for complete support.

4. Rest the vent hood onto the bracket, being sure the hood properly rests on the tabs found on the bracket. See Fig. 11-1. Ensure the sides and bottom of the vent hood sit flush with the spacer (see Fig. 11-2). (The spacer will already be finished with any applicable substrate, to allow for the vent hood to rest flush.)

Note: Be sure the transition clears the soffit when placing.

5. From the inside of the vent hood; fasten the hood to the bracket using the provided screws (see Fig.11-2, Detail A).
6. From the inside of the vent hood, using appropriate mounting hardware for the spacer construction; secure the top portion of the hood directly into the spacer. Use the provided support plates when fastening, see Fig. 11-2, Detail B.

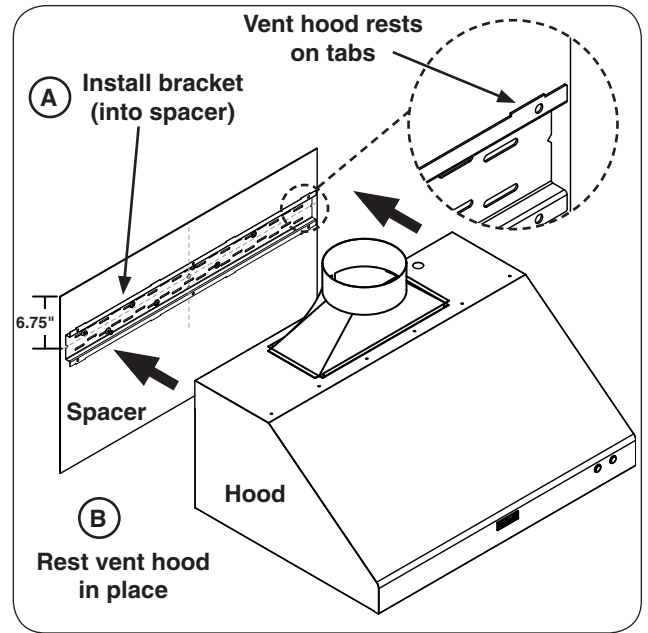

Fig. 11-1

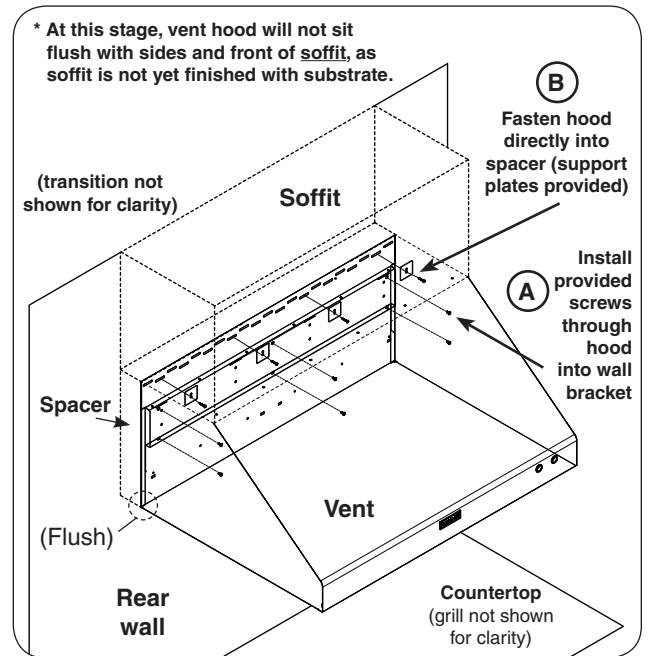

Fig. 11-2 (42" shown)

ELECTRICAL

Both standard models and solar models will require electrical work. The standard model consists of a power supply. The solar model consists of a battery charger. Either selection will need a dedicated GFI receptacle installed near the vent hood to allow for the power supply / battery charger to be plugged into. The area above the vent hood that the soffit will enclose is an ideal location.

1. Install GFI receptacle accordingly.
2. Mount power supply / battery charger to rear wall or to soffit frame.
3. Run the power supply / battery charger cord down into the vent hood, through the hole found in the vent hood top panel. See Fig. 12-1. (Do Not plug power supply / battery charger into GFI receptacle yet.)

For solar models, proceed to steps 4-7 for solar panel detail. For standard models, move on to the FAN BOX section.

4. The ideal location to install the solar panel is the rooftop, above the vent hood. Choose the install location according to your individual setup; being sure that the cord is in range to run down into the soffit area, and continue down into the vent hood where it will later be connected to the fan box. The cord is 25 feet long. Reference Fig. 12-2 for an example.
5. Use the solar panel bracket as a template to mark and drill 4 pilot holes into the rooftop. Realign the solar panel and fasten it to the rooftop using 1/4" bolts, and seal with silicone to prevent leaks.

Note: Orient the solar panel so that it receives the most possible sunlight throughout the day. It is recommended to direct the solar panel toward the south.

6. Set the solar panel to the desired angle. Use a Phillips screwdriver and a 7/16" wrench to tighten. See Fig. 12-3.
7. Run the solar panel cord into the soffit area as applicable to your individual setup. (Seal any hole with silicone made in the rooftop or side wall for the cord, if applicable.) Feed the end of the cord down into the vent hood, through the hole found in the vent hood top panel. See Fig. 12-2.

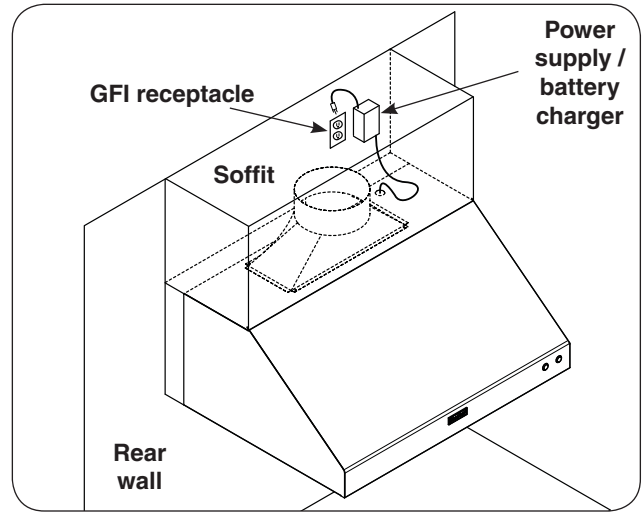

Fig. 12-1

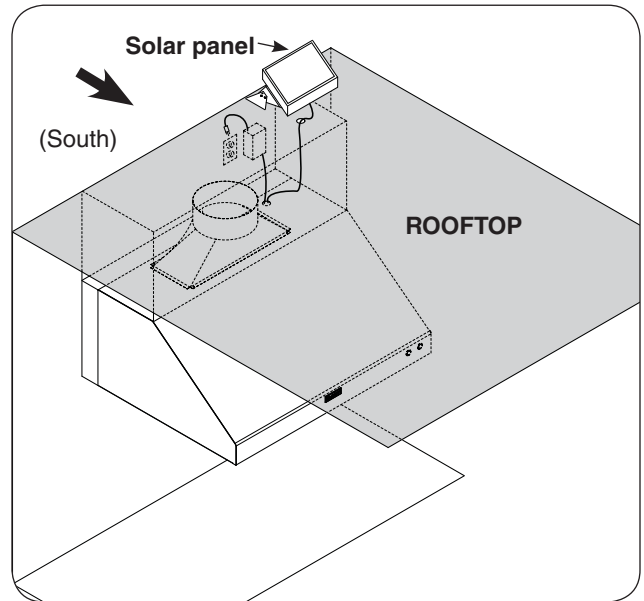

Fig. 12-2



Fig. 12-3

FAN BOX

1. Carefully raise the fan box up into the vent hood. You will first need to slide one side in at a slight angle, until the fan box lip rests on the access plate. Then raise and slide the opposite side of the fan box until it is centered in place. Be sure to align the 8 screw holes, then secure the fan box in place with the provided screws. See Fig. 13-1.

CAUTION: DO NOT PROCEED TO THE NEXT STEP UNTIL THE FAN BOX IS INSTALLED AND FASTENED IN PLACE WITH ALL 8 SCREWS.

WIRING CONNECTIONS

Be sure the fan box is secured in place prior to removing the right access plate to make the wire connection(s).

1. Unfasten the 4 screws and remove the right access plate (see Fig. 13-2).

CAUTION: Support the access plate when removing to avoid it from quickly falling off.

2. The wiring connections will be exposed.

Standard models will have one wire connection coming out of the right rear side of the fan box, with the power supply cord coming into the vent hood. Make this connection as shown in Fig. 13-2.

Solar models will have a wire harness coming out of the right rear side of the fan box, with the battery charger and solar panel cords coming into the vent hood. Make these connections as shown in Fig. 13-3.

Both models will have another wire harness toward the right front of the fan box. This is to be connected to the wire harness coming out of the right front of the vent hood. See Fig. 13-2 or 13-3.

3. Reinstall the access plate.

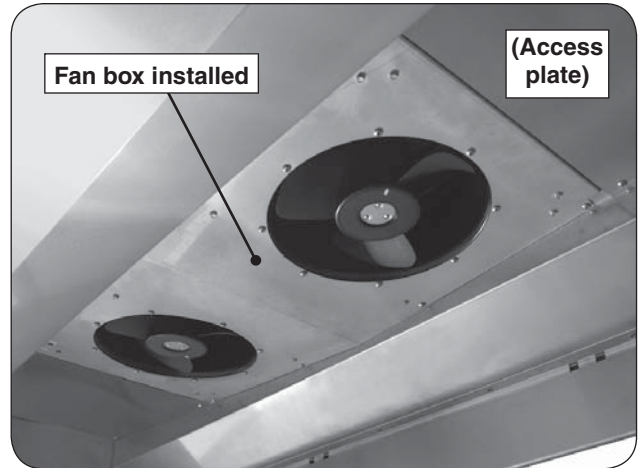

Fig. 13-1

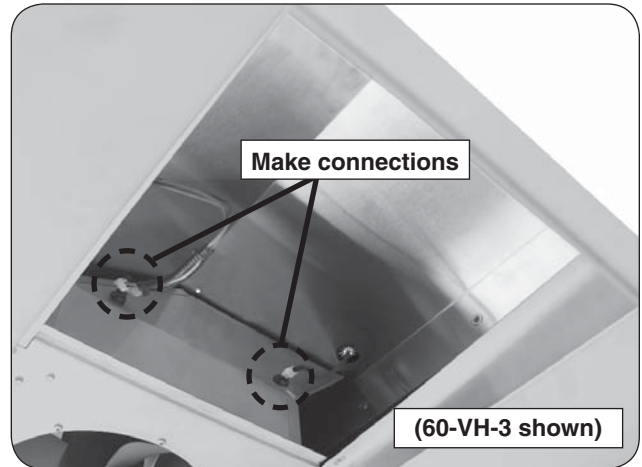

Fig. 13-2

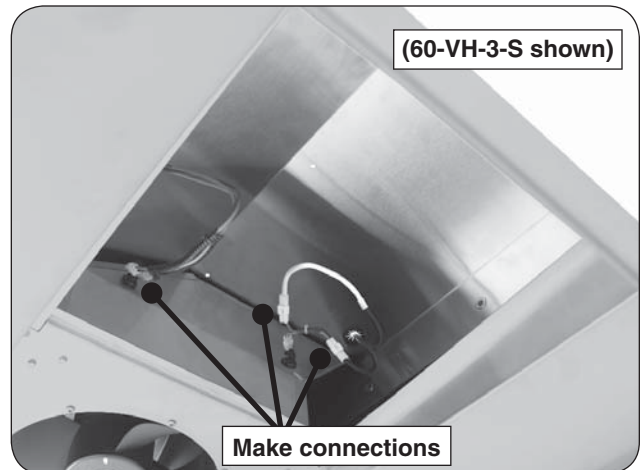

Fig. 13-3

BAFFLE

1. Carefully raise the baffle up into the vent hood. You will first need to slide one side in at a slight angle, until the baffle edge aligns above the inner wall (see Fig. 14-1). Then raise the opposite side of the baffle until it also aligns. Drop the baffle into place.
2. Align the 4 screw holes (2 on each side), then secure the baffle in place with the provided screws. See Fig. 14-2.

Important: To prevent cross-threading the screws; screws should be installed manually with a screwdriver.

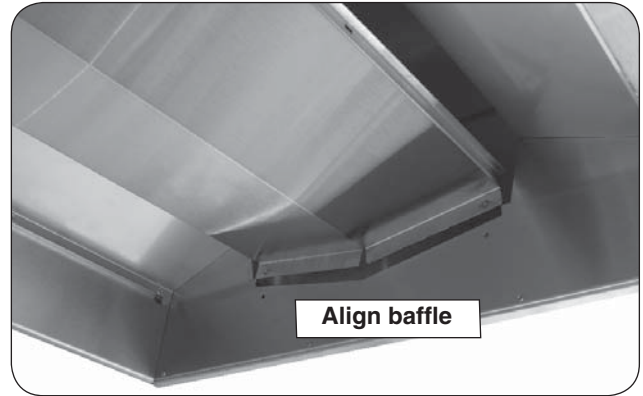

Fig. 14-1

GREASE FILTERS

1. Install the filter spacer (if applicable, 42" models only). See Fig. 14-3. Repeat for other side.
2. Install a filter into the vent hood by first pressing in the lever, then aligning the tabs found on the filter into the notches found in the interior of the hood. The filters will secure in place. Repeat for all filters. See Fig. 14-4.

VENT PIPING

A cutout will need to be made in the ceiling to route the piping through; and must be sealed with silicone to prevent leaks.

Install 10" round galvanized rigid (single wall) vent piping from the transition on. Install cap on top of vent piping to prevent water and debris from entering the vent hood. Installation will depend on ceiling construction and individual setup.

Note: Vent piping should be installed as straight as possible to prevent back-pressure on the fans.

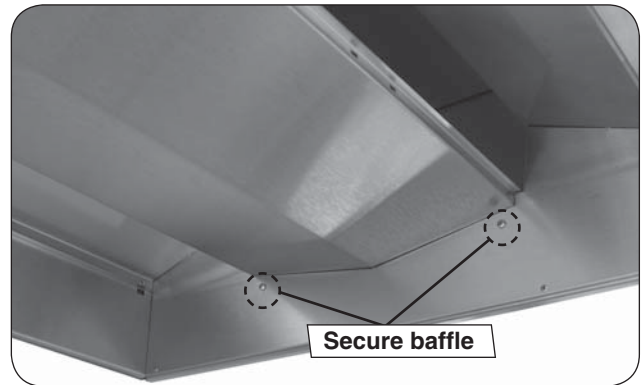

Fig. 14-2

CONNECT POWER

1. Plug power supply / battery charger into the GFI receptacle that was previously installed (in the soffit area).

Standard models will always need the power supply plugged in when operating the vent hood.

Solar models must be charged prior to initial use and after any excessive battery drainage. Leave the battery charger plugged in overnight to ensure complete charges. Only plug in the battery charger when necessary.

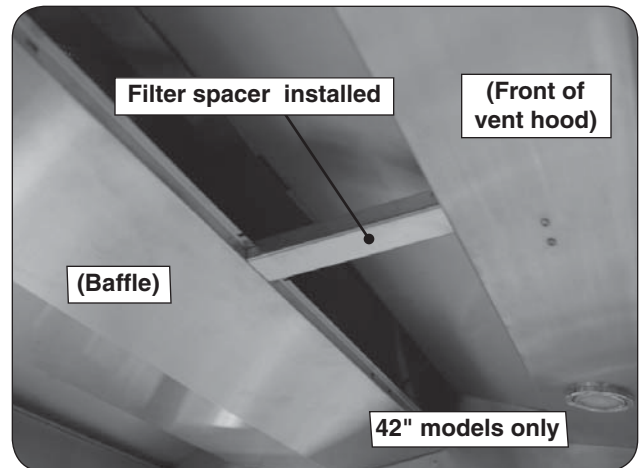

Fig. 14-3

FINISH SOFFIT

1. Install finishing substrate to left and right sides, and front of soffit as appropriate.

Important: The soffit must allow permanent interior access (i.e. access panel/door).

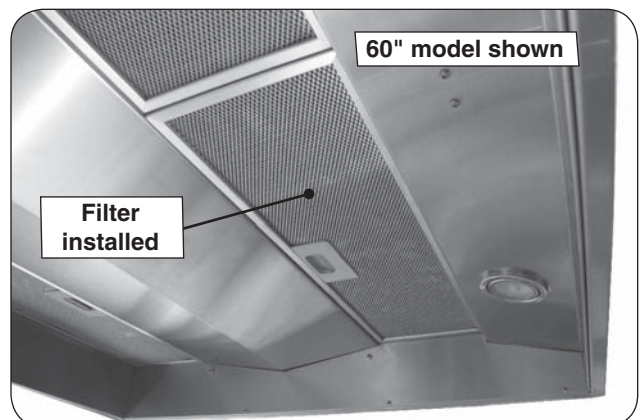

Fig. 14-4

VENT HOOD FAN

To turn the fan on/off, simply press the on/off button located on the front right of the vent hood. The on/off button is symbolized with a fan logo etched below it. (See Fig. 15-1.)

Always turn the fan on before cooking to establish an air flow. Allow the fan to operate for few minutes after you turn the grill off, to clear the air out and keep the area smoke free.

Note: The vent hood is internally equipped with a thermal switch. When the surrounding area reaches temperature, the thermal switch will automatically turn on the vent hood fan. This feature is for convenience and prevents damage to the vent hood.

GRILL TOP LIGHTING

The LED lights are controlled by pressing the on/off button located on the front right side of the vent hood. The on/off button is symbolized with a light bulb logo etched below it. (See Fig. 15-1.)

Clean the vent hood on a regular basis to ensure optimal performance. See the SERVICING AND CLEANING section for details.

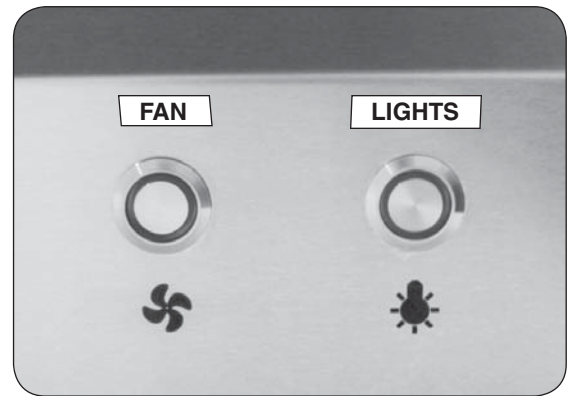

Fig. 15-1

VENTILATEUR DE CAPOT DE PASSAGE

Pour tourner le ventilateur "Marche/Arrêt", appuyez sur simplement le bouton "Marche/Arrêt" situé sur le juste d'avant du capot de passage. Le bouton "Marche/Arrêt" est symbolisé avec un logo de ventilateur gravé à l'eau-forte au-dessous de lui. (Voir la Fig. 16-1.)

Tournez toujours le ventilateur dessus avant la cuisson pour établir une circulation d'air. Permettez au ventilateur de fonctionner pendant peu de minutes après que vous arrêtez le gril, pour dégager l'air dehors et pour maintenir le secteur sans fumée.

Note: Le capot de passage est intérieurement équipé d'un interrupteur thermique. Quand les abords atteignent la température, l'interrupteur thermique automatique branchera le ventilateur de capot de passage. Ce dispositif est pour la convenance et empêche des dommages au capot de passage.

ÉCLAIRAGE SUPÉRIEUR DE GRIL

Les lumières de LED sont commandées en appuyant sur le bouton "Marche/Arrêt" situé sur le côté droit plan du capot de passage. Le bouton "Marche/Arrêt" est symbolisé avec un logo d'ampoule gravé à l'eau-forte au-dessous de lui. (Voir la Fig. 16-1.)

Nettoyez le capot de passage de façon régulière pour assurer l'exécution optimale.

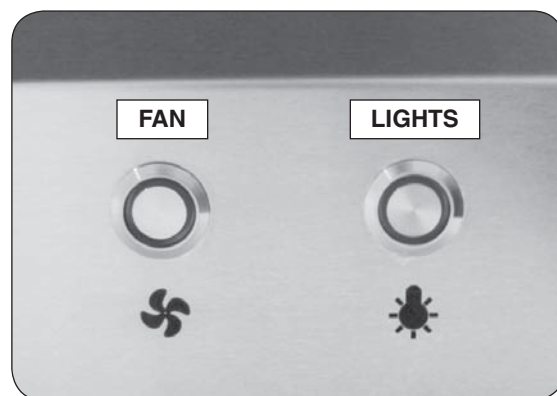

Fig. 16-1

The unit must be off and the power supply source must be disconnected prior to beginning any service or cleaning. Any components removed during servicing/cleaning must be reinstalled, as previously instructed in this manual, prior to future operation. CONTACT YOUR DEALER FOR REPLACEMENT PARTS.

STAINLESS STEEL CARE

Clean your vent hood by first using Fire Magic Barbecue and Grill Cleaner (part #3580-1) to remove grease and dirt. Always wipe with the grain (See Fig. 17-1). Next, use Fire Magic Stainless Steel Cleaner (3581-1) to restore the stainless steel color. Finish by wiping your vent hood down using Fire Magic Polish Wipes (3586-1).

Clean your vent hood at least once a month.

If your vent hood is installed in a seaside (salt air) or poolside (chlorine) location, it will be more susceptible to corrosion and must be maintained/cleaned more frequently. Do not store chemicals (such as chlorine or fertilizer) near your stainless steel appliance.

Due to the nature of stainless steel, surface iron oxide deposits may appear. Do not be alarmed – these deposits are removable with stainless-steel cleaner through prompt and periodic maintenance. If not attended to promptly, permanent pitting may occur.

GREASE FILTERS

Wash the filters frequently either in a detergent solution, or by placing them in your dishwasher. Cleaning the filters on a regular basis (depending on usage) will ensure optimal performance and longevity of the vent hood.

To remove a filter; simply press in the lever and pull it away from the vent hood (see Fig. 17-2).

Once the filters are clean, reinstall each into the vent hood by first pressing in the lever, then aligning the tabs found on the filter into the notches found in the interior of the hood. The filters will secure in place.

Important: If a filter becomes damaged or not cleanable; it must be replaced.

FANS

Clean the fans on a regular basis (depending on usage) with a damp towel to ensure optimal performance. (The grease filters and baffle will need to be removed to gain access.)

REPLACING LIGHTS

Should a light need to be replaced; the light housing assembly can be removed with your hands by applying slight pressure to one side, and simultaneously pulling it out (see Fig. 17-3).

Disconnect the terminal found inside (see Fig. 17-4); and reconnect a new light housing assembly.



Fig. 17-1

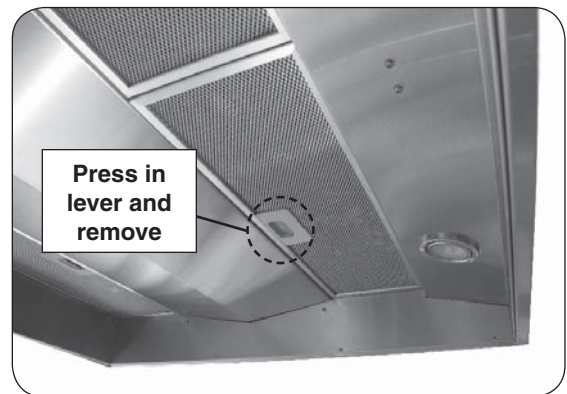

Fig. 17-2



Fig. 17-3



Fig. 17-4

REPLACING BATTERIES/FUSE (SOLAR ONLY)

1. Remove the filters, and the filter spacers (if applicable, 42" models only). To remove a filter; simply press in the lever and pull it away from the vent hood (see previous page).
2. Uninstall the baffle by removing the 4 screws (securing it to the hood), then lifting the baffle upward and out. See Fig. 18-1.
3. Uninstall the right access plate by removing the 4 screws; then disconnect the wire connections (see Fig. 18-2).

4. REINSTALL THE ACCESS PLATE.

5. Uninstall the fan box by removing the 8 screws (securing it to the hood), then carefully sliding it to one side and pulling it down and out of the hood (see Fig. 18-3).
6. The batteries and fuse holder are located inside of the fan box (see Fig. 18-4). Replace as needed.

Fuses can be replaced by opening the fuse holder, removing the old fuse, and inserting a new fuse (3AG 20 AMP).

Batteries can be replaced by first removing the protective covering from each battery (as needed) and disconnecting the terminals. Remove the battery (from Velcro) and replace with a new battery.

Connect the exposed terminals to the new battery (red to red and black to black) and replace the protective covering.

CAUTION: Incorrectly connecting the terminals may result in damage, injury, and/or a short.

7. Once any replacements are complete; reinstall the fan box.
8. Remove the right access plate to reconnect the wire connections, then reinstall the access plate.
9. Reinstall the baffle and the filters.

SOLAR PANEL (IF EQUIPPED)

For optimal performance; keep the solar panel glass clean and clear of debris/obstructions. Common glass cleaner may be used.



Fig. 18-1

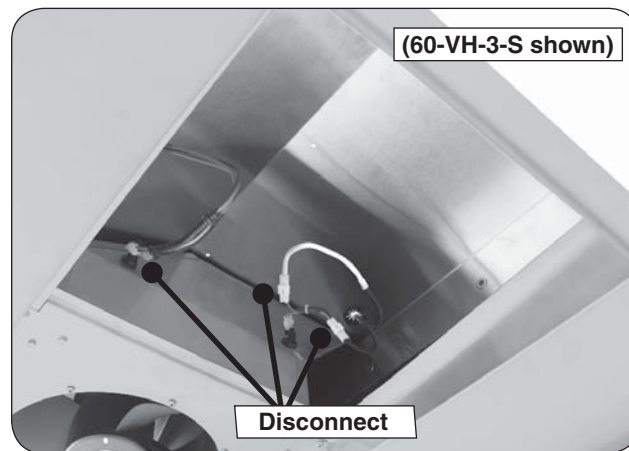

Fig. 18-2

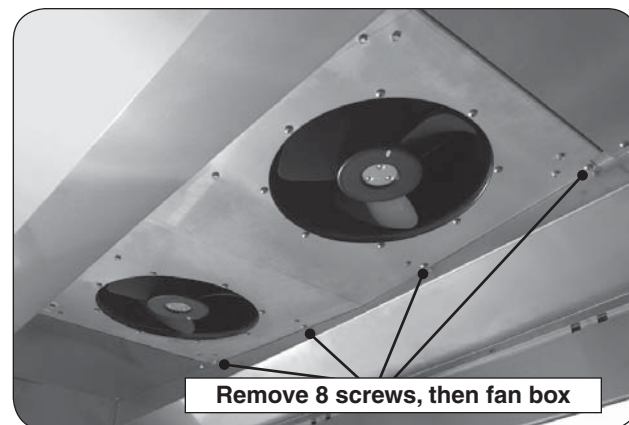

Fig. 18-3

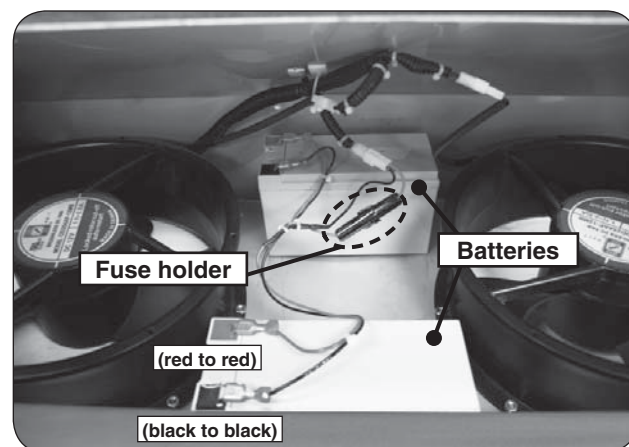

Fig. 18-4

TROUBLESHOOTING

If you have trouble with this vent hood, please use this list to identify the problem. By trying one or more of the solutions to the possible cause, you should be able to solve the problem. If this list does not cover your present problem, or if you have other technical difficulties with the vent hood, please contact your local Fire Magic dealer or visit our web site at www.rhpeterson.com.

PROBLEM	POSSIBLE CAUSE	CORRECTION
Unit does not turn on	<ol style="list-style-type: none"> 1. No power to hood 2. Switch malfunction 3. Power supply malfunction 	<ol style="list-style-type: none"> 1a. Check if unit is plugged in. 1b. Check battery and fuse condition (solar only). 3. Check or replace switch. 4. Check or replace power supply.
Loss of suction	<ol style="list-style-type: none"> 1. Grease filter(s) clogged 2. Fan(s) not operating 3. Fan(s) obstructed 	<ol style="list-style-type: none"> 1. Clean or replace filter(s). 2. Check or replace fan(s). 3. Check fan(s) for possible obstructions.
Switch malfunction	<ol style="list-style-type: none"> 1. Defective switch 2. Wire harness shorted/disconnected 	<ol style="list-style-type: none"> 1. Check or replace switch. 2. Check wire harness connection.
Fan malfunction	<ol style="list-style-type: none"> 1. Defective fan 2. Wire harness shorted/disconnected 3. Fan(s) obstructed 	<ol style="list-style-type: none"> 1. Check or replace fan. 2. Check wire harness connection. 3. Check fan(s) for possible obstructions.
Power supply/ battery charger malfunction	<ol style="list-style-type: none"> 1. Defective power supply / battery charger 2. Power supply / battery charger over-heated 	<ol style="list-style-type: none"> 1. Replace power supply / battery charger. 2. Allow power supply / battery charger to cool before continued use.

WARRANTY

LIFETIME WARRANTY - Fire Magic® cast stainless-steel burners, stainless-steel rod cooking grids, and stainless-steel housings are warranted for as long as you own your Fire Magic® grill.

FIFTEEN-YEAR WARRANTY - Fire Magic® cast brass burners, brass valves, backburner assemblies (except ignition parts), and manifold assemblies are warranted for 15 years from the date of purchase of your Fire Magic® grill.

THREE-YEAR WARRANTY - Fire Magic® sideburners and all other Fire Magic® grill components (except ignition and electronic parts) are warranted for three (3) years from the date of purchase of your Fire Magic® grill.

Fire Magic® ignition systems (excluding batteries), electronic components (including lights and thermometers), and accessories are warranted for one (1) year from date of purchase.

PLEASE KEEP A COPY OF YOUR SALES SLIP FOR PROOF OF PURCHASE

This warranty applies to the original purchaser and to single family residential use only. It commences from date of purchase, and is valid only with proof of purchase.

This warranty does not cover parts becoming defective through misuse, accidental damage, electrical damage, improper handling, storage, and/or installation. Product must be installed (and gas must be connected) as specified in the instructions or operator's manual, by a **qualified professional installer**. Accessories, parts, valves, remotes, etc., when used must be Peterson Co. product.

This warranty **does not** apply to rust, corrosion, oxidation, or discoloration, unless the affected component becomes inoperable. It **does not** cover labor or labor-related charges.

This warranty specifically excludes liability for **indirect, incidental**, or consequential damages. Some states do not allow the exclusion or limitation of incidental or consequential damages, so the above exclusion may not apply to you. This warranty gives you specified legal rights, and you may have other rights that may vary from state to state.

For additional information regarding this warranty, or to place a warranty claim, contact the R.H. Peterson dealer where the product was purchased.

**TO REGISTER YOUR PRODUCT ONLINE GO TO: WWW.RHPETERSON.COM,
AND CLICK ON PRODUCT REGISTRATION. THANK YOU FOR YOUR PURCHASE.**

Quality Check			Date: _____		
Burner Orifices	Nat.	L.P.	Leak Test: _____	Model#: _____	
Main:	_____	_____	Burn Test: _____	Serial#: _____	
Other:	_____	_____	Gas Type: <u>Nat. / L.P.</u>	Air Shutter: _____	
				Inspector: _____	