



# FF1376SSIM



59.25" x 23.63" x 28.38" (H x W x D)

11.5 cu.ft. frost-free refrigerator-freezer with black cabinet, stainless steel doors, and factory installed icemaker

### Highlights:

True frost-free operation prevents icy buildup

Deluxe interior includes adjustable glass shelves for spill-proof storage

Door storage in both compartments, including a gallon-sized shelf

Factory installed icemaker provides a steady supply of ice

### Product Features:

|                                  |                                                                                                                           |
|----------------------------------|---------------------------------------------------------------------------------------------------------------------------|
| Frost-free operation             | No-frost convenience for reduced user maintenance                                                                         |
| Thin-line design                 | Limited space is no problem for our thin-line models, designed specifically for those hard-to-fit spots                   |
| Full capacity                    | 11.5 cu.ft. interior                                                                                                      |
| Factory installed icemaker       | Keep a steady supply of ice on hand in the freezer compartment                                                            |
| Reversible stainless steel doors | Professional look with reversible convenience                                                                             |
| Adjustable glass shelves         | Rearrange your refrigerator and freezer space to accommodate all shapes and sizes or remove shelves for a simple clean-up |
| Door storage                     | Store tall bottles and condiments right on the door for convenient access                                                 |
| Fruit and vegetable crisper      | Get the longest life and best taste out of produce by storing it in a convenient slide drawer                             |
| Interior light                   | Automatically illuminates when you open the door                                                                          |



## FF1376SSIM Specifications:

| Overview                         |                 |
|----------------------------------|-----------------|
| Height                           | 59.25"          |
| Height to Hinge Cap              | 59.75"          |
| Width                            | 23.63"          |
| Depth                            | 28.38"          |
| Depth with door at 90°           | 50.63"          |
| Capacity                         | 11.5 cu.ft.     |
| Defrost Type                     | Frost-Free      |
| Door                             | Stainless Steel |
| Cabinet                          | Black           |
| US Electrical Safety             | CSA             |
| Canadian Electrical Safety       | CSA-C           |
| Energy Usage/Year                | 428.0kWh/year   |
| Amps                             | 2.5             |
| Voltage/Frequency                | 115 V AC/60 Hz  |
| Weight                           | 134.0 lbs.      |
| Shipping Weight                  | 158.0 lbs.      |
| Parts & Labor Warranty           | 1 Year          |
| Compressor Warranty              | 5 Years         |
| Refrigerator-Freezer             |                 |
| Door Swing                       | RHD             |
| Reversible                       | Yes             |
| Crisper Qty                      | 1               |
| Crisper Finish                   | Transparent     |
| Crisper Cover                    | Glass           |
| Refrigerator - Interior Height   | 34.5"           |
| Refrigerator - Interior Width    | 18.75"          |
| Refrigerator - Interior Depth    | 23.75"          |
| Refrigerator - Shelf Type        | Glass           |
| Refrigerator - Shelf Qty         | 2               |
| Refrigerator - Full Door Shelves | 1               |
| Refrigerator - Half Door Shelves | 2               |
| Freezer - Interior Height        | 15.5"           |
| Freezer - Interior Width         | 16.75"          |
| Freezer - Interior Depth         | 18.5"           |

|                             |          |
|-----------------------------|----------|
| Freezer - Shelf Type        | Glass    |
| Freezer - Shelf Qty         | 1        |
| Freezer - Full Door Shelves | 2        |
| Adjustable Shelves          | Yes      |
| Gallon Door Storage         | Yes      |
| Interior Light              | Yes      |
| Thermostat Type             | Dial     |
| Fan Type                    | Interior |
| Refrigerant Type            | R600a    |
| Refrigerant Amount          | 1.69 oz. |
| High Side PSI               | 300.0    |
| Low Side PSI                | 120.0    |
| Level Legs                  | 2        |
| Compressor Step Height      | 8.88"    |
| Compressor Step Width       | 18.75"   |
| Compressor Step Depth       | 7.0"     |

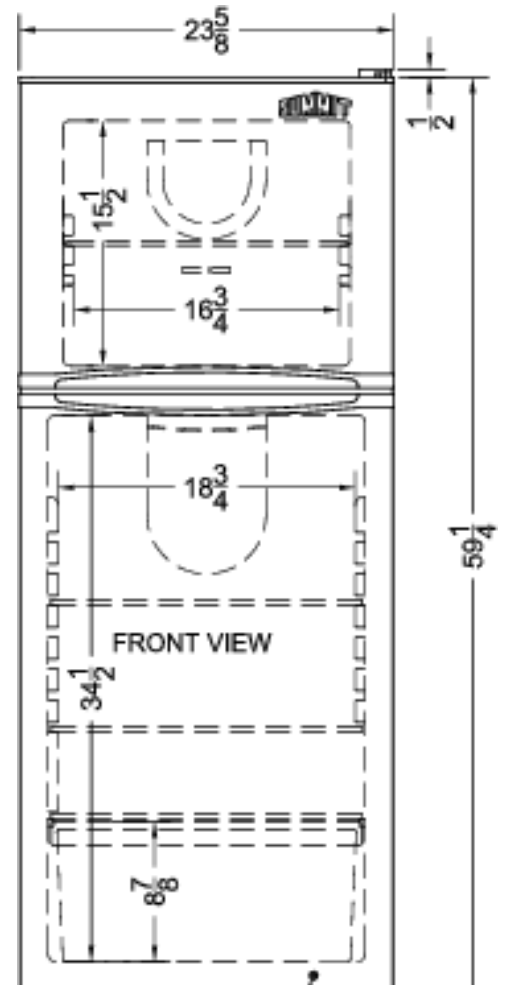
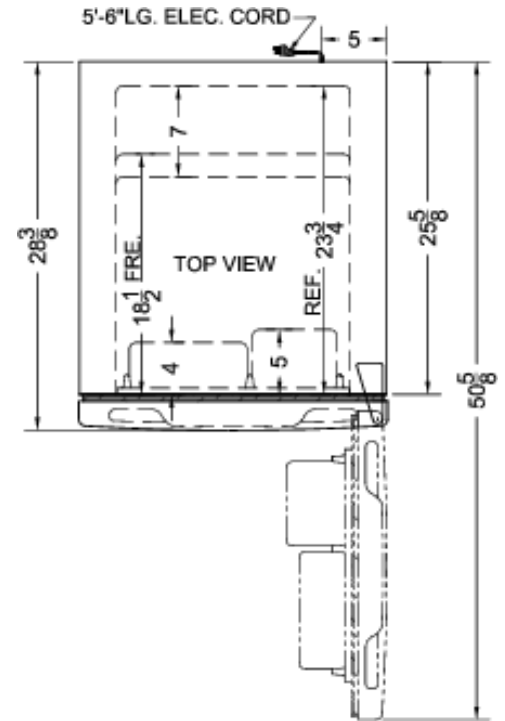

SUMMIT APPLIANCE DIVISION FELIX STORCH, INC.

770 Garrison Avenue, Bronx, NY 10474 USA TEL 718-893-3900 FAX 844-478-8799 info@summitappliance.com www.summitappliance.com