



# FF1375WIM



59.25" x 23.63" x 28.38" (H x W x D)

11.5 cu.ft. frost-free refrigerator-freezer in white finish with icemaker; replaces FF1374WIM

## Highlights:

True frost-free operation saves you maintenance by preventing icy buildup

Door storage in both compartments, including a gallon-sized shelf

Slim 24" width offers nearly 12 cu.ft. of interior storage capacity

Factory installed icemaker provides a steady supply of ice

## Product Features:

Frost-free operation	No-frost convenience for reduced user maintenance
Thin-line design	Limited space is no problem for our thin-line models, designed specifically for those hard-to-fit spots
Full capacity	11.5 cu.ft. interior
Factory installed icemaker	Keep a steady supply of ice on hand in the freezer compartment
Adjustable glass shelves	Rearrange your refrigerator and freezer space to accommodate all shapes and sizes or remove shelves for a simple clean-up
Door storage	Store tall bottles and condiments right on the door for convenient access
Gallon door storage	Door storage includes a shelf perfectly sized to hold one gallon container
Fruit and vegetable crisper	Get the longest life and best taste out of produce by storing it in a convenient slide drawer
Interior light	Automatically illuminates when you open the door



**SUMMIT APPLIANCE DIVISION** FELIX STORCH, INC.

770 Garrison Avenue, Bronx, NY 10474 USA **TEL** 718-893-3900 **FAX** 844-478-8799 [info@summitappliance.com](mailto:info@summitappliance.com) [www.summitappliance.com](http://www.summitappliance.com)



## FF1375WIM Specifications:

Overview	
Height	59.25"
Height to Hinge Cap	59.75"
Width	23.63"
Depth	28.38"
Depth with door at 90°	50.63"
Capacity	11.5 cu.ft.
Defrost Type	Frost-Free
Door	White
Cabinet	White
US Electrical Safety	CSA
Canadian Electrical Safety	CSA-C
Energy Usage/Year	428.0kWh/year
Amps	2.5
Voltage/Frequency	115 V AC/60 Hz

Weight	127.0 lbs.
Shipping Weight	140.0 lbs.
Parts & Labor Warranty	1 Year
Compressor Warranty	5 Years

Refrigerator-Freezer	
Door Swing	RHD
Reversible	Yes
Crisper Qty	1
Crisper Finish	Transparent
Crisper Cover	Glass
Refrigerator - Interior Height	34.5"
Refrigerator - Interior Width	18.75"
Refrigerator - Interior Depth	23.75"
Refrigerator - Shelf Type	Glass
Refrigerator - Shelf Qty	2
Refrigerator - Full Door Shelves	1
Refrigerator - Half Door Shelves	2
Freezer - Interior Height	15.5"
Freezer - Interior Width	16.75"
Freezer - Interior Depth	18.5"
Freezer - Shelf Type	Glass

Freezer - Shelf Qty	1
Freezer - Full Door Shelves	2
Adjustable Shelves	Yes
Gallon Door Storage	Yes
Interior Light	Yes
Thermostat Type	Dial
Fan Type	Interior
Refrigerant Type	R600a
Refrigerant Amount	1.69 oz.
High Side PSI	300.0
Low Side PSI	120.0
Level Legs	2
Compressor Step Height	8.88"
Compressor Step Width	18.75"
Compressor Step Depth	7.0"

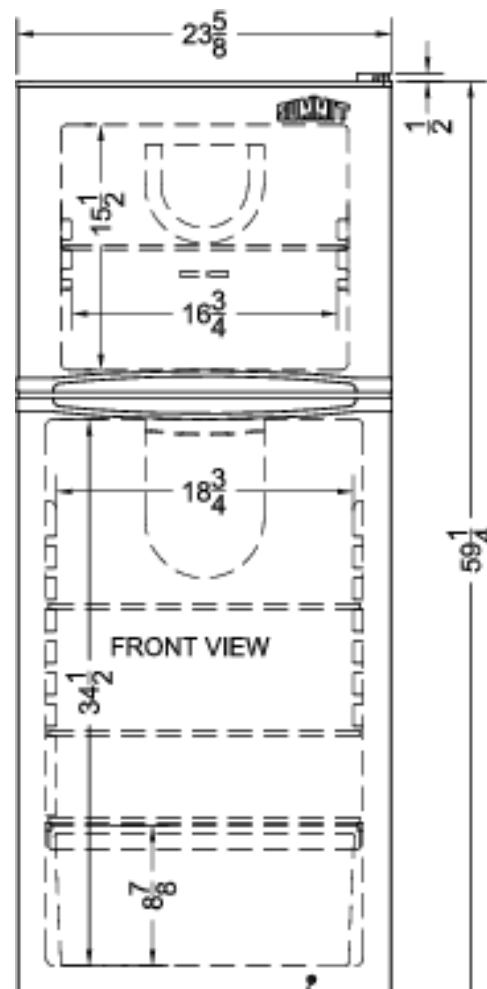
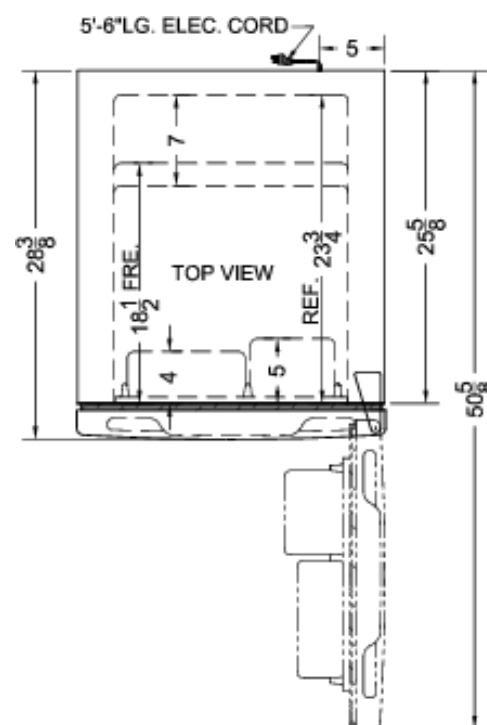

SUMMIT APPLIANCE DIVISION FELIX STORCH, INC.

770 Garrison Avenue, Bronx, NY 10474 USA TEL 718-893-3900 FAX 844-478-8799

info@summitappliance.com [www.summitappliance.com](http://www.summitappliance.com)