

In-Line Blowers

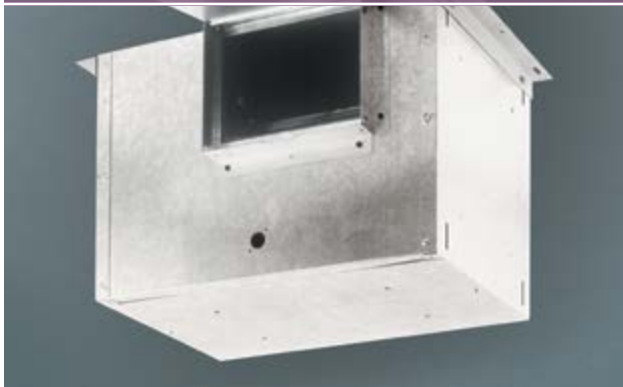

BEST® In-line blowers provide exceptional performance and reduced sound levels by moving the blower mechanism away from the point of use. Durable, sealed blowers meet the rigorous needs of professional-style cook tops and ranges. The table below will help you select an in-line blower matched to the heat output of your range hood. See page 70 for more information on selecting the right blower for your range or cooking style.



Series	ILB3	ILB6	ILB9	ILB11
Type	In-line	In-line	In-line	In-line
Straight Through CFM	280	600	800	1100
Right Angle CFM	260	600	700	1000
Unit Dimensions ³ W"x D"x H"	12¼x12¼x11¾	21½x12¼x11¾	22x18x18	22x18x18
Duct Inlet ¹ /Outlet	8" or 10" / 8" round	10" / 10" Round	10" / 10" Round	10" / 10" Round
Duct Direction	Vert. or Hor.	Vert. or Hor.	Vert. or Hor.	Vert. or Hor.
Backdraft Damper	Yes	Yes	Yes	Yes
Amps at 120V	2.7	2.9	3.0	5.0
Motor Type ²	Single Speed	Single Speed	Single Speed	Single Speed
Hood Compatibility ¹	IP29, UP26M, UP27M, WP28M, WP29M, PIK, All EX & E models	IP29, UP26M, UP27M, WP28M, WP29M, PIK, All EX & E models	IP29, UP26M, UP27M, WP28M, WP29M, PIK, All EX & E models	IP29, UP26M, UP27M, WP28M, WP29M, PIK, WPD39M, All EX & E models

¹ Most "EX" & "E" models require a transition (model 414) from 8" to 10" for use with External Blowers. BEST® blowers are designed and UL Certified for use with BEST® products only.

² All BEST® blower motors are thermal overload protected.

³ For more detailed information visit BESTRangeHoods.com

BEST® ducting, roof and wall cap accessories may be found on page 68. In-line blowers may be vented through the roof or wall, with the goal of minimizing the duct length.

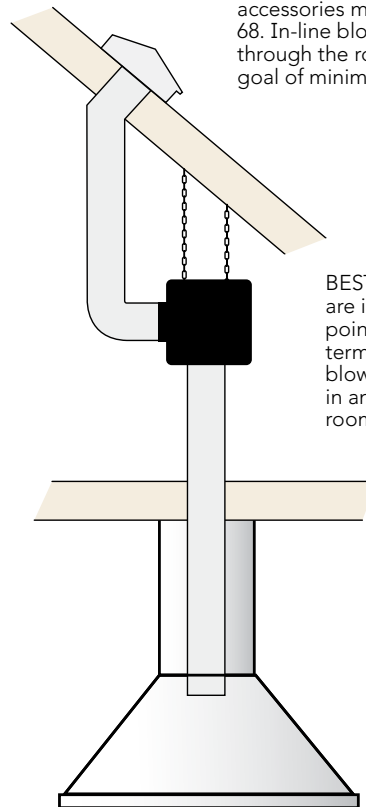

BEST® In-line blowers are installed between the point of use and the duct termination point. In-line blowers may be installed in an attic space, utility room or crawl space.

Electrical connections to both the hood and the in-line blower are required.

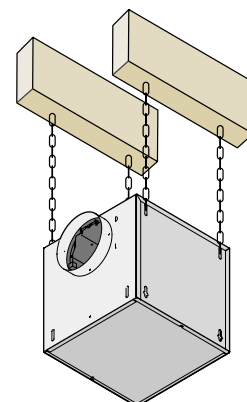

Suspending the in-line blower with a chain mounting kit (included) is recommended to minimize noise and vibration.

Exterior Blowers

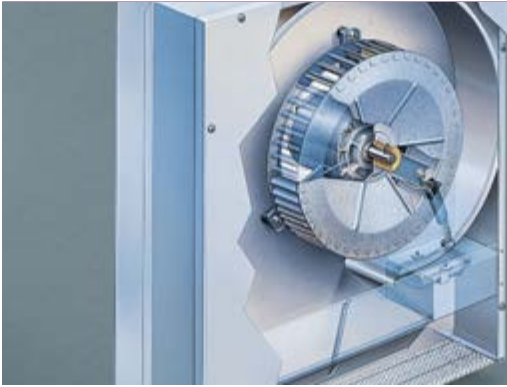

BEST® Exterior blowers provide exceptional performance and minimal sound levels by moving the blower to an exterior wall or the roof. Exterior blowers will handle the rigorous needs of professional-style cook tops and ranges. Durable, sealed blower housings are crafted from weather-resistant aluminum and can be painted to match the roof or wall color scheme. The table below will help you select an exterior blower matched to the heat output of your range hood. See page 70 for more information on selecting the right blower for your range or cooking style.

Series	EB6	EB9	EB12	EB15
Type	Exterior	Exterior	Exterior	Exterior
Vertical CFM/Sones	600 / NA	900 / NA	1200 / NA	1500 / NA
Horizontal CFM/Sones	NA*	NA*	NA*	NA*
Duct Size ¹	10" Round	10" Round	10" Round	10" Round
Duct Direction	Vertical*	Vertical*	Vertical*	Vertical*
Backdraft Damper ²	Yes	Yes	Yes	Yes
Amps at 120V	2.4	5.7	3	4.3
Motor Type ³	Single Speed	Single Speed	Single Speed	Single Speed
Hood Compatibility ¹	IP29, UP26M, UP27M, WP28M, WP29M, PIK, All EX & E models	IP29, UP26M, UP27M, WP28M, WP29M, PIK, All EX & E models	IP29, UP26M, UP27M, WP28M, WP29M, PIK, WPD39M, All EX & E models	IP29, UP26M, UP27M, WP28M, WP29M, PIK, WPD39M, All EX & E models

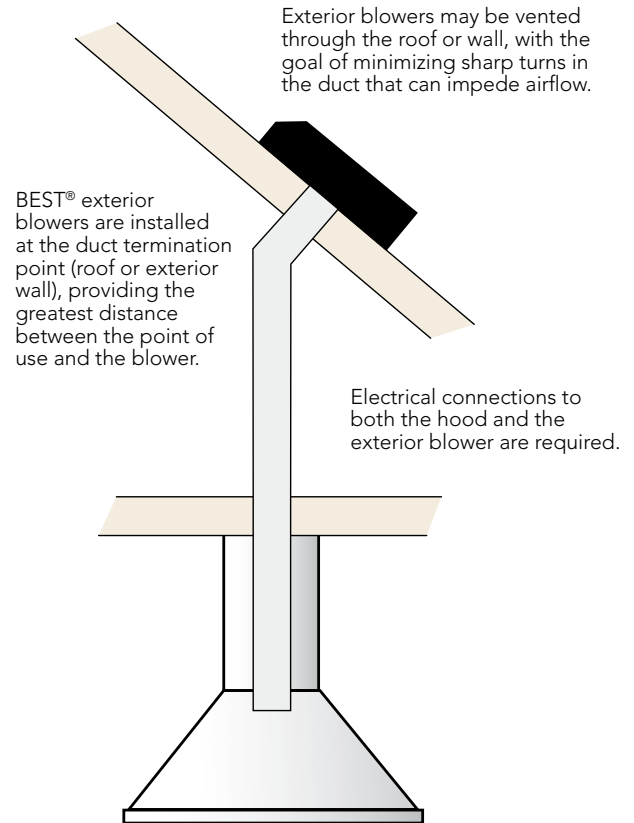

¹ Most "EX" & "E" models require a transition (model 414) from 8" to 10" for use with External Blowers. BEST® blowers are designed and UL Certified for use with BEST® products only.

² In cold climates, a separate In-line damper (model 421) is recommended.

³ All BEST® blower motors are thermal overload protected.

* Exterior Blower duct connection can be attached to the back (horizontal) of the WP29M.

EB6 and EB9

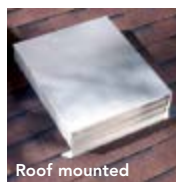
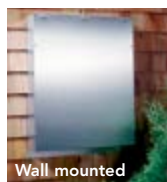
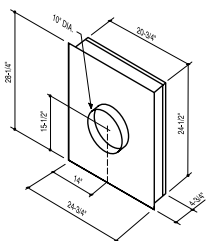

EB12 and EB15

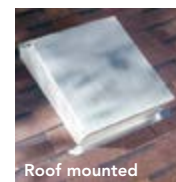
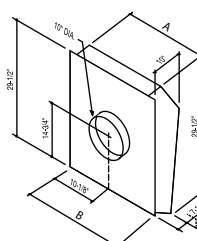

Model	Width "A"	Width "B"
EB12	22"	18"
EB15	25"	21"