



# XOU24RDS

24" REFRIGERATED DRAWERS

## LUXURY LIFESTYLE REFRIGERATION



**XOU24RDS**

- Precise Temperature 34° F to 50° F
- 5.2 cu. ft. Capacity
- Elegant Tri-Color Illumination
- Easy Glide - Soft Close Drawers

### XO INDOOR REFRIGERATED DRAWERS

If you're looking for a convenient way to store your food and beverages at the perfect temperature, the XO Refrigerated Drawer is just what you need. This innovative appliance is designed to fit seamlessly into your kitchen, giving you easy access to cold drinks, fresh produce, and anything else you might need at a moment's notice.

At XO, we believe that a good design is something everyone can afford

WORLD CLASS SERVICE | COMPREHENSIVE WARRANTIES

OUR LASTING COMMITMENT TO YOU

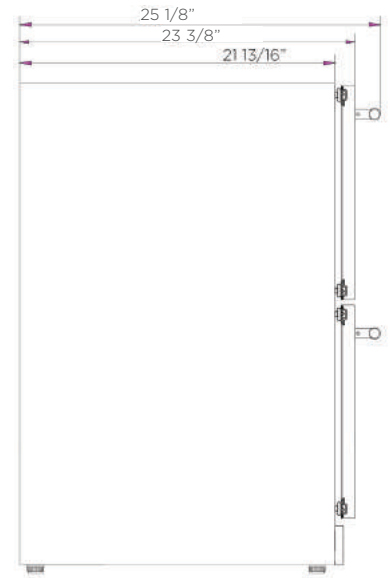
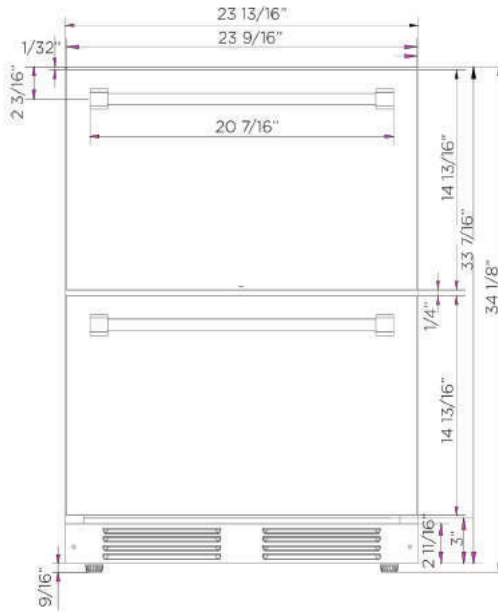
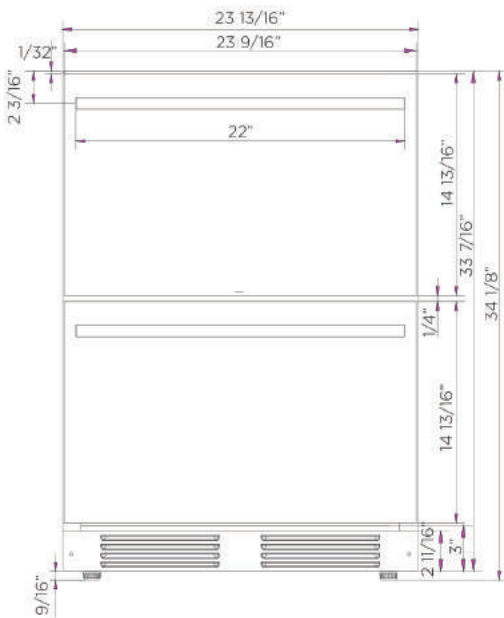

## FEATURES

## SPECIFICATIONS

FINISH

Stainless Steel

STYLES



Also available in:

- Outdoor
- Panel Ready

FEATURES

- Precise Temperature From 34° F To 50° F
- Easy Operating, Soft Close Drawers
- 5.2 Cu. Ft. Capacity Stores 132 (12oz) Cans
- Adjustable Divider Included In Top Drawer
- Rated For Indoor Use
- X-Active Air Circulation for Even Temperatures, Faster Cool Down and Greater Efficiency
- Quiet 39dBA Operation
- Elegant Tri-Color Illumination
- Energy Star Certified
- 2 Handle Styles Included
- Stainless Steel Toe Kick

**ELECTRICAL** 115V / 60 Hz / 15A

### DIMENSIONS

23-13/16" W x 23-3/8" D x 34-1/8" H

**SHIPPING WEIGHT** 160LBS

**CORD LENGTH** 6FT

**CONTROL TYPE** Electronic

**12-OZ CANS** 132

**CAPACITY** 5.2 (cu ft)



Two Different Style Handles Included

