

SIGNATURE

KITCHEN SUITE

WALL OVEN PLANNING / INSTALLATION GUIDE



WALL OVEN

PRODUCT DIMENSIONS

SIGNATURE
KITCHEN SUITE

SINGLE WALL OVEN – SKSSV3001S

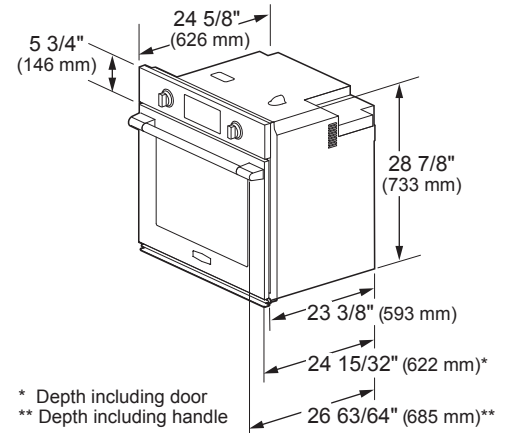
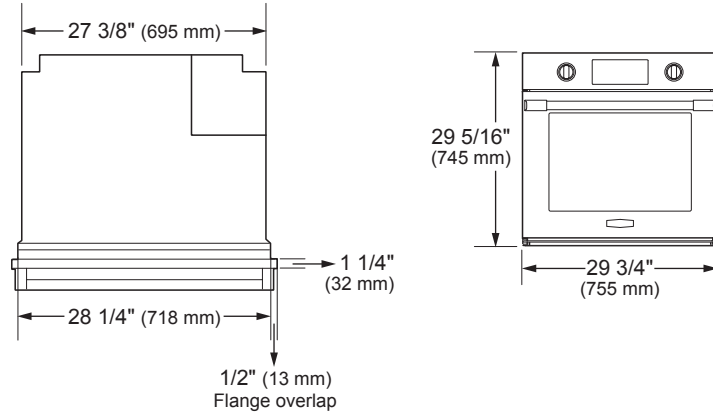

DOUBLE WALL OVEN – SKSDV3002S

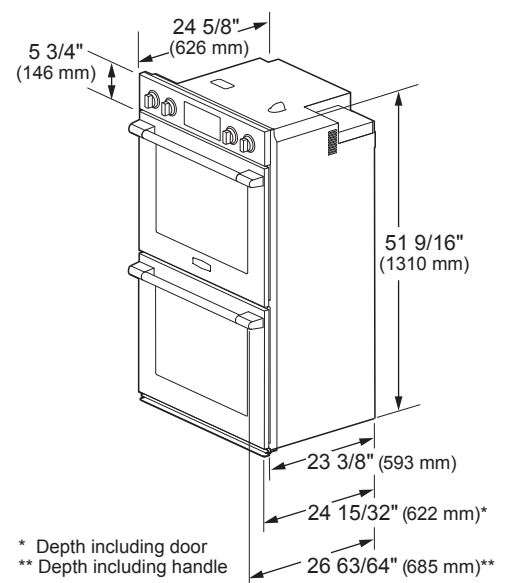
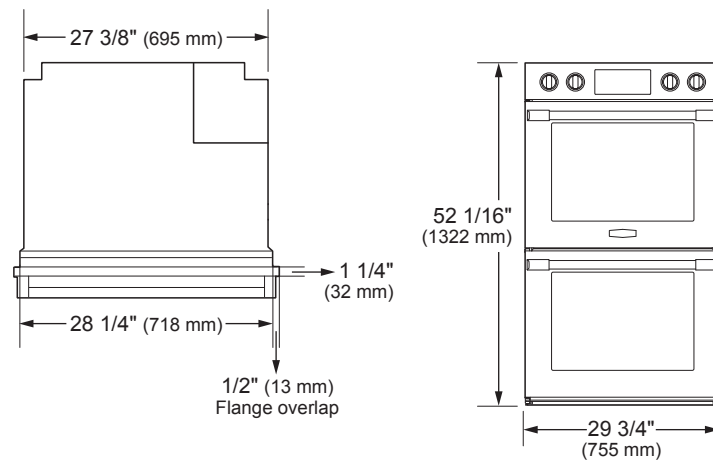

COMBINATION WALL OVEN – SKSCV3002S

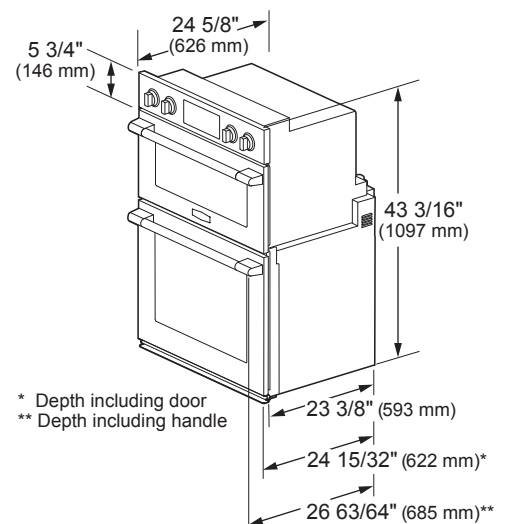
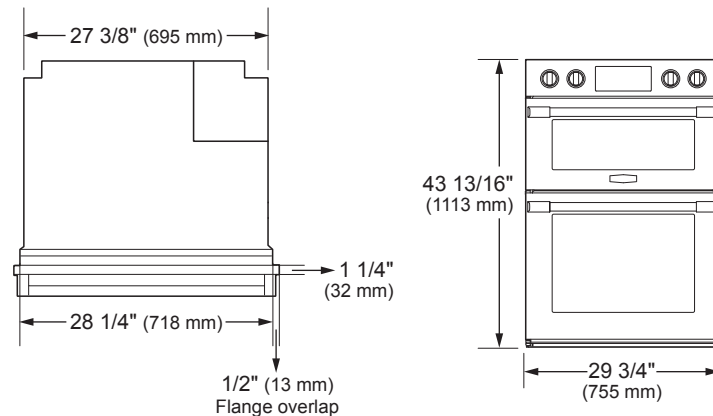

WALL OVEN PROUD INSTALLATION

SINGLE WALL OVEN – SKSSV3001S

CUTOUT DIMENSIONS – PROUD INSTALLATION IN WALL CABINET

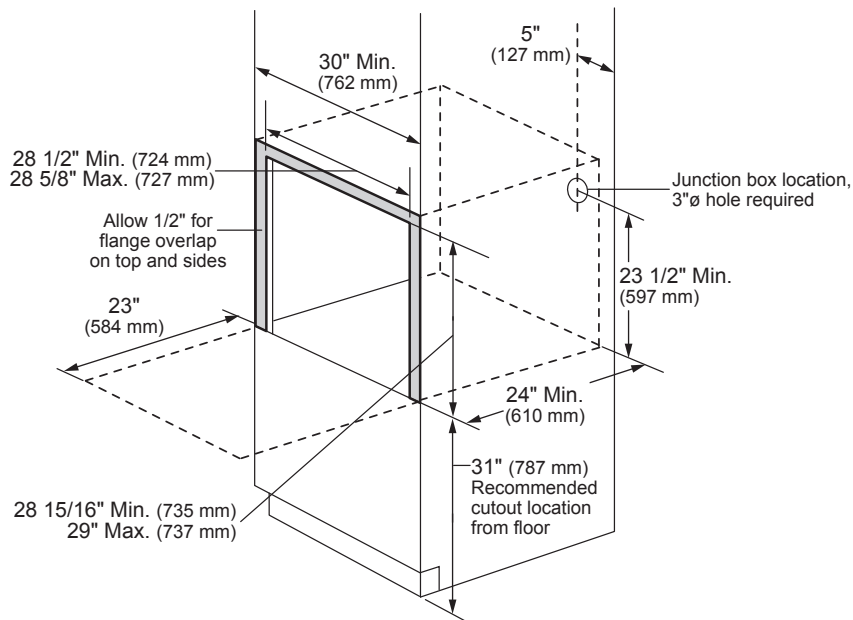

CUTOUT DIMENSIONS – UNDERCOUNTER INSTALLATION

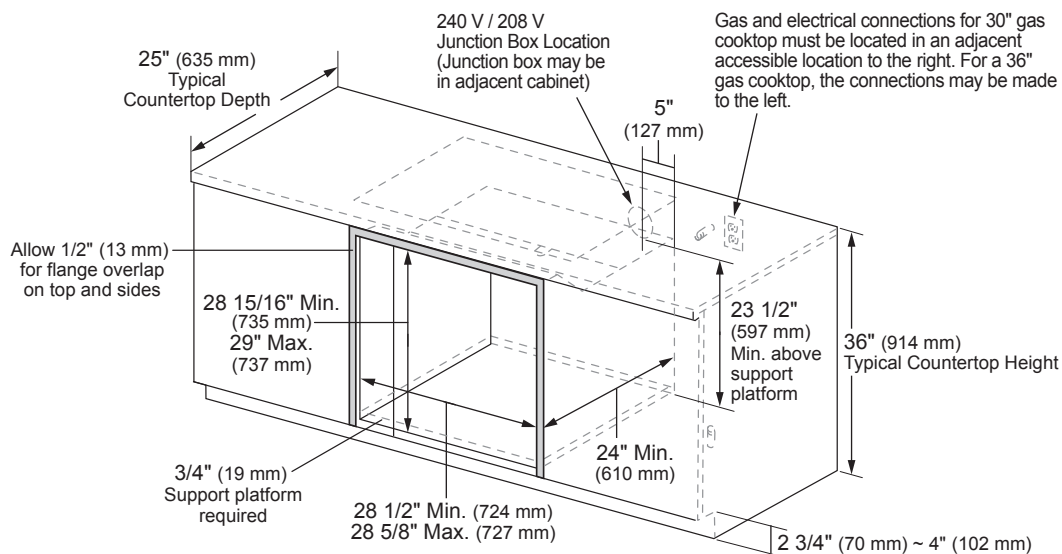

SINGLE WALL OVEN – SKSSV3001S

MICROWAVE & TRIM KIT – SKSMC2401S / MK2030NST

CUTOUT DIMENSIONS – PROUD INSTALLATION IN WALL CABINET

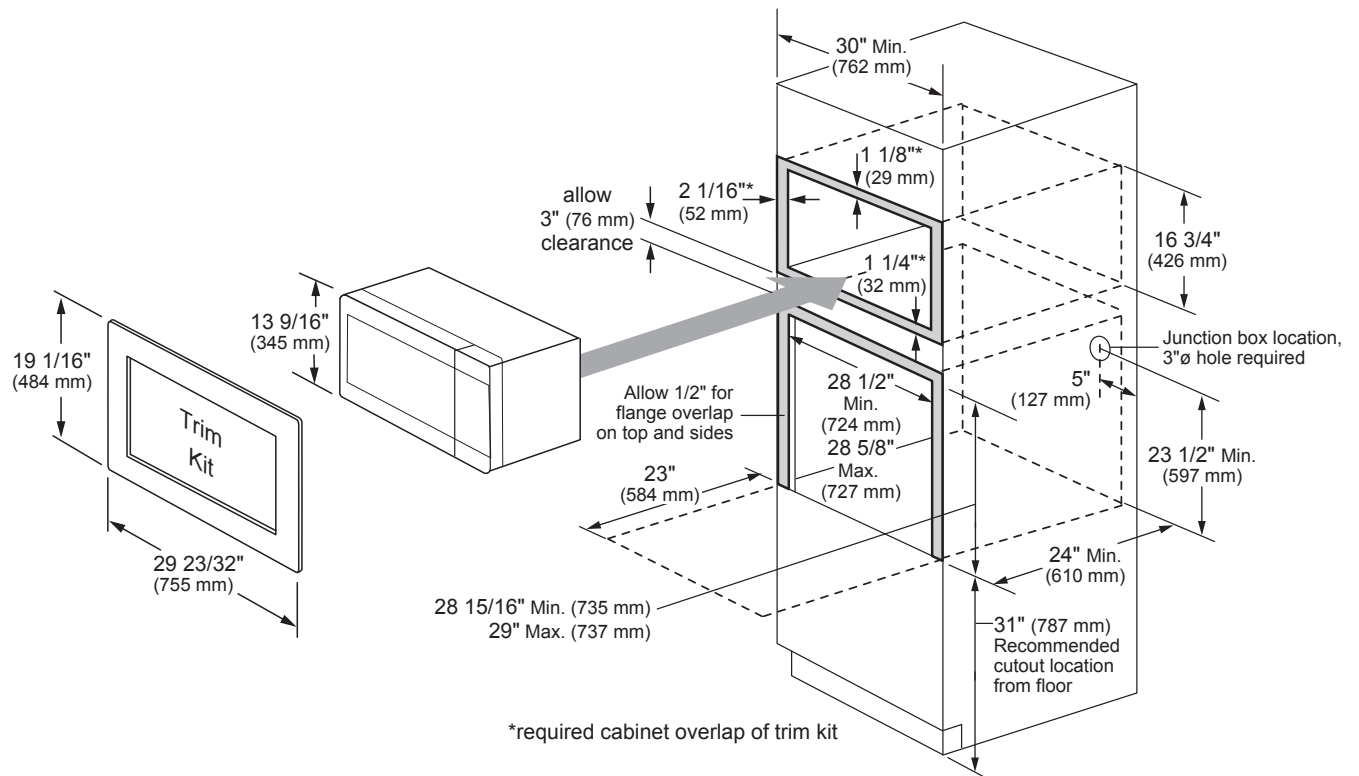

Notes

For installation above a built-in oven, the microwave oven should be installed on a 3/8" plywood base and supported by 2x4 or 1x2 equivalent runners on all sides. Base must support a minimum of 100 lbs.

A 120V, 60Hz grounded power receptacle should be installed at the back of the cabinet opening.

Warning

The trim kit uses air flow from the top, bottom and sides of the trim frame. Blocking the air flow can cause the microwave to function improperly and may cause damage to the microwave.

Allow an additional 1" of clearance beyond the trim kit on all sides to provide proper air flow.

WALL OVEN PROUD INSTALLATION

SIGNATURE
KITCHEN SUITE

DOUBLE WALL OVEN – SKSDV3002S

CUTOUT DIMENSIONS – PROUD INSTALLATION IN WALL CABINET

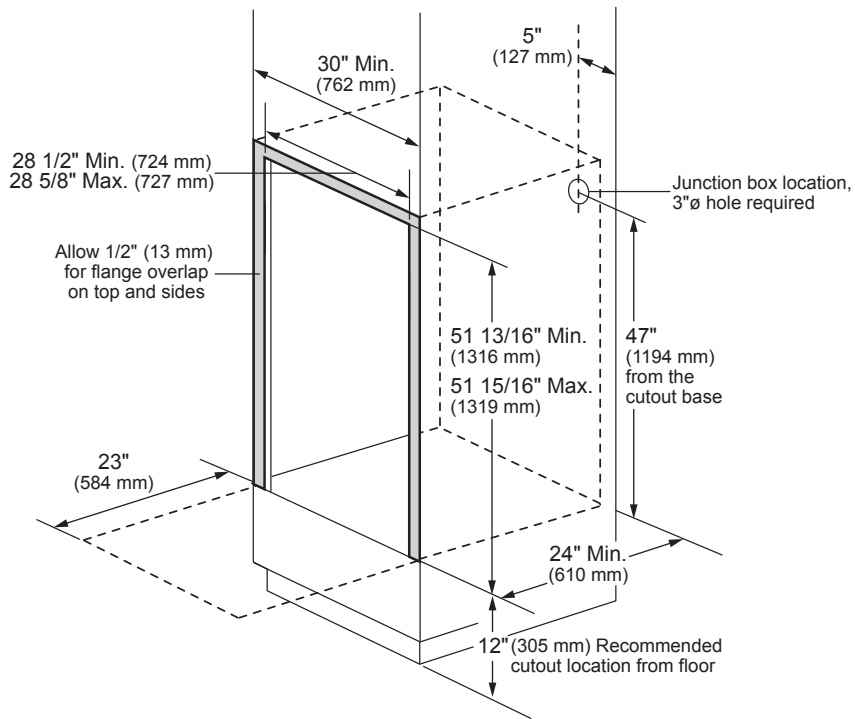

WALL OVEN PROUD INSTALLATION

SIGNATURE
KITCHEN SUITE

COMBINATION WALL OVEN - SKSCV3002S

CUTOUT DIMENSIONS – PROUD INSTALLATION IN WALL CABINET

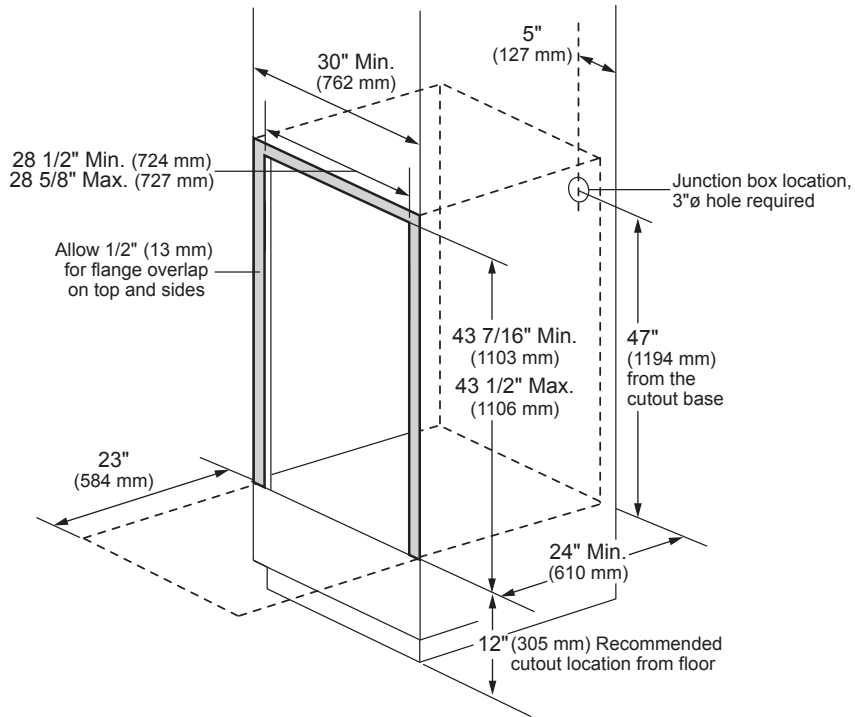

WALL OVEN FLUSH INSTALLATION

SIGNATURE
KITCHEN SUITE

SINGLE WALL OVEN – SKSSV3001S

CUTOUT DIMENSIONS – FLUSH INSTALLATION IN WALL CABINET

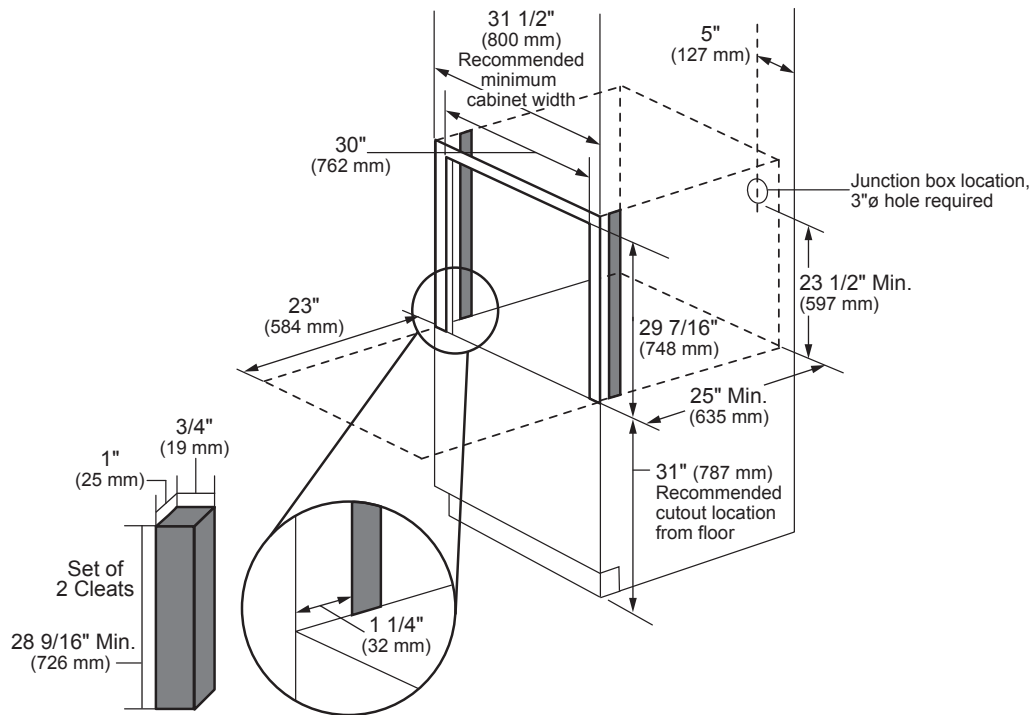

TOP VIEW

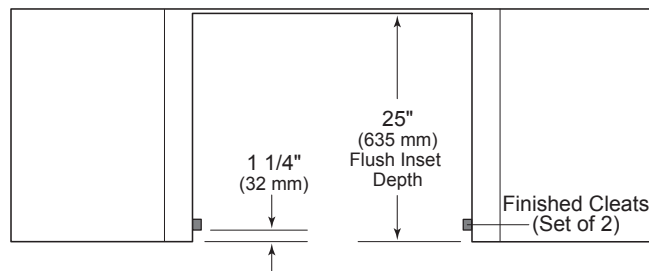

Notes

Cleats (spacers) must be recessed 1 1/4" (32 mm) from the front of the cabinet.

WALL OVEN FLUSH INSTALLATION

SIGNATURE
KITCHEN SUITE

DOUBLE WALL OVEN – SKSDV3002S

CUTOUT DIMENSIONS – FLUSH INSTALLATION IN WALL CABINET

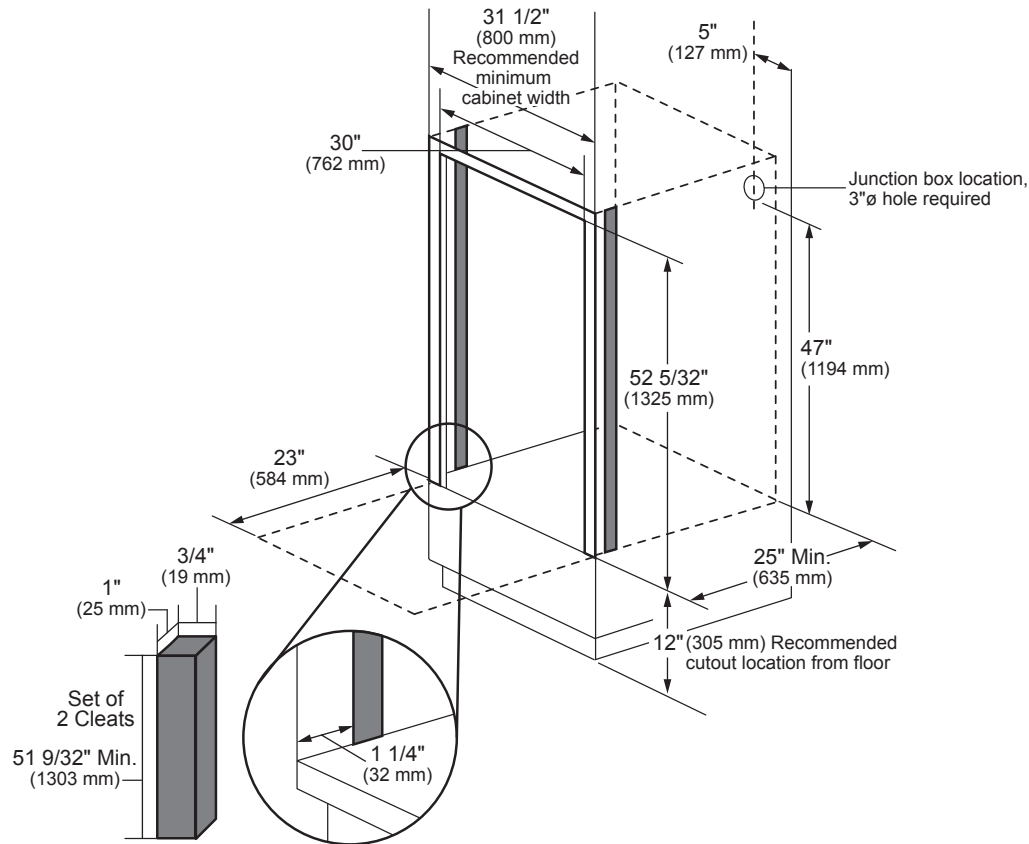

TOP VIEW

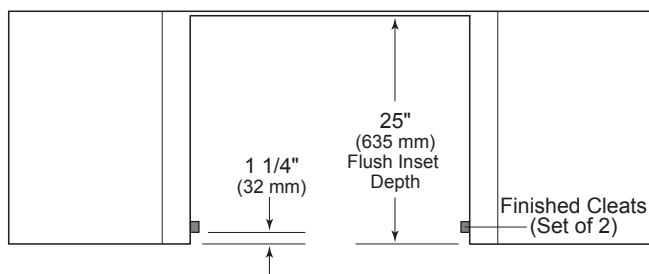

Notes

Cleats (spacers) must be recessed 1 1/4" (32 mm) from the front of the cabinet.

WALL OVEN FLUSH INSTALLATION

SIGNATURE
KITCHEN SUITE

COMBINATION WALL OVEN – SKSCV3002S

CUTOUT DIMENSIONS – FLUSH INSTALLATION IN WALL CABINET

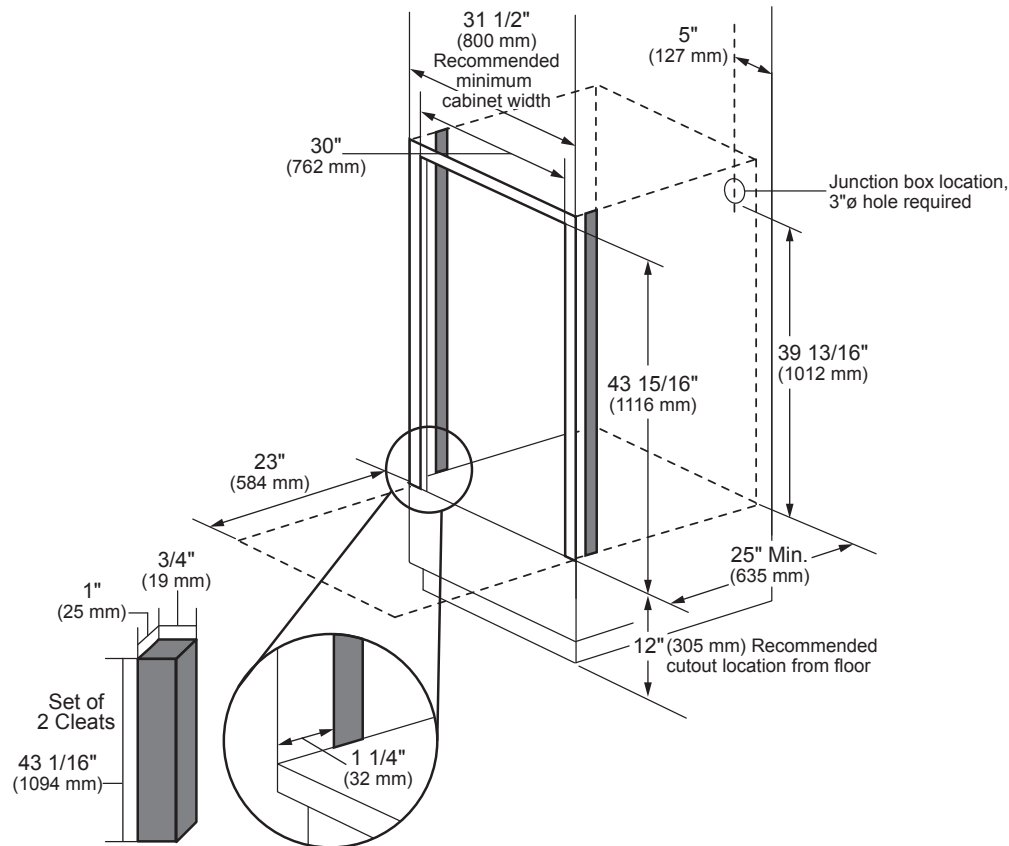

TOP VIEW

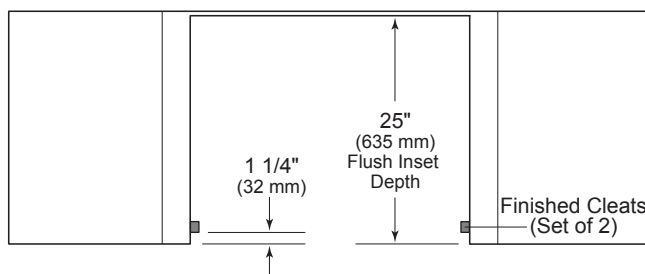

Notes

Cleats (spacers) must be recessed 1 1/4" (32 mm) from the front of the cabinet.