



MDD30TE/S/TH

FEATURES

- Integrates into any kitchen
- Matches E series ovens, coffee systems, convection steam oven
- 900 watts of power
- Generous 1.6. cu. ft. capacity
- Quick-start controls for popular items
- Gourmet mode cooks automatically from preset recipes
- "Keep Warm" mode
- Rigorously tested in our U.S. manufacturing facilities for decades of use
- Exceptional 24/7 support from our Customer Care team in Madison





PRODUCT SPECIFICATIONS

Model	MDD30TE/S/TH
Dimensions	29 7/8"W x 17 7/8"H x 20"D
Door Clearance	14 3/16"
Weight	80 lb
Electrical Supply	120 VAC, 60 Hz
Electrical Service	15 amp dedicated circuit
Overall Capacity	1.6 cu ft
Power Cord Length	4 feet
Receptacle	3-prong grounding-type

ELECTRICAL

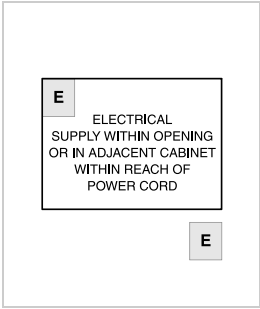

DIMENSIONS

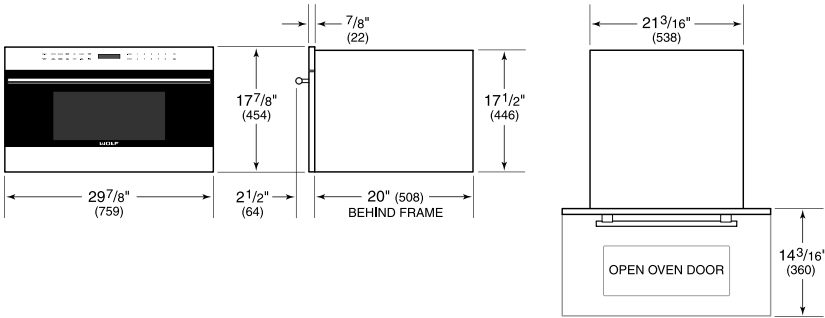

FLUSH INSTALLATION

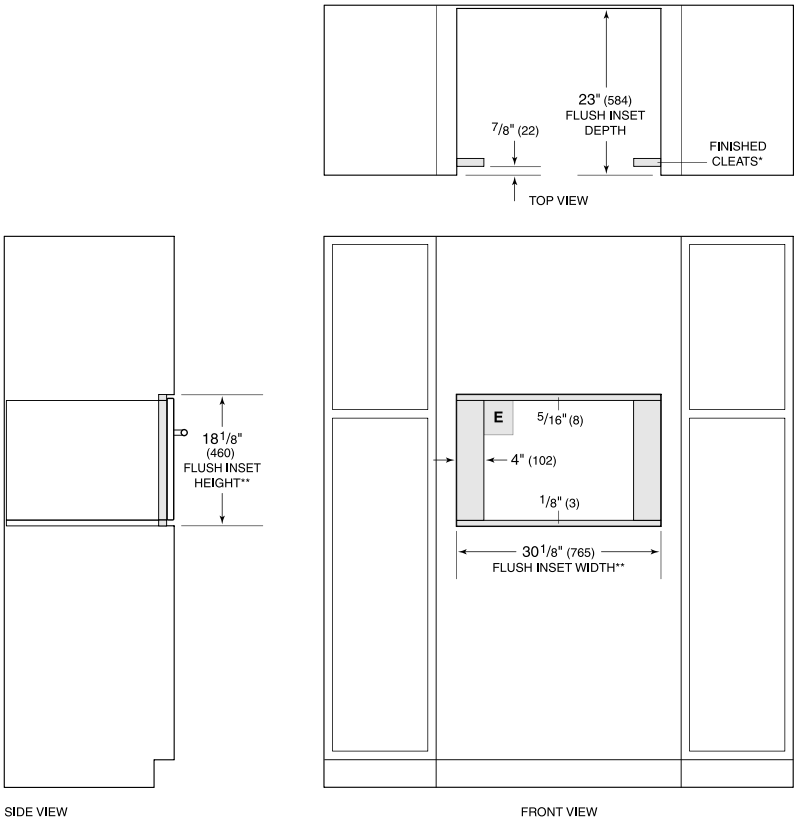

*Will be visible and should be finished to match cabinetry.
**Dimension provides minimum reveals.