



**Model 700BC(I)
Integrated
Refrigerator/Freezer Drawers**

Integrated refrigeration can be used anywhere in the home. It merges seamlessly into the décor, with no visible hinges or grilles. Model 700BC(I) offers refrigerator storage in the upper drawer with freezer storage in the lower drawer. Two temperature zones ensure the freshest food and energy efficiency. Model 700BC(I) features an automatic ice maker.



Features

- Integrated design blends invisibly into custom cabinetry
- Microprocessor offers precise temperature control
- Electronic digital controls
- Flat-to-the-ceiling bright interior lighting
- Open drawer alarm
- Automatic ice maker (Model 700BCI)
- Meets strict Department of Energy requirements

Model Options

	700BC	700BCI
Design	Integrated	Integrated
Automatic Ice Maker		■

Stainless Steel Panels

	Classic	Platinum	Carbon
Model 700BC(I)	■	■	■

Interior Features

- **Refrigerator**
Upper Storage Drawer
Independent Temperature Zone
Removable Crisper Cover
- **Freezer**
Lower Storage Drawer
Independent Temperature Zone
1 Removable Drawer Divider (700BC)
Automatic Defrost
Automatic Ice Maker (700BCI)

Accessories

- Stainless steel drawer panels with tubular handles available in three finishes (see chart above for specifics)
- Polished chrome handles for custom panel applications
- Dozen egg container with lid
- Dual installation heater kit

Accessories are available through your Sub-Zero dealer. To obtain local dealer information, visit the Locator section of our website, subzero.com.



This appliance is certified by Star-K to meet strict religious regulations in conjunction with specific instructions found on www.star-k.org.



Classic



Platinum



Carbon



**Model 700BC(I)
Integrated
Refrigerator/Freezer Drawers**

Overall Dimensions

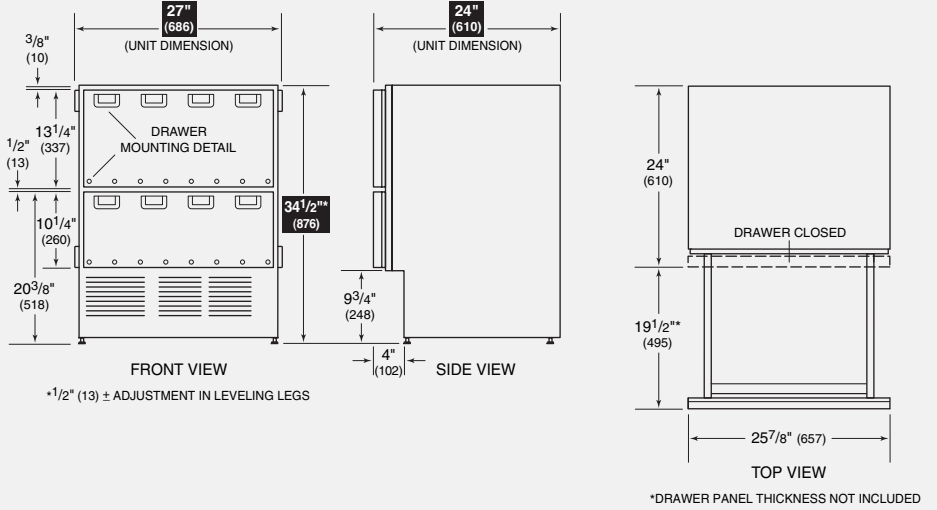

Unit dimensions may vary by ±1/8".

Specifications

Overall Width	27"
Overall Height	34 1/2"
Overall Depth	24"
Drawer Clearance	19 1/2"
Refrigerator Capacity	2.9 cu ft
Freezer Capacity	2.1 cu ft
Opening Width	27"
Opening Height	34 1/2"
Opening Depth	25"*
Electrical Requirements	115 V AC, 60 Hz 15 amp dedicated circuit
Plumbing Requirements (Model 700BCI)	1/4" OD copper line 20–100 psi
Annual Energy Usage	\$41**
Shipping Weight	190 lbs

*Depth is 24" from the front of the unit to its back. Your design may necessitate moving the unit back, or cabinets forward to achieve a flush fit. This will require a minimum opening depth of 25".

**Based on 9.06 cents per kilowatt hour.

Installation Specifications

Models without an ice maker will not require the water line connection.

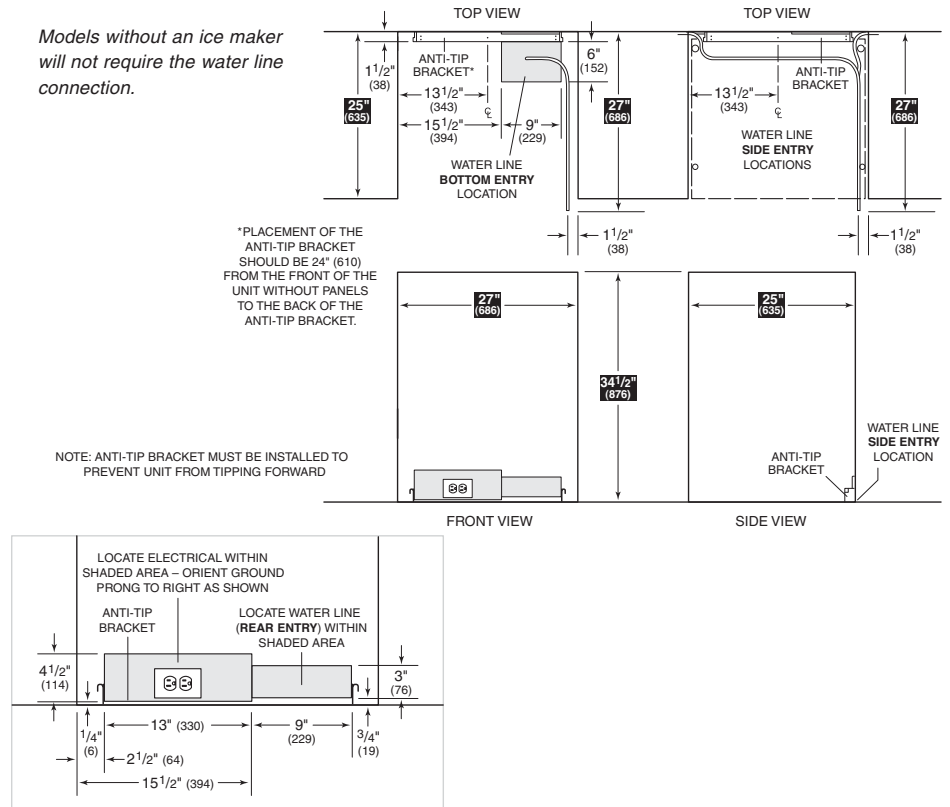

Installation Notes

Stainless steel drawer front panels with handles are available as accessories. These panels are not installed at the factory.

Complete installation specifications, including panel sizes, can be found on our website, subzero.com.

Dimensions in parentheses are in millimeters unless otherwise specified.