

# PRODUCT DIMENSIONS

## TOP VIEW

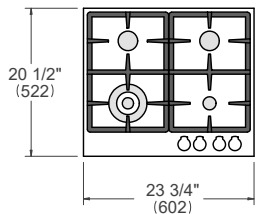

## FRONT VIEW

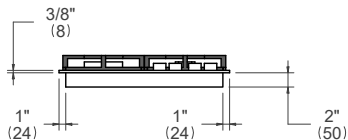

## SIDE VIEW



## ELECTRICAL & GAS CONNECTION

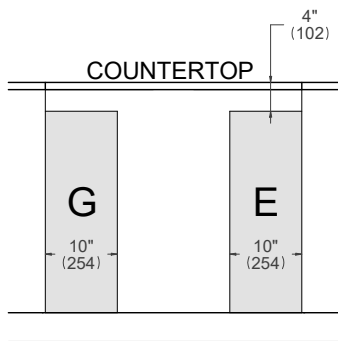

**E** A properly-grounded, horizontally-mounted electrical receptacle should be installed according to this drawing.

**G** An agency-approved, properly-sized manual shut-off valve should be installed according to this drawing.

## INSTALLATION REQUIREMENTS

Combustible material cannot be installed within shaded area.

For installation with an updraft or downdraft hood as well as any OTR, refer to the hood/OTR manufacturer's installation requirements.

## CUTOUT DIMENSIONS

### TOP VIEW

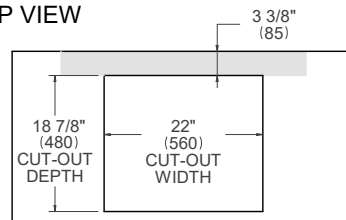

### SIDE VIEW

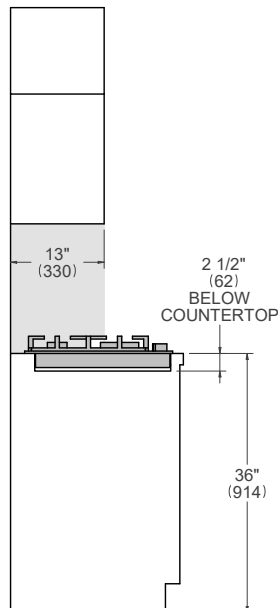

### FRONT VIEW

