



ENGLISH

FRANÇAIS

ESPAÑOL



# OWNER'S MANUAL

# FRENCH DOOR

# REFRIGERATOR

Please read this owner's manual thoroughly before operating and keep it handy for reference at all times.

LFX28995\*\*



# TABLE OF CONTENTS

## 4 PRODUCT FEATURES

---

## 5 IMPORTANT SAFETY INSTRUCTIONS

---

## 8 COMPONENTS

---

8 Refrigerator Exterior

9 Refrigerator Interior

## 10 INSTALLATION

---

10 Installation Overview

10 Specifications

11 - LCD Display

11 - Modem FCC / IC Certification

12 Unpacking Your Refrigerator

12 Choosing the Proper Location

12 - Flooring

13 - Ambient Temperature

13 - Measuring the Clearances

13 Removing/Assembling the Refrigerator Door Handles

14 Removing/Assembling the Freezer Drawer Handle

14 Removing/Assembling the Doors and Drawers

14 - Removing the Left Refrigerator Door

15 - Removing the Right Refrigerator Door

16 - Assembling the Right Refrigerator Door

16 - Assembling the Left Refrigerator Door

17 - Removing the Freezer Drawers

18 - Assembling the Freezer Drawers

19 Connecting the Water Line

19 - Before You Begin

19 - Water Pressure

19 - What You Will Need

20 - Water Line Installation Instructions

22 Turning On the Power

23 Leveling and Door Alignment

23 - Leveling

23 - Door Alignment

## 24 HOW TO USE

---

24 Before Use

25 Control Panel

25 - Control Panel Features

27 In-Door Ice Bin

27 - Detaching the In-Door Ice Bin

27 - Assembling the In-Door Ice Bin

28 Automatic Icemaker

28 - Turning the Automatic Icemaker On or Off

29 - When You Should Turn the Icemaker Off

29 - Normal Sounds You May Hear

29 - Preparing for Vacation

30 Ice and Water Dispenser

30 - Dispenser

30 - Using the Dispenser

30 - Locking the Dispenser

30 - Cleaning the Dispenser Stand

31 Storing Food

31 - Food Preservation Location

32 - Food Storage Tips

32 - Storing Frozen Food

33 Humidity Controlled Crisper and Glide'N'Serve

34 Detaching and Assembling the Storage Bins

36 Adjusting the Refrigerator Shelves

## 37 SMART REFRIGERATOR DISPLAY SCREEN

---

- 37 Before Use
- 37 - Smart Refrigerator display Screen
- 37 - Touch button Function
- 38 - Necessary Installation Parts
- 38 - Note Before Using
- 39 - Downloading The Smart Phone Application
- 39 - Turning the touch screen on or off.
- 40 Home Screen
- 41 Basic button
- 42 Settings
- 42 - Brightness
- 42 - Volume
- 43 - Wireless Network
- 45 - Update
- 47 - Screen Saver
- 48 - Date / Time
- 49 - Zigbee
- 50 - Log In / Reset
- 52 Energy Saving
- 52 - Smart Grid
- 53 - Smart Saving
- 54 Food Manager
- 54 - Frequently used Items
- 56 - Food Manager by Category
- 57 - Food Manager Using Voice Recognition
- 59 - Food Manager Using Keyboard
- 61 - Phone
- 63 - Food List
- 64 - Recipes
- 64 - Grocery
- 65 - Deleting Individual Stored Items
- 65 - Removing All Stored Items
- 66 Recipes
- 67 - Recipes Search
- 68 - Recommended recipes by available items.

- 69 Grocery
- 69 - Phone
- 70 - Remove Grocery
- 71 Food Guide
- 71 - Fruit / Vegetable Lists
- 72 Calendar
- 72 - Creating / Scheduling an event
- 74 - Edit / Delete event
- 75 - Calendar Menu Button
- 76 Memo
- 76 - Creating Memo
- 78 - Delete Memo
- 78 - Save memo to Home Screen
- 79 Photo Album
- 80 - View Photos
- 81 - Saving photo to Home Screen
- 82 Timer
- 82 - Setting the Timer
- 84 Using the Widgets

## 87 MAINTENANCE

---

- 87 Cleaning
- 88 Replacing the Water Filter

## 93 SMART DIAGNOSIS

---

- 93 Using Smart Diagnosis

## 94 TROUBLESHOOTING

---

## 104 WARRANTY

---

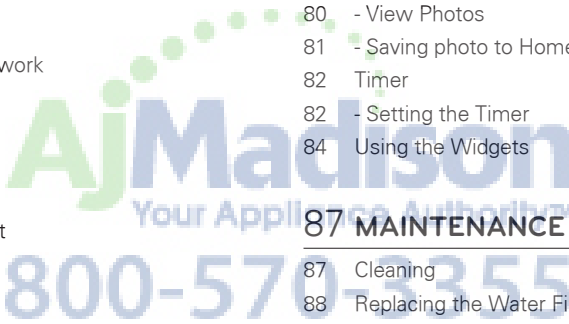

## PRODUCT FEATURES

\* Depending on the model, some of the following functions may not be available.

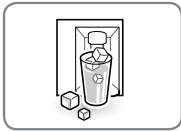

### FILTERED WATER AND ICE DISPENSER

The water dispenser dispenses fresh, chilled water. The ice dispenser dispenses cubed and crushed ice.



### DOOR ALARM

The Door Alarm function is designed to prevent refrigerator malfunctioning that could occur if a refrigerator door or freezer drawer remains open. If a refrigerator door or freezer drawer is left open for more than 60 seconds, a warning alarm sounds in 30 second intervals.



### HUMIDITY CONTROLLED CRISPER

The Humidity Controlled Crisper is designed to help keep your fruits and vegetables fresh and crisp. You can control the amount of humidity in the crisper by adjusting the setting between Low and High.

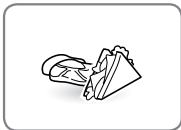

### GLIDE 'N' SERVE

Glide 'N' Serve provides storage space that keeps the compartment colder than the refrigerator.

It is a convenient place to store sandwiches or meat to be cooked.

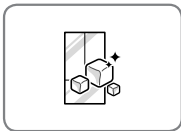

### ICE PLUS

Ice production can be increased by approximately 20 percent when the freezer section is maintained at the coldest temperature for a 24-hour period.

# IMPORTANT SAFETY INSTRUCTIONS

## READ ALL INSTRUCTIONS BEFORE USING THE APPLIANCE.

This guide contains many important safety messages. Always **read and obey** all safety messages.



This is the safety alert symbol. It alerts you to safety messages that inform you of hazards that can kill or hurt you or others, or cause damage to the product.

All safety messages will be preceded by the safety alert symbol and the hazard signal word WARNING or CAUTION. These words mean:



**WARNING** You can be killed or seriously injured if you do not follow instructions.



**CAUTION** Indicates an imminently hazardous situation which, if not avoided, may result in minor or moderate injury, or product damage.



**WARNING**

To reduce the risk of fire, electric shock, or personal injury when using your product, basic safety precautions should be followed, including the following.

### Power

- NEVER unplug your refrigerator by pulling on the power cord. Always grip the plug firmly and pull it straight out from the outlet.
- Immediately repair or replace all power cords that have become frayed or otherwise damaged. Do not use a cord that shows cracks or abrasion damage along its length or at either the plug or connector end.
- Do not use an uncertified power outlet.
- Unplug the power plug immediately in the event of a blackout or thunderstorm.
- Plug in the power plug with the power cord facing downward.

### Installation

- Contact an authorized service center when you install or relocate the refrigerator.
- When moving your refrigerator away from the wall, be careful not to roll over or damage the power cord.
- Connect this product to a dedicated grounded electric outlet conforming with the rating prior to use. It is the user's responsibility to replace a standard 2-prong wall outlet with a standard 3-prong wall outlet.
- Do not install the refrigerator where there may be a danger of falling.

### Use

- DO NOT allow children to climb, stand, or hang on the refrigerator doors or shelves in the refrigerator. They could damage the refrigerator and seriously injure themselves.
- Do not place heavy objects on the dispenser of the refrigerator or hang onto it.
- Do not place heavy or dangerous objects (bottles with liquid) on the refrigerator.
- Do not put live animals inside of the refrigerator.
- Do not allow children to climb into the product when it is in use.
- In the event of a gas leak (propane/LPG), ventilate sufficiently and contact an authorized service center before use. Do not touch or disassemble the electric outlet of the refrigerator.
- In the event of a refrigerant leak, move flammable objects away from the refrigerator. Ventilate sufficiently and contact an authorized service center.
- Do not use or place flammable substances (chemicals, medicine, cosmetics, etc) near the refrigerator or store them inside the refrigerator. Do not place the refrigerator in the vicinity of flammable gas.

**READ ALL INSTRUCTIONS BEFORE USING THE APPLIANCE.**

To reduce the risk of fire, electric shock, or personal injury when using your product, basic safety precautions should be followed, including the following.

- Do not use this product for special purposes (storage of medicine or test materials or for ships, etc).
- Unplug the power plug before cleaning or repairing the refrigerator.
- When you replace the light bulb in the refrigerator, unplug the refrigerator or turn off the power.
- Do not modify or extend the power cord.
- Do not use a dryer to dry the interior. Do not light a candle to remove the interior odor.
- For your safety, this appliance must be properly grounded. Have the wall outlet and the circuit checked by a qualified electrician to make sure the outlet is properly grounded.
- Do not use an outlet that can be turned off with a switch. Do not use an extension cord. It is the user's responsibility to replace a standard 2-prong wall outlet with a standard 3-prong wall outlet.
- Do not, under any circumstances, cut or remove the third (ground) prong from the power cord.
- Do not use an adapter plug and plug the power plug into a multi-outlet extension cord.
- Disconnect the power cord immediately if you hear a noise, smell a strange odor or detect smoke.
- Turn the power off if water or dust penetrates into the refrigerator. Call a service agent.
- Do not disassemble or modify the refrigerator.
- Do not put hands, feet, or metal objects below or behind the refrigerator.
- Do not operate the refrigerator or touch the power cord with wet hands.
- In refrigerators with automatic icemakers, avoid contact with the moving parts of the ejector mechanism or with the heating element that releases the cubes. Do not place fingers or hands on the automatic ice-making mechanism while the refrigerator is plugged in.
- When dispensing ice from the dispenser, do not use crystal ceramics.
- Do not touch the cold surfaces in the freezer compartment with wet or damp hands, when your refrigerator is in operation.
- Do not put glass containers, glass bottles or soda in the freezer.
- This appliance is not intended for use by persons (including children) with reduced physical, sensory or mental capabilities, or lack of experience and knowledge, unless they have been given supervision or instruction concerning the use of the appliance by a person responsible for their safety.
- Do not refreeze frozen food that have thawed completely. It may result in a serious health issue.
- If you are throwing away your old refrigerator, make sure the CFC coolant is removed for proper disposal by a qualified servicer. If you release CFC coolant, you may be fined or imprisoned in accordance with the relevant environmental law.
- Junked or abandoned refrigerators are dangerous, even if they are sitting for only a few days. When disposing the refrigerator, remove the packing materials from the door or take off the doors but leave the shelves in place so that children may not easily climb inside.

**READ ALL INSTRUCTIONS BEFORE USING THE APPLIANCE.**

To reduce the risk of fire, electric shock, or personal injury when using your product, basic safety precautions should be followed, including the following.

 **CAUTION****Installation**

- The refrigerator must be properly installed in accordance with the Installer Instructions that were taped to the front of the refrigerator.
- Be careful when you unpack and install the refrigerator. Immediately dispose of packing materials (plastic) out of reach of children.

**Use**

- Close the door carefully when children are around.
- Keep fingers out of pinch point areas; clearances between the doors and cabinets are necessarily small. Be careful closing doors when children are in the area.
- If you store food properly, beware that it may fall and cause injury.

**Maintenance**

- Do not use strong detergents like wax or thinners for cleaning. Clean with a soft fabric.
- Wipe foreign objects (dust, water, etc) off the prongs of the power plug and contact areas regularly.

**SAVE THESE INSTRUCTIONS**

# COMPONENTS

Use this page to become more familiar with the parts and features of your refrigerator. Page references are included for your convenience.

\*The appearance and specifications of the actual product may differ depending on the model.

## Refrigerator Exterior



## Refrigerator Interior

### LED Interior Lamps

The interior lamps light up the inside of the refrigerator.

### Water Filter

### SpacePlus Ice System

Automatically produces 80-130 ice cubes in a 24-hour period.

### Fixed Door Bins

### Mullion

Folds in when the left door is opened.

### Can Storage Bin

Used to preserve chilled food or drinks.

### Glide'N'Serve

Allows you to store food items at a different temperature than the regular refrigerator area.

### Auto Closing Hinge

The refrigerator doors and freezer drawers close automatically when you push them slightly.

(The door only closes automatically when it is open at an angle of less than 30°.)

### Holder cover

### Smart Diagnosis Speaker

Hold your phone to this speaker when activating Smart Diagnosis. Refer to the Smart Diagnosis section for more details.

### Dairy Product Bin

### Refrigerator Shelves

The shelves in your refrigerator are adjustable to meet your individual storage needs.

### Modular Door Bins

### Crispers

Controls humidity and helps vegetables and fruit to stay crisp.

### Pullout Drawer

### Durabase

### Durabase Divider

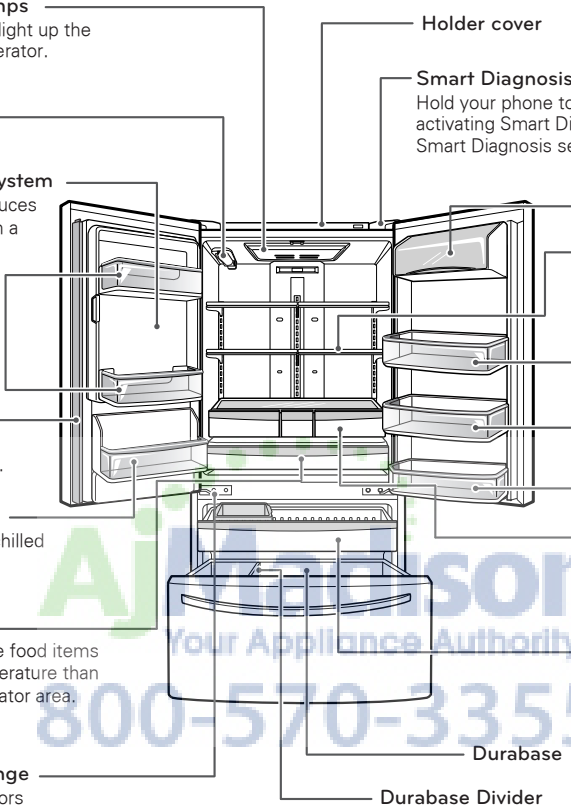

# INSTALLATION

## Installation Overview

Please read the following installation instructions first after purchasing this product or transporting it to another location.

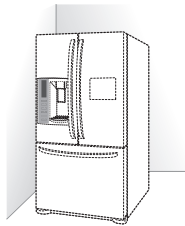

1 Unpacking your refrigerator

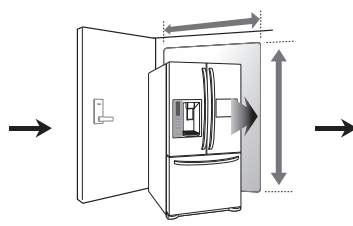

2 Choosing the proper location

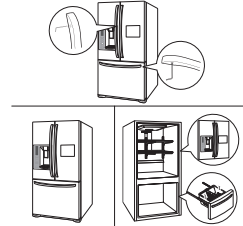

3 Disassembling/Assembling

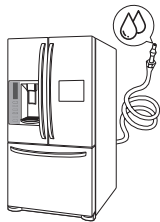

4 Connecting the water supply and water line

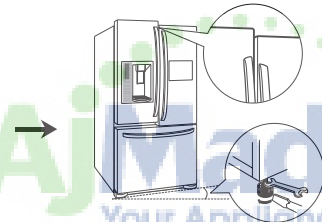

5 Leveling and Door Alignment

Aj Madison  
Your Appliance Authority™  
800-370-3355

## Specifications

The appearance and specifications listed in this manual may vary due to constant product improvements.

Bottom-freezer refrigerator model LFX28995	
Description	French door refrigerator
Electrical requirements	115 VAC @ 60 Hz
Min. / Max. Water pressure	20 - 120 psi (1.4 - 8.4 kgf/cm <sup>2</sup> )
Dimensions	35 3/4" (W) X 35 3/8" (D) X 69 3/4" (H), 47 5/8" (D w/ door open) 908 mm (W) X 899 mm (D) X 1 772 (H), 1 210 mm (D w/ door open)
Net weight	342 lb. (155kg)
Refrigerator storage capacity	18.82 cu. ft.
Freezer storage capacity	8.79 cu. ft.

**LCD Display**

Processor	Telechips (ARM Core)
ROM	2GB
RAM	512MB
LCD	10.1" TFT-LCD (1024 X 600)
Network	802.11 b/g/n

**Modem FCC / IC Certification**

**- Product Specification**

	WLAN (Wi-Fi)	ZigBee
Model	LGHA-WNA1105	LGHA-ZNA1105
Frequency Range	2412 ~ 2462 MHz	2405 ~ 2475 MHz
RF Max Power	802.11b(22.88 dBm)/802.11g(21.65dBm)/ 802.11n(20.67dBm)	18.91dBm
Channel	11	15
Modulation type	CCK/DSSS/OFDM	DSSS

**- U.S. Regulatory Wireless Notice**

This products emits radio frequency energy, but the radiated output power of this device is far below the FCC radio frequency exposure limits. Nevertheless, the device should be used in such a manner that the potential for human contact with the antenna during normal operation is minimized.

**- FCC WARNING:**

This equipment may generate or use radio frequency energy. Changes or modifications to this equipment may cause harmful interference unless the modifications are expressly approved in the instruction manual. The user could lose the authority to operate this equipment if an unauthorized change or modification is made.

**! NOTE**

This device complies with part 15 of the FCC rules.

Operation is subject to the following two conditions :

- (1) This device may not cause harmful interference, and
- (2) This device must accept any interference received, including interference that may cause undesired operation.

This device complies with RSS-210 of the Industry Canada Rules.

Operation is subject to the following two conditions:

- (1) This device may not cause interference and
- (2) This device must accept any interference, including interference that may cause undesired operation of the device.

## Unpacking Your Refrigerator

### WARNING

- Use two or more people to move and install the refrigerator. Failure to do so can result in back or other injury.
- Your refrigerator is heavy. When moving the refrigerator for cleaning or service, be sure to protect the floor. Always pull the refrigerator straight out when moving it. Do not wiggle or walk the refrigerator when trying to move it, as floor damage could occur.
- Keep flammable materials and vapors, such as gasoline, away from the refrigerator. Failure to do so can result in fire, explosion, or death.

Remove tape and any temporary labels from your refrigerator before using. Do not remove any warning-type labels, the model and serial number label, or the Tech Sheet that is located under the front of the refrigerator.

To remove any remaining tape or glue, rub the area briskly with your thumb. Tape or glue residue can also be easily removed by rubbing a small amount of liquid dish soap over the adhesive with your fingers. Wipe with warm water and dry.

Do not use sharp instruments, rubbing alcohol, flammable fluids, or abrasive cleaners to remove tape or glue. These products can damage the surface of your refrigerator.

Refrigerator shelves are installed in the shipping position. Please reinstall shelves according to your individual storage needs.

## Choosing the Proper Location

- Select a place where a water supply can be easily connected for the automatic icemaker.

### NOTE

The water pressure must be between 20 and 120 psi on models without a water filter and between 43 and 121 psi on models with a water filter.

- The refrigerator should always be plugged into its own individual properly grounded electrical outlet rated for 115 Volts, 60 Hz, AC only, and fused at 15 or 20 amperes. This provides the best performance and also prevents overloading house wiring circuits which could cause a fire hazard from overheated wires. It is recommended that a separate circuit serving only this appliance be provided.

### WARNING

To reduce the risk of electric shock, do not install the refrigerator in a wet or damp area.

## Flooring

To avoid noise and vibration, the unit must be leveled and installed on a solidly constructed floor. If required, adjust the leveling legs to compensate for unevenness of the floor. The front should be slightly higher than the rear to aid in door closing. Leveling legs can be turned easily by tipping the cabinet slightly. Turn the leveling legs to the left to raise the unit or to the right to lower it. (See Leveling and door Alignment.)

### NOTE

Installing on carpeting, soft tile surfaces, a platform or weakly supported structure is not recommended.

### Ambient Temperature

Install this appliance in an area where the temperature is between 55°F (13°C) and 110°F (43°C). If the temperature around the appliance is too low or high, cooling ability may be adversely affected.

### Measuring the Clearances

Too small of a distance from adjacent items may result in lowered freezing capability and increased electricity consumption charges. Allow at least 24 inches (61 cm) in front of the refrigerator to open the doors, and at least 2 inches (5.08 cm) between the back of the refrigerator and the wall.

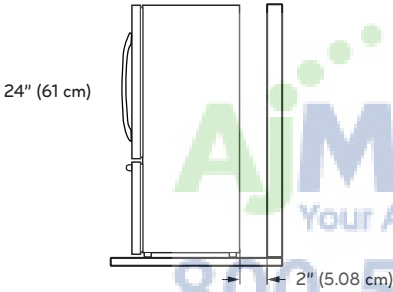

### Removing/Assembling the Refrigerator Door Handles

#### ! NOTE

Removing the doors is always recommended when it is necessary to move the refrigerator through a narrow opening. If it is necessary to remove the handles, follow the directions below.

#### Removing the Handles

- 1 Loosen the set screws **1** with a  $\frac{3}{32}$  in. Allen wrench and remove the handle.
- 2 Loosen the mounting fasteners **2** that connect to the refrigerator door and handle using a  $\frac{1}{4}$  in. Allen wrench, remove the mounting fasteners.

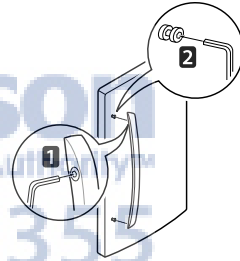

#### Assembling the Handles

- 1 Assemble the mounting fasteners **1** at both ends of the handle using a  $\frac{1}{4}$  in. Allen wrench.
- 2 Place the handle on the door by fitting the handle footprints over the mounting fasteners and tightening the set screws **2** with a  $\frac{3}{32}$  in. Allen wrench.

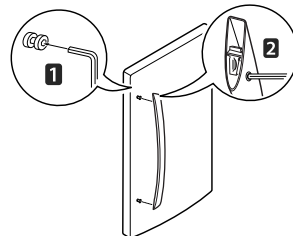

## Removing/Assembling the Freezer Drawer Handle

### Removing the Handles

- 1 Loosen the set screws **1** located on the lower side of the handle with a  $\frac{1}{8}$  in. Allen wrench and remove the handle.
- 2 Loosen the mounting fasteners **2** that connect to the freezer drawer and handle using a  $\frac{1}{4}$  in. Allen wrench, and remove the mounting fasteners.

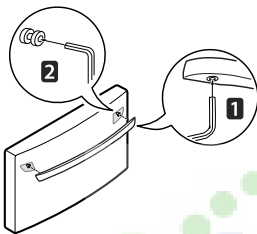

### Assembling the Handles

- 1 Assemble the mounting fasteners **1** at both ends of the handle using a  $\frac{1}{4}$  in. Allen wrench.
- 2 Place the handle on the door by fitting the handle footprints over the mounting fasteners and tightening the set screws **2** with a  $\frac{1}{8}$  in. Allen wrench.

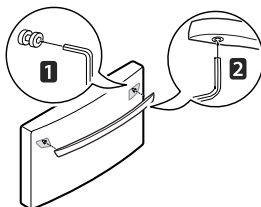

## Removing/Assembling the Doors and Drawers

Removing the doors is always recommended when it is necessary to move the refrigerator through a narrow opening.

### ! WARNING

- If your entrance door is too narrow for the refrigerator to pass through, remove the refrigerator doors and move the refrigerator sideways through the doorway.
- Use two or more people to remove and install the refrigerator doors. Failure to do so can result in back or other injury.
- Disconnect the electrical supply to the refrigerator before installing. Failure to do so could result in serious injury or death.
- Do not put hands, feet or other objects into the air vents or bottom of the refrigerator. You may be injured or receive an electrical shock.
- Be careful when handling the hinge and stopper. It may result in injury.
- Remove food and bins from the doors and drawers before detaching.

### Removing the Left Refrigerator Door

- 1 The water supply is connected to the upper right part of the rear surface of the refrigerator. Remove the ring in the joint area. Hold the water supply connection and gently push the Collet to detach the water supply line as shown in **1** and **2**.

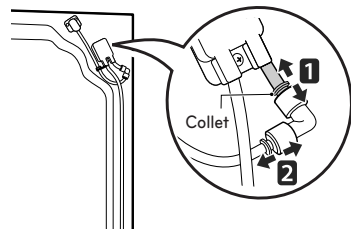

### ! NOTE

Detachment of the water supply line is applicable only when detaching the left refrigerator door.

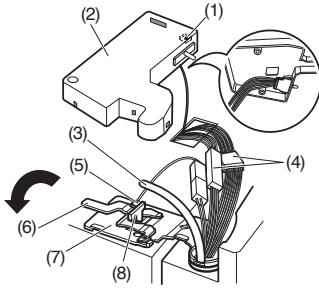

- 2 Open the left door. Remove the top hinge cover screw (1). Lift up the cover (2).
- 3 Remove the cover.
- 4 Pull out the tube (3).
- 5 Disconnect all wire harnesses (4).
- 6 Remove the grounding screw (5).
- 7 Rotate the hinge lever (6) counterclockwise. Lift the top hinge (7) free of the hinge lever latch (8).
- 8 Lift the door from the middle hinge pin and remove the door.
- 9 Place the door, inside facing up, on a non-scratching surface.



**CAUTION**

When lifting the hinge free of the latch, be careful that the door does not fall forward.

**Removing the Right Refrigerator Door**

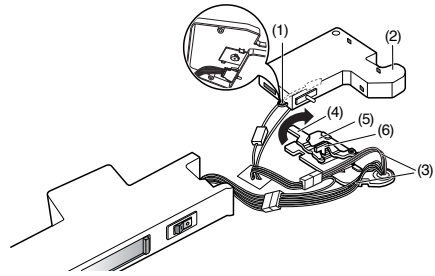

- 1 Open the door. Remove the top hinge cover screw (1). Lift up the cover (2).
- 2 Remove the cover.
- 3 Disconnect all wire harnesses (3).
- 4 Rotate the hinge lever (4) clockwise. Lift the top hinge (5) free of the hinge lever latch (6).
- 5 Lift the door from the middle hinge pin and remove the door.
- 6 Place the door, inside facing up, on a non-scratching surface.



**CAUTION**

When lifting the hinge free of the latch, be careful that the door does not fall forward.

AJ Madison  
 Your Appliance Authority™  
 800-570-3355

## Assembling the Right Refrigerator Door

Install the right-side door first.

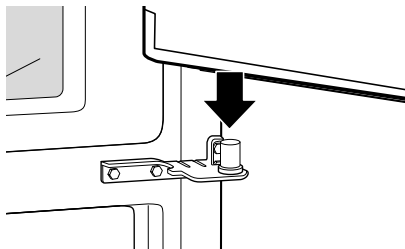

- 1 Lower the door onto the middle hinge pin. Make sure that the plastic sleeve is inserted into the bottom of the door.

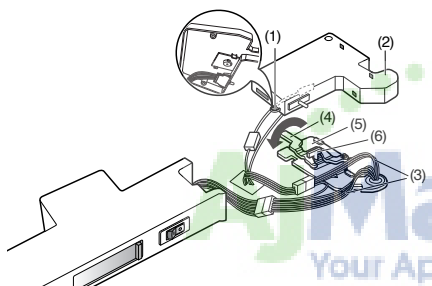

- 2 Fit the top hinge (5) over the hinge lever latch (6) and into place.
- 3 Rotate the lever (4) counterclockwise to secure the hinge.
- 4 Connect the two wire harnesses (3).
- 5 Hook the tabs on the right side of the hinge cover (2) under the edge of the top hinge (5) and position the cover in place.
- 6 Insert and tighten the cover screw (1).

## Assembling the Left Refrigerator Door

Install the left refrigerator door after the right door is installed.

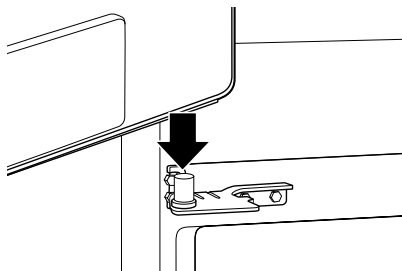

- 1 Lower the door onto the middle hinge pin.

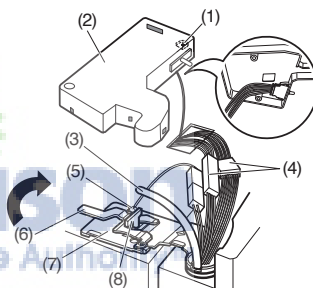

- 2 Fit the top hinge (7) over the hinge lever latch (8) and into place.
- 3 Rotate the lever (6) clockwise to secure the hinge.
- 4 Install the grounding screws (5) and connect the two wire harnesses (4).
- 5 Push the water tube (3) located at the top of the left door into the hole beside the left hinge on the top of the cabinet until it exits through the back.
- 6 Insert the water supply tube (3) into the connector until you see only one scale mark. Fully insert the tub cover (15 mm).
- 7 Hook the tabs on the left side of the hinge cover (1) under the edge of the top hinge (7) and position the cover in place.
- 8 Insert and tighten the cover screw (1).

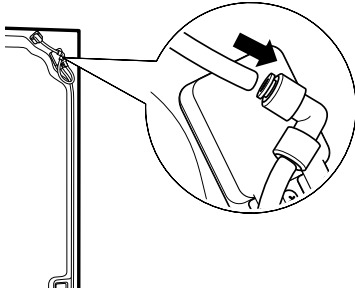

- 9 Insert the water supply tube at least 5/8 in. (15 mm) into the connector.
- 10 Hook the tab on the door switch side of the cover under the edge of the wire opening in the cabinet top.
- 11 Position the cover into place. Insert and tighten the cover screw.

**NOTE**

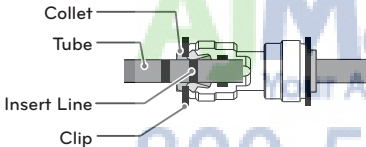

- 1) Gently press the Collet and insert the tube until only one line shows on the tube.

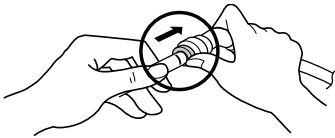

(Correct)

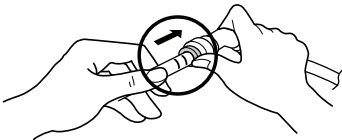

(Incorrect)

- 2) Pull the tube to make sure that the tube is tightly fastened and then insert the clip.

**Removing the Freezer Drawers**

The top, middle and bottom drawers are all removed in the same way. In the following figures, the Pullout Drawer located above the freezer drawer is not shown for clarity.

**CAUTION**

- Use two or more people to remove and install the freezer drawer. Failure to do so can result in back or other injury.
- Do not hold the handle when removing or replacing the drawer. The handle may come off and it could cause personal injury.
- Be careful of sharp hinges on both sides of the drawer.
- When you lay the drawer down, be careful not to damage the floor.
- Do not sit or stand on the freezer drawer.
- To prevent accidents, keep children and pets away from the drawer. Do not leave the drawer open.

- 1 Fully extend the freezer drawer. Lifting up and out to remove the Dura Base basket making sure to clear the rail system.

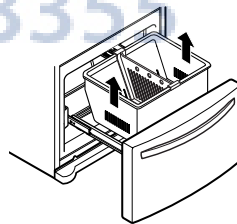

- 2 Remove one white screw ① on each side of the rails assembly.

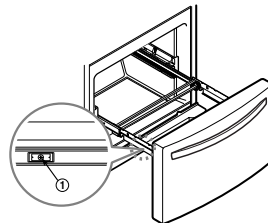

- 3 With both hands, grasp the sides of the door and pull it up to separate it from the rails.

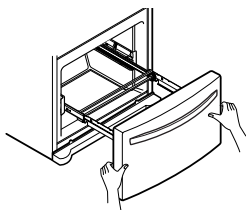
**CAUTION**

When you remove the drawer, do not hold the handle. The handle may come off and it could cause personal injury.

- 2 Hook the door support ① into the rail tabs ② on both sides.

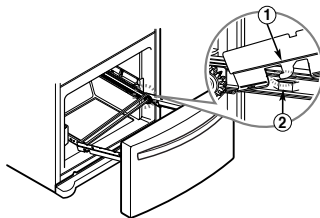

- 3 Lower door into final position and tighten the screws.

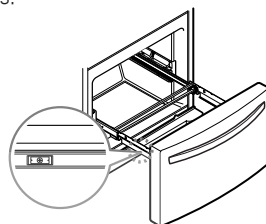

- 4 With both hands, hold each rail and push it in to allow both rails to slide in simultaneously.

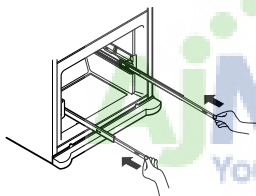

- 4 With the drawer pulled out to full extension, insert the lower basket in the rail assembly.

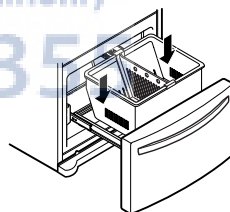
**Assembling the Freezer Drawer**

- 1 With both hands, pull out each rail simultaneously until both rails are fully extended.

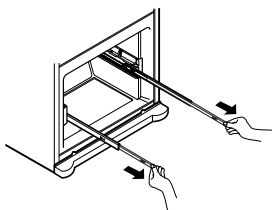
**WARNING**

- If the Durabase divider is removed, there is enough open space for children or pets to crawl inside. To prevent accidental child and pet entrapment or suffocation risk, **DO NOT** allow them to touch or go near the freezer drawer.
- **DO NOT** step or sit down on freezer drawer.

## Connecting the Water Line

### Before You Begin

This water line installation is not covered by the refrigerator warranty. Follow these instructions carefully to minimize the risk of expensive water damage.

Water hammer (water banging in the pipes) in house plumbing can cause damage to refrigerator parts and can lead to water leakage or flooding. Call a qualified plumber to correct water hammer before installing the water supply line to the refrigerator.



#### CAUTION

To prevent burns and product damage, only connect the refrigerator water line to a cold water supply.

If you use your refrigerator before connecting the water line, make sure the icemaker power switch is in the OFF (O) position.



#### CAUTION

Do not install the icemaker tubing in areas where temperatures fall below freezing.

### Water Pressure

A cold water supply. The water pressure must be between 20 and 120 psi on models without a water filter and between 43 and 121 psi on models with a water filter.

If a reverse osmosis water filtration system is connected to your cold water supply, this water line installation is not covered by the refrigerator warranty. Follow the following instructions carefully to minimize the risk of expensive water damage.

If a reverse osmosis water filtration system is connected to your cold water supply, the water pressure to the reverse osmosis system needs to be a minimum of 40 to 60 psi (2.8 kgf/cm<sup>2</sup> ~ 4.2 kgf/cm<sup>2</sup>, less than 2.0~3.0 sec. to fill a cup of 7 oz capacity).



#### CAUTION

Wear eye protection during installation to prevent injury.

If the water pressure from the reverse osmosis system is less than 21 psi or 1.5 kgf/cm<sup>2</sup> (takes more than 4.0 sec to fill a cup of 7 oz capacity):

- Check to see if the sediment filter in the reverse osmosis system is blocked. Replace the filter if necessary.
- Allow the storage tank on the reverse usage.
- If the issue concerning water pressure from reverse osmosis remains, call a licensed, qualified plumber.
- All installations must be in accordance with local plumbing code requirements.

### What You Will Need

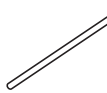
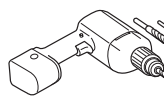
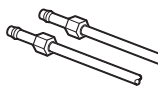
- **Copper Tubing**, ¼ in. outer diameter, to connect the refrigerator to the water supply. Be sure both ends of the tubing are cut square. 
- To determine how much tubing you need: measure the distance from the water valve on the back of the refrigerator to the water supply pipe. Then, add 8 feet (2.4 m). Be sure there is sufficient extra tubing (about 8 feet [2.4 m] coiled into 3 turns of about 10 in. [25 cm] diameter) to allow the refrigerator to move out from the wall after installation.
- **Power drill.**
- **½ in. or adjustable wrench.** 
- **Flat blade and Phillips head screwdrivers.**
- **Two ¼ in. outer diameter compression nuts and 2 ferrules (sleeves)** to connect the copper tubing to the shutoff valve and the refrigerator water valve. 

- If your existing copper water line has a flared fitting at the end, you will need an **adapter** (available at plumbing supply stores) to connect the water line to the refrigerator OR you can cut off the flared fitting with a tube cutter and then use a compression fitting.

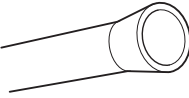

- **Shutoff valve to connect to the cold water line.** The shutoff valve should have a water inlet with a minimum inside diameter of 5/32 in. at the point of connection to the COLD WATER LINE. Saddle-type shutoff valves are included in many water supply kits. Before purchasing, make sure a saddle-type valve complies with your local plumbing codes.

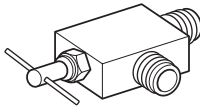

**NOTE**

A self piercing saddle type water valve should not be used.

**Water Line Installation Instructions**

**WARNING**

When using any electrical device (such as a power drill) during installation, be sure the device is battery powered, double insulated or grounded in a manner that will prevent the hazard of electric shock.

Install the shutoff valve on the nearest frequently used drinking water line.

- 1 SHUT OFF THE MAIN WATER SUPPLY  
Turn on the nearest faucet to relieve the pressure on the line.

- 2 CHOOSE THE VALVE LOCATION

Choose a location for the valve that is easily accessible. It is best to connect into the side of a vertical water pipe. When it is necessary to connect into a horizontal water pipe, make the connection to the top or side, rather than at the bottom, to avoid drawing off any sediment from the water pipe.

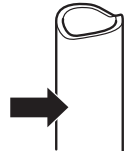

- 3 DRILL THE HOLE FOR THE VALVE

Drill a 1/4 in. hole in the water pipe using a sharp bit. Remove any burrs resulting from drilling the hole in the pipe. Be careful not to allow water to drain into the drill. Failure to drill a 1/4 in. hole may result in reduced ice production or smaller cubes.

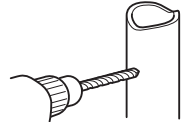

**NOTE**

The hookup line cannot be white, plastic tubing. Licensed plumbers must use only copper tubing NDA tubing #49595 or 49599 or Cross Link Polyethylene (PEX) tubing.

4 FASTEN THE SHUTOFF VALVE

Fasten the shutoff valve to the cold water pipe with the pipe clamp.

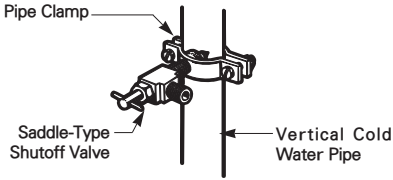

**NOTE**

Commonwealth of Massachusetts Plumbing Codes 248CMR shall be adhered to. Saddle valves are illegal and use is not permitted in Massachusetts. Consult with your licensed plumber.

5 TIGHTEN THE PIPE CLAMP

Tighten the clamp screws until the sealing washer begins to swell.

**NOTE:** Do not overtighten clamp or you may crush the tubing.

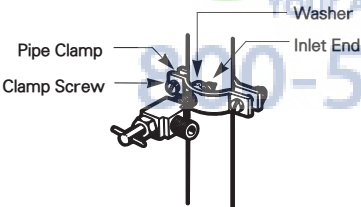

6 ROUTE THE TUBING

Route the tubing between the cold water line and the refrigerator.

Route the tubing through a hole drilled in the wall or floor (behind the refrigerator or adjacent base cabinet) as close to the wall as possible.

**NOTE**

Be sure there is sufficient extra tubing (about 8 feet coiled into 3 turns of about 10 in. diameter) to allow the refrigerator to move out from the wall after installation.

7 CONNECT THE TUBING TO THE VALVE

Place the compression nut and ferrule (sleeve) for copper tubing onto the end of the tubing and connect it to the shutoff valve. Make sure the tubing is fully inserted into the valve. Tighten the compression nut securely.

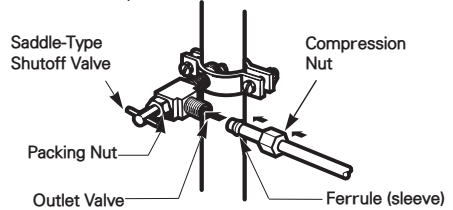

8 FLUSH OUT THE TUBING

Turn the main water supply on and flush out the tubing until the water is clear.

Shut the water off at the water valve after about one quart of water has been flushed through the tubing.

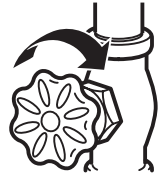

9 CONNECT THE TUBING TO THE REFRIGERATOR

**NOTE:** Before making the connection to the refrigerator, be sure that the refrigerator power cord is not plugged into the wall outlet.

- Remove the plastic flexible cap from the water valve.
- Place the compression nut and ferrule (sleeve) onto the end of the tubing as shown.
- Insert the end of the copper tubing into the connection as far as possible. While holding the tubing, tighten the fitting.

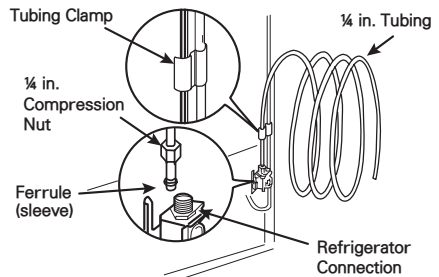

## 10 TURN THE WATER ON AT THE SHUTOFF VALVE

Tighten any connections that leak.

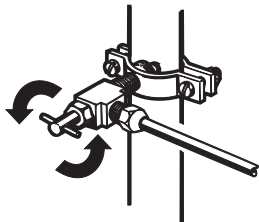

### CAUTION

Check to see if leaks occur at the water line connections.

## 11 PLUG IN THE REFRIGERATOR

Arrange the coil of tubing so that it does not vibrate against the back of the refrigerator or against the wall. Push the refrigerator back to the wall.

## Turning On The Power

- 1 Plug in the refrigerator.

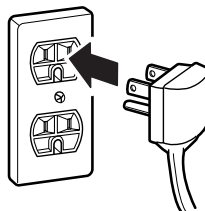

### CAUTION

- Connect to a rated power outlet.
- Have a certified electrician check the wall outlet and wiring for proper grounding.
- Do not damage or cut off the ground terminal of the power plug.

## 12 START THE ICEMAKER

Set the icemaker power switch to the **ON** position.

The icemaker will not begin to operate until it reaches its operating temperature of 15°F (-9°C) or below. It will then begin operation automatically if the icemaker power switch is in the **ON (I)** position.

**AjMadison**  
Your Appliance Authority™  
800-570-3355

## Leveling and Door Alignment

### Leveling

After installing, plug the refrigerator's power cord into a 3-prong grounded outlet and push the refrigerator into the final position.

Your refrigerator has two front leveling legs—one on the right and one on the left. Adjust the legs to alter the tilt from front-to-back or side-to-side. If your refrigerator seems unsteady, or you want the doors to close more easily, adjust the refrigerator's tilt using the instructions below:

- 1 Remove the base grille. Refer to the Base Grille Installation section.
- 2 Turn the leveling leg to the left to raise that side of the refrigerator or to the right to lower it. It may take several turns of the leveling leg to adjust the tilt of the refrigerator.

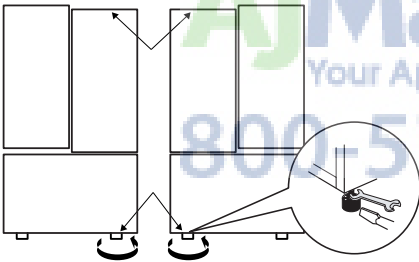

#### NOTE

A flare nut wrench works best, but an open-end wrench will suffice. Do not over-tighten.

- 3 Open both doors again and check to make sure that they close easily. If the doors do not close easily, tilt the refrigerator slightly more to the rear by turning both leveling legs to the left. It may take several more turns, and you should turn both leveling legs the same amount.
- 4 Replace the base grille.

### Door Alignment

Both the left and right refrigerator doors have an adjustable nut, located on the bottom hinge, to raise and lower them to align properly. If the space between your doors is uneven, follow the instructions below to align the doors evenly:

Use the wrench (included with the Owner's Manual) to turn the nut in the door hinge to adjust the height. To the right to raise or to the left to lower the height.

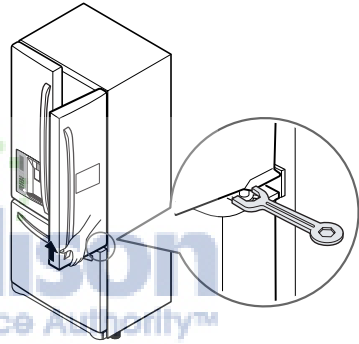

# HOW TO USE

## Before use



### Clean the refrigerator.

Clean your refrigerator thoroughly and wipe off all dust that accumulated during shipping.

#### ⚠ CAUTION

- Do not scratch the refrigerator with a sharp object or use a detergent that contains alcohol, a flammable liquid or an abrasive when removing any tape or adhesive from the refrigerator.
- Do not peel off the model or serial number label or the technical information on the rear surface of the refrigerator.

#### ⚠ NOTE

Remove adhesive residue by wiping it off with your thumb or dish detergent.

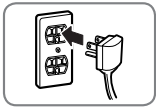

### Connect the power supply.

Check if the power supply is connected before use.  
Read the "Turning On The Power" section.

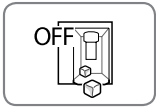

### Turn off the icemaker if the refrigerator is not yet connected to the water supply.

Turn off the automatic icemaker and then plug the power plug of the refrigerator into the grounded electric outlet.

\* This is applicable only to certain models.

#### ⚠ CAUTION

Running the automatic icemaker before connecting it to the water supply may cause the refrigerator to malfunction.

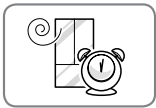

### Wait for the refrigerator to cool.

Allow your refrigerator to run for at least two to three hours before putting food in it. Check the flow of cold air in the freezer compartment to ensure proper cooling.

#### ⚠ CAUTION

Putting food in the refrigerator before it has cooled could cause the food to spoil, or a bad odor could remain inside the refrigerator.

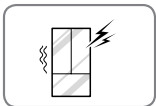

### The refrigerator makes a loud noise after initial operation.

This is normal. The loudness will decrease as the temperature lowers.

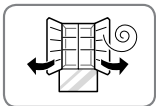

### Open refrigerator doors and freezer drawers to ventilate the interior.

The inside of the refrigerator may smell like plastic at first. Remove any adhesive tape from inside the refrigerator and open the refrigerator doors and the freezer drawers for ventilation.

## Control Panel

\* Depending on the model, some of the following functions may not be available.

### Control Panel Features

The LED Display shows the temperature settings, dispenser options, water filter, door alarm, and locking status messages.

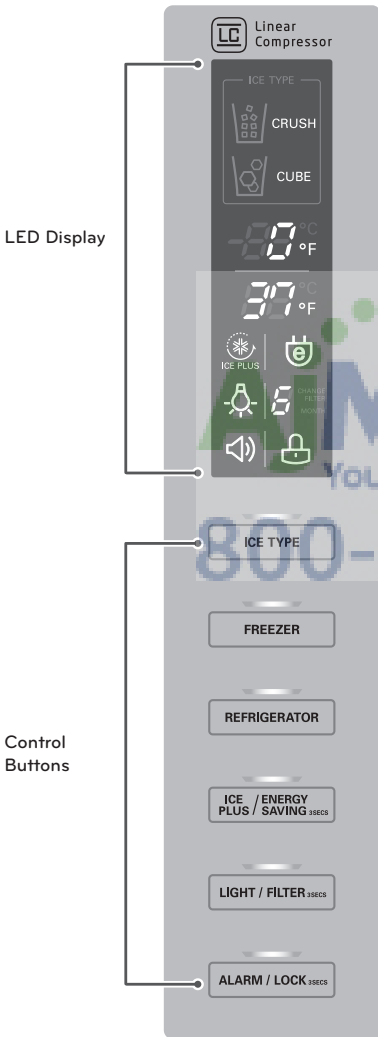

Press the ICE TYPE button to select either Crushed or Cubed Ice. The selected option will illuminate on the LED display.



Press the FREEZER button to adjust the temperature in the freezer compartment.



#### NOTE

To change the display from Fahrenheit to Celsius, press and hold the FREEZER and REFRIGERATOR button for five seconds.



Press the REFRIGERATOR button to adjust the temperature in the freezer compartment.



This function increases both ice making and freezing capabilities.

- When you touch the Ice Plus button, the graphic will illuminate in the display and will continue for 24 hours. The function will automatically shut off after 24 hours.
- You can stop this function manually by touching the button one more time.

## Control Panel Features (continued)

### Energy Saving

The Energy Saving function disables the mullion heater located on the refrigerator door in order to conserve electricity. Press and hold the Energy Saving button for three seconds to activate or deactivate this function.

#### NOTE

Discontinue using the Energy Saving function if excessive moisture begins to collect on the door mullion.

### Light

Press the LIGHT button, to turn on the dispenser light. The indicator will appear on the LED display.

### Change Filter

When the water filter indicator turns on, you have to change the water filter. After changing the water filter, press and hold the FILTER button for three seconds to turn the indicator light off. You need to change the water filter approximately every six months.

### Alarm

- When power is connected to the refrigerator, the door alarm is initially set to ON. When you press the ALARM button, the display will change to OFF and the Alarm function will deactivate.
- When either the refrigerator or the freezer door is left open for more than 60 seconds, the alarm tone will sound to let you know that the door is open.
- When you close the door, the door alarm will stop.

### Control Lock

The Control Lock function disables every other button on the display.

- When power is initially connected to the refrigerator, the Lock function is off.
- If you want to activate the Lock function to lock other buttons, press and hold the Lock button for three seconds or more. The Lock icon will display and the Lock function is now enabled.
- To disable the Lock function, press and hold the Lock button for approximately three seconds.

#### CAUTION

##### Display Mode (For Store Use Only)

The Display Mode disables all cooling in the refrigerator and freezer sections to conserve energy while on display in a retail store. When activated, OFF will display on the control panel.

##### To deactivate:

With either refrigerator door opened, press and hold the Refrigerator and Ice Plus buttons at the same time for five seconds. The control panel will beep and the temperature settings will display to confirm that Display Mode is deactivated. Use the same procedure to activate the Display Mode.

## In-Door Ice Bin

\* Depending on the model, some of the following functions may not be available.



### CAUTION

- Keep hands and tools out of the ice compartment door and dispenser chute. Failure to do so may result in damage or personal injury.
- The icemaker will stop producing ice when the in-door ice bin is full. If you need more ice, empty the ice bin into the extra ice bin in the freezer compartment. During use, the ice can become uneven causing the icemaker to misread the amount of ice cubes and stop producing ice. Shaking the ice bin to level the ice within it can reduce this problem.
- Storing cans or other items in the ice bin will damage the icemaker.
- Keep the ice compartment door closed tightly. If the ice compartment door is not closed tightly, the cold air in the ice bin will freeze food in the refrigerator compartment. This could also cause the icemaker to stop producing ice.
- If the ON/OFF switch on the icemaker is set to OFF for an extended period of time, the ice compartment will gradually warm up to the temperature of the refrigerator compartment. To prevent ice cubes from melting and leaking from the dispenser, ALWAYS empty the ice bin when the icemaker is set to OFF for more than a few hours.

- 2 To remove the in-door ice bin, grip the front handle, slightly lift the lower part, and slowly pull out the bin as shown.

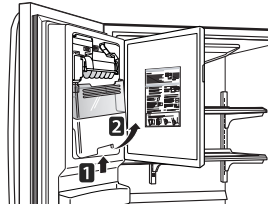

## Assembling the In-Door Ice Bin

- 1 Carefully insert the in-door ice bin while slightly slanting it to avoid contact with the icemaker.

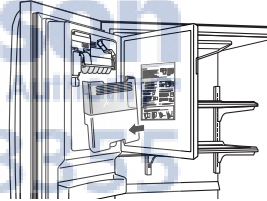

- 2 Avoid touching the ice-detecting sensor when replacing the ice bin. See the label on the ice compartment door for details.

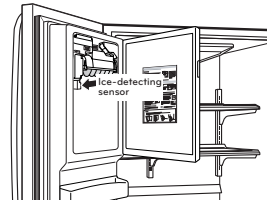

## Detaching the In-Door Ice Bin

- 1 Gently pull the handle to open the ice compartment.

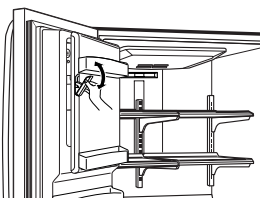

### CAUTION

When handling the ice bin, keep hands away from the icemaker tray area to avoid personal injury.



## Automatic Icemaker

\* Depending on the model, some of the following functions may not be available.

Ice is made in the automatic icemaker and sent to the dispenser. The icemaker will produce 12 cubes per cycle—approximately 120 cubes in a 24-hour period, depending on freezer compartment temperature, room temperature, number of door openings and other operating conditions.

- It takes about 12 to 24 hours for a newly installed refrigerator to begin making ice. Wait 72 hours for full ice production to occur.
- Ice making stops when the in-door ice bin is full. When full, the in-door ice bin holds approximately 6 to 8 (12-16 oz) glasses of ice.
- The water pressure must be between 20 and 120 psi on models without a water filter and between 43 and 121 psi on models with a water filter to produce the normal amount and size of ice cubes.
- Foreign substances or frost on the ice-detecting sensor can interrupt ice production. Make sure the sensor area is clean at all times for proper operation.

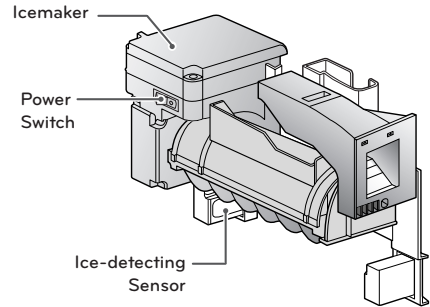

### Turning the Automatic Icemaker On or Off

To turn off the automatic icemaker, set the icemaker switch to **OFF (O)**. To turn on the automatic icemaker, set the switch to **ON (I)**.

**Madison**  
Your Appliance Authority™  
800-570-3355

## Automatic Icemaker (continued)



### CAUTION

- The first ice and water dispensed may include particles or odor from the water supply line or the water tank.
- Throw away the first few batches of ice (about 24 cubes). This is also necessary if the refrigerator has not been used for a long time.
- Never store beverage cans or other items in the ice bin for the purpose of rapid cooling. Doing so may damage the icemaker or the containers may burst.
- If discolored ice is dispensed, check the water filter and water supply. If the problem continues, contact a Sears or other qualified service center. Do not use the ice or water until the problem is corrected.
- Keep children away from the dispenser. Children may play with or damage the controls.
- The ice passage may become blocked with frost if only crushed ice is used. Remove the frost that accumulates by removing the ice bin and clearing the passage with a rubber spatula. Dispensing cubed ice can also help prevent frost buildup.
- Never use thin crystal glass or crockery to collect ice. Such containers may chip or break resulting in glass fragments in the ice.
- Dispense ice into a glass before filling it with water or other beverages. Splashing may occur if ice is dispensed into a glass that already contains liquid.
- Never use a glass that is exceptionally narrow or deep. Ice may jam in the ice passage and refrigerator performance may be affected.
- Keep the glass at a proper distance from the ice outlet. A glass held too close to the outlet may prevent ice from dispensing.
- To avoid personal injury, keep hands out of the ice door and passage.
- Never remove the dispenser cover.
- If ice or water dispenses unexpectedly, turn off the water supply and contact a qualified service center.

## When You Should Turn the Icemaker Off

- When the water supply will be shut off for several hours.
- When the ice bin is removed for more than one or two minutes.
- When the refrigerator will not be used for several days.



### NOTE

The ice bin should be emptied when the icemaker on/off switch is turned to the OFF position.

## Normal Sounds You May Hear

- The icemaker water valve will buzz as the icemaker fills with water. If the power switch is in the ON (I) position, it will buzz even if it has not yet been hooked up to water. To stop the buzzing, move the power switch to OFF (O).



### NOTE

Keeping the power switch in the ON (I) position before the water line is connected can damage the icemaker.

- You will hear the sound of cubes dropping into the bin and water running in the pipes as the icemaker refills.

## Preparing For Vacation

Set the icemaker power switch to OFF (O) and shut off the water supply to the refrigerator.



### NOTE

The ice bin should be emptied anytime the icemaker on/off switch is turned to the OFF (O) position.

If the ambient temperature will drop below freezing, have a qualified technician drain the water supply system to prevent serious property damage due to flooding caused by ruptured water lines or connections.

## Ice and Water Dispenser

\* Depending on the model, some of the following functions may not be available.



### CAUTION

Keep children away from the dispenser. Children may play with or damage the controls.

## Dispenser

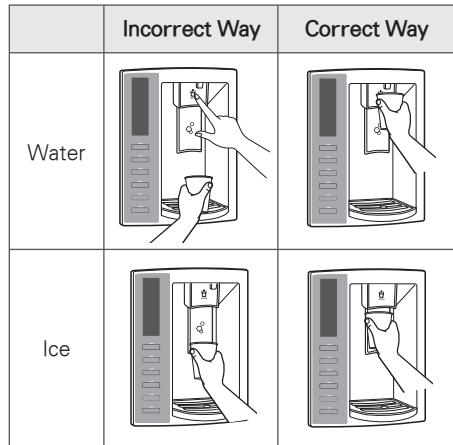
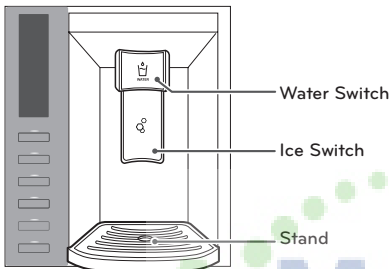

### CAUTION

Throw away the first few batches of ice (about 24 cubes). This is also necessary if the refrigerator has not been used for a long time.

## Using the Dispenser

- To dispense **cold water**, push on the water switch with a glass.
- To dispense **ice**, push on the ice switch with a glass.



### NOTE

- If discolored ice is dispensed, check the water filter and water supply. If the problem continues, contact a qualified service center. Do not use the ice or water until the problem is corrected.
- The dispenser will not operate when either of the refrigerator doors are open.
- If dispensing water or ice into a container with a small opening, place it as close to the dispenser as possible.
- Some dripping may occur after dispensing. Hold your cup beneath the dispenser for a few seconds after dispensing to catch all of the drops.

## Locking the Dispenser

Press and hold the Alarm and Lock button simultaneously for 3 seconds to lock the dispenser and all the control panel functions. Follow the same instructions to unlock.

## Cleaning the Dispenser Stand

- 1 Grip the stand with both hands and pull it out.

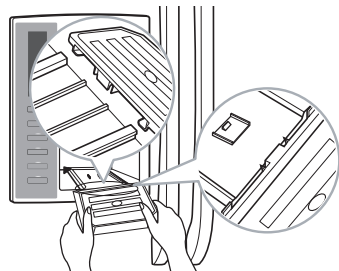

- 2 Wipe out dirty areas with a clean cloth.

## Storing Food

### Food Preservation Location

Each compartment inside the refrigerator is designed to store different types of food. Store your food in the optimal space to enjoy the freshest taste.



**Adjustable refrigerator shelf**  
Adjustable shelves to meet your individual storage needs.



**Vegetable storage (Crisper)**  
Preserves vegetables and fruit.



**Durabase®**  
Largest storage space in the freezer.

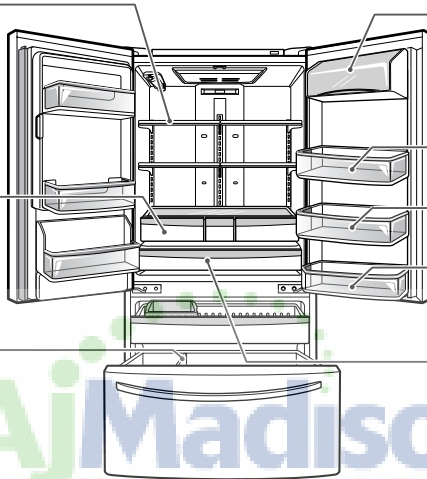

**Dairy product bin**  
Store milk products such as butter and cheese.



**Gallon Storage Bin**  
Store drinks such as juice and soda, as well as seasonings, salad dressings and other food items.



**Glide 'N' Serve**  
Provides storage space that keeps the compartment at a different temperature than the refrigerator. It is a convenient place to store sandwiches or meat to be cooked.

**AjMadiso**  
Your Appliance Authority  
800-570-3355



### CAUTION

- Do not store food with high moisture content towards the top of the refrigerator. The moisture could come in direct contact with the cold air and freeze.
- Wash food before storing it in the refrigerator. Vegetables and fruit should be washed, and food packaging should be wiped down to prevent adjacent foods from being contaminated.
- If the refrigerator is kept in a hot and humid place, frequent opening of the door or storing a lot of vegetables in the refrigerator may cause condensation to form. Wipe off the condensation with a clean cloth or a paper towel.
- If the refrigerator door or freezer drawer is opened or closed too often, warm air may penetrate the refrigerator and raise its temperature. It can also increase the cost of electricity.



### NOTE

- If you are leaving home for a short period of time, like a short vacation, the refrigerator should be left on. Refrigerated foods that are able to be frozen will stay preserved longer if stored in the freezer.
- If you are leaving the refrigerator turned off for an extended period of time, remove all food and unplug the power cord. Clean the interior, and leave the door open to prevent fungi from growing in the refrigerator.

## Food Storage Tips

\* The following tips may not be applicable depending on the model.

Wrap or store food in the refrigerator in airtight and moisture-proof material unless otherwise noted. This prevents food odor and taste transfer throughout the refrigerator. For dated products, check date code to ensure freshness.

Food	How to
<b>Butter or Margarine</b>	Keep opened butter in a covered dish or closed compartment. When storing an extra supply, wrap in freezer packaging and freeze.
<b>Cheese</b>	Store in the original wrapping until you are ready to use it. Once opened, rewrap tightly in plastic wrap or aluminum foil.
<b>Milk</b>	Wipe milk cartons. For best storage, place milk on interior shelf, not on door shelf.
<b>Eggs</b>	Store in original carton on interior shelf, not on door shelf.
<b>Fruit</b>	Do not wash or hull the fruit until it is ready to be used. Sort and keep fruit in its original container, in a crisper, or store in a completely closed paper bag on a refrigerator shelf.
<b>Leafy Vegetables</b>	Remove store wrapping and trim or tear off bruised and discolored areas. Wash in cold water and drain. Place in plastic bag or plastic container and store in crisper.
<b>Vegetables with skins (carrots, peppers)</b>	Place in plastic bags or plastic container and store in crisper.
<b>Fish</b>	Store fresh fish and shellfish in the freezer section if they are not being consumed the same day of purchase. It is recommended to consume fresh fish and shellfish the same day purchased.
<b>Leftovers</b>	Cover leftovers with plastic wrap, aluminum foil, or plastic containers with tight lids.

## Storing Frozen Food

### ! NOTE

Check a freezer guide or a reliable cookbook for further information about preparing food for freezing or food storage times.

## Freezing

Your freezer will not quick-freeze a large quantity of food. Do not put more unfrozen food into the freezer than will freeze within 24 hours (no more than 2 to 3 lbs. of food per cubic foot of freezer space). Leave enough space in the freezer for air to circulate around packages. Be careful to leave enough room at the front so the door can close tightly.

Storage times will vary according to the quality and type of food, the type of packaging or wrap used (how airtight and moisture-proof) and the storage temperature. Ice crystals inside a sealed package are normal. This simply means that moisture in the food and air inside the package have condensed, creating ice crystals.

### ! NOTE

Allow hot foods to cool at room temperature for 30 minutes, then package and freeze. Cooling hot foods before freezing saves energy.

## Storing Frozen Food (continued)

### Packaging

Successful freezing depends on correct packaging. When you close and seal the package, it must not allow air or moisture in or out. If it does, you could have food odor and taste transfer throughout the refrigerator and could also dry out frozen food.

### Packaging recommendations:

- Rigid plastic containers with tight-fitting lids
- Straight-sided canning/freezing jars
- Heavy-duty aluminum foil
- Plastic-coated paper
- Non-permeable plastic wraps
- Specified freezer-grade self-sealing plastic bags

Follow package or container instructions for proper freezing methods.

### Do not use

- Bread wrappers
- Non-polyethylene plastic containers
- Containers without tight lids
- Wax paper or wax-coated freezer wrap
- Thin, semi-permeable wrap

## Humidity Controlled Crisper and Glide'N'Serve

### Humidity Controlled Crisper

\* Depending on the model, some of the following functions may not be available.

The crispers provide fresher tasting fruit and vegetables by letting you easily control humidity inside the drawer.

You can control the amount of humidity in the moisture-sealed crispers by adjusting the control to any setting between **HIGH** and **LOW**.

- **HIGH** keeps moist air in the crisper for best storage of fresh, leafy vegetables.
- **LOW** lets moist air out of the crisper for best storage of fruit.

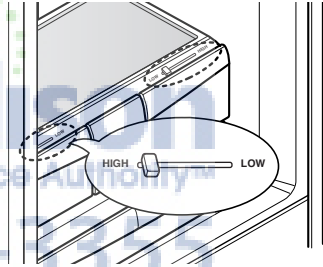

### Glide'N'Serve

The Glide'N'Serve provides storage space with a variable temperature control that keeps the compartment colder than refrigerator. This drawer can be used for large party trays, deli items, or beverages.

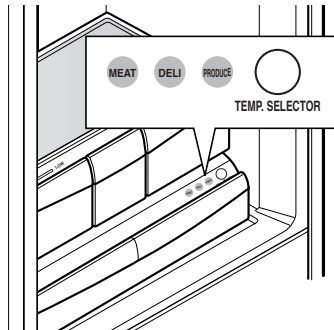

## Humidity Controlled Crisper and Glide'N'Serve (continued)

### Selection Button

- When "MEAT" is selected, the temperature of the Glide'N'Serve can be kept around 34°F (1°C). This feature helps keep meat or fish fresh for a longer time. The Glide'N'Serve temperature can be maintained under recommended temperature setting (Freezer : 0°F, Refrigerator : 37°F).
- When "DELI" is selected, the temperature of the Glide'N'Serve can be kept around 38°F (3°C). This feature helps keep food fresh for a longer time. The Glide'N'Serve temperature can be maintained under recommended temperature setting (Freezer : 0°F, Refrigerator : 37°F).
- When "PRODUCE" is selected, the temperature of the Glide'N'Serve can be kept around 41°F (5°C). This feature helps keep food fresh for a long time. The Glide'N'Serve temperature can be maintained under recommended temperature setting (Freezer : 0°F, Refrigerator : 37°F).

## Detaching and Assembling the Storage Bins

### Humidity Controlled Crisper

- To remove, pull the drawer out to full extension.
- Lift the front of the crisper up, then pull it straight out.

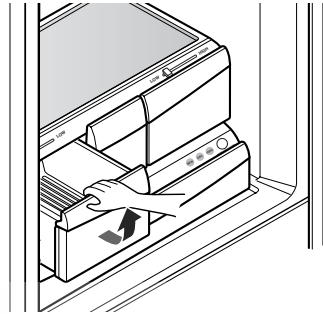

To install, slightly tilt up the front, insert the drawer into the frame and push it back into place.

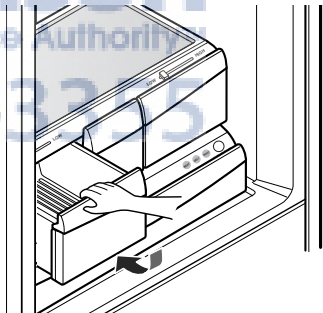

### ! NOTE

Storage Bins may vary in appearance, depending on your model.

## To Remove the Glass

(Pantry drawer not shown for clarity)

Lift up the glass under the crisper cover, and pull up and out.

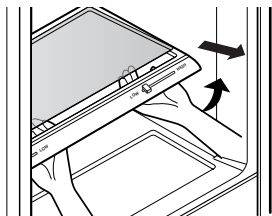

## Door Bins

The door bins are removable for easy cleaning and adjustment.

- 1 To remove the bin, simply lift the bin up and pull straight out.
- 2 To replace the bin, slide it in above the desired support and push down until it snaps into place.

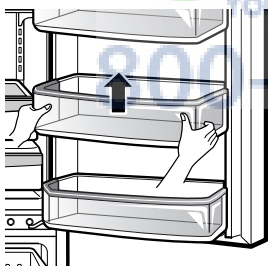

### NOTE

Some bins may vary in appearance and will only fit in one location.

### CAUTION

- Do not apply excessive force while detaching or assembling the storage bins.
- Do not use the dishwasher to clean the storage bins and shelves.
- Regularly detach and wash the storage bins and shelves; they can become easily contaminated by the food.

## Ice Bin

To separate the ice bin, pull out the drawer to full extension. Gently lift and pull out the ice bin.

To reinstall, simply set the ice bin in its correct position.

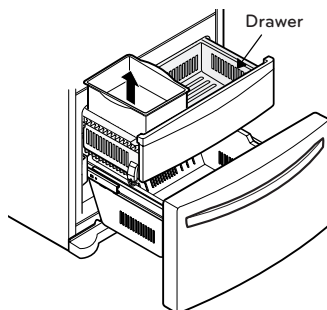

### CAUTION

- Pinch hazard! Keep hands and feet clear of the bottom of the door when opening and closing.

## DuraBase® Divider

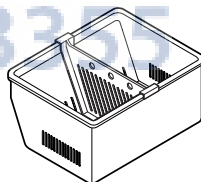

### WARNING

#### Child Entrapment Hazard

- If the DuraBase divider is removed, there is enough open space for children or pets to crawl inside.
- To prevent accidental child and pet entrapment or suffocation risk, DO NOT allow them to play inside of drawer.

## Detaching and Assembling the Storage Bins (continued)

### Pull-Out Drawer

To remove the drawer, push the tabs located on the front inside surface of each rail. Next, gently lift the rear left and right sides of the drawer and pull it out.

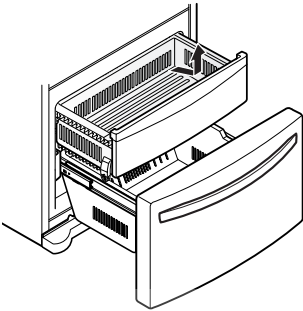

To reinstall, pull out and fully extend both rails. Insert the end of rib in the bracket at left and right. Making sure that the guides at the front are lined up properly, gently push down on both sides.

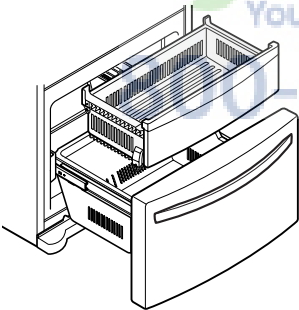

## Adjusting the Refrigerator Shelves

The shelves in your refrigerator are adjustable to meet your individual storage needs. Your model may have glass or wire shelves.

Adjusting the shelves to fit different heights of items will make finding the exact item you want easier. Doing so will also reduce the amount of time the refrigerator door is open which will save energy.

### Detaching the Shelf

Tilt up the front of the shelf and lift it straight up. Pull the shelf out.

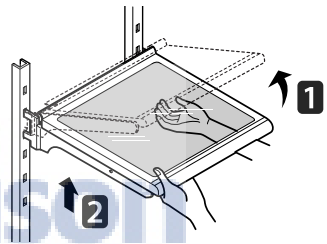

### Assembling the Shelf

Tilt the front of the shelf up and guide the shelf hooks into the slots at a desired height. Then, lower the front of the shelf so that the hooks drop into the slots.

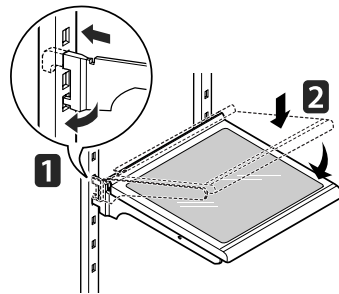

### CAUTION

Make sure that shelves are level from one side to the other. Failure to do so may result in the shelf falling or spilling food.

# SMART REFRIGERATOR DISPLAY SCREEN

## Before Use

### 1. Smart refrigerator display screen

Utilize the many new features, such as Food Manager, Note Pad and Weather application, on the LCD display.

- Display screen buttons are touch activated.
- The touch screen will only respond to the human touch. Gloves, pens or other objects will not work with the touchscreen, and may cause a malfunction.

### 2. Touch button function

- The touch screen buttons do not need to be pressed hard or excessively. Lightly touch the touch screen buttons and icons.
- When the touch screen is turned off, touch the screen once to brighten the screen, and again to use the functions. If the touch screen is locked, you must first unlock the screen in order to use the functions.
- Turn off the display screen before cleaning.
- Excessive dirt or residue on the display may inhibit the function. The display should be kept clean at all times for optimal performance.
- The touch function may not operate normally if there is moisture on the display. Wipe the display with a soft cloth.
- The touch screen will only respond to the human touch. Touch gloves, pens or other objects will not work with the touchscreen, and may cause a malfunction.
- Do not touch the screen while the refrigerator is initially booting up. Doing so may cause a malfunction.

### 3. Necessary Installation Parts

To use the wireless network connection, please verify the following steps:

- The wireless modem can be purchased separately and installed to use smart refrigerator functions such as Food Manager and Weather (linked with smart phone using Wi-Fi) when the product is purchased.
- The user must use a wireless router that supports IEEE 802.11 b/g/n.
- Consult with your internet service provider or install a wireless router to connect your smart refrigerator.
- For best results, install the wireless router as close to the refrigerator as possible.
- For WEP security, IEEE 802.11 b/g is supported. Do not set up IEEE 802.11 n independently.

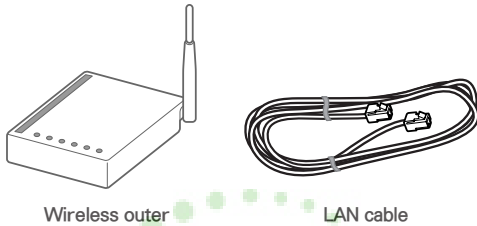

AjMadison  
Your Appliance Authority™

### 4. Note Before Using

To use the connectivity features of your appliance, you must first create a user ID and password at: [us.smartthing.com](http://us.smartthing.com) or [www.smartthing.com](http://www.smartthing.com)



#### CAUTION

- Connectivity features are not available unless the product is registered.
- Images may vary.



## 5. Downloading the Smart Phone Application

Download the application from the Android smart phone market. Search for 'LG Smart Refrigerator' in the search section of the market.

- Optimal resolution for this application is 480x800.

## 6. Turning the touch screen on or off.

Turn the touch screen on or off using the reset switch.

- If the touch screen does not seem to be operating properly, reset the screen using the reset switch.
- Using the reset switch does not effect the refrigerator/freezer compartments.
- You must open the refrigerator doors to located the reset switch, located on the upper right hand corner (see image below).

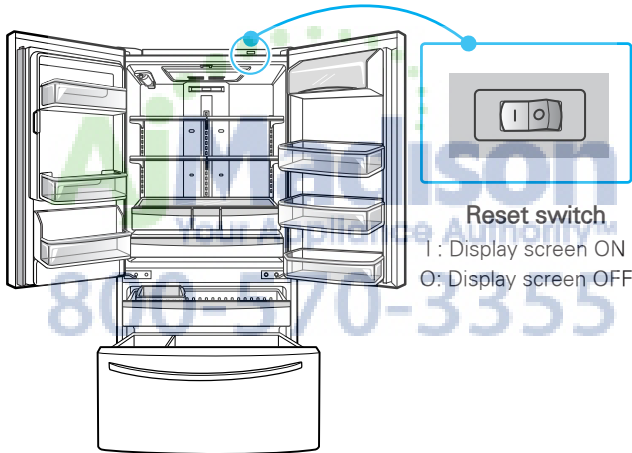

## Home Screen

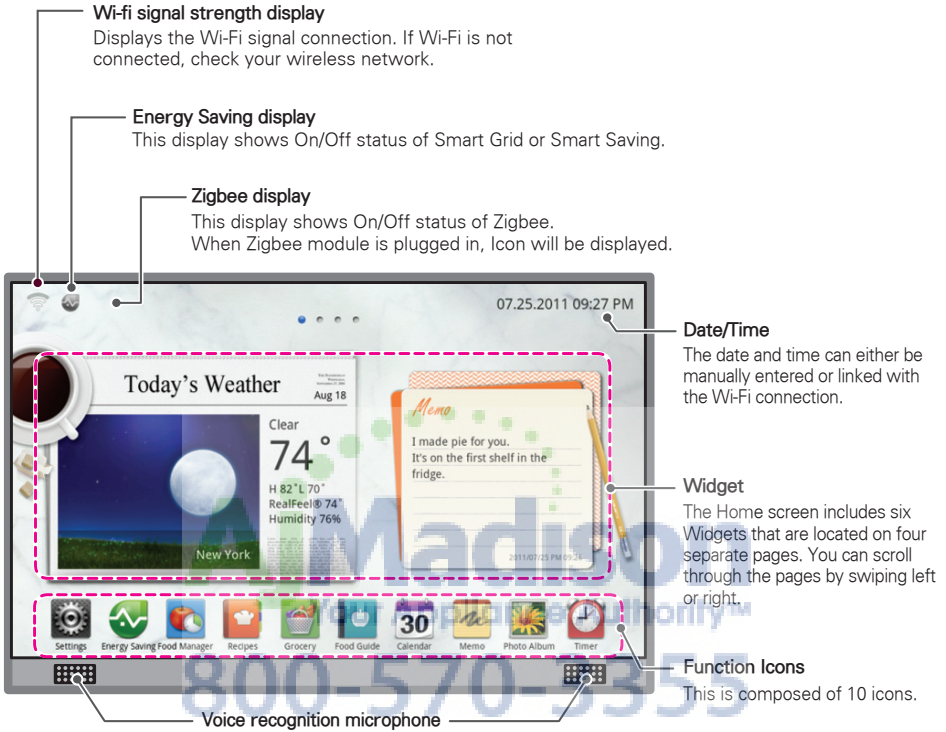

- The Home screen shows Widgets, Function Icons, Date/Time, Wi-Fi, Energy Saving, Zigbee.



### CAUTION

- The touch screen will only respond to the human touch. Touch gloves, pens or other objects will not work with the touchscreen, and may cause a malfunction.

## Basic button

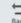
- When the user touches each function icon menu, the basic button (    ) is shown on the top left corner.

### Home Button

Touch the Home button to return to the Home screen.

### Menu Button

Touch the Menu button for menu options of the present screen.

### Back Button

Touch the Back button to return to the previous screen.



**AjMadison**  
Your Appliance Authority™



### CAUTION

- The touch screen will only respond to the human touch. Touch gloves, pens or other objects will not work with the touchscreen, and may cause a malfunction.

## Settings

- Touch the Settings button to view or modify the display settings: Brightness, Volume, Wireless Network, Update, Screen Saver, Date & Time, Zigbee, Log In/Reset.

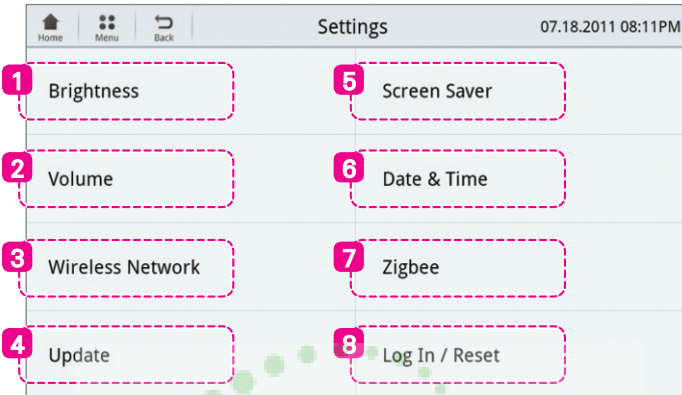

### 1. Brightness

Touch the Brightness button from the Settings screen.

- Move the scroll bar left (darker) or right (brighter) to control the brightness of the display screen.

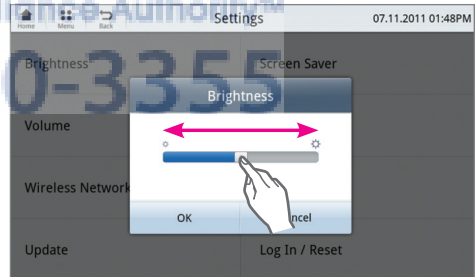

### 2. Volume

Touch the Volume button from the Settings screen.

- Move the scroll bar left (softer) or right (louder) to control the volume of the display screen.

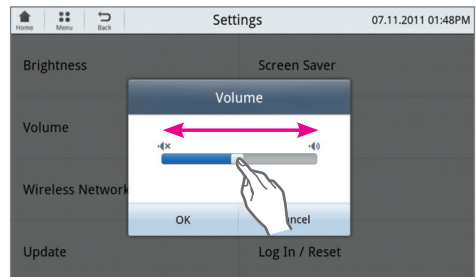

### 3. Wireless Network

- Touch the Wi-Fi button on the Settings screen.
- Touch the Wi-Fi on/off button. The Wi-Fi is turned on when there is a check mark in the box.

#### ! CAUTION

- When searching for the wireless network, wireless routers other than the one installed in the house hold used nearby can be searched. Using other routers without permission is illegal and can result in legal consequences when found. Therefore always use only the wireless routers that are authorized for use.

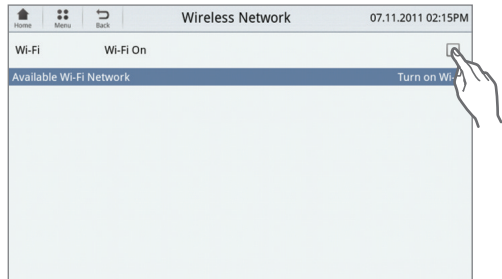

#### How to connect the wireless network

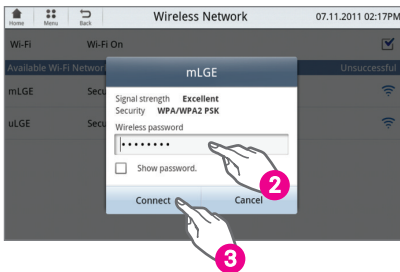
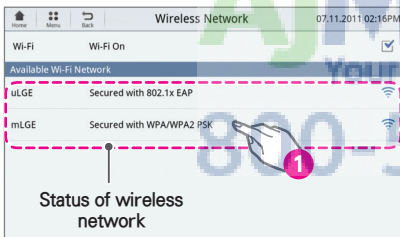

- Select the wireless network that you would like to use.
- When the wireless password popup displays on the screen, enter the wireless password (refer to the 'How to enter the wireless password on the Keyboard' section on the following page).
- Touch the Connect button to complete the wireless connection setup.

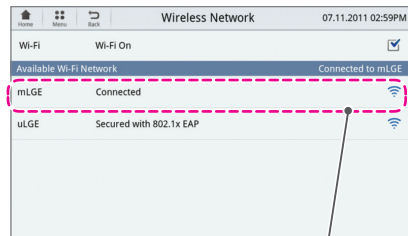



Wireless network connection completed state (Example of router mLGE)

### How to enter the wireless password on the keyboard

- Use the alphabet and number keyboard to enter the password.

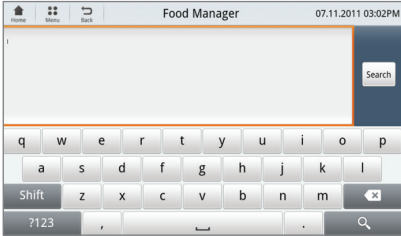
\* Keyboard input for all text type is the same.





 Shift Shift for lowercase or capital letters

 Space button

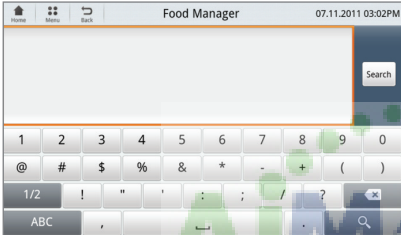
 Delete button

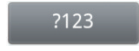

 ?123 Alphabet/Number and special character switch button

 1/2 Special character switch button



## 4. Update

Once the user registration is complete, the firmware and recipes will automatically update through the network.

### 1) Confirm registration

[Settings screen]

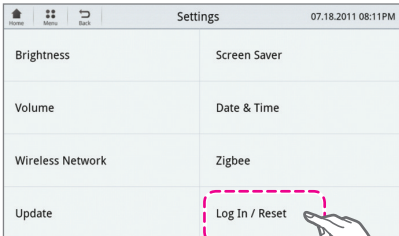

- Select Settings → Log In / Reset.

[Log In / Reset Screen]

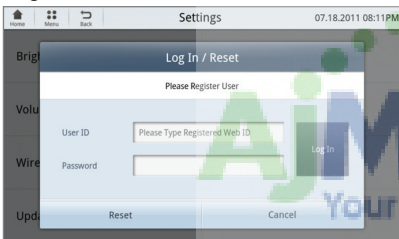

[Example]

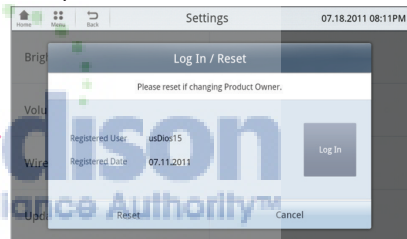

800-570-3355

### 2) Press the Update button in Settings.

[Settings screen]

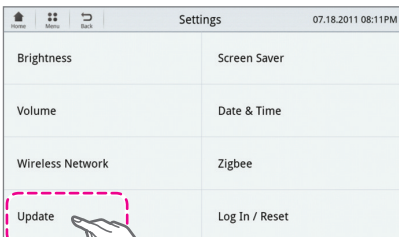

- Once you are registered, touch the Update button from the Settings screen.

- Firmware and recipe updates are automatically checked.

- If there is a new item to update, press the Network button.

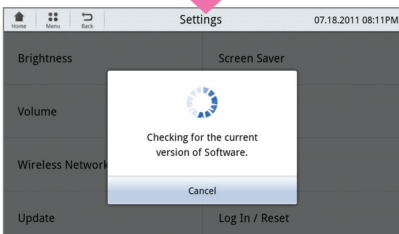

3) Update firmware

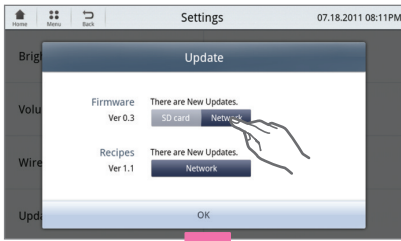

- Touch the Network button if "There are new updates" appears in the display.
- After the update, the system will automatically reboot. Do not touch the screen while the firmware is updating.

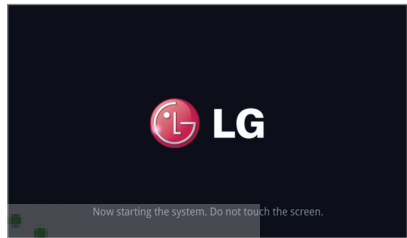
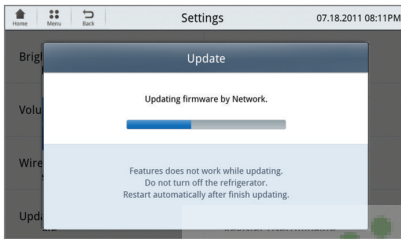

- The update may take longer depending on the Wi-Fi connection. Please be patient. If the screen stalls during the update (progress bar has stopped) open the door and flip the reset switch off and on.

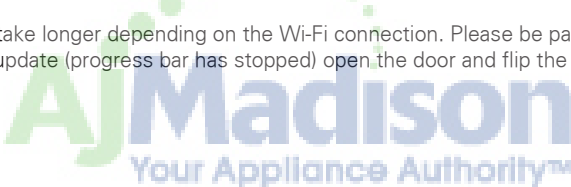

4) Update recipes

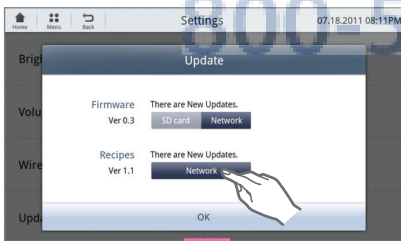

- Touch the Network button if "There are new updates" appears in the display.
- After the update, the screen will automatically switch over to Settings. Do not touch the screen while the recipe is updating.

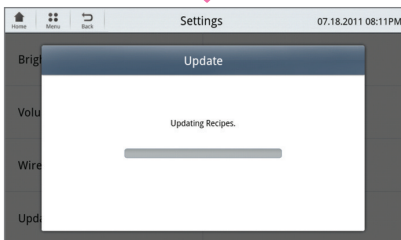

Brightness	Screen Saver
Volume	Date & Time
Wireless Network	Zigbee
Update	Log In / Reset



- The update may take longer depending on the Wi-Fi connection. Please be patient. If the screen stalls during the update (progress bar has stopped) open the door and flip the reset switch off and on.

## 5. Screen Saver

The user can set the screen saver.

- From the Settings, touch the Screen Saver button **1**.
- After setting the screen saver, touch Ok **2**.

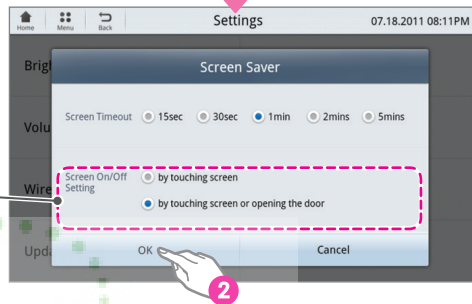
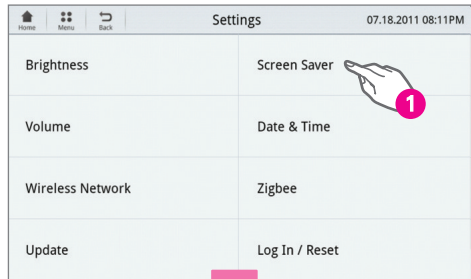

The user can select to turn on the screen based on the user convenience.

### Screen lock

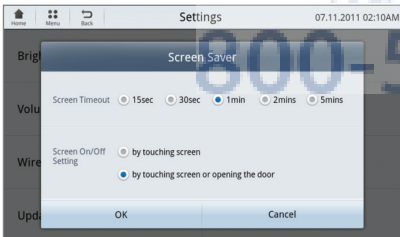

- The screen will be turned off after the screen timeout and it will be locked when the user touches the screen.

- Use the refrigerator content after unlocking the screen.

### Unlock screen

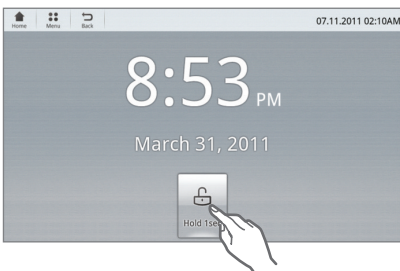

- To unlock the screen, touch and hold the Hold 1sec icon for one second. After the screen is unlocked, the most recently used screen will appear in the display.

## 6. Date / Time

- You can select a time zone of your location. Touch the Select Time Zone button and scroll up and down the time zone to identify your desired time zone.

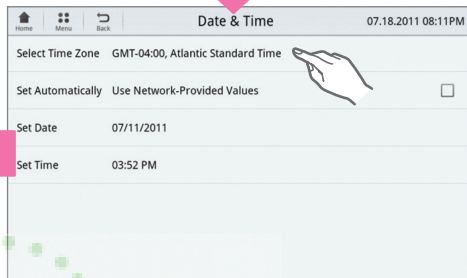
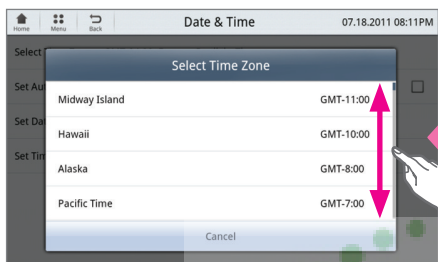
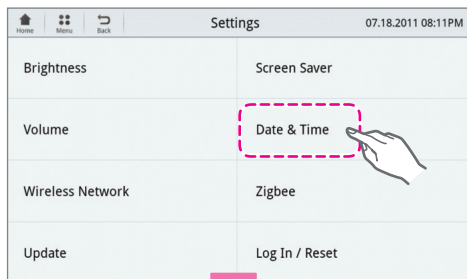

- Selecting "Set Automatically" (recommended) will link the date and time through your Wi-Fi connection.

When the user sets the date and time

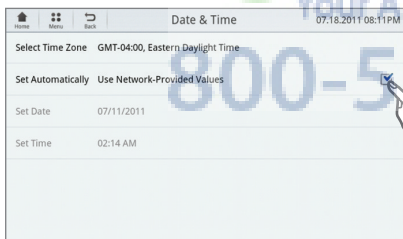

- Use the +/- and AM/PM buttons to set up the date and time.

- If necessary, you may also set the date and time manually by selecting "Set Date" and "Set Time."



### CAUTION

- Saved data value can be different from that of the network based on the date/ time set up by the user.

## 7. Zigbee

- Zigbee is a modem to use Smart Grid.
- It communicates with electric power corporation.

### Update Zigbee

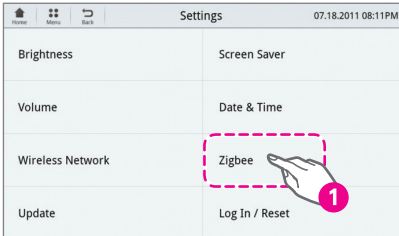

1 Touch the Zigbee in Settings.

2 Touch Continue when Zigbee Update pops up.

3 After checking current version, Zigbee Update pops up. Update if it is not the newest version.

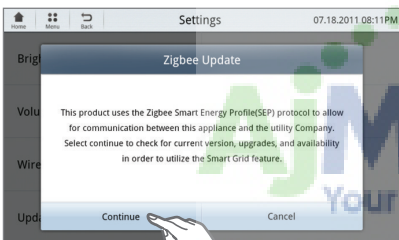

#### CAUTION

- Smart Grid feature can be used only when Smart Grid service is provided by the utility company. The LG Electronics Zigbee module must be compatible with the Smart Meter and installed properly prior to usage.

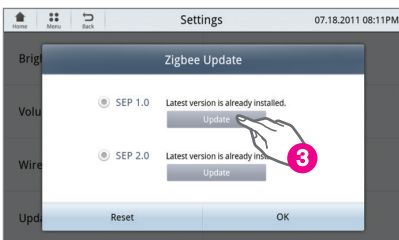

## 8. Log In / Reset

To use various functions of this refrigerator, such as Food Manager and Software Update, it is necessary to Login.

The product must first be registered online at: [us.smarthing.com](http://us.smarthing.com) and create a Login ID and Password. (Refer to "How to set up ID/Password for User Registration" on the following page.)

### < Log In >

- Enter your User I.D. and password created when you registered your product.
- Select the Log In button. A popup will verify the login.
- The date of registration can be verified by returning to the Log In screen.

#### CAUTION

- After resetting, all information will go back to its original settings.

### < Reset Log In information >

- Select the Reset button.
- A popup will appear to verify your selection. Enter your password and select the Confirm button.

#### CAUTION

- The product must first be registered online at: [us.smarthing.com](http://us.smarthing.com) and create a Login ID and Password. (Refer to "How to set up ID/Password for User Registration" on the following page.)

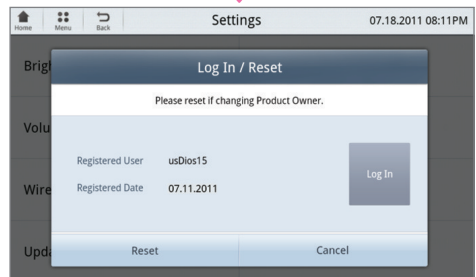
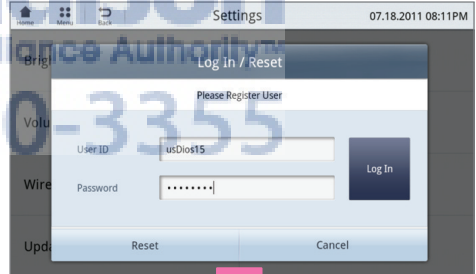
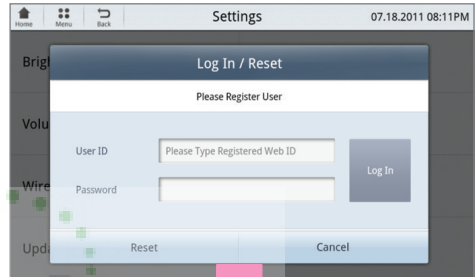
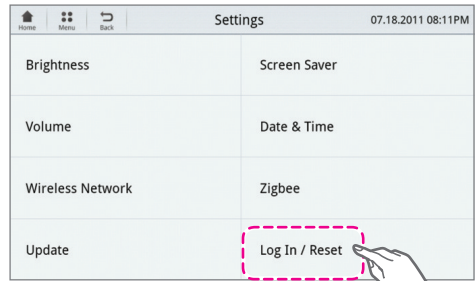

## How to set up ID/Password for User Registration

To use the connectivity features of your appliance, you must first create a user ID and password at the LG SMARTTHINQ website (<http://us.smarthinq.com>). From your home computer, or other computer with internet access, open the SMARTTHINQ website and follow the instructions below for creating your ID and password.

- Click Sign In in the left corner of the web page.
- On the Sign In page, below the ID and password boxes, click the Membership Resister button.
- On the next page, you must agree to the terms of use and the privacy statement. Click "Confirm."
- Next, enter your email address. This will be your user ID. You will receive a confirmation email for activating the account at that email address, and this ID will be entered on the ID and password screen on your appliance when registering the appliance.
- Enter a password. Passwords are case sensitive, and you will need to enter this password on your appliance when you register the appliance. The password should be 6~12 characters, and you should make note of it for later use.
- Type the characters from the security box into the box to the right of the security box.
- Click the "Confirm" button. The system will send you an email containing a link to confirm your identity for the account.
- Click the link in the confirmation email, and the website will display a confirmation page.

You are now ready to register your appliances so you can take advantage of all the connectivity features of your LG SMARTTHINQ appliance.

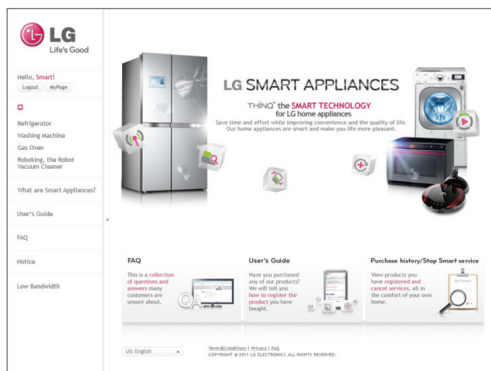

### CAUTION

- Connectivity features are not available unless the product is registered.
- Images may vary.

## Energy Saving

- Touch the Energy Saving button at the bottom of the Home screen.
- The refrigerator power consumption can be reduced by either turning on the Smart Grid feature or the Smart Saving feature. Both features cannot be on at the same time.

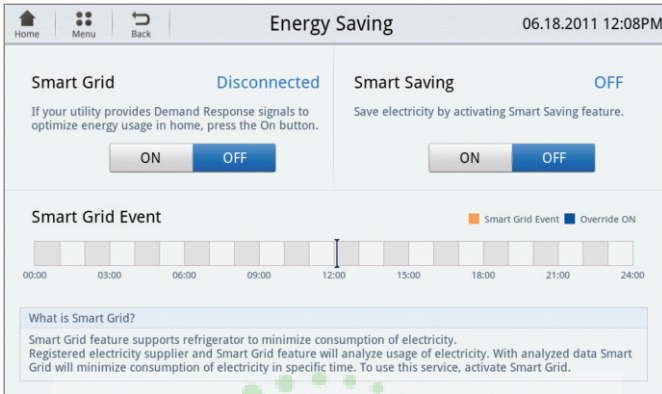

## Smart Grid

Smart appliances can communicate with local utility companies that are equipped with SMART GRID equipment. These utility companies can then adjust the operating times for enabled smart appliances during peak electricity demands. Turning this feature on can help reduce your electricity consumption by allowing the utility company to delay some of the functions of your machine during peak electric demand.

- Select ON or OFF to turn the SMART GRID feature on or off. The status of the smart grid is shown on the home screen.
- Contact your utility company to find out more about its system's capabilities and for help in setting up your machine.

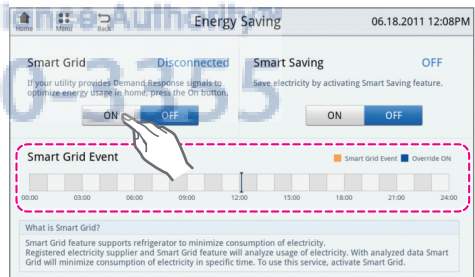

### CAUTION

- Smart Grid feature can be used only when Smart Grid service is provided by the utility company. The LG Electronics Zigbee module must be compatible with the Smart Meter and installed properly prior to usage.

## Smart Saving

- Smart Saving reduces power consumption for up to four hours either at night or at custom set time periods.

### Setting Smart Saving

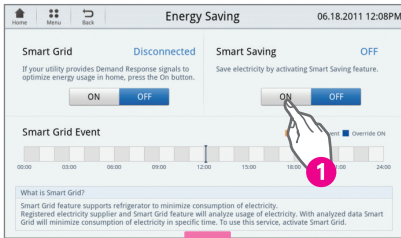

- 1 Touch the on button to turn on Smart Savings and customize your smart saving settings.
- 2 Choose the mode: Night Mode or Customize.
- 3 Touch the OK button.

**Night Mode:** Minimizes power consumption of the refrigerator during the hours of 12am to 4am.

**Customize:** Minimizes power consumption during user defined time periods. You are able to set up to two Smart Saving time periods. Each period may not last longer than two hours.

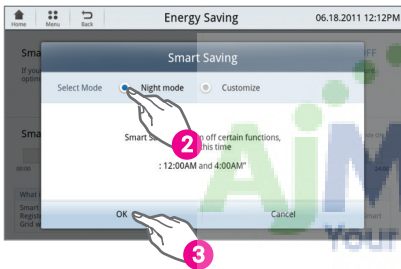

### Customize

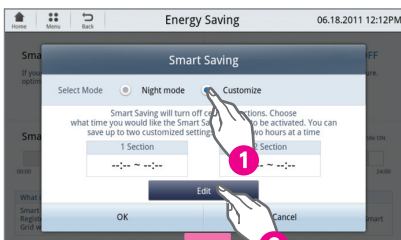

- 1 Touch the Customize button.
- 2 Touch the Edit button. Set the time zone.

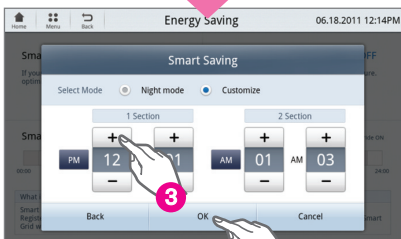

- 3 Touch the +/- buttons to set the time.
- 4 Touch the OK button.

## Food Manager

- Touch the Food Manager button at the bottom of the Home screen.
- There are 5 options in the Food Manager. (Phone, Food List, Recipes, Grocery, Trash Bin)
- In Food Manager, you can search for food items with the keyboard, voice recognition, or drag and drop.



Touch for Food Manager using voice recognition.

Touch for Food Manager using keyboard.

### Frequently used items

This tab displays frequently used food items.

- Use the scroll bar to view all of the list of items.



### 1) Loading frequent food to the refrigerator

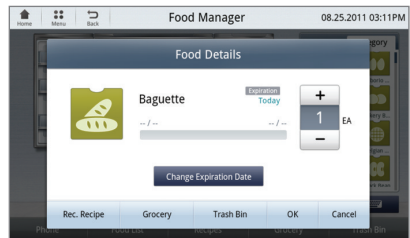

- Touch and hold the item for one second and then drag it into the desired refrigerator location.
- The screen of food details appears.

## 2) Entering detail information of food (Quantity and Set storage period)



- After the item has been loaded to the refrigerator, you are able to enter detailed information about the item, such as quantity and an expiration date.

- To enter information on an item, touch the item in the refrigerator.

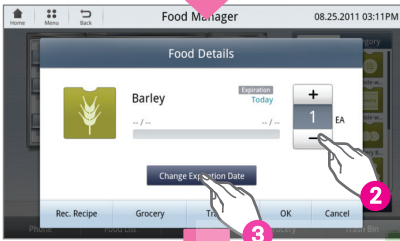

- Enter desired information into the Food Details popup. To enter quantity, touch the +/- buttons. To enter an expiration date, touch the Change Expiration Date button and use the +/- buttons to set the date.

- Food with short storage period is notified to the user daily through Freshness Tracker widget.

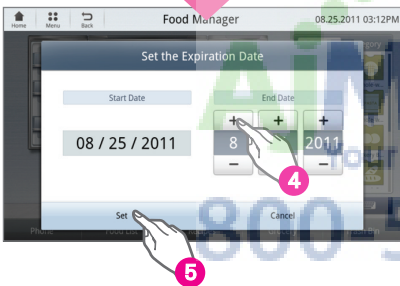

### ► Example of misuse of storage period and storage location setting.

- When the storage period is entered longer than normal either because the expiration date is unknown or because it was entered incorrectly.
- When children are playing with the refrigerator.
- When the same type of food is stored in the same location with a time gap, but the food stored earlier is misjudged to have been stored later.
- When the food stored in the freezer is moved to the fridge but only the storage location has been changed and not the storage period.
- When the time and environment (High temperature and humidity etc.) are not considered from the time of purchasing the food to storing the food.
- When the food is taken out of the refrigerator and put back in without being used and the time passed has not been reflected.
- When the food is stored in a different location after partially being used (Store in another compartment where same type of food is stored).
- When the food with damaged packaging is set to be stored until normal expiration date.



#### CAUTION

- The ending date can differ based on the expiration date and stored condition of the food and the manufacturer or the refrigerator manufacturer is not responsible for the storage period that the user has set.

## Food Manager by Category

Search for food items by category.

- The Category includes Dairy, Grain, Produce, Beverage, Seafood, Condiments, Meat, Frozen Food.
- When the user selects the category of the food to store (For example Fruit), the food is displayed below.
- The method of storing the food is the same as that of food storage by Frequent.
- In addition, If you want to change the category to store food in category, touch the Category button to switch to the previous stage.



### 1) Search food by storage location



- If the user stores more than a certain quantity of food in the applicable location, the number of types of food is shown is displayed on the right side.

- To enter the detail information of the food, the user touches the location to activate the applicable compartment.

- If the user stores more than a certain quantity of food in the applicable location, the user can use the < or > to search for the food.

- When the user touches the applicable food, the screen to enter the detail information of the food is displayed.

2) Enter detail information of food and view recommended recipe by storage location.

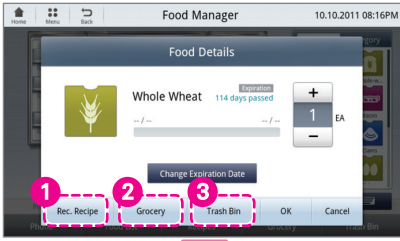

- The user can use the quantity (+, - button) and Change Expiration Date button to change the detail information.

- From the detail information view of the stored food, the user can view (1) the recommended recipe that can be cooked from the applicable food, and the applicable food can be added (2) to the Grocery or deleted (3) from the stored food list.



- Touch the Rec. Recipe (1) and select the necessary recipe.

**Food Manager Using Voice Recognition**

- Touch the Voice Recognition button.
- Once "Activation voice recognition. Please wait." appears in the display, say the item that you would like to search for.



## Voice Recognition Food Manager Method

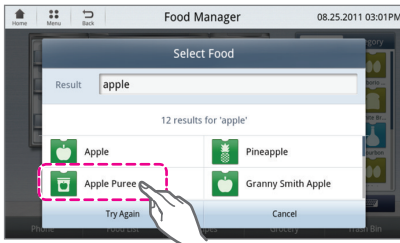

- The search results will appear on the display.
- Touch the item that you would like to add to the refrigerator.
- Touch the location in the refrigerator that you would like your item to be stored.

### If item is not recognized



If the Voice Recognition is unable to recognize the item, a popup will display giving you the option to try again, use the keyboard or cancel.



#### CAUTION

- The sensitivity of the recognition may differ depending on the voice tone of the user.

### Food Manager Using Keyboard



- Touch the Keyboard button.
- Using the Keyboard, type in the name of the item that you would like to search for.
- Touch the Search button.

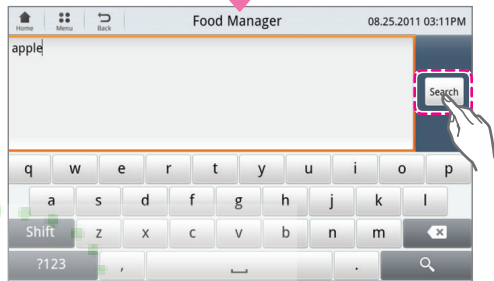

### When saved on the database

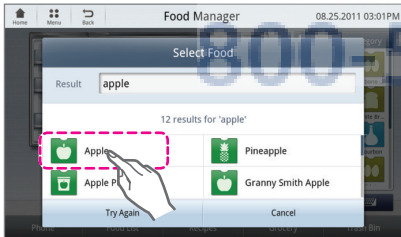

- The search results will appear on the display.
- Touch the item that you would like to add to the refrigerator.
- Touch the location in the refrigerator that you would like your item to be stored.



**Adding new items into the database**

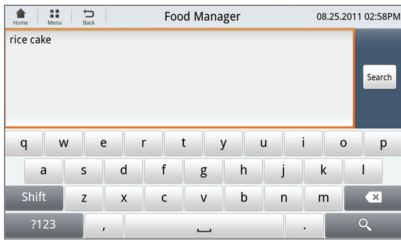

- A popup will display if the searched item is not in the database.

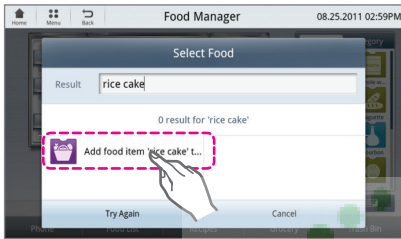

- To add a new item to the database, select the "Add food item..." button.

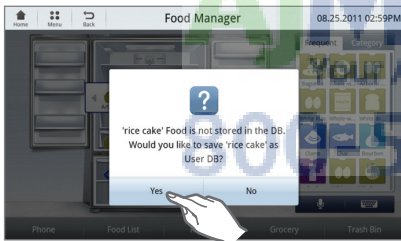

- A confirmation popup will display. Touch the Yes button.



- Touch the location in the refrigerator that you would like your item to be stored.



## Phone

This is the button to send or load the food list to or from the phone.

### 1) Send

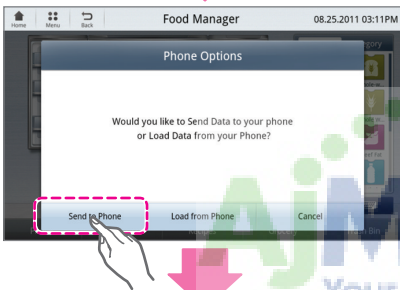

Touch this button to send the current food list information to the server and smart phone.

- When the information is sent from the display screen to the smart phone, it connects to the application on the smart phone and the user can check whether the applicable changes are applied.

- Popup is displayed based on the success/failure of the send result.



### CAUTION

- If the user does not log in in Settings, the food information is not updated.

**AjMadison**  
Your Appliance Authority™  
800-570-3355

2) Load

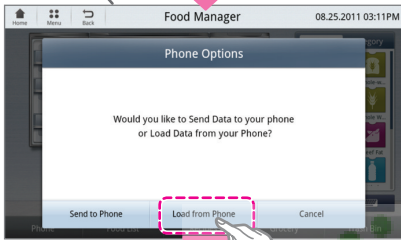

Touch this button to open the current food list sent from the server and smart phone.

- When the information is sent from Smart phone to the display screen, the user can check whether the applicable changes are applied.

- Popup is displayed based on the success/failure of the send result.

**CAUTION**

- If the user does not log in in Settings, the food information is not updated.

► Send/Load error

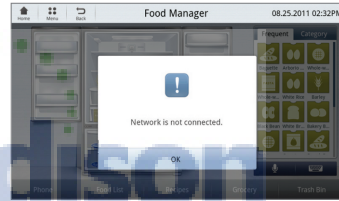

In case of wireless network error, the error popup window is displayed. Press the Ok button and press the Send or Load button again to refresh the screen.

\* If the network is not connected, the same message is displayed. Press Ok for use, and there is no issue with Food Manager.

## Food List

- The user can view the list of all foods in the refrigerator from the main screen of the Food Manager.
- The user can check the number of days the food is stored from the list of stored food and can remove the stored food selectively or entirely.

### 1) Use the Menu button

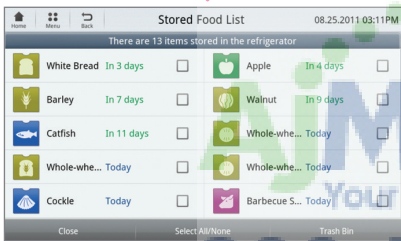
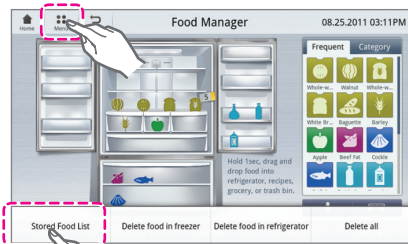

### 2) Use the Food List button

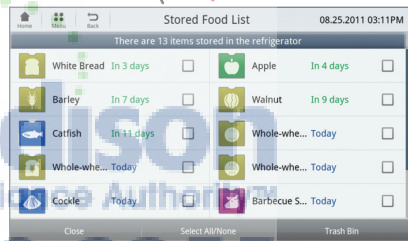

800-570-3355

## Recipes

The recipe function can be used to find recipes based on ingredients you have in your refrigerator.

- To retrieve recipes based on available ingredients, drag and drop the ingredients you would like to use into the Recipes button. To drag and drop you must press and hold the food icon until it activates, then drag it where you would like.
- A popup will appear to confirm that the item has been added to the Recipes list.
- For more information on using the Recipes function, refer to the Recipes page in this manual.

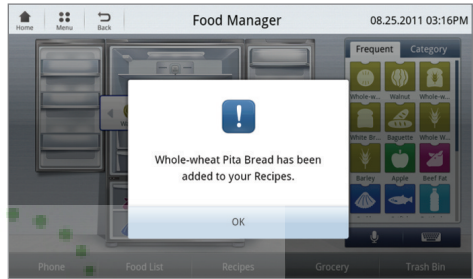

## Grocery

The Grocery function is used to create a grocery shopping list. This list can be sent to your smartphone using the refrigerator's Wifi connection.

- To add food items to your grocery list, drag and drop food items from your refrigerator or the food list onto the Grocery button. To drag and drop you must press and hold the food icon until it activates, then drag it where you would like.
- A popup will appear to confirm that the item has been added to the Grocery list.
- For more information on using the Grocery function, refer to the Grocery page in this manual.

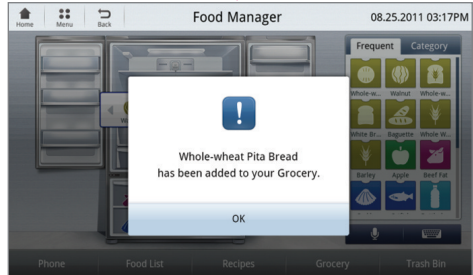

## Deleting Individual Stored Items

To remove items from your refrigerator's contents, use the Trash Bin function.

- Select the compartment in which the food item you want to delete is stored.
- Drag and drop the food item you would like to delete onto the Trash Bin button. To drag and drop you must press and hold the food icon until it activates, then drag it where you would like.
- A popup will appear confirming that the item has been removed from the refrigerator.

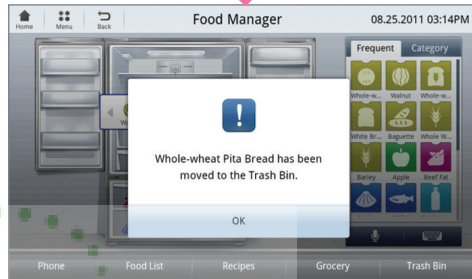

## Removing All Stored Items

When managing your refrigerator's contents, you have the option to remove all items in the refrigerator, freezer, or both.

- On the Food Manager home screen, press the Menu button in the upper left hand corner. A list of options will appear on the bottom of the screen.

- 1 **Stored Food List** - Selecting this option will display a list of all foods stored in your refrigerator and freezer.
- 2 **Delete food in freezer** - This option will delete all stored food in the freezer section only. You will be prompted for confirmation before freezer items are deleted.
- 3 **Delete food in refrigerator** - This option will delete all stored food in the refrigerator section only. You will be prompted for confirmation before refrigerated items are deleted.
- 4 **Delete all** - Selecting this option will delete all stored food items in both the refrigerator and freezer. You will be prompted for confirmation before all items are deleted.



## Recipes

- The Recipes function can be accessed either by selecting the Recipes icon from the bottom of the home page or by pressing the Recipes widget on the home screen.
- In the Recipes section there are several options for finding recipes:
  - **Search for Recipes:** You may search for recipes by course, time, ingredient, or cuisine.
  - **Recommended recipes by available items:** Your refrigerator will recommend recipes to you using items you already have in your refrigerator. You may add ingredients to included in your recommendations through Food Manager. Please refer to the Food Manager section of this manual for more information on this.

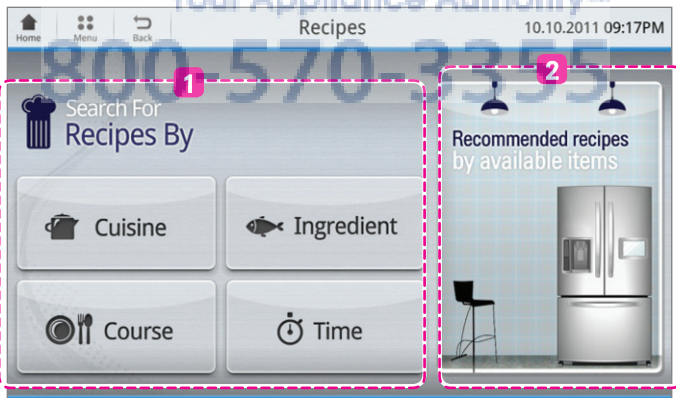

## Recipes Search

- You may search for recipes in four different ways: by course, ingredient, time, or cuisine.

### Using Recipes Search



- ❶ One of the 4 search methods that you wish to use.



- ❷ Once you have selected your preferred search method, a new screen will appear on the left side with a list of categories. Select the category for which you would like to view recipes.

- ❸ A list of recipes pertaining to the category you selected will appear directly to the right of the category list. The category you are currently viewing will remain appear highlighted in the category list.

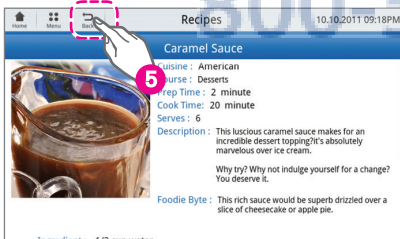

- ❹ Scroll up and down the recipes list to identify your desired recipe. Once you have found a recipe you would like to view, select the recipe by pressing it. The recipe will appear.

- ❺ To return to the View Recipes screen from a recipe, press the Back button in the upper left hand corner.

- In the same way, the recipes for Time, Ingredient and Cuisine can be viewed.

## Recommended recipes by available items.

This feature will recommend recipes to you based on items you have available in your refrigerator.

### Viewing Recommended recipes

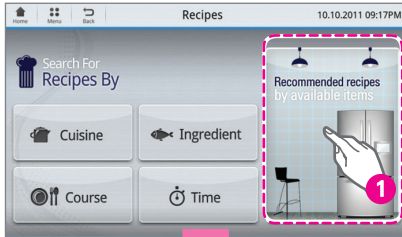

- Touch Recommended recipes by the stored food (1).

- The recipe recommendation home screen has three main parts:

**2 Available Ingredients** - This includes ingredients from Food Manager that you have made available for recipe recommendation. These are the ingredients that you can use to find recipes. To view all of the available ingredients, you can scroll through them by swiping the list left or right. (For more information on adding ingredients to this list, refer to the Food Manager section of this manual. To access Food Manager, you can use the Food Manager button at the bottom of the screen.)

**3 The Pot** - Here, you will add the ingredients you would like to include in your search. Adding ingredients from the Pot is as easy as dragging and dropping from the Available Ingredients list (to drag and drop you must press and hold the food icon until it activates, then drag it where you would like). To delete items from the Pot, simply press the item you would like to remove and it will be removed. Once you have included all of the ingredients you would like to use for your search, press Show Recipes.

**4 Recommended Recipes** - Once you have selected your ingredients and pressed Show Recipes, recipes fitting your ingredient list will appear here. To view a recipe, simply touch the recipe you want on this list.

#### NOTE

- You can access the Food Manager or your Grocery list from this screen at any time by selecting the corresponding shortcut at the bottom(5) of the screen.

## Grocery



- Touch the Grocery icon at the bottom of the Home screen.
- Drag and drop the groceries into the grocery list.
- You can check the name of food with a long name by tapping the icon of the food.
- Recommend displays food in the order of frequency of use by users.
- Once the grocery list has been updated, you have the option of sending the list to your smart phone.

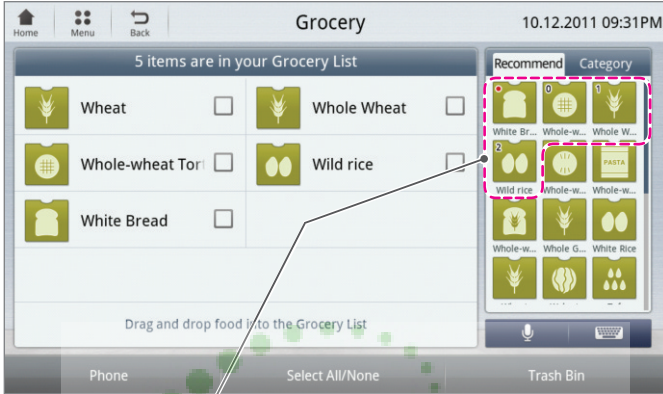

- Among the stored food list, food that has passed the expiration date or is 2 days before the expiration date is displayed as follows:

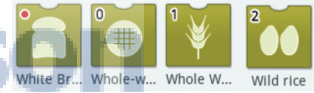

Madison  
Your Appliance Authority™  
800-570-3355

## Phone

Press the Phone button to send or load the grocery list to or from your smart phone.



### CAUTION

- You will not be able to load the grocery list to your smart phone if the refrigerator has not been registered.

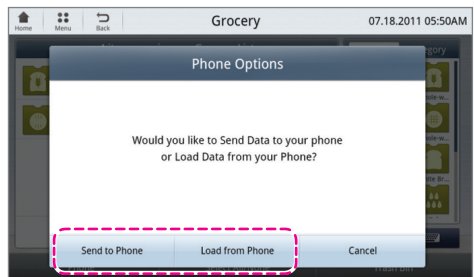
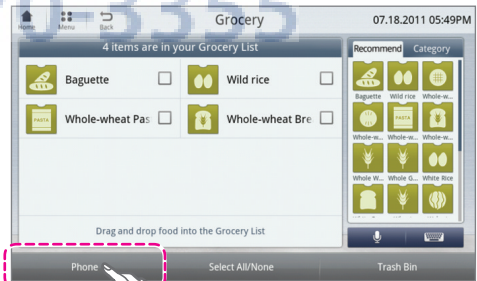

**When the user touches the Send to Phone**

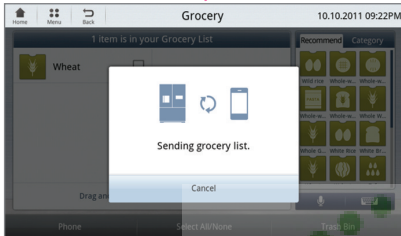
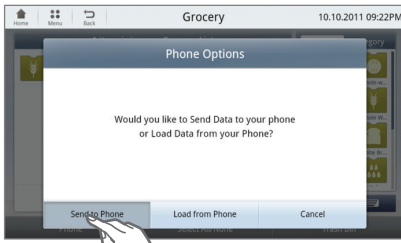

**When the user touches the Load from Phone**

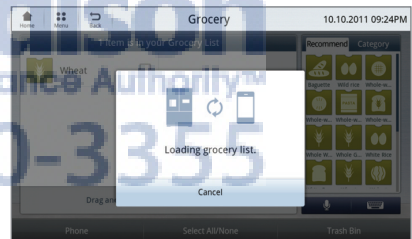
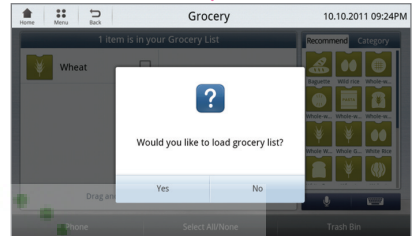
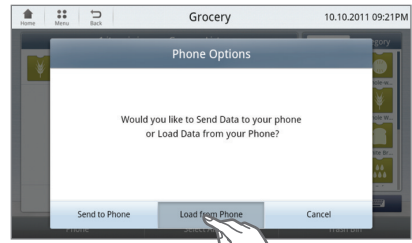

AjMadison  
Your Appliance Authority™  
800-570-3355

**Remove Grocery**

Drag and drop items into the Trash Bin to remove them from your grocery list.

- The user can delete food by dragging and dropping food icon into Trash Bin.
- After selecting food by touching the Select All/None button or check box, the user can delete food by touching the Trash Bin button.
- Make sure to select the correct items before removing them.

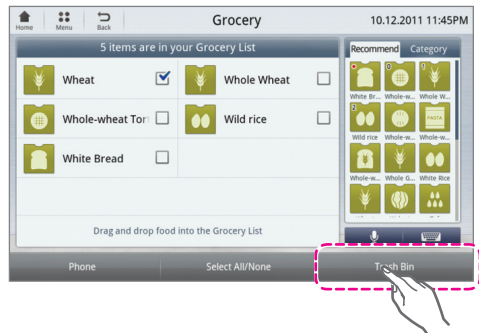

## Food Guide

- Touch the Food Guide icon at the bottom of the Home screen.
- The food guide provides information, such as Storage temperature, on an array of fruits and vegetables.



### Fruit / Vegetable Lists

- Select either the Fruit or Vegetable list.
- Select the item that you would like to see information on.

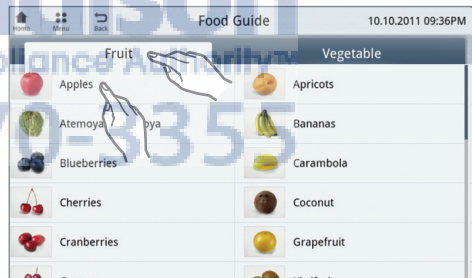

- Detailed information on the selected fruit or vegetable will display on the screen.

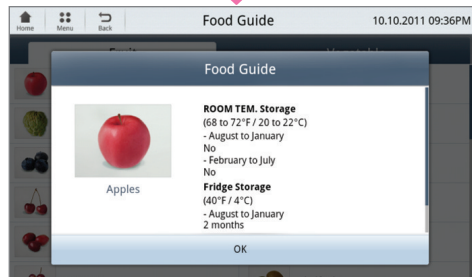



## Enter detail information of event

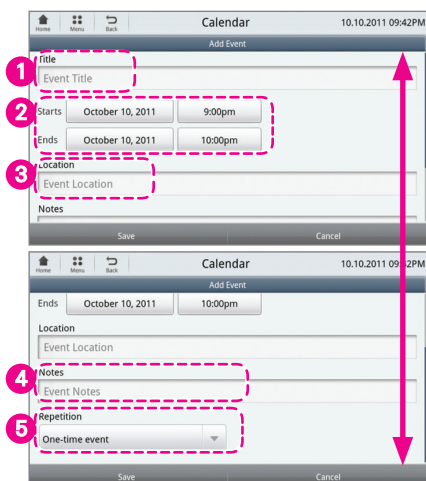

- Customize your event. Touch the Title box and a Keyboard will display. Type in the name of your event. Press Done.

- Enter the start and end date by selecting the date and time buttons. Adjust the date/time by using the +/- buttons on the display.



- Touch the Set button to save the date/time settings.

- You may also enter the event location or notes. Touch the Location or Notes box and a Keyboard will display. Type in the Location or Notes for the event. Press Done.

- Touch the Repetition button to make it a recurring or one-time event. Swipe up or down for the repetition options.

- Press the Save button to save the event.

**AjMadison**  
Your Appliance Authority™  
800-570-3355

### Edit / Delete event

- Select the date of the event from the calendar.
- Select the event that you would like to edit or delete.
- Select the Menu button.
- Select Edit event or Delete event.
- If editing the event, edit the information and press Save.
- To delete an event, select the Delete button.

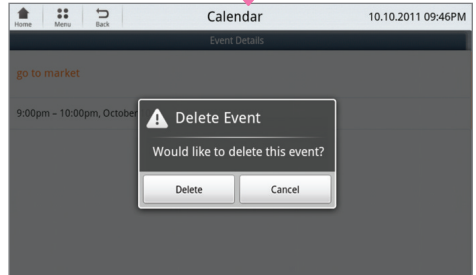
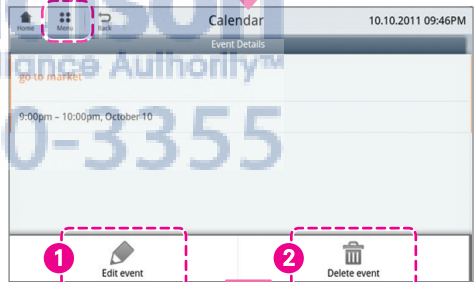
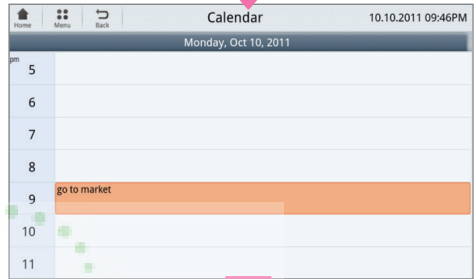

  
 Your Appliance Authority™  
 800-570-3355

## Calendar Menu Button

Use the Menu to view quick event information, or to add a new event.

- Touch the Menu button to view and select the different menu options.



### 1 When selecting List Tasks

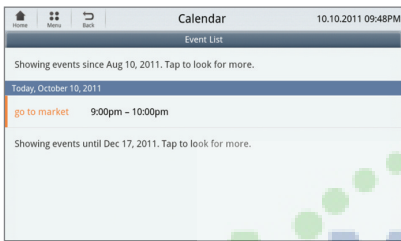

### 2 Search daily event

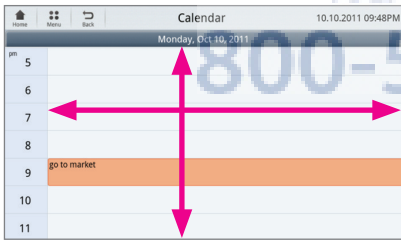

- Swipe up and down, and from side to side to view the events.

### 3 Search weekly event

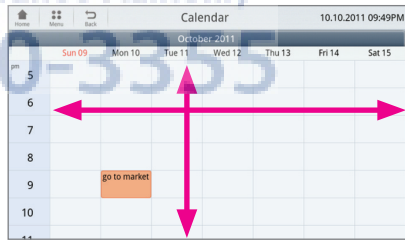

- Swipe up and down, and from side to side to view the events.

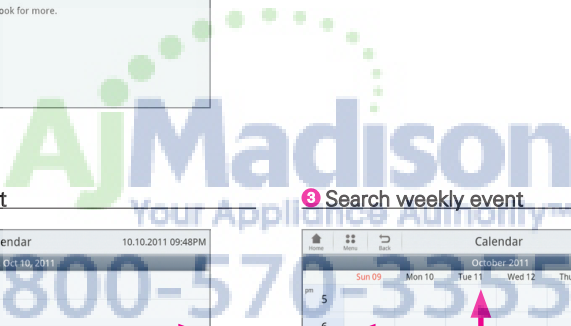

## Memo

- Touch the Memo icon on the bottom of the Home screen or the Memo widget.

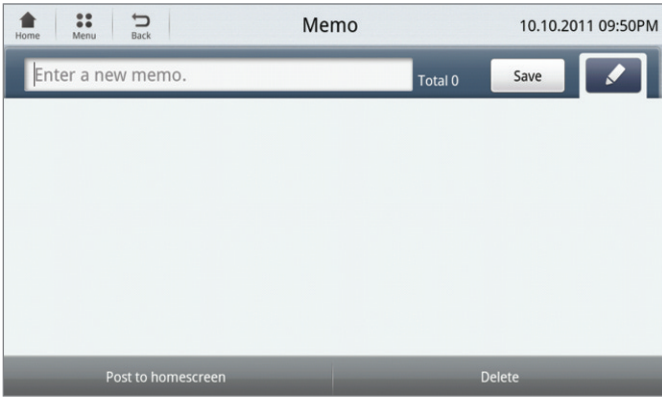

### Creating Memo

The user can create a new memo by entering text and drawing picture.

#### 1) Entering memo with text

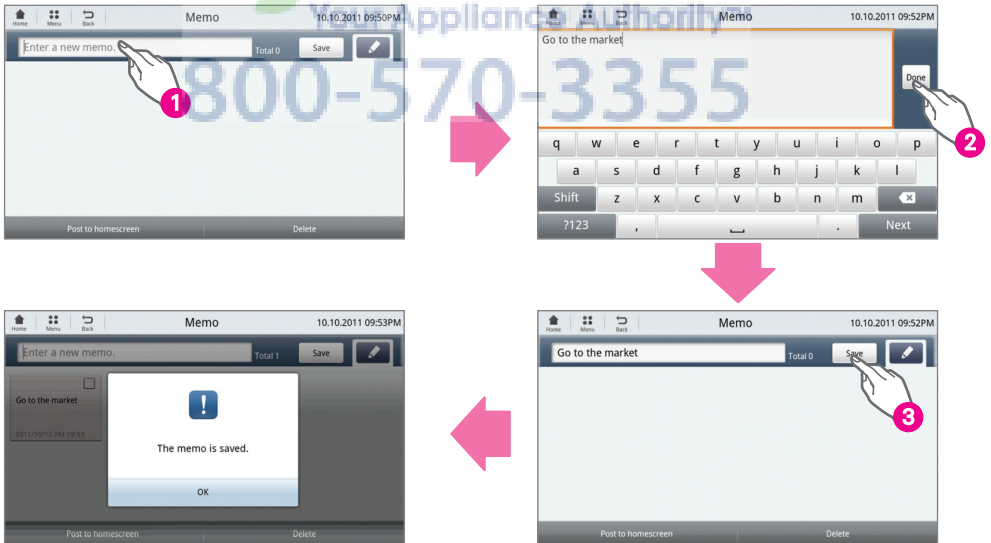

- 1 Touch the empty box and a Keyboard will display.
- 2 Enter your note using the Keyboard. Touch the Done button when you are finished typing the note.

- 3 Touch the Save button to save a memo.

2) Entering memo by drawing

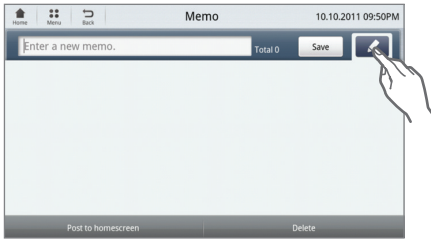

- Touch the (  ) icon from the Memo screen.

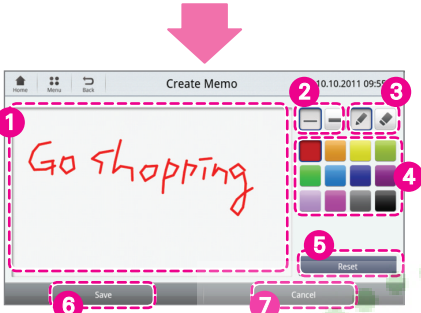

Touch the screen to draw the memo.

- 1 A memo can only drawn within the drawing area of the screen (see image).
- 2 The thickness of the line can be set. Select one of the 2 types.
- 3 Drawing and Eraser function.
- 4 The color of the line can be selected.
- 5 Select the Reset button to erase the image from the screen.
- 6 Touch the Save button once you are done drawing your memo.
- 7 Cancel the memo by touching the Cancel button.

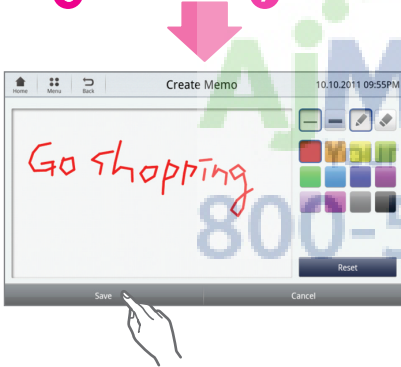

- Touch the Save button to save your memo.

\* How to use the eraser

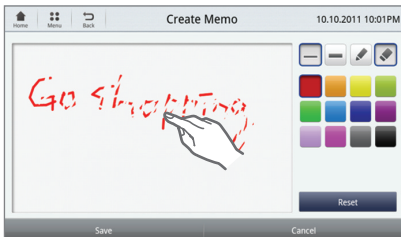

- Select the eraser button.
- Use your finger to to wipe away the information in the memo screen.

### Delete Memo

- Touch the check box on the upper right hand corner of the memo.
- Touch the Delete button.
- A confirmation popup will display. Touch Delete.

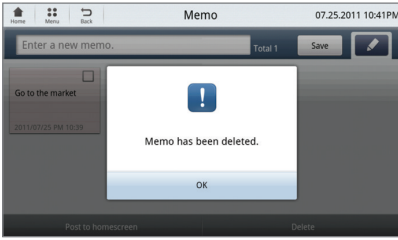
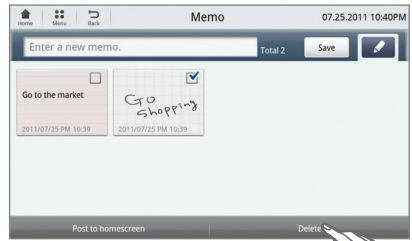

### Save memo to Home Screen

- Touch the check box on the upper right hand corner of the memo.
- Touch the Post to home screen button.
- A confirmation popup will display.
- View your memo on the Home screen next to the weather widget.

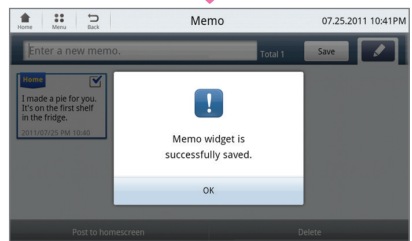

## Photo Album

- Touch the Photo Album button on the bottom of the Home screen or the Photo Album widget.
- You can store up to 300MB. Video is not supported.



\* If there are not any photos loaded, a screen will appear instructing you to insert the SD card.

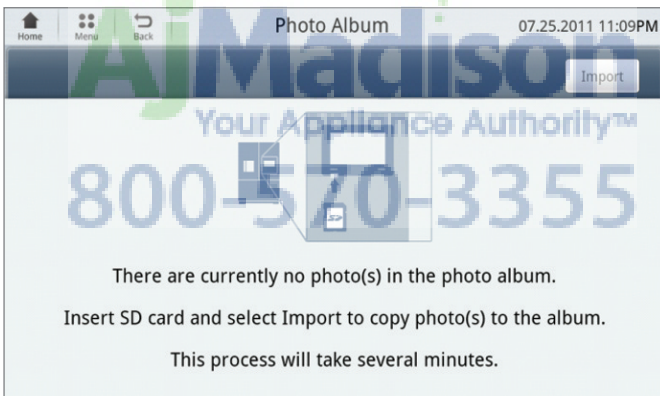

### View Photos

- Select a photo to either post the photo to the Home screen or delete it.
- Touch the Post to homescreen button (1) to post the photo to the Home screen.
- Touch The Delete button (2) to delete the photo.

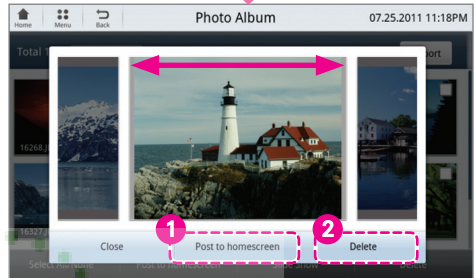
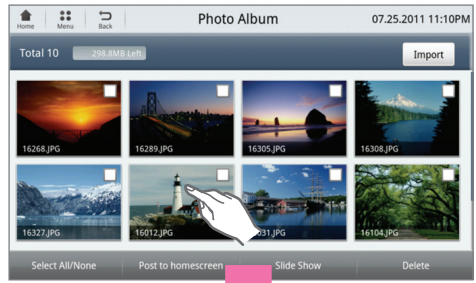

### Slide Show

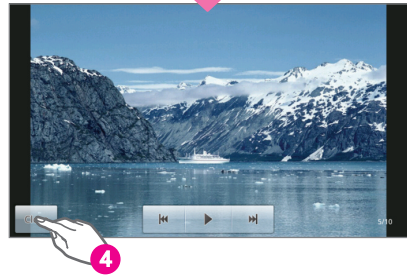
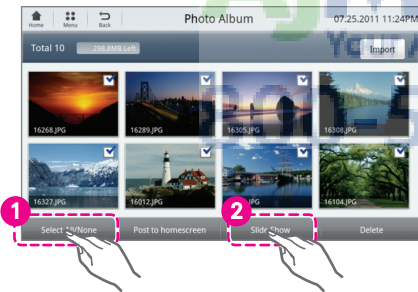

- (1) Photos can be selected one by one. Or by touching "Select All On/Off" all photos can be selected.
- (2) After selecting photos, touch Slide Show to view a slide show of photos.

- (3) Touch the screen to stop the slide show and view the photo being displayed.
- (4) Touch the Close button to switch to the main screen of Photo Album.

## Saving photo to Home Screen

- From the Photo Album screen, select the photo that you would like to save to the Home screen.
- Touch the Post to homescreen button.

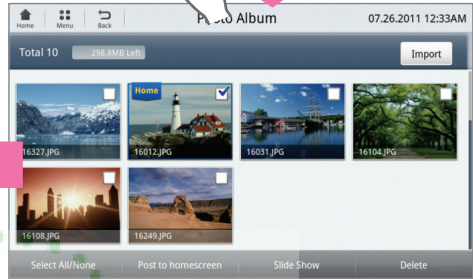
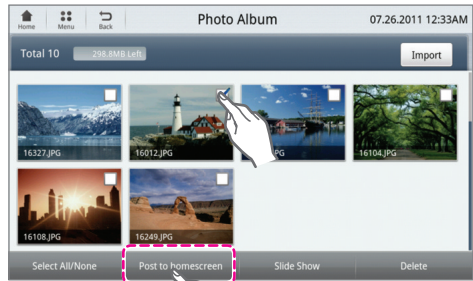
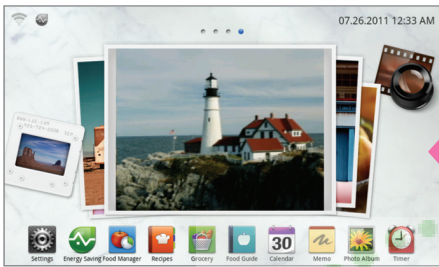

## Uploading photos to the album

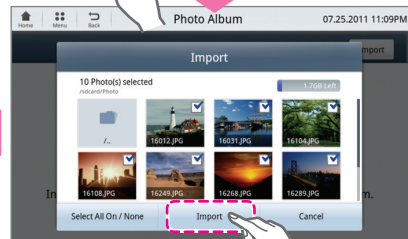

- This should appear in the beginning of the Photo Album section.
- If there are no photos loaded to the album, a screen will display instructing you to import photos from an SD card.
- Insert your SD card into the SD port.
- The photos loaded to your SD card will display on the screen.

- Select the photos that you would like to add to the photo album, or touch the Select All On/ Off button to load all photos on the SD card.
- After selecting the desired photos, touch the Import button.
- Photos are now saved in Photo Album.

## Timer

- Touch the Timer button at the bottom of the Home screen.
- Set up to three timers at a time.

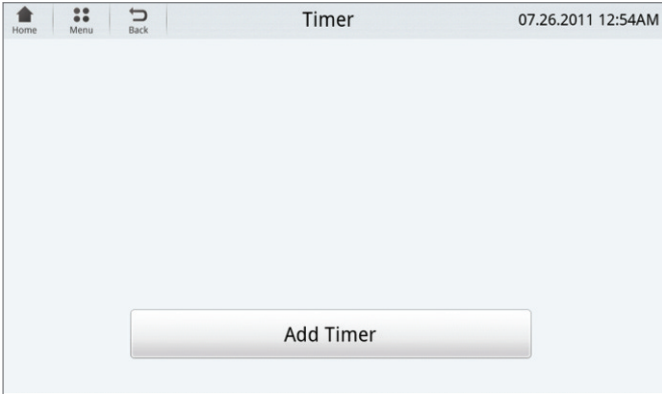

### Setting the Timer

- **1** Touch the Add Timer button.
- **2** Use the +/- buttons to set the timer.
- **3** Touch the Set button.

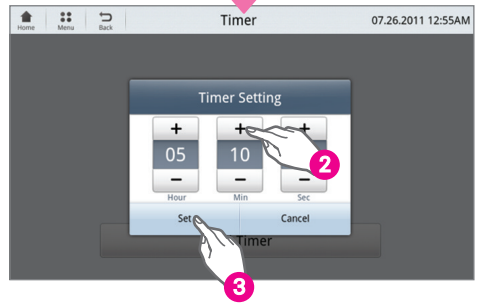
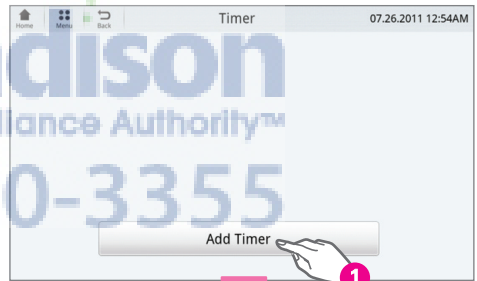

**To delete the timer:**

- Touch the X button next to the timer that you would like to delete.
- Touch the Delete button on the popup.

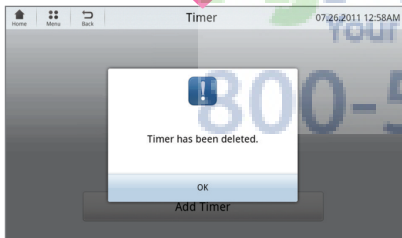
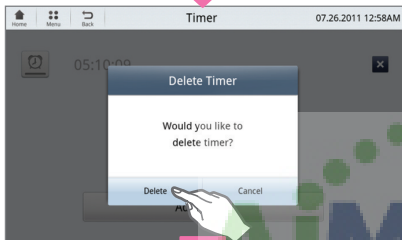
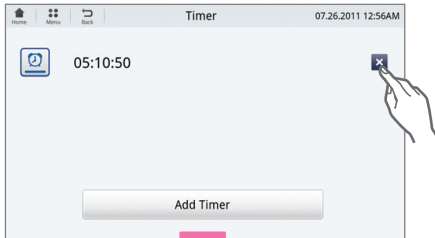
**To turn off the timer:**

- Touch the timer icon. The icon will turn gray once it is off.

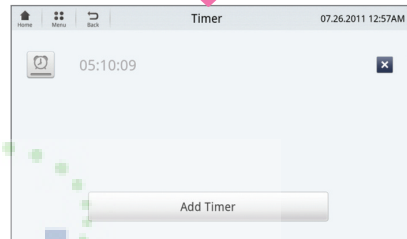
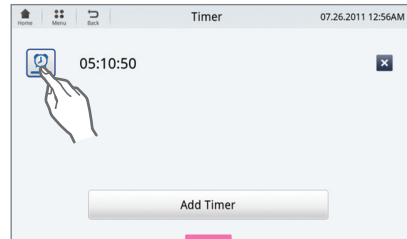

**AjMadison**  
Your Appliance Authority™  
800-570-3355

## Using the Widgets

- A widget is a mini application that can be accessed without using a web browser.
- There are six widgets that are loaded to the display: Weather, Memo, Calendar, Freshness Tracker, Recipes, and Photo Album.
- View the widgets by swiping your finger left or right on the display screen. The Home screen can be set to any of the below widget screens.



\* The user can swipe in the arrow direction to switch over to the next widget.

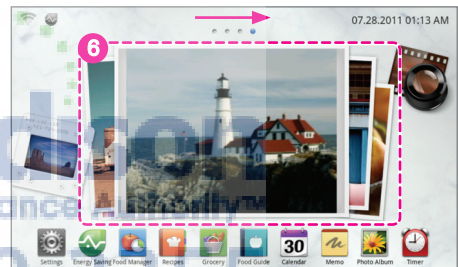

### 1. Weather widget

This displays the current weather image and temperature of the set region.

### 2. Memo widget

This displays the memo 'Post to Homescreen' from the main memo screen.

### 3. Calendar widget

This displays the calendar where the events are displayed on a weekly basis.

### 4. Freshness Tracker widget

This displays the 4 types of foods with the shortest remaining storage period for the food that the user set the storage date.

### 5. Recommended recipe widget

- This recommends and displays recipes that can be prepared based on the stored food in random order.
- The recipe is refreshed once a day (7AM).

- When the user touches the recipe widget, it moves to the recommended recipe to show the user with the description of the recipe.

### 6. Photo widget

This displays the photo 'Post to Homescreen' from the main photo screen.

Setting the weather region



- To change the weather region on the Weather widget:

- Touch the weather widget on the Home screen.

- Touch the Location button on the upper right hand corner of the display.

- Touch the region box.

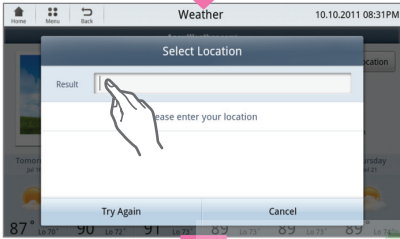

- A Keyboard will display. Type the region that you would like to search and touch the Done button.

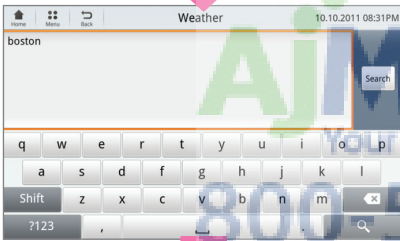

- Select the desired city from the search results.

**CAUTION**

- This function only works when the system is connected to the Wi-Fi network.
- Applicable weather only includes weather information provided by Accuweather Co. Ltd.

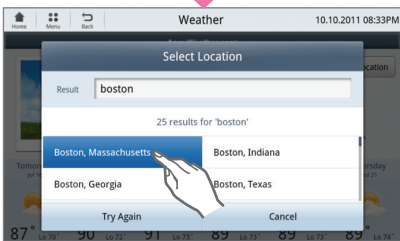

## Using the Freshness Tracker widget

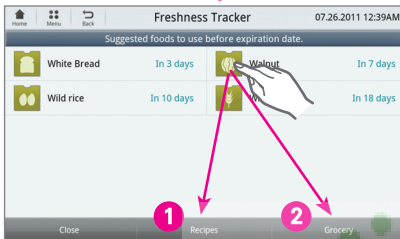

Touch the Freshness Tracker widget at the Home screen.

- When the user drags the applicable food to the applicable button, the user can easily use the function.
- **1** Provide recipe made with food with short storage period.
- **2** When the food is used as the ingredient for the recipe, it is reflected to the Grocery for future purchase.
- Food with short storage period is notified to the user daily through the Freshness Tracker widget.

**AjMadison**  
Your Appliance Authority™  
800-570-3355

# MAINTENANCE

## Cleaning

- Both the refrigerator and freezer sections defrost automatically; however, clean both sections about once a month to prevent odors.
- Wipe up spills immediately.
- Always unplug the refrigeration before cleaning.

### General Cleaning Tips

- Unplug refrigerator or disconnect power.
- Remove all removable parts, such as shelves, crispers, etc.
- Use a clean sponge or soft cloth and a mild detergent in warm water. Do not use abrasive or harsh cleaners.
- Hand wash, rinse and dry all surfaces thoroughly.

### Exterior

Waxing external painted metal surfaces helps provide rust protection. Do not wax plastic parts. Wax painted metal surfaces at least twice a year using appliance wax (or auto paste wax). Apply wax with a clean, soft cloth.

For products with a stainless steel exterior, use a clean sponge or soft cloth and a mild detergent in warm water. Do not use abrasive or harsh cleaners. Dry thoroughly with a soft cloth.



#### CAUTION

- Do not use a rough cloth or sponge when cleaning the interior and exterior of the refrigerator.
- Do not place your hand on the bottom surface of the refrigerator when opening and closing.



#### WARNING

Use non-flammable cleaner. Failure to do so can result in fire, explosion, or death.

### Inside Walls (allow freezer to warm up so the cloth will not stick)

To help remove odors, you can wash the inside of the refrigerator with a mixture of baking soda and warm water. Mix 2 tablespoons of baking soda to 1 quart of water (26 g soda to 1 liter water.) Be sure the baking soda is completely dissolved so it does not scratch the surfaces of the refrigerator.

### Door Liners and Gaskets

Use a clean sponge or soft cloth and a mild detergent in warm water. Do not use cleaning waxes, concentrated detergents, bleaches, or cleaners containing petroleum on plastic refrigerator parts.

### Plastic Parts (covers and panels)

Use a clean sponge or soft cloth and a mild detergent in warm water. Do not use window sprays, abrasive cleansers, or flammable fluids. These can scratch or damage the material.

### Condenser Coils

Use a vacuum cleaner with an attachment to clean the condenser cover and vents. Do not remove the panel covering the condenser coil area.

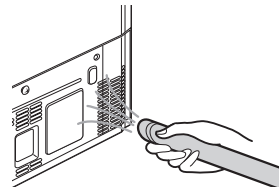

## Replacing the Water Filter

It is recommended that you replace the filter approximately every 6 months, when the water filter indicator reaches 0 months, or when the ice and water dispenser noticeably decreases out-put.

### Remove the old cartridge.

1. Press the push button to open the filter cover.

#### NOTE

- Replacing the filter causes a small amount of water (around 1 oz. or 25 cc) to drain. Place a cup under the filter hole to catch any waste.

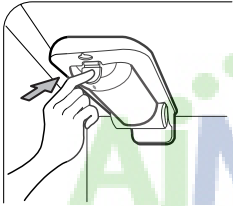

3. Pull out the filter cartridge.

#### NOTE

- When opened at a full angle the cartridge should easily come out.

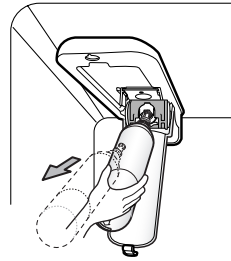

### Replace with a new cartridge.

1. Take the new cartridge out of its packing and remove the protective cover from the o-rings. With cartridge ears in the horizontal position, push the new filter cartridge into the manifold hole until it stops.

2. Pull the cartridge downward.

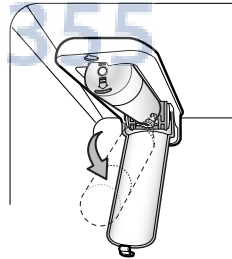
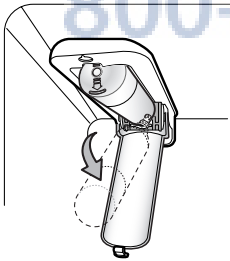

2. Firmly lock in the cartridge. The cover will click back into place.

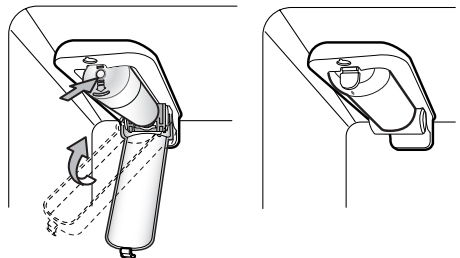

**NOTE**

- After replacing the filter, flush 2.5 gallons through filter before use (flush for approximately 5 minutes). Check the filter for leaks.



When the water filter indicator displays the message 0 Filter Month, hold 3 seconds. Reset the water filter status display and indicator light by pressing and holding the LIGHT/FILTER button for at least 3 seconds.

**Filter Bypass Plug**

Keep the filter bypass plug.

You must use the filter bypass plug when a replacement filter cartridge is not available.

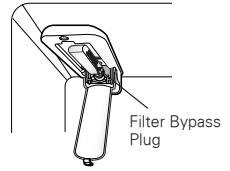

The icemaker will not operate without the filter or filter bypass plug inserted in the proper compartment.

To purchase replacement water filter cartridges, visit your local appliance dealer or parts distributor.

You can also call USA 1-800-243-0000  
CANADA 1-888-LGCANADA (24 hours per day/  
7 days per week).

The replacement water filter cartridge's part number is ADQ36006101.



## Performance Data Sheet

Model: LG ADQ36006101-S

Use Replacement Cartridge: ADQ36006101

The concentration of the indicated substances in water entering the system was reduced to a concentration less than or equal to the permissible limit for water leaving the system as specified in NSF/ANSI Standard 42 and Standard 53.



System tested and certified by NSF International against NSF/ANSI Standard 42 and Standard 53 for the reduction of substances listed below.

Contaminant Reduction	Average Influent	NSF specified Challenge Concentration	Avg % Reduction	Average Product Water Concentration	Max Permissible Product Water Concentration	NSF Reduction Requirements	NSF Test Report
Chlorine Taste and Odor	2.1 mg/L	2.0 mg/L ± 10%	97.2%	0.06 mg/L	N/A	≥ 50%	J-00049247
Nominal Particulate Class 1, , ≥ 0.5 to < 1.0 µm	5,600,000 pts/mL	At least 10,000 particles/mL	98.7%	73,000 pts/ml	N/A	≥ 85%	J-00049282
Asbestos	190 MFL	107 to 108 MFL; fibers greater than 10 µm in length	>99%	< 1MLF	N/A	≥ 99%	J-0004928
Atrazine	0.0094 mg/L	0.009 mg/L ± 10%	94.7%	0.00005 mg/L	0.003 mg/L	N/A	J-00049293
Benzene	0.016 mg/L	0.015 mg/L ± 10%	96.7%	0.005 mg/L	0.005 mg/L	N/A	J-00049300
Carbofuran	0.08 mg/L	0.08 mg/L ± 10%	98.1%	0.002 mg/L	0.04 mg/L	N/A	J-00049294
Lindane	0.002 mg/L	0.002 mg/L ± 10%	98.2%	0.00004 mg/L	0.0002 mg/L	N/A	J-00051975
P-Dichlorobenzene	0.22 mg/L	0.225 mg/L ± 10%	99.8%	0.0005 mg/L	0.075 mg/L	N/A	J-00049298
Toxaphene	0.014 mg/L	0.015 mg/L ± 10%	93%	0.001 mg/L	0.003 mg/L	N/A	J-00049302
2,4-D	0.213 mg/L	0.210 mg/L ± 10%	95.2%	0.009 mg/L	0.07 mg/L	N/A	J-00049284
Lead pH @6.5	0.150 mg/L	0.15 mg/L ± 10%	>99.3%	0.001 mg/L	0.010 mg/L	N/A	J-00051974
Lead pH @8.5	0.150 mg/L	0.15 mg/L ± 10%	>99.3%	0.001 mg/L	0.010 mg/L	N/A	J-00049277
Mercury @ pH 6.5	0.0059 mg/L	0.006 mg/L ± 10%	96.1	0.0002 mg/L	0.002 mg/L	N/A	J-00053886
Mercury @ pH 8.5	0.0058 mg/L	0.006 mg/L ± 10%	90.1	0.0006 mg/L	0.002 mg/L	N/A	J-00051972
Cyst*	120,000 cysts/L	Minimum 50,000 cysts/L	99.99%	<1 cyst/L	N/A	≥ 99.95%	J-00049281

\* Based on the use of Cryptosporidium parvum oocysts.

Application Guidelines/Water Supply Parameters	
Service Flow	0.5 gpm (1.9 lpm)
Water Supply	Potable Water
Water Pressure	20 -120 psi (138 - 827 kPa)
Water Temperature	33°F - 100°F (0.6°C - 38°C)

It is essential that the manufacturer’s recommended installation, maintenance and filter replacement requirements be carried out for the product to perform as advertised.

**NOTE**

- While the testing was performed under standard laboratory conditions, actual performance may vary.
- Replacement Cartridge: **ADQ36006101**
- For estimated costs of replacement elements please call USA **1-800-243-0000** CANADA **1-888-LGCANADA** (24 hours per day/7 days per week) or visit our website at [www.lg.com](http://www.lg.com)

3M is a trademark of 3M Company.  
 NSF is a trademark of NSF International.  
 © 2009 3M Company. All rights reserved.

**WARNING**

**To reduce the risk associated with ingestion of contaminants:**

Do not use with water that is microbiologically unsafe or of unknown quality without adequate disinfection before and after the system.

Systems certified for cyst reduction may be used on disinfected water that may contain filterable cysts.

EPA Establishment Number 10350-MN-005

**CAUTION**

**To reduce the risk associated with property damage due to water leakage:**

- Read and follow. Use Instructions before installation and use of this system.
- Installation and use **MUST** comply with all state and local plumbing codes.
- Do not install if water pressure exceeds 120 psi (827 kPa). If your water pressure exceeds 80 psi, you must install a pressure limiting valve. Contact a plumbing professional if you are uncertain how to check your water pressure.
- Do not install where water hammer conditions may occur. If water hammer conditions exist you must install a water hammer arrester. Contact a plumbing professional if you uncertain how to check for this condition.
- Do not install on hot water supply lines. The maximum operating water temperature of this filter system is 100°F (38°C).
- Protect filter from freezing. Drain filter when temperatures drop below 40°F (4.4°C).
- The disposable filter cartridge must be replaced every 6 months, at the rated capacity or if a noticeable reduction in flow rate occurs.

Manufactured for LG@Electronics by CUNO Incorporated 400 Research Parkway Meriden, CT 06450 U.S.A Worldwide: 203-237-5541 [www.cuno.com](http://www.cuno.com)

State of California  
 Department of Public Health  
**Water Treatment Device**  
**Certificate Number**  
**09-2018**

Date Issued: December 15, 2009

**Trademark/Model Designation**

ADQ36006101-S

**Replacement Elements**

ADQ36006101

**Manufacturer:** Cuno Inc.

The water treatment device(s) listed on this certificate have met the testing requirements pursuant to Section 116830 of the Health and Safety Code for the following health related contaminants:

**Microbiological Contaminants and Turbidity**

Cysts

**Inorganic/Radiological Contaminants**

Asbestos  
 Lead  
 Mercury

**Organic Contaminants**

2,4-D Reduction  
 Atrazine  
 Benzene  
 Carbofuran  
 Lindane  
 p-Dichlorobenzene  
 Toxaphene

**Rated Service Capacity:** 200 gal

**Rated Service Flow:** 0.5 gpm

**Conditions of Certification:**



# SMART DIAGNOSIS



Should you experience any problems with your refrigerator, it has the capability of transmitting data via your telephone to the LG service center. This gives you the capability of speaking directly to our trained specialists. The specialist records the data transmitted from your machine and uses it to analyze the issue, providing a fast and effective diagnosis.

If you experience problems with your refrigerator, call 1-800-243-0000. Only use the Smart Diagnosis feature when instructed to do so by the LG call center agent. The transmission sounds that you will hear are normal and sound similar to a fax machine.

Smart Diagnosis cannot be activated unless your refrigerator is connected to power. If your refrigerator is unable to turn on, then troubleshooting must be done without using Smart Diagnosis.

## Using Smart Diagnosis

First, call 1-800-243-0000. Only use the Smart Diagnosis feature when instructed to do so by the LG call center agent.

- 1 Lock the display. To lock the display, press and hold the Lock button for three seconds. (If the display has been locked for over five minutes, you must deactivate the lock and then reactivate it.)



- 2 Open the right refrigerator door.

- 3 Hold the mouthpiece of your phone in front of the speaker that is located on the right hinge of the refrigerator door, when instructed to do so by the call center.

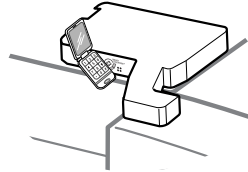

- 4 Press and hold the Freezer Temperature button for three seconds while continuing to hold your phone to the speaker.

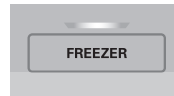

- 5 After you hear three beeps, release the Freezer Temperature button.
- 6 Keep the phone in place until the tone transmission has finished. This takes about 15 seconds, and the display will count down the time. Once the countdown is over and the tones have stopped, resume your conversation with the specialist, who will then be able to assist you in using the information transmitted for analysis.

### ! NOTE

- For best results, do not move the phone while the tones are being transmitted.
- If the call center agent is not able to get an accurate recording of the data, you may be asked to try again.

# TROUBLESHOOTING

Review the Troubleshooting section before calling for service; doing so will save you both time and money.

Problem	Possible Causes	Solutions
Refrigerator and Freezer section are not cooling.	The refrigerator control is set to OFF (some models).	Turn the control ON. Refer to the Setting the Controls section for proper temperature settings.
	Refrigerator is in the defrost cycle.	During the defrost cycle, the temperature of each compartment may raise slightly. Wait 30 minutes and confirm the proper temperature has been restored once the defrost cycle has completed.
	Refrigerator was recently installed.	It may take up to 24 hours for each compartment to reach the desired temperature.
	Refrigerator was recently relocated.	If the refrigerator was stored for a long period of time or moved on its side, it is necessary for the refrigerator to stand upright for 24 hours before connecting it to power.
Cooling System runs too much.	Refrigerator is replacing an older model.	Modern refrigerators require more operating time but use less energy due to more efficient technology.
	Refrigerator was recently plugged in or power restored.	The refrigerator will take up to 24 hours to cool completely.
	Door opened often or a large amount of food / hot food was added.	Adding food and opening the door warms the refrigerator, requiring the compressor to run longer in order to cool the refrigerator back down. In order to conserve energy, try to get everything you need out of the refrigerator at once, keep food organized so it is easy to find, and close the door as soon as the food is removed. (Refer to the Food Storage Guide.)
	Doors are not closed completely.	Firmly push the doors shut. If they will not shut all the way, see the Doors will not close completely or pop open section in Parts & Features Troubleshooting.
	Refrigerator is installed in a hot location.	The compressor will run longer under warm conditions. At normal room temperatures (70°F) expect your compressor to run about 40% to 80% of the time. Under warmer conditions, expect it to run even more often. The refrigerator should not be operated above 110°F.
	Condenser / back cover is clogged.	Use a vacuum cleaner with an attachment to clean the condenser cover and vents. Do not remove the panel covering the condenser coil area.

Problem	Possible Causes	Solutions
Refrigerator or Freezer section is too warm.	Refrigerator was recently installed.	It may take up to 24 hours for each compartment to reach the desired temperature.
	Air vents are blocked.	Rearrange items to allow air to flow throughout the compartment. Refer to the Airflow diagram in the Using Your Refrigerator section.
	Doors are opened often or for long periods of time.	When the doors are opened often or for long periods of time, warm, humid air enters the compartment. This raises the temperature and moisture level within the compartment. To lessen the effect, reduce the frequency and duration of door openings.
	Unit is installed in a hot location.	The refrigerator should not be operated in temperatures above 110°F.
	A large amount of food or hot food was added to either compartment.	Adding food warms the compartment requiring the cooling system to run. Allowing hot food to cool to room temperature before putting it in the refrigerator will reduce this effect.
	Doors not closed correctly.	See the Doors will not close correctly or pop open section in Parts & Features Troubleshooting.
	Temperature control is not set correctly.	If the temperature is too warm, adjust the control one increment at a time and wait for the temperature to stabilize. Refer to the Setting the Controls section for more information.
	Defrost cycle has recently completed.	During the defrost cycle, the temperature of each compartment may raise slightly and condensation may form on the back wall. Wait 30 minutes and confirm the proper temperature has been restored once the defrost cycle has completed.

Problem	Possible Causes	Solutions
Interior moisture buildup.	Doors are opened often or for long periods of time.	When the doors are opened often or for long periods of time, warm, humid air enters the compartment. This raises the temperature and moisture level within the compartment. To lessen the effect, reduce the frequency and duration of door openings.
	Doors not closed correctly.	See the Doors will not close correctly section in the Troubleshooting section.
	Weather is humid.	Humid weather allows additional moisture to enter the compartments when the doors are opened leading to condensation or frost. Maintaining a reasonable level of humidity in the home will help to control the amount of moisture that can enter the compartments.
	Defrost cycle recently completed.	During the defrost cycle, the temperature of each compartment may raise slightly and condensation may form on the back wall. Wait 30 minutes and confirm that the proper temperature has been restored once the defrost cycle has completed.
	Food is not packaged correctly.	Food stored uncovered or unwrapped, and damp containers can lead to moisture accumulation within each compartment. Wipe all containers dry and store food in sealed packaging to prevent condensation and frost.
Food is freezing in the refrigerator compartment.	Food with high water content was placed near an air vent.	Rearrange items with high water content away from air vents.
	Refrigerator temperature control is set incorrectly.	If the temperature is too cold, adjust the control one increment at a time and wait for the temperature to stabilize. Refer to the Setting the Controls section for more information.
	Refrigerator is installed in a cold location.	When the refrigerator is operated in temperature below 41°F (5°C), food can freeze in the refrigerator compartment. The refrigerator should not be operated in temperature below 55°F (13°C).
Frost or ice crystals form on frozen food (outside of package).	Door is opened frequently or for long periods of time.	When the doors are opened often or for long periods of time, warm, humid air enters the compartment. This raises the temperature and moisture level within the compartment. Increased moisture will lead to frost and condensation. To lessen the effect, reduce the frequency and duration of door openings.
	Door is not closing properly.	Refer to the Doors will not close correctly or pop open section in the Troubleshooting section.
Refrigerator or Freezer section is too cold.	Incorrect temperature control settings.	If the temperature is too cold, adjust the control one increment at a time and wait for the temperature to stabilize. Refer to the Setting the Controls section for more information.

Problem	Possible Causes	Solutions
Frost or ice crystals on frozen food (inside of sealed package).	Condensation from food with a high water content has frozen inside of the food package.	This is normal for food items with a high water content.
	Food has been left in the freezer for a long period of time.	Do not store food items with high water content in the freezer for a long period of time.
Icemaker is not making enough ice.	Demand exceeds ice storage capacity.	The icemaker will produce approximately 100 cubes in a 24 hour period.
	House water supply is not connected, valve is not turned on fully, or valve is clogged.	Connect the refrigerator to a cold water supply with adequate pressure and turn the water shutoff valve fully open. If the problem persists, it may be necessary to contact a plumber.
	Water filter has been exhausted.	It is recommended that you replace the water filter: <ul style="list-style-type: none"> <li>• Approximately every six months.</li> <li>• When the water filter indicator turns on.</li> <li>• When the water dispenser output decreases.</li> <li>• When the ice cubes are smaller than normal.</li> </ul>
	Low house water supply pressure.	The water pressure must be between 20 and 120 psi on models without a water filter and between 43 and 121 psi on models with a water filter. If the problem persists, it may be necessary to contact a plumber.
	Reverse Osmosis filtration system is used.	Reverse osmosis filtration systems can reduce the water pressure below the minimum amount and result in icemaker issues. (Refer to Water Pressure section.)
	Tubing connecting refrigerator to house supply valve is kinked.	The tubing can kink when the refrigerator is moved during installation or cleaning resulting in reduced water flow. Straighten or repair the water supply line and arrange it to prevent future kinks.

Problem	Possible Causes	Solutions
Icemaker is not making enough ice (continued).	Doors are opened often or for long periods of time.	If the doors of the unit are opened often, ambient air will warm the refrigerator which will prevent the unit from maintaining the set temperature. Lowering the refrigerator temperature can help, as well as not opening the doors as frequently.
	Doors are not closed completely.	If the doors are not properly closed, ice production will be affected. See the Doors will not close completely or pop open section in Parts & Features Troubleshooting for more information.
	The temperature setting for the freezer is too warm.	The recommended temperature for the freezer compartment for normal ice production is 0°F. If the freezer temperature is warmer, ice production will be affected.
Dispensing water slowly.	Water filter has been exhausted.	It is recommended that you replace the water filter: <ul style="list-style-type: none"> <li>• Approximately every six months.</li> <li>• When the water filter indicator turns on.</li> <li>• When the water dispenser output decreases.</li> <li>• When the ice cubes are smaller than normal.</li> </ul>
	Reverse osmosis filtration system is used.	Reverse osmosis filtration systems can reduce the water pressure below the minimum amount and result in icemaker issues. If the problem persists, it may be necessary to contact a plumber.
	Low house water supply pressure.	The water pressure must be between 20 and 120 psi on models without a water filter and between 43 and 121 psi on models with a water filter.  If the problem persists, it may be necessary to contact a plumber.

Problem	Possible Causes	Solutions
Not dispensing ice.	Doors are not closed completely.	Ice will not dispense if any of the refrigerator doors are left open.
	Infrequent use of the dispenser.	Infrequent use of the ice dispenser will cause the cubes to stick together over time, which will prevent them from properly dispensing. Check the ice bin for ice cubes clumping/sticking together. If they are, break up the ice cubes to allow for proper operation.
	The delivery chute is clogged with frost or ice fragments.	Eliminate the frost or ice fragments by removing the ice bin and clearing the chute with a plastic utensil. Dispensing cubed ice can also help prevent frost or ice fragment buildup.
	The dispenser display is locked.	Press and hold the Lock button for three seconds to unlock the control panel and dispenser.
	Ice bin is empty.	It may take up to 24 hours for each compartment to reach the desired temperature and for the icemaker to begin making ice. Make sure that the shutoff (arm/sensor) is not obstructed.  Once the ice supply in the bin has been completely exhausted, it may take up to 90 minutes before additional ice is available, and approximately 24 hours to completely refill the bin.
Icemaker is not making ice.	Refrigerator was recently installed or icemaker recently connected.	It may take up to 24 hours for each compartment to reach the desired temperature and for the icemaker to begin making ice.
	Icemaker not turned on.	Locate the icemaker ON/OFF switch and confirm that it is in the ON (I) position.
	The ice detecting sensor is obstructed.	Foreign substances or frost on the ice-detecting sensor can interrupt ice production. Make sure that the sensor area is clean at all times for proper operation.
	The refrigerator is not connected to a water supply or the supply shutoff valve is not turned on.	Connect refrigerator to the water supply and turn the water shutoff valve fully open.
	Icemaker shutoff (arm or sensor) obstructed.	If your icemaker is equipped with an ice shutoff arm, make sure that the arm moves freely. If your icemaker is equipped with the electronic ice shutoff sensor, make sure that there is a clear path between the two sensors.
	Reverse osmosis water filtration system is connected to your cold water supply.	Reverse osmosis filtration systems can reduce the water pressure below the minimum amount and result in icemaker issues. (Refer to the Water Pressure section.)

Problem	Possible Causes	Solutions
Not dispensing water.	New installation or water line recently connected.	Dispense 2.5 gallons of water (flush for approximately 5 minutes) to remove trapped air and contaminants from the system. Do not dispense the entire 2.5 gallon amount continuously. Depress and release the dispenser pad for cycles of 30 seconds ON and 60 seconds OFF.
	The dispenser panel is locked.	Press and hold the Lock button for three seconds to unlock the control panel and dispenser.
	The dispenser is not set for water dispensing.	The dispenser can be set for ice or water. Make certain that the control panel is set for the proper operation. Press the Water button on the control panel to dispense water.
	Refrigerator or freezer doors are not closed properly.	Water will not dispense if any of the refrigerator doors are left open.
	Water filter has been recently removed or replaced.	After the water filter is replaced, dispense 2.5 gallons of water (flush for approximately 5 minutes) to remove trapped air and contaminants from the system. Do not dispense the entire 2.5 gallon amount continuously. Depress and release the dispenser pad for cycles of 30 seconds ON and 60 seconds OFF.
	Tubing connecting refrigerator to house supply valve is kinked.	The tubing can kink when the refrigerator is moved during installation or cleaning resulting in reduced water flow. Straighten or repair the water supply line and arrange it to prevent future kinks.
	The house water supply is not connected, the valve is not turned on fully, or the valve is clogged.	Connect refrigerator to the water supply and turn the water shutoff valve fully open.  If the problem persists, it may be necessary to contact a plumber.

Problem	Possible Causes	Solutions
Ice has bad taste or odor.	Water supply contains minerals such as sulfur.	A water filter may need to be installed to eliminate taste and odor problems.  NOTE: In some cases, a filter may not help. It may not be possible to remove all minerals / odor / taste in all water supplies.
	Icemaker was recently installed.	Discard the first few batches of ice to avoid discolored or bad tasting ice.
	Ice has been stored for too long.	Ice that has been stored for too long will shrink, become cloudy, and may develop a stale taste. Throw away old ice and make a new supply.
	The food has not been stored properly in either compartment.	Rewrap the food. Odors may migrate to the ice if food is not wrapped properly.
	The interior of the refrigerator needs to be cleaned.	See the Care and Cleaning section for more information.
	The ice storage bin needs to be cleaned.	Empty and wash the bin (discard old cubes). Make sure that the bin is completely dry before reinstalling it.
Dispensing warm water.	Refrigerator was recently installed.	Allow 24 hours after installation for the water storage tank to cool completely.
	The water dispenser has been used recently and the storage tank was exhausted.	Depending on your specific model, the water storage capacity will range from approximately 20 to 30 oz.
	Dispenser has not been used for several hours.	If the dispenser has not been used for several hours, the first glass dispensed may be warm. Discard the first 10 oz.
	Refrigerator is connected to the hot water supply.	Make sure that the refrigerator is connected to a cold water pipe.  ⚠️ WARNING: Connecting the refrigerator to a hot water line may damage the icemaker.
Water has bad taste or odor.	Water supply contains minerals such as sulfur.	A water filter may need to be installed to eliminate taste and odor problems.
	Water filter has been exhausted.	It is recommended that you replace the water filter: <ul style="list-style-type: none"> <li>• Approximately every 6 months.</li> <li>• When the water filter indicator turns on.</li> <li>• When the water dispenser output decreases.</li> <li>• When the ice cubes are smaller than normal.</li> </ul>
	Refrigerator was recently installed.	Dispense 2.5 gallons of water (flush for approximately 5 minutes) to remove trapped air and contaminants from the system. Do not dispense the entire 2.5 gallon amount continuously. Depress and release the dispenser pad for cycles of 30 seconds ON and 60 seconds OFF.

Problem	Possible Causes	Solutions
Icemaker is making too much ice.	Icemaker shutoff (arm/sensor) is obstructed.	Empty the ice bin. If your icemaker is equipped with an ice shutoff arm, make sure that the arm moves freely. If your icemaker is equipped with the electronic ice shutoff sensor, make sure that there is a clear path between the two sensors. Reinstall the ice bin and wait 24 hours to confirm proper operation.
Clicking	The defrost control will click when the automatic defrost cycle begins and ends. The thermostat control (or refrigerator control on some models) will also click when cycling on and off.	Normal Operation
Rattling	Rattling noises may come from the flow of refrigerant, the water line on the back of the unit, or items stored on top of or around the refrigerator.	Normal Operation
	Refrigerator is not resting solidly on the floor.	Floor is weak or uneven or leveling legs need to be adjusted. See the Door Alignment section.
	Refrigerator with linear compressor was jarred while running.	Normal Operation
Whooshing	Evaporator fan motor is circulating air through the refrigerator and freezer compartments.	Normal Operation
	Air is being forced over the condenser by the condenser fan.	Normal Operation
Gurgling	Refrigerant flowing through the cooling system.	Normal Operation
Popping	Contraction and expansion of the inside walls due to changes in temperature.	Normal Operation
Sizzling	Water dripping on the defrost heater during a defrost cycle.	Normal Operation
Vibrating	If the side or back of the refrigerator is touching a cabinet or wall, some of the normal vibrations may make an audible sound.	To eliminate the noise, make sure that the sides and back cannot vibrate against any wall or cabinet.
Dripping	Water running into the drain pan during the defrost cycle.	Normal Operation

Problem	Possible Causes	Solutions
Pulsating or High-Pitched Sound	Your refrigerator is designed to run more efficiently to keep your food items at the desired temperature. The high efficiency compressor may cause your new refrigerator to run longer than your old one, but it is still more energy efficient than previous models. While the refrigerator is running, it is normal to hear a pulsating or high-pitched sound.	Normal Operation
Doors will not close correctly or pop open.	Food packages are blocking the door open.	Rearrange food containers to clear the door and door shelves.
	Ice bin, crisper cover, pans, shelves, door bins, or baskets are out of position.	Push bins all the way in and put crisper cover, pans, shelves and baskets into their correct positions. See the Using Your Refrigerator section for more information.
	The doors were removed during product installation and not properly replaced.	Remove and replace the doors according to the Removing and Replacing Refrigerator Handles and Doors section.
	Refrigerator is not leveled properly.	See Door Alignment in the Refrigeration Installation section to level refrigerator.
Doors are difficult to open.	The gaskets are dirty or sticky.	Clean the gaskets and the surfaces that they touch. Rub a thin coat of appliance polish or kitchen wax on the gaskets after cleaning.
	Door was recently closed.	When you open the door, warmer air enters the refrigerator. As the warm air cools, it can create a vacuum. If the door is hard to open, wait one minute to allow the air pressure to equalize, then see if it opens more easily.
Refrigerator wobbles or seems unstable.	Leveling legs are not adjusted properly.	Refer to the Leveling and Door Alignment section.
	Floor is not level.	It may be necessary to add shims under the leveling legs or rollers to complete installation.
Lights do not work.	LED interior lighting failure.	The refrigerator compartment lamp is LED interior lighting, and service should be performed by a qualified technician.
Refrigerator has an unusual odor.	The Air Filter may need to be set to the MAX setting or replaced.	Set the Air Filter to the MAX setting. If the odor does not go away within 24 hours, the filter may need to be replaced. See the Replacing the Air Filter section for replacement instructions.
The interior of the refrigerator is covered with dust or soot.	The refrigerator is located near a fire source, such as a fireplace, chimney or candle.	Make sure that the refrigerator is not located near a fire source, such as a fireplace, chimney or candle.

## WARRANTY (USA)

Should your LG Refrigerator ("Product") fail due to a defect in materials or workmanship under normal home use, during the warranty period set forth below, LG will at its option repair or replace the product. This limited warranty is valid only to the original retail purchaser of the product and applies only when purchased and used within the United States including U.S. Territories. Proof of original retail purchase is required to obtain warranty service under this limited warranty.

WARRANTY PERIOD			
Refrigerator	Sealed System (Condenser, Dryer, Connecting Tube, Refrigerant and Evaporator)		Linear Compressor
One (1) year from the date of original retail purchase	One (1) year from the date of original retail purchase	Seven (7) years from the date of original retail purchase	Ten (10) years from the date of original retail purchase
Parts and Labor (internal/functional parts only)	Parts and Labor	Parts only (Consumer will be charged for labor)	Part only (Consumer will be charged for labor)

Noises associated with normal operation and failure to follow instructions found in the use and care and installation guides or operating the unit in an unsuitable environment will not be covered under this warranty.

- ▶ Replacement products and parts are warranted for the remaining portion of the original warranty period or ninety (90) days, whichever is greater.
- ▶ Replacement products and parts may be new or remanufactured.

**THIS WARRANTY IS IN LIEU OF ANY OTHER WARRANTY, EXPRESS OR IMPLIED, INCLUDING WITHOUT LIMITATION, ANY WARRANTY OF MERCHANTABILITY OR FITNESS FOR A PARTICULAR PURPOSE. TO THE EXTENT ANY IMPLIED WARRANTY IS REQUIRED BY LAW, IT IS LIMITED IN DURATION TO THE EXPRESS WARRANTY PERIOD ABOVE. NEITHER THE MANUFACTURER NOR ITS U.S. DISTRIBUTOR SHALL BE LIABLE FOR ANY INCIDENTAL, CONSEQUENTIAL, INDIRECT, SPECIAL, OR PUNITIVE DAMAGES OF ANY NATURE, INCLUDING WITHOUT LIMITATION, LOST REVENUES OR PROFITS, OR ANY OTHER DAMAGE WHETHER BASED IN CONTRACT, TORT, OR OTHERWISE.** Some states do not allow the exclusion or limitation of incidental or consequential damages or limitations on how long an implied warranty lasts, so the above exclusion or limitation may not apply to you. This warranty gives you specific legal rights and you may also have other rights that vary from state to state.

**THIS LIMITED WARRANTY DOES NOT COVER:**

1. Service trips to deliver, pick up, install, or repair the product; instruct the customer on operation of the product; repair or replace fuses or correct wiring or plumbing, or correction of unauthorized repairs/installation.
2. Failure of product to perform during power failures and interruptions or inadequate electrical service.
3. Damage caused by leaky or broken water pipes, frozen water pipes, restricted drain lines, inadequate or interrupted water supply or inadequate supply of air.
4. Damage resulting from operating the product in a corrosive atmosphere or contrary to the instructions outlined in the product owner's manual.
5. Damage to the product caused by accidents, pests and vermin, lightning, wind, fire, floods, or acts of God.
6. Damage resulting from misuse, abuse, improper installation, repair, or maintenance. Improper repair includes use of parts not approved or specified by LG.
7. Damage or failure caused by unauthorized modification or alteration, or if it is used for other than the intended purpose, or any water leakage where the unit was not properly installed.
8. Damage or failure caused by incorrect electrical current, voltage, or plumbing codes, commercial or industrial use, or use of accessories, components, or consumable cleaning products that are not approved by LG.
9. Damage caused by transportation and handling, including scratches, dents, chips, and/or other damage to the finish of your product, unless such damage results from defects in materials or workmanship and is reported within one (1) week of delivery (Call: 1-800-243-0000).
10. Damage or missing items to any display, open box, discounted, or refurbished product.
11. Products with original serial numbers that have been removed, altered, or can not be readily determined. Model and Serial numbers, along with original retail sales receipt, are required for warranty validation.
12. Increases in utility costs and additional utility expenses.
13. Replacement of light bulbs, filters, or any consumable parts.
14. Repairs when your product is used in other than normal and usual household use (e.g. commercial use, offices, and recreational facilities) or contrary to the instructions outlined in the product owner's manual.
15. Costs associated with removal of your product from your home for repairs.
16. The removal and reinstallation of the product if it is installed in an inaccessible location or is not installed in accordance with published installation instructions, including LG's owner's and installation manuals.
17. Shelves, door bins, drawers, handles, accessories, and other parts besides those that were originally included with this particular model.

**The cost of repair or replacement under these excluded circumstances shall be borne by the consumer.**

**For complete warranty details and customer assistance, please call or visit our website:**

Call 1-800-243-0000 (24 hours a day, 365 days a year) and select the appropriate option from the menu, or visit our website at <http://www.lg.com> Or by mail: LG Customer Information Center: P. O. Box 240007, 201 James Record Road Huntsville, Alabama 35813 ATTN: CIC

Write your warranty information below: \_\_\_\_\_

Product Registration Information: \_\_\_\_\_

Model: \_\_\_\_\_

Serial Number: \_\_\_\_\_

Date of Purchase: \_\_\_\_\_

## WARRANTY (Canada)

**WARRANTY:** Should your LG Refrigerator (“Product”) fail due to a defect in material or workmanship under normal home use during the warranty period set forth below, LG Canada will at its option repair or replace the Product upon receipt of proof of original retail purchase. This warranty is valid only to the original retail purchaser of the product and applies only to a Product distributed in Canada by LG Canada or an authorized Canadian distributor thereof. The warranty only applies to Products located and used within Canada.

<b>WARRANTY PERIOD:</b> (Note: If the original date of purchase can not be verified, the warranty will begin sixty (60) days from the date of manufacture)			
<b>Refrigerator/ Freezer</b>	<b>Sealed System (Condenser, Dryer, Connecting Tube, Refrigerant and Evaporator)</b>		<b>Linear Compressor</b>
<b>One (1) year from the date of original retail purchase</b>	<b>One (1) year from the date of original retail purchase</b>	<b>Seven (7) years from the date of original retail purchase</b>	<b>Ten (10) years from the date of original retail purchase</b>
Parts and Labor (internal/functional parts only)	Parts and Labor	Parts only (Consumer will be charged for labor)	Part only (Consumer will be charged for labor)

Noises associated with normal operation and failure to follow instructions found in the use and care and installation guides or operating the unit in an unsuitable environment will not be covered under this warranty.

- ▶ Replacement products and parts are warranted for the remaining portion of the original warranty period or ninety (90) days, whichever is greater.
- ▶ Replacement products and parts may be new or remanufactured.
- ▶ LG Authorized Service Center warranties their repair work for thirty (30) days.

**LG CANADA'S SOLE LIABILITY IS LIMITED TO THE WARRANTY SET OUT ABOVE. EXCEPT AS EXPRESSLY PROVIDED ABOVE, LG CANADA MAKES NO AND HEREBY DISCLAIMS ALL OTHER WARRANTIES AND CONDITIONS RESPECTING THE PRODUCT, WHETHER EXPRESS OR IMPLIED, INCLUDING, BUT NOT LIMITED TO, ANY IMPLIED WARRANTY OR CONDITION OF MERCHANTABILITY OR FITNESS FOR A PARTICULAR PURPOSE, AND NO REPRESENTATIONS SHALL BE BINDING ON LG CANADA. LG CANADA DOES NOT AUTHORIZE ANY PERSON TO CREATE OR ASSUME FOR IT ANY OTHER WARRANTY OBLIGATION OR LIABILITY IN CONNECTION WITH THE PRODUCT. TO THE EXTENT THAT ANY WARRANTY OR CONDITION IS IMPLIED BY LAW, IT IS LIMITED TO THE EXPRESS WARRANTY PERIOD ABOVE. LG CANADA, THE MANUFACTURER OR DISTRIBUTOR SHALL NOT BE LIABLE FOR ANY INCIDENTAL, CONSEQUENTIAL, SPECIAL, DIRECT OR INDIRECT DAMAGES, LOSS OF GOODWILL, LOST PROFITS, PUNITIVE OR EXEMPLARY DAMAGES OR ANY OTHER DAMAGE, WHETHER ARISING DIRECTLY OR INDIRECTLY FROM ANY CONTRACTUAL BREACH, FUNDAMENTAL OR OTHERWISE, OR FROM ANY ACTS OR OMISSIONS, TORT, OR OTHERWISE.** This warranty gives you specific legal rights. You may have other rights which may vary from province to province depending on applicable provincial laws. Any term of this warranty that negates or varies any implied condition or warranty under provincial law is severable where it conflicts with provincial law without affecting the remainder of this warranty's terms.

**THIS LIMITED WARRANTY DOES NOT COVER:**

1. Service trips to deliver, pick up, or install the product; instructing a customer on operation of the product; repair or replacement of fuses or correction of wiring or plumbing, or correction of unauthorized repairs/installation.
2. Failure of the product to perform during power failures and interruptions or inadequate electrical service.
3. Damage caused by leaky or broken water pipes, frozen water pipes, restricted drain lines, inadequate or interrupted water supply or inadequate supply of air.
4. Damage resulting from operating the Product in a corrosive atmosphere or contrary to the instructions outlined in the Product owner's manual.
5. Damage to the Product caused by accidents, pests and vermin, lightning, wind, fire, floods, or acts of God.
6. Damage resulting from the misuse, abuse, improper installation, repair, or maintenance of the Product. Improper repair includes use of parts not approved or specified by LG Canada.
7. Damage or product failure caused by unauthorized modification or alteration, or use for other than its intended purpose, or resulting from any water leakage due to improper installation.
8. Damage or Product failure caused by incorrect electrical current, voltage, or plumbing codes, commercial or industrial use, or use of accessories, components, or cleaning products that are not approved by LG Canada.
9. Damage caused by transportation and handling, including scratches, dents, chips, and/or other damage to the finish of your product, unless such damage results from defects in materials or workmanship and is reported within one (1) week of delivery.
10. Damage or missing items to any display, open box, discounted, or refurbished Product.
11. Products with original serial numbers that have been removed, altered, or cannot be readily determined. Model and Serial numbers, along with original retail sales receipt, are required for warranty validation.
12. Increases in utility costs and additional utility expenses.
13. Replacement of light bulbs, filters, or any consumable parts.
14. Repairs when your Product is used in other than normal and usual household use (including, without limitation, commercial use, in offices or recreational facilities) or contrary to the instructions outlined in the Product owner's manual.
15. Costs associated with removal of the Product from your home for repairs.
16. The removal and reinstallation of the Product if it is installed in an inaccessible location or is not installed in accordance with published installation instructions, including the Product owner's and installation manuals.
17. Shelves, door bins, drawers, handles, and accessories to the Product. Also excluded are parts besides those that were originally included with the Product.

**All costs associated with the above excluded circumstances  
shall be borne by the consumer.**

**For complete warranty details and customer assistance, please call or visit our website:**

Call 1-888-542-2623 (24 hours a day, 365 days a year) and select the appropriate option from the menu, or visit our website at <http://www.lg.com>

Write your warranty information below: \_\_\_\_\_  
 Product Registration Information: \_\_\_\_\_  
 Model: \_\_\_\_\_  
 Serial Number: \_\_\_\_\_  
 Date of Purchase: \_\_\_\_\_

### Open Source Software Notice

To obtain the source code under GPL, LGPL, MPL and other open source licenses, that is contained in this product, please visit <http://opensource.lge.com> .

In addition to the source code, all referred license terms, warranty disclaimers and copyright notices are available for download.

LG Electronics will also provide open source code to you on CD-ROM for a charge covering the cost of performing such distribution (such as the cost of media, shipping and handling) upon email request to [opensource@lge.com](mailto:opensource@lge.com). This offer is valid for three (3) years from the date on which you purchased the product.







**800-570-3355**



**LG Customer Information Center**

For inquiries or comments,  
visit [www.lg.com](http://www.lg.com) or call;

**1-800-243-0000** USA, Consumer User

**1-888-865-3026** USA, Commercial User

**1-888-542-2623** CANADA

**Register your product Online!**

[www.lg.com](http://www.lg.com)