

40" INDUSTRIAL STYLE DUAL FUEL RANGE

Genesi series - GQY10SF-4M

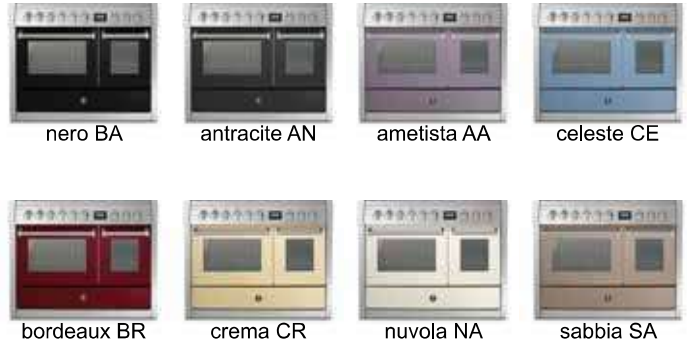

ALSO AVAILABLE IN



FEATURES AND BENEFITS	MAIN OVEN PERFORMANCE	TECHNICAL DETAILS
-----------------------	-----------------------	-------------------

- Powerful 17,000 BTU double ring burner speeds cooking time
- Combi-Steam to bake as you've always cooked, in shorter time, with less energy consumption, with better results
- Removable, dishwasher safe, s.steel oven liners
- Full extension telescopic rack rails for easy access to the oven cavity
- Soft closing hinges softly guide the door shut so the oven door never slams
- TFT programmer. 11 cooking functions - 34 pre set recipes - eco mode - Sabbath mode - traditional and fan assisted steam functions

BAKE/BROIL ELEMENT WATTS	850 + 1900 W
CONVECTION ELEMENT WATTS	2100 W
LOWER ELEMENT WATTS	1200 W
OVEN VOLUME	2.5 cubic feet

CIRCUIT BRAKER	20 A
VOLTS	120 / 240 V
FREQUENCY	60 Hz
POWER CORD LENGHT	46" (included)
PLUG TYPE	NEMA 50-14P - 4 prong

SIDE OVEN PERFORMANCE	
BAKE/BROIL ELEMENT WATTS	1200 + 500 W
LOWER ELEMENT WATTS	900 W
OVEN VOLUME	1.4 cubic feet

ENERGY SOURCE	mixed electric / gas
GAS TYPE	natural gas (5" wc)
ALTERNATIVE GAS TYPE	lp (10" wc) - LP kit included

GENERAL PROPERTIES	
--------------------	--

OVEN FUNCTIONS	defrost, static, upper element, static steam, grill, ventilated grill, fan steam, convection, fast heating, proof
TYPE OF GRATE	enameled cast iron
KNOB/HANDLE MATERIAL	metal
INTERIOR LIGHT	2+1 (halogen)
KITCHEN TIMER	yes
SEALED BURNERS	yes

COOK TOP PERFORMANCE	
----------------------	--

TOTAL COOKING ZONES	5
TOTAL COOK TOP (NG/LP) BTU	53700 / 41800
SIMMER (NG/LP) BTU	4200 / 3000
SEMI-RAPID (NG/LP) BTU	7500 / 5600
RAPID (NG/LP) BTU	11500 / 9500
WOK (NG/LP) BTU	13500 / 10600
MEGA-WOK (NG/LP) BTU	17000 / 13100

DIMENSIONS & WEIGHT	
---------------------	--

OVERALL DIMENSIONS	W= 39 5/16" (100cm) H= 35 7/16" (90cm) D= 24 9/16" (62cm)
ADJUSTABLE RANGE HEIGHT	35 7/16" (90cm) min 36 7/32" (92cm) max
OVERALL OVEN INTERIOR SIZE	W= 18 19/64" (46,5cm) H= 13 25/32" (35cm) D= 16 59/64 (43cm)
OVERALL OVEN INTERIOR SIZE (side oven)	W= 10 15/64" (26cm) H= 13 25/32" (35cm) D= 16 59/64 (43cm)
NET WEIGHT	269lbs (122kg)

CUTOUT REQUIREMENTS	
---------------------	--

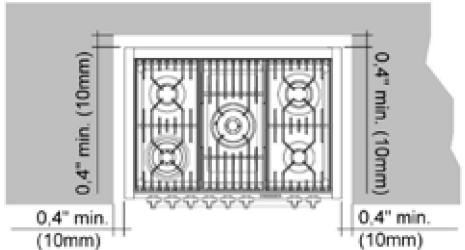

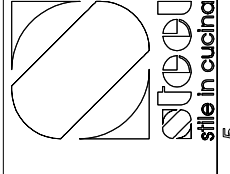
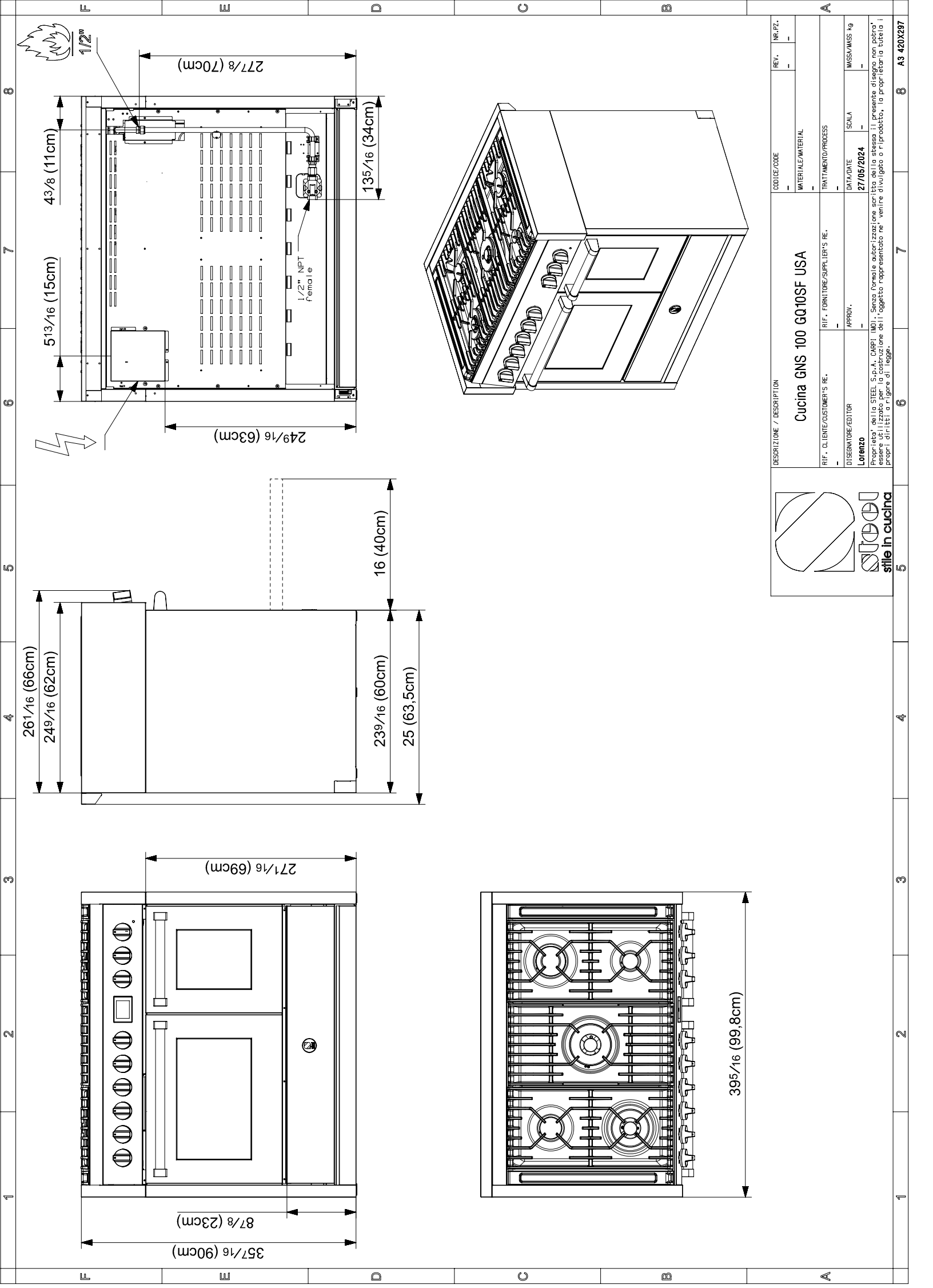

DESCRIZIONE / DESCRIPTION	Cucina GNS 100 G010SF USA	CODICE/ CODE	REV.	NR. PZ.
RIF. CLIENTE/CUSTOMER'S REF.		MATERIALE/MATERIAL		
RIF. FORNITORE/SUPPLIER'S REF.		TREATMENT/PROCESS		
DISEGNATORE/EDITOR	Lorenzo	APPROV.		
		DATA/DATE	27/05/2024	
		SCALA		MASSA/MASS kg

Proprietà di La STEEL S.p.A. CARPI (MO). Senza forma le autorizzazioni scritte da la stessa. Il presente disegno non potrà essere utilizzato per la costruzione dell'oggetto rappresentato né venire divulgato o riprodotto, la proprietà tutela i propri diritti a rigore di legge.