

Filler strips CVA and DG
EBA 70

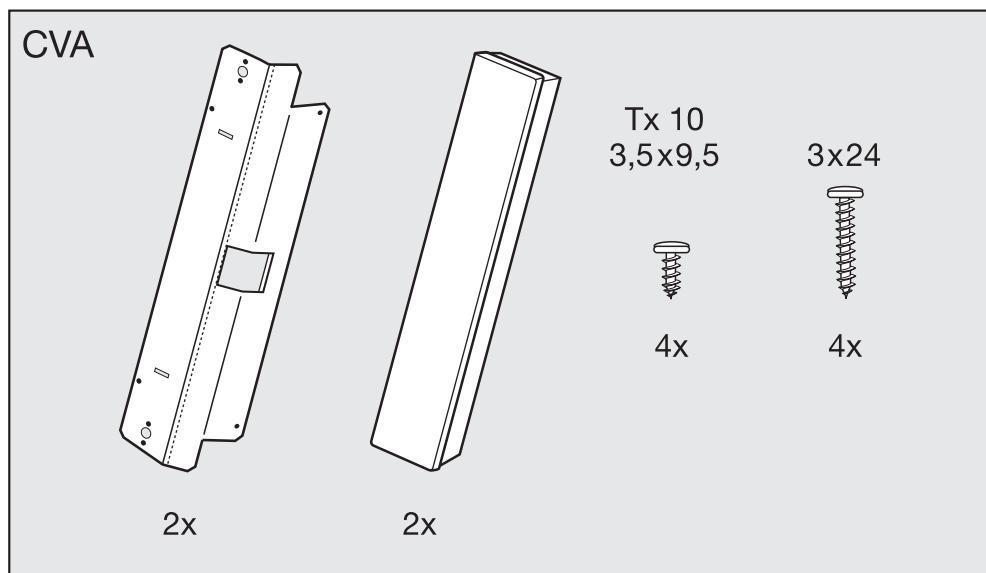

Parts included



CVA

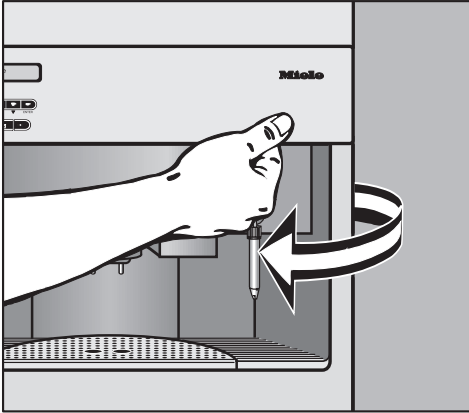

1. Open the door of the CVA.

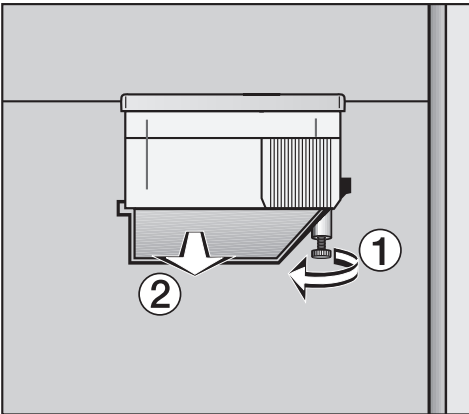

2. Remove the bean container by turning the locking screw, \curvearrowright , counterclockwise until the container, \curvearrowright , can be removed.

Determine the number of spacers needed

3. Center the CVA in the cabinet.

4. Measure space x and y .

x = width of filler

y = width of opening from the edge of the machine to the edge of the cabinet.

If x is less than y , the enclosed spacers can be used to fill this gap at the time the right mounting bracket is secured. If the gap is greater than $\frac{1}{16}$ " additional spacers must be used.

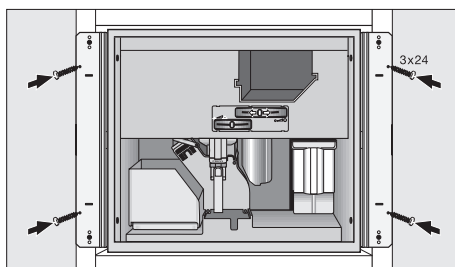
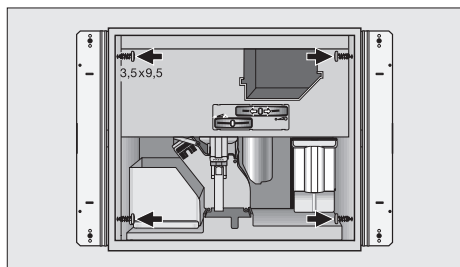

5. Screw the EBA to the side of the CVA using the (4) Tx 10 screws provided. If spacers are used, place them between the EBA and CVA.

7. Secure the cabinet with the (4) 3 x 24 screws provided.

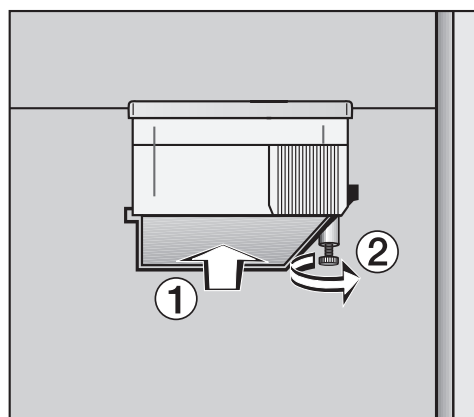
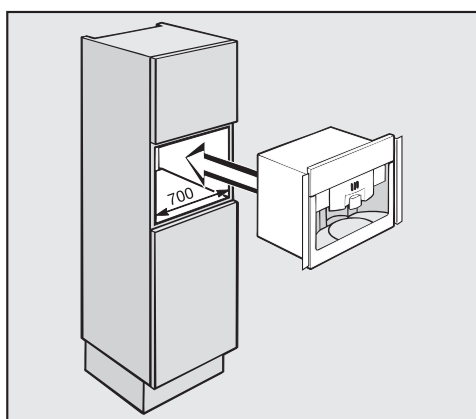

6. Slide the CVA into the cabinet opening.

8. Return the bean container – and tighten the locking screw –

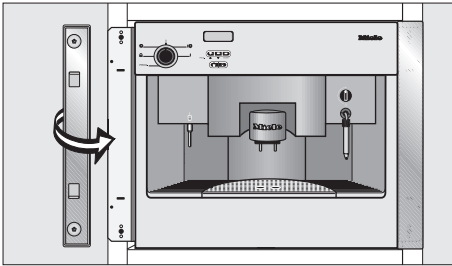

9. Place covers over brackets so they snap in place.

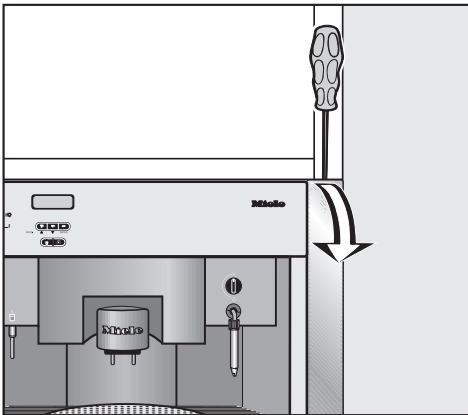

10. Check spacing and make sure the door opens easily. If the spacing is off or the door does not operate correctly, gently pry off the covers with a flat head screwdriver. Remove appliance and add or remove spacers as needed.

Parts included

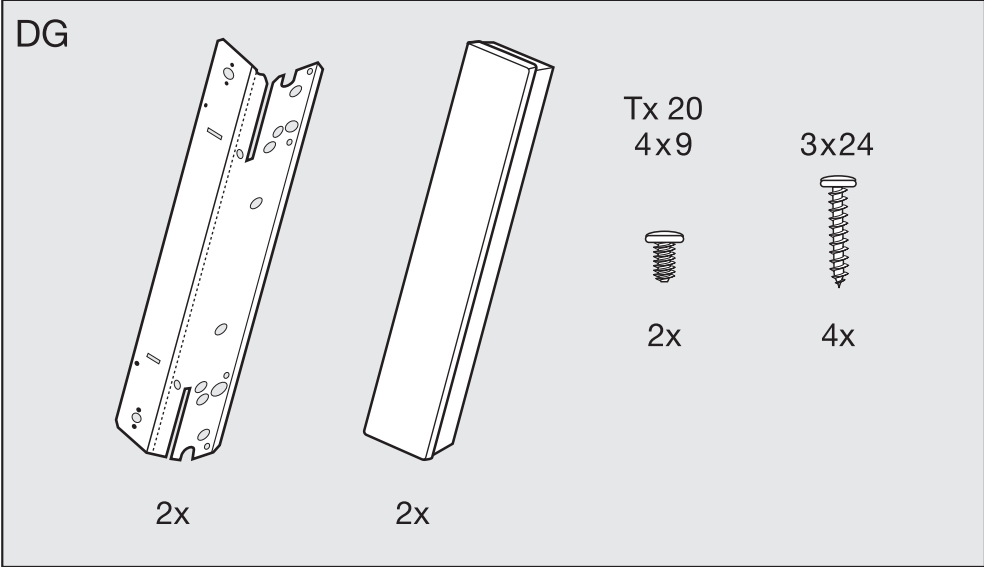

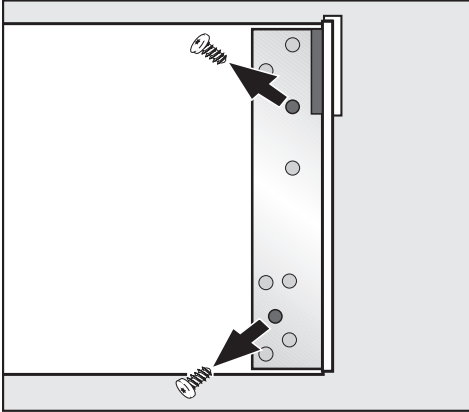

1. Remove (2) screws, as shown, from each side of the DG. Save these (4) screws for later.

Determine the number of spacers needed

2. Center the DG in the cabinet.
3. Measure space x and y.
x = width of filler
y = width of opening from the edge of the appliance to the edge of the cabinet.

If x is less than y, the enclosed spacers can be used to fill this gap at the time the right mounting bracket is secured. If the gap is greater than $\frac{1}{16}$ " additional spacers must be used.

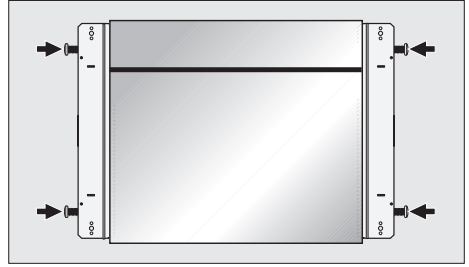

4. Secure the EBA strips to the side of the DG using the screws removed in step 1.

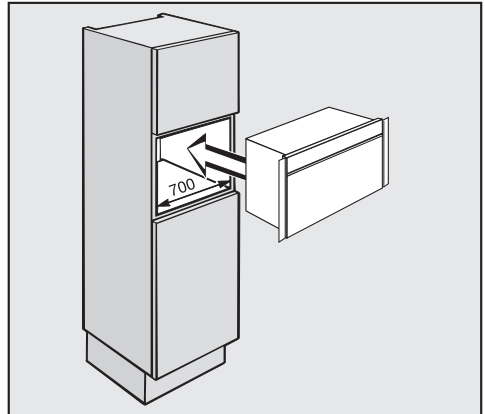

5. Slide the DG into the opening.

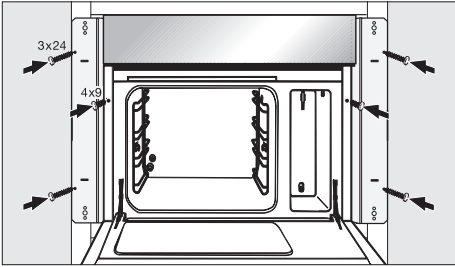

6. Screw the (2) 4 x 9 screws provided into the DG mounting holes. Screw the (4) 3 x 24 screws provided into the surrounding cabinet as shown.

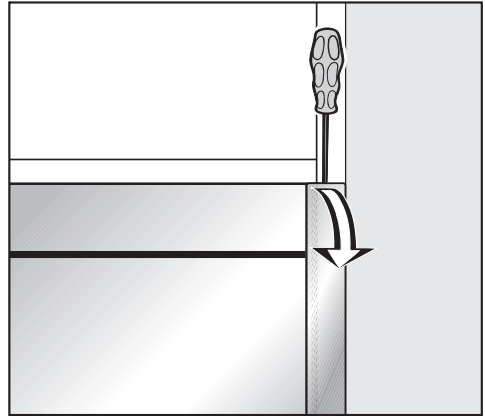

8. Check spacing. If not correct, gently pry off the covers with a flathead screwdriver. Remove the DG and add or remove spacers as needed.

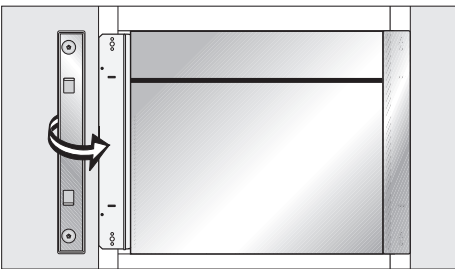

7. Press covers into EBA brackets so they snap into place.

When contacting the Technical Service,
please quote the model and serial number
of your appliance.



Miele, Inc. (USA)

National Headquarters

9 Independence Way
Princeton, NJ 08540
Phone: 800-843-7231
609-419-9898
Fax: 609-419-4298
www.miele.com

**Technical Service & Support
Nationwide**

Phone: 800-999-1360
Fax: 888-586-8056

Miele Limited (CDN)

National Headquarters

55G East Beaver Creek Road
Richmond Hill, ON L4B 1E5
Phone: 800-643-5381
905-707-1171
Fax: 905-707-0177
www.miele.ca
info@miele.ca (general enquiries)
professional@miele.ca (commercial enquiries)

Mielecare National Service

Phone: 800-565-6435
905-850-7456
Fax: 905-850-6651
service@miele.ca (Tech. Service)