

# LIEBHERR

## Installation Instructions

For Free Standing NoFrost  
Combined Refrigerator-Freezers

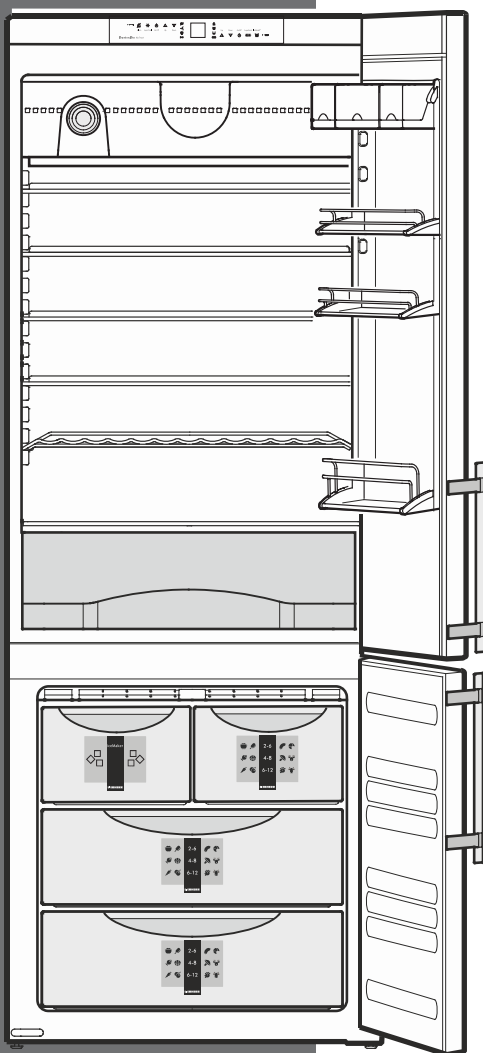

CS 1660  
7083 227-00

# IMPORTANT

---

## PLEASE READ AND FOLLOW THESE INSTRUCTIONS

These instructions contain Warning and Caution statements. This information is important for safe and efficient installation.

Always read and follow all Warning and Caution statements!



### WARNING!

**Warning indicates a potentially hazardous situation which, if not avoided, could result in death or serious injury.**



### CAUTION!

**Caution indicates a potentially hazardous situation which, if not avoided, may result in minor or moderate injury.**

### IMPORTANT

*This highlights information that is especially relevant to a problem-free installation.*

Make sure incoming voltage is the same as the unit rating.

To reduce the risk of fire, electric shock, or personal injury, installation work and electrical wiring must be done by a qualified electrician in accordance with all applicable codes and standards, including fire-rated construction.

## TO THE INSTALLER

It is very important that the guidelines and instructions are followed in the manual to ensure proper installation and operation of the unit. The Installation Guidelines section contains important information for making sure the installation is correct. Read and understand all the information in Installation Guidelines, and in this manual before the unit is installed.



### CAUTION!

**Always wear protective devices such as protective gloves and eye shields when installing the appliance. Also use hearing protection when drilling holes into concrete floors.**

Contents	Page
Planning information	
Unit dimensions .....	4
Unit venting .....	4
Cabinet opening dimensions .....	5
Installation	
Leveling the appliance .....	6
Blocking for safety	
Mounting the anti tipping device .....	6
Ice maker	
Safety instructions and warnings .....	8
Position of the solenoid valve .....	8
Water connection .....	8
Connection to the water supply .....	9
Reversing door hinges .....	10-12
Door adjustment .....	13

# INSTALLATION GUIDELINES

## Area Requirements

Verify the following:

- Finished kitchen floor height is level. Appliance must be shimmed level if the floor heights are not equal to make sure air vents are not obstructed.
- Remove anything attached to rear or side walls that can obstruct door opening.
- Cutout dimensions are accurate.
- Electrical outlet is in correct location.

Do not install this refrigerator-freezer next to any other refrigerator or model except another Liebherr model. Liebherr models are designed to allow side by side installation. They are equipped with a heating system to eliminate condensation when refrigerators or freezers are installed side by side. Installing this refrigerator-freezer next to any other refrigerator or freezer can cause condensation or cause damage to the Liebherr refrigerator-freezer.

## Electrical Requirement

If codes require a separate grounding circuit to be used, have a qualified electrician install the circuit.

### WARNING!

**Do not ground to a gas pipe. Check with a qualified electrician if you are not sure the appliance is properly grounded. Do not have a fuse in the neutral or grounding circuit.**

### WARNING!

#### ELECTRIC SHOCK HAZARD

- Electrically ground the appliance.
- Do not use an extension cord.
- Failure to follow these instructions could result in fire or electric shock.

### WARNING!

#### ELECTROCUTION HAZARD

Electrical grounding required. This appliance is equipped with a three-prong (grounding) polarized plug for your protection against possible shock hazards.

- Do not remove the round grounding prong from the plug.
- Do not use a two-prong grounding adapter.
- Do not use an extension cord to connect power to the unit.

### CAUTION!

To protect the appliance from possible damage, allow the appliance to stand 1/2 to 1 hour in place before turning the electricity on. This allows the refrigerant and system lubrication to reach equilibrium.

## Customer's Responsibility

A 115 Volt, 60 Hz, 15 Amp fused electrical supply is required. We recommend using a dedicated circuit for this appliance to prevent electrical overload. Follow the National Electrical Code and local codes and ordinances when installing the receptacle.

## Blocking for Safety

### WARNING!

The anti tipping brackets must be installed to prevent the appliance from tipping after it is installed. Refer to Blocking for Safety.

## Unit Venting

Do not restrict the air flow. Air flow must be provided for the unit to operate.

# PLANNING INFORMATION

## Unit Dimensions - Figure 1

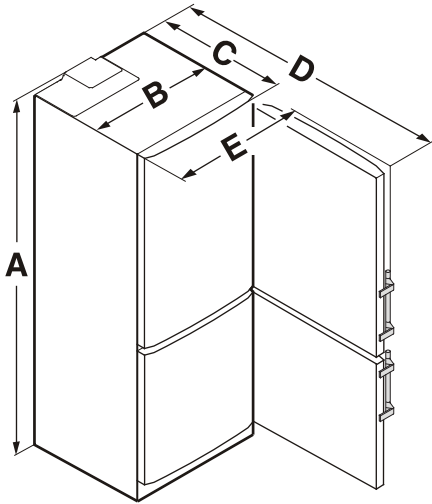

**Figure 1**

A = 79-1/2" (2020 mm)  
B = 29-3/8" (747 mm)  
C = 24-13/16" (630 mm)  
D = 52-3/8" (1330 mm)  
E = 31-3/32" (790 mm)

Overall height of the appliance can be increased by a maximum of 5/8" (see Leveling the appliance).

## Unit Venting - Figure 2

Do not restrict the air flow. The opening can either be directly over the appliance ①, above the cabinet and below the ceiling ② or through a vent installed in a soffit ③.

The cabinet height as specified at 80" (2032 mm) will create a 1-5/16" (33 mm) gap above the appliance providing optimal air flow over the top of the appliance for its efficient operation.

Be sure to consider the possibility of having to raise some of the leveling legs in order to level the appliance when installing. If you adjust the height of the appliance - it will effectively reduce air flow. Therefore leave yourself some room for adjustment.

### **IMPORTANT**

*The section below the freezer door and the floor must not be covered.*

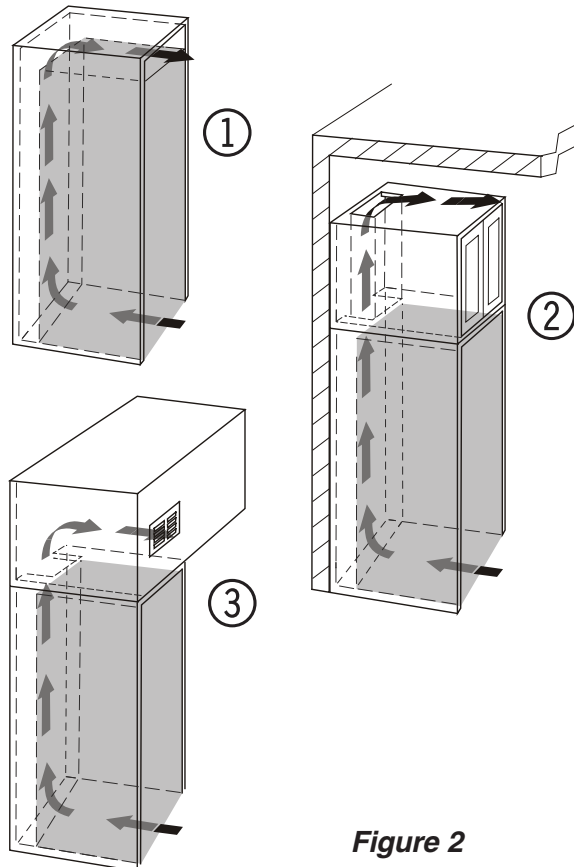

**Figure 2**

# PLANNING INFORMATION

## Cabinet Opening Dimensions - Figure 3

The appliance can be used freestanding or semi built-in.

If semi built-in, please consider the cabinet opening dimensions as shown in **Figure 3**.

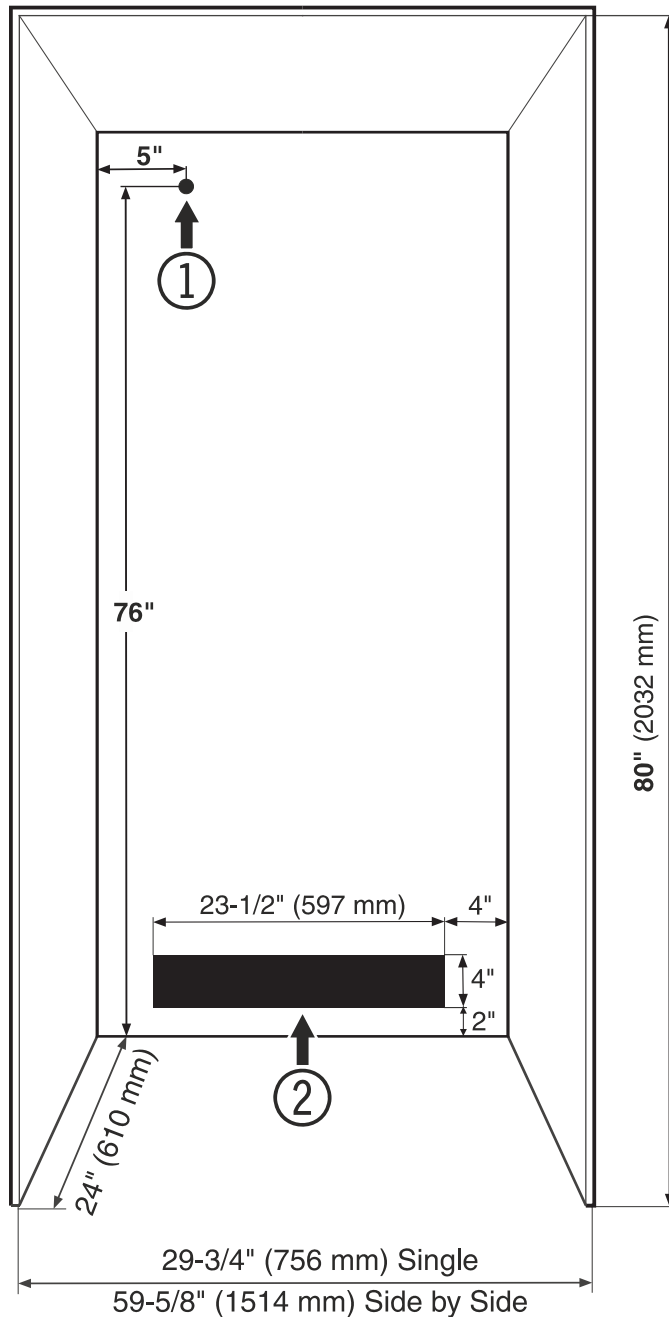

**Figure 3**

- ① This is where the power cord is fed out of the appliance rear.

Free length of the power cord is 94".

Choose the position of the electrical outlet taking these specifications into account.

The electrical outlet must be accessible for installation and servicing.

**The electrical outlet must not be situated behind the appliance!**

- ② The water line lead out position can be within the shaded area.

### **IMPORTANT**

Do not install the shut-off valve behind the appliance.

# INSTALLATION

## Leveling the Appliance - Figure 4

1. The height can be adjusted in front by twisting the leveling feet ①.
2. Twist the adjusting bolt ② to set up the back of the appliance.



### CAUTION!

Do not use a power driver.

3. Align the appliance with sides of kitchen cabinets by adjusting leveling feet ① and the supports ②.

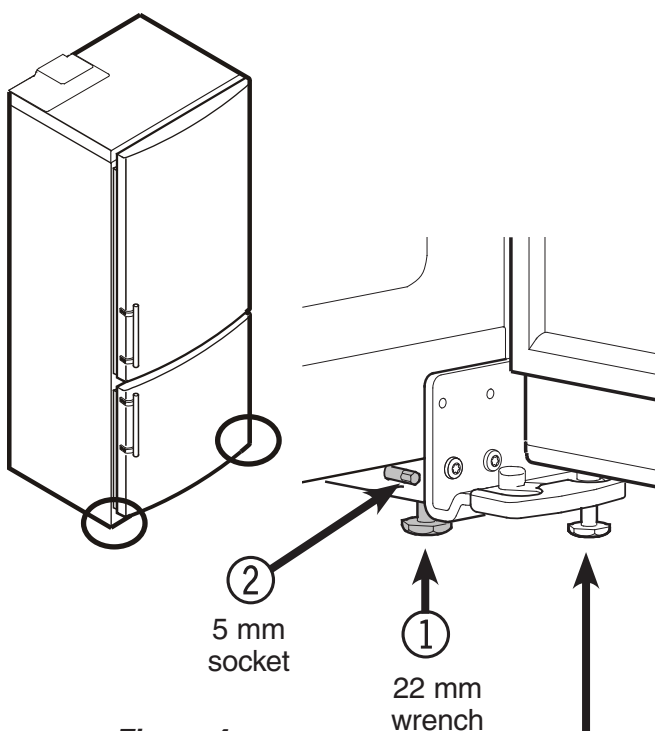

Figure 4

### IMPORTANT

After final installation, this screw must be turned down until it has proper floor contact to support the hinge bracket.

## Mounting the Anti Tipping Device

### Device



### WARNING!

The anti tipping brackets must be mounted to prevent the appliance from tipping when the fully stocked door is opened.



### WARNING!

Be sure that there is no plumbing or electrical wiring located in this area which screws or drills could damage.

The anti tipping brackets provided can be mounted within 11-3/4 inches to the left and right of the appliance center (Figure 5).

### Freestanding applications

1. Mark the center of the appliance on the back wall.
2. Mount the anti tipping brackets within the given area.

### IMPORTANT

Locate at least one anti tipping bracket directly in line with a wall stud (Figure 5).

To ensure a secure mounting of the brackets, use any possible mounting option as shown in Figures 7 - 10.

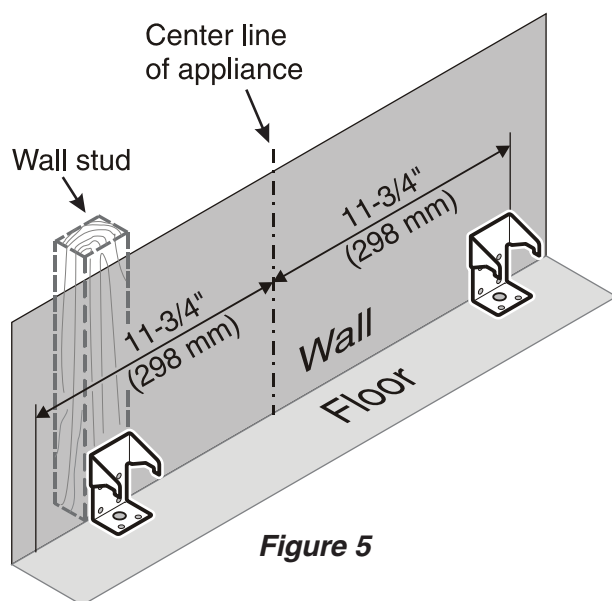

Figure 5

# BLOCKING FOR SAFETY

## Semi built-in

With semi built-in applications the anti tipping brackets must be mounted with a distance of 22 inches from the appliance housing front to the back of the bracket (**Figure 6**).

The gap to the wall must be filled with a wooden spacer to fasten the bracket.



### WARNING!

**Be sure the wooden spacer is fastened securely to the floor and / or wall.**

1. Mark the center of the appliance on the back wall.
2. Mount the wooden spacer.
3. Mount the anti tipping brackets within 11-3/4 inches to the left and right of the appliance center.

### IMPORTANT

*To ensure a secure mounting of the brackets use any possible mounting option as shown in **Figures 7 - 10**.*

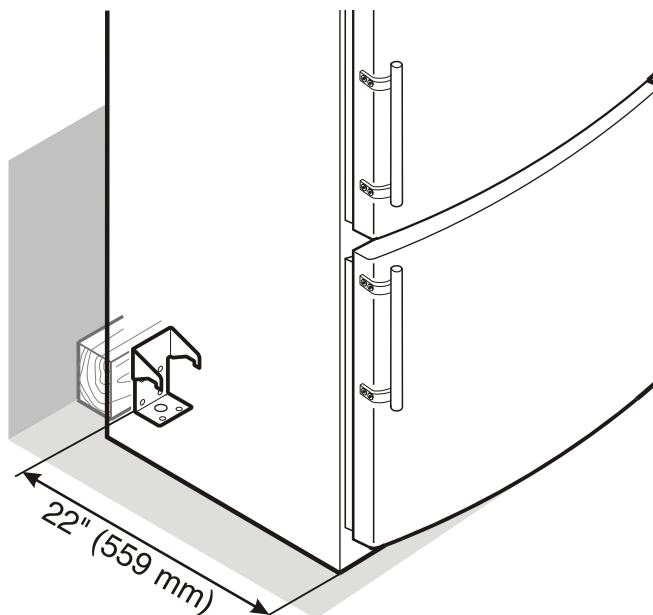

**Figure 6**

## Mounting Options

Mounting the bracket using the wall stud.

Mounting with wall plugs to concrete walls (**Figure 7**).

Screws 6 x 63 mm

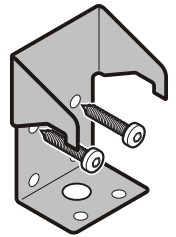

**Figure 7**

Mounting with the wall plate turning in the screws at an angle (**Figure 8**).

Screws 6 x 63 mm

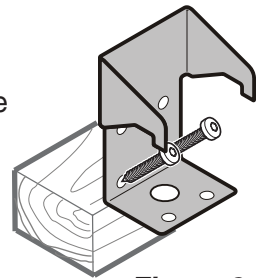

**Figure 8**

Mounting onto wooden floors (**Figure 9**).

Screws 6 x 63 mm

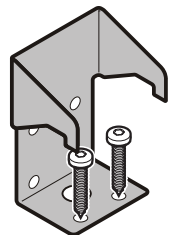

**Figure 9**

Mounting onto concrete floors using the anchors provided (**Figure 10**).

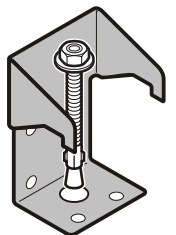

**Figure 10**

### NOTE

*If longer or shorter screws are needed, they must be supplied by the installer.*

# ICE MAKER

## Ice Maker

The ice maker for the combined refrigerator-freezer is located in the freezer compartment. These instructions only refer to the installation of the ice maker. Please refer to the Use and Care Manual provided with the appliance for operation instructions. The combined refrigerator-freezer must be level for the ice maker to function properly.

## Safety Instructions and Warnings

- Do not install the water connection while the combined refrigerator-freezer is connected to an electrical outlet.
- The connection to the water supply may only be made by a trained and licensed plumber.
- The water quality must comply with the drinking water regulations for the geographical area where the appliance is located.
- All equipment and devices used to supply the water to the appliance must comply with the current regulations for your geographical area.

## Position of the Solenoid Valve

The solenoid valve is located in the compressor compartment at the rear of the appliance (**Figure 11**).

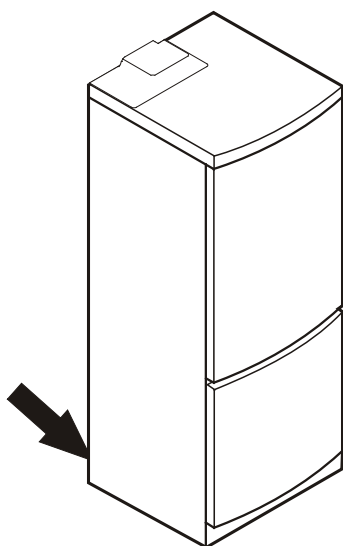

**Figure 11**

## Water Connection

- The water supply pressure requirements are different based on whether or not the supplied Liebherr water filter is installed. With the filter installed, the pressure must be in the range of 40-90 psi (2.8-6.2 bar). Without the filter installed the acceptable pressure range is 22-87 psi (1.5-6 bar). Failure to meet these requirements will likely result in ice maker malfunction and possibly cause a water leakage that can damage flooring and surrounding furniture.
- Use a 1/4" OD copper line to connect the water supply to the solenoid valve. ***This is not supplied with the appliance (Figure 12).***
- A shut-off valve, such as the saddle valve illustrated here, must be installed between the hose line and the main water supply so the water supply can be stopped if necessary.

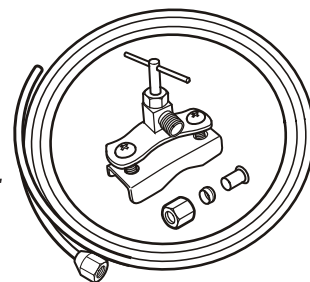

**Figure 12**

**Do not install the shut-off valve behind the refrigeration unit.**

- The solenoid valve has a *metric R3/4* male connector. A R3/4 (metric) to a 1/4" OD adapter is supplied with the ice maker.
- Insert the water strainer provided into the OD adapter with the cavity downwards.

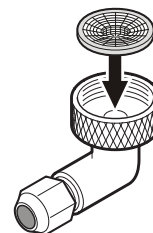

### **IMPORTANT**

*Be sure the strainer is inserted with the cavity downwards. Otherwise the strainer could be damaged when mounting the OD adapter onto the solenoid valve.*



## Connection to the Water Supply

1. Move the appliance towards the final position and leave enough space to work behind.
2. Remove the cover from the valve connector (**Figure 13**).
3. Connect the water line with the OD adapter (**Figure 14**).
4. Bleed the air from the water line by opening the water supply temporarily.
5. Screw the OD adapter onto the solenoid valve (**Figure 15**).
6. Move the power supply line to the area of the electrical outlet.

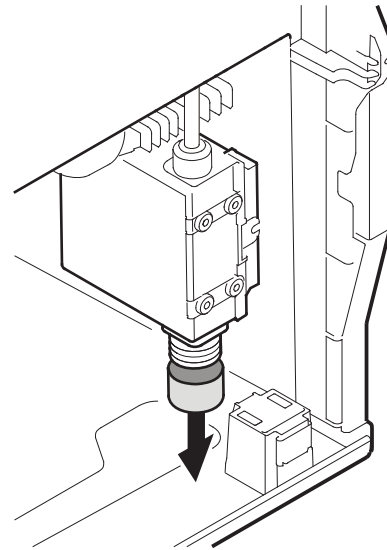

**Figure 13**

**⚠ WARNING!**

**Do not connect to the electrical outlet before the installation is completed and the water line is connected to the solenoid valve.**

7. Push the appliance slowly to the back wall. Make sure the water line does not interfere with the anti tipping bracket(s).
8. Open the shut-off valve for the water supply and check the entire water system for leaks.

### **IMPORTANT**

*After starting up the appliance, the water pipe system must be purged of any air. Refer to chapter "Bleeding the ice maker" in the operating instructions.*

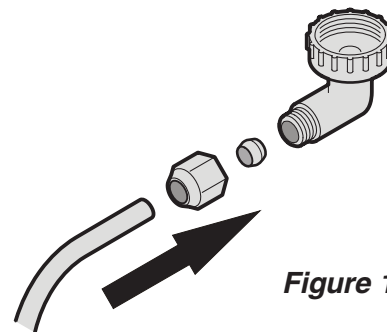

**Figure 14**

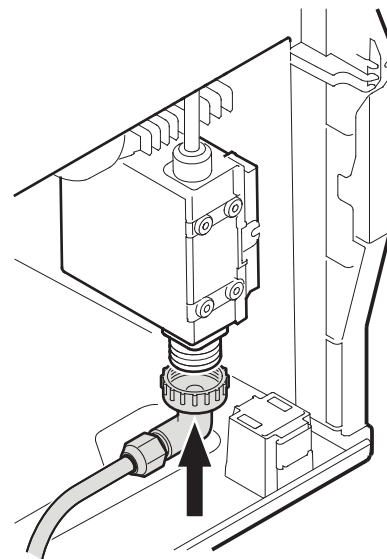

**Figure 15**

# REVERSING DOOR HINGES

Door hinges should only be changed by a trained expert.

Changing the door hinges must be done by two people.



## CAUTION!

**Before changing over door hinges, disconnect the appliance from the electrical outlet.**

1. Open top door, prise off door cover and pivot to the left.

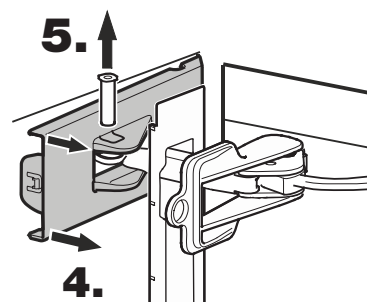
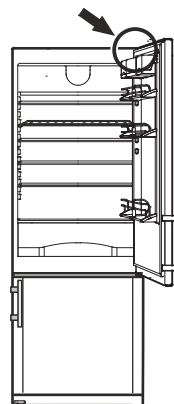
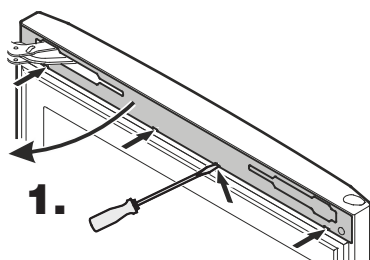

4. Pull the left-hand side of the cover approx. 1/4" (6 mm) towards you.

5. Remove pin.

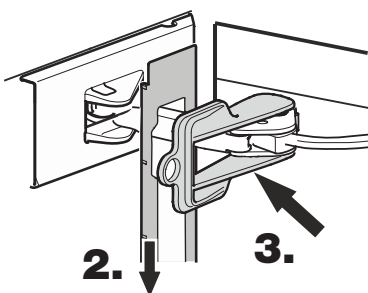
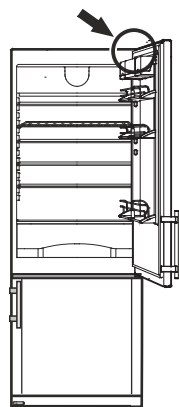

2. Let door cover hang down.

3. Slide red safety bracket over the hinge.

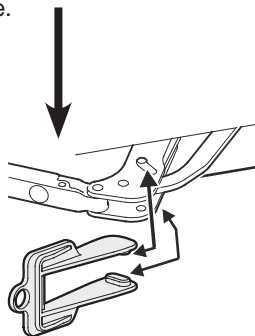

### IMPORTANT

*The two knobs on the safety bracket must be fully inserted into the marked openings on the hinge.*

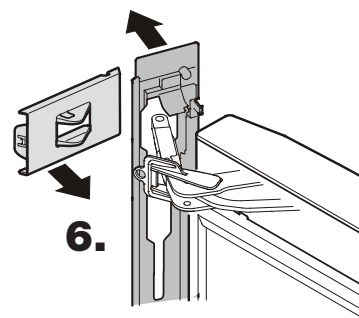
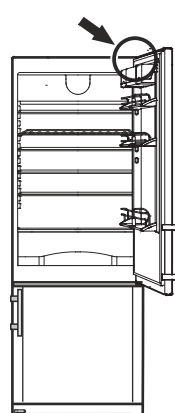

6. Open top door wide and remove covers.

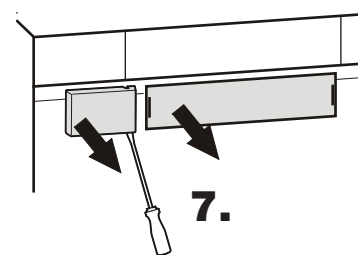
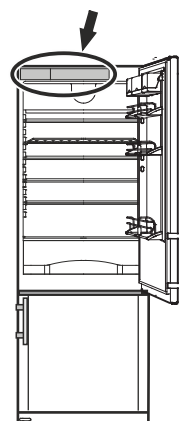

7. Prise off covers on the left and in the center.

# REVERSING DOOR HINGES

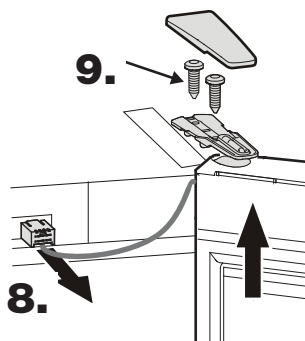
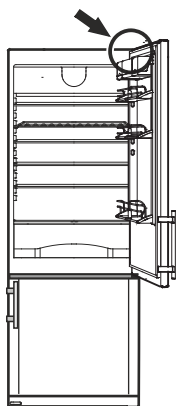

8. Disconnect the connector and pull the cable out of the guide.

9. Remove cover from upper door mounting and unscrew door.

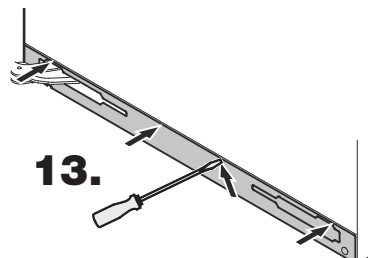
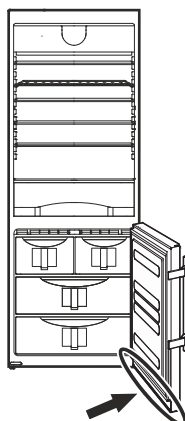

13. Open bottom door, prise off door cover.

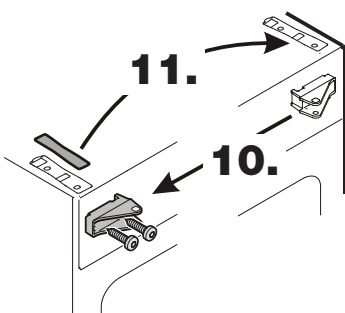
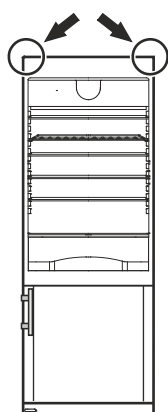

10. Transfer fastener for soft stop mechanism to the opposite side.

11. Transfer cover plate to the opposite side.

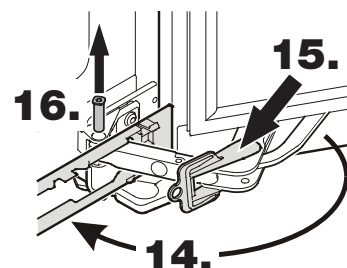
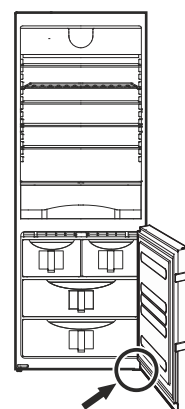

14. Pivot door cover to the left.

15. Slide red safety bracket over the hinge.

16. Remove pin.

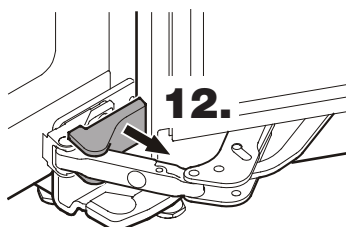
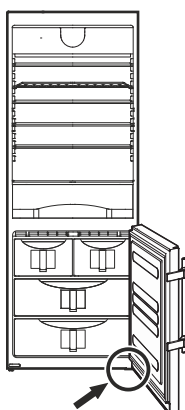

12. Remove cover.

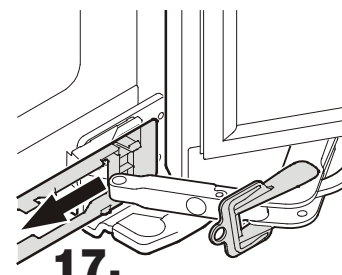
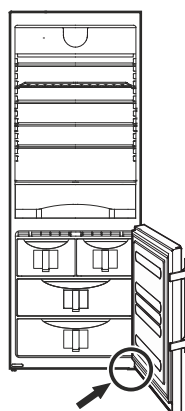

17. Open bottom door wide and remove cover.

# REVERSING DOOR HINGES

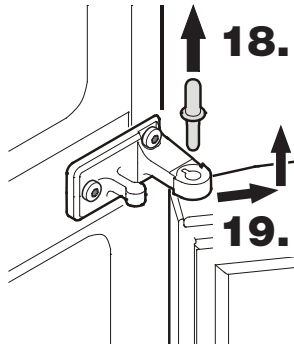
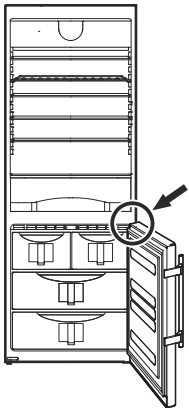

18. Pull out middle hinge pin.  
19. Remove bottom door.

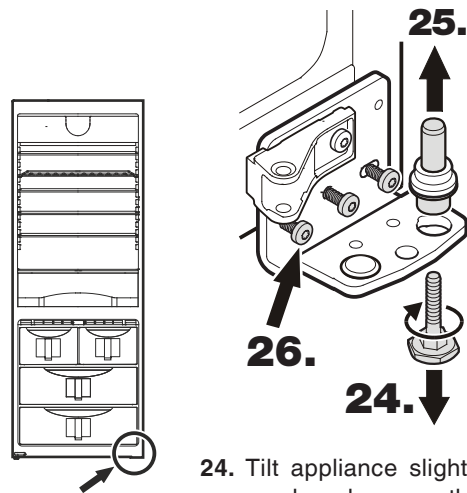

24. Tilt appliance slightly backwards and unscrew the adjustable foot.  
25. Remove the hinge pin.  
26. Unscrew hinge bracket.

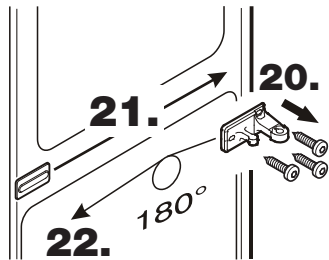
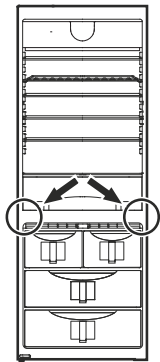

20. Unscrew hinge bracket.  
21. Transfer cover plate to the opposite side.  
22. Turn hinge bracket through 180° and screw into place.

27. Transfer fastener for soft stop mechanism on hinge bracket to the opposite side.  
28. Transfer cover to the opposite side.

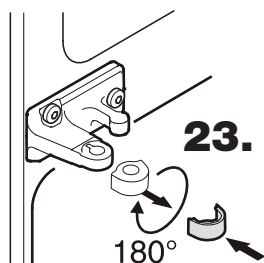
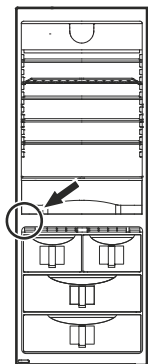
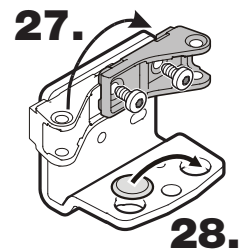

23. Remove hinge bushing, turn through 180° and re-fit.

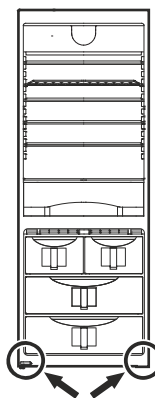

29. Transfer cover plate to the opposite side.  
30. Screw hinge bracket into place.

# DOOR ADJUSTMENT

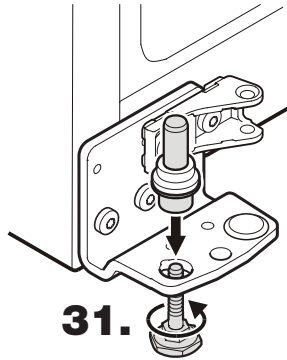
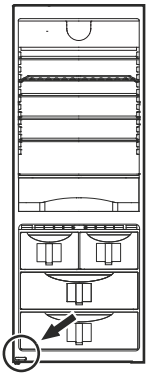

- 31.** Tilt appliance slightly backwards, insert pin and attach using the adjustable foot.

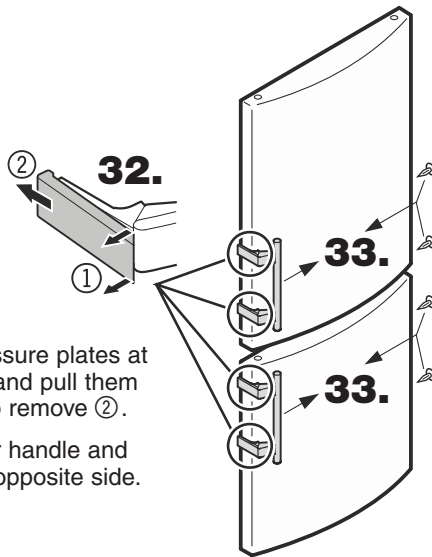

- 32.** Release pressure plates at the front ① and pull them backwards to remove ②.
- 33.** Transfer door handle and plugs to the opposite side.

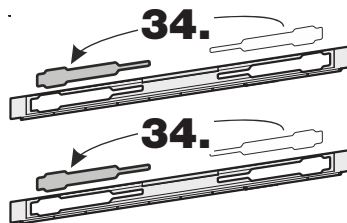

- 34.** Transfer panels of both door covers to the opposite side.

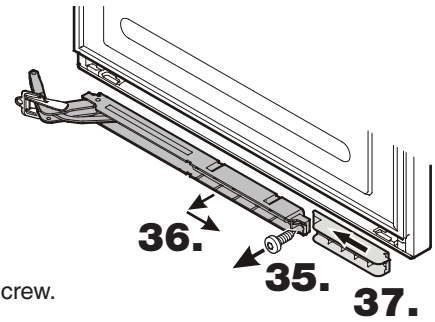

**Both doors**

- 35.** Remove screw.
- 36.** Pivot soft stop mechanism outwards on the right, pull to the right and remove.
- 37.** Slide spacer to the left and remove.

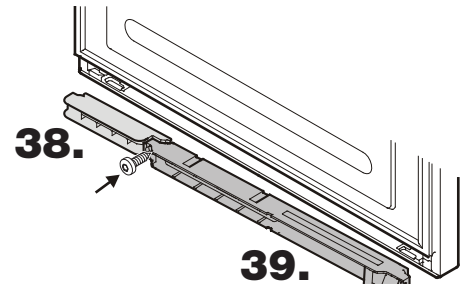

**Both doors**

- 38.** Turn spacer through 180° and re-fit on the opposite side.
- 39.** Turn soft stop mechanism through 180° and re-fit on the opposite side. Then secure both parts with screws.

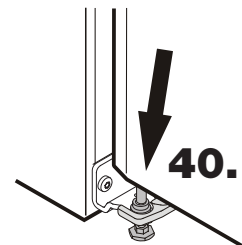
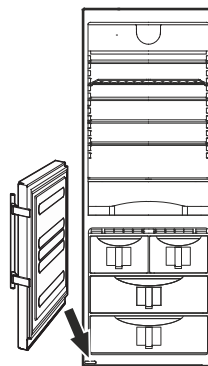

- 40.** Suspend bottom door on hinge pin.

# REVERSING DOOR HINGES

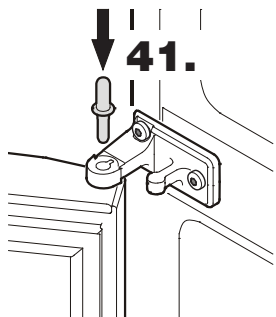
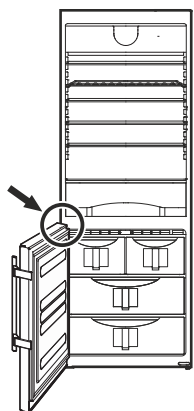

41. Insert middle hinge pin.

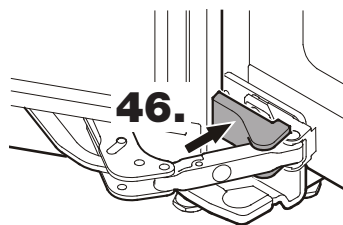
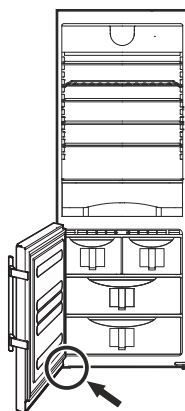

46. Click cover into place.

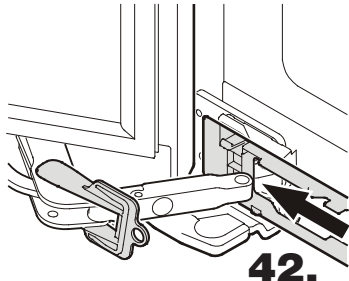
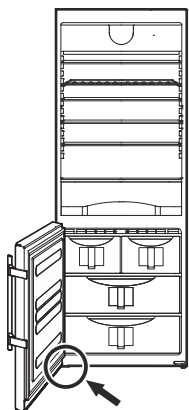

42. Slide door cover over soft stop mechanism hinge.

## Refrigerator door

47. Disconnect the connector.

48. Using a screwdriver, push out the hinge from underneath and remove it from the door complete with the cable.

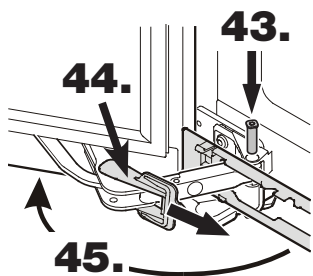
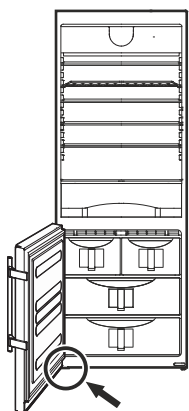
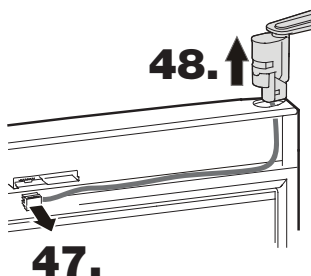

43. Move soft stop mechanism hinge to the fastener and insert pin.

44. Remove red safety bracket.

45. Pivot door cover to the left and click into place on the door.

## Refrigerator door

49. Using a screwdriver, push out the plug from underneath and transfer it to the opposite side.

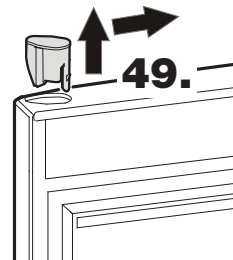

## Refrigerator door

50. Feed in the cable of the hinge at the opposite side and insert hinge.

51. Plug in the connector. Place the cable in the guide.

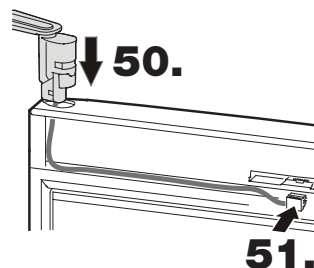

# DOOR ADJUSTMENT

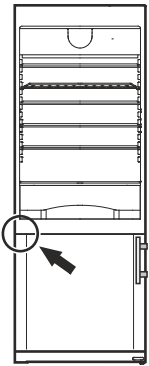

**52.** Suspend top door on hinge pin. For this, the door must be open at least 90°.

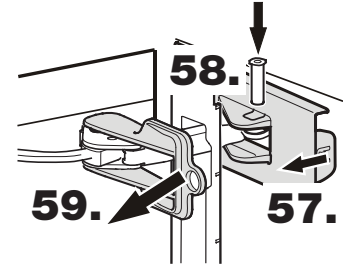
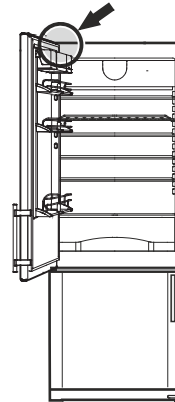
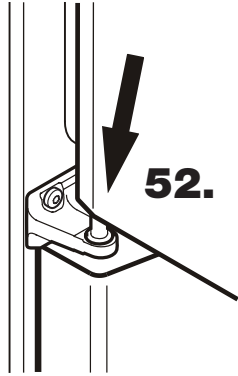

**57.** Pull the right-hand side of the cover approx. 1/4" (6 mm) towards you.

**58.** Move soft stop mechanism hinge to the fastener and insert pin.

**59.** Remove red safety bracket.

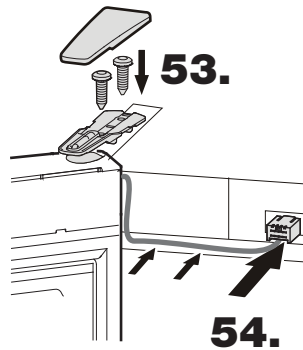
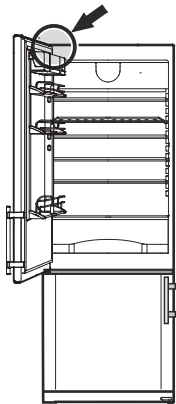

**53.** Secure door with screws and click cover into place.

**54.** Plug in the connector and insert the cable in the guide.

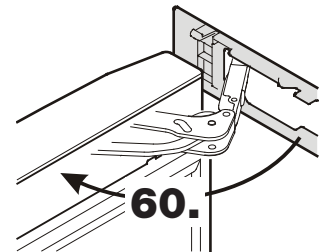
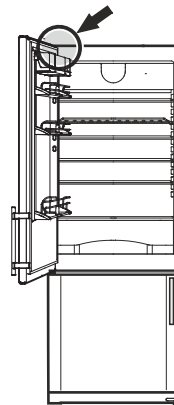

**60.** Pivot door cover to the left and click into place on the door.

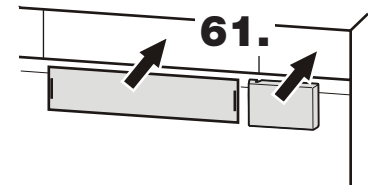
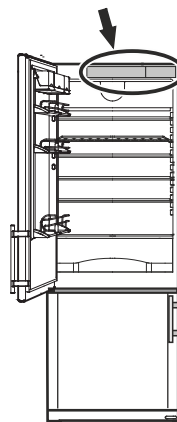

**61.** Click covers into place.

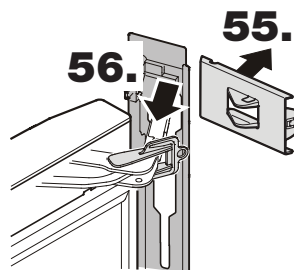
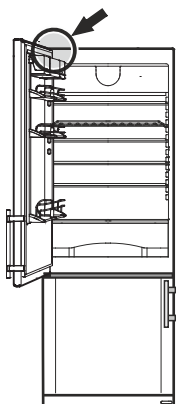

**55.** Click cover into place.

**56.** Slide door cover over soft stop mechanism hinge.

**62.** Place the appliance in its final position at the place of installation.

Extend the adjustable foot at the bottom hinge bracket until it rests on the floor and then make a further 90° turn.

