

LIEBHERR

Installation Instructions

For Free Standing NoFrost
Combined Refrigerator-Freezers

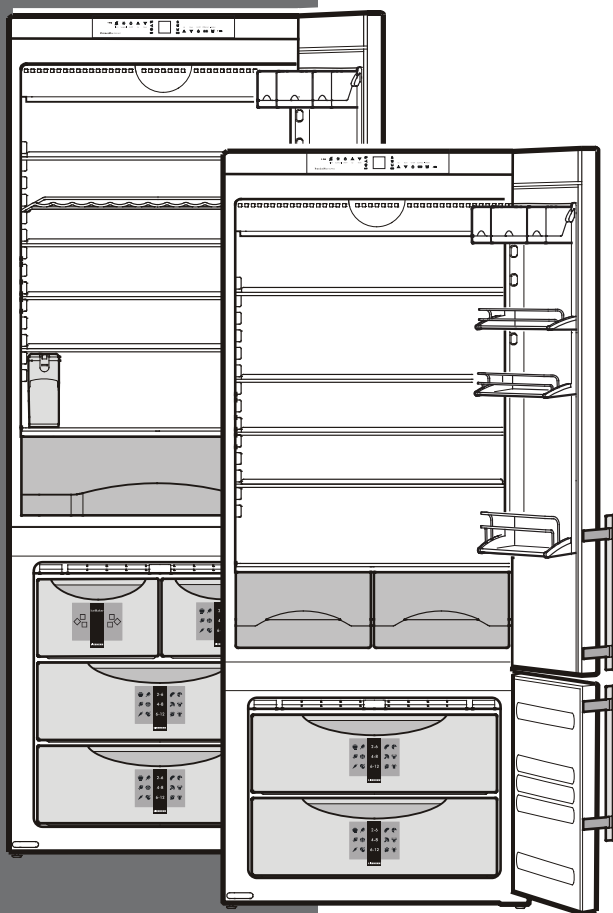

CS 1640, CS 1400
7082 153-00

IMPORTANT

PLEASE READ AND FOLLOW THESE INSTRUCTIONS

These instructions contain Warning and Caution statements. This information is important for safe and efficient installation.

Always read and follow all Warning and Caution statements!

WARNING

Warning indicates a potentially hazardous situation which, if not avoided, could result in death or serious injury.

CAUTION

Caution indicates a potentially hazardous situation which, if not avoided, may result in minor or moderate injury.

IMPORTANT

This highlights information that is especially relevant to a problem-free installation.

Make sure incoming voltage is the same as the unit rating.

To reduce the risk of fire, electric shock, or personal injury, installation work and electrical wiring must be done by a qualified electrician in accordance with all applicable codes and standards, including fire-rated construction.

TO THE INSTALLER

It is very important that the guidelines and instructions are followed in the manual to ensure proper installation and operation of the unit. The Installation Guidelines section contains important information for making sure the installation is correct. Read and understand all the information in Installation Guidelines, and in this manual before the unit is installed.

CAUTION

Always wear protective devices such as protective gloves and eye shields when installing the appliance. Also use hearing protection when drilling holes into concrete floors.

Contents	Page
Planning information	
Unit dimensions	4
Unit venting	4
Cabinet opening dimensions	5
Installation	
Leveling the appliance	6
Blocking for safety	
Mounting the anti tipping device	6
Reversing door hinges	8-10
Door adjustment	11

INSTALLATION GUIDELINES

Area Requirements

Verify the following:

- Finished kitchen floor height is level. Appliance must be shimmed level if the floor heights are not equal to make sure air vents are not obstructed.
- Remove anything attached to rear or side walls that can obstruct door opening.
- Cutout dimensions are accurate.
- Electrical outlet is in correct location.

Do not install this refrigerator-freezer next to any other refrigerator or model except another Liebherr model. Liebherr models are designed to allow side by side installation. They are equipped with a heating system to eliminate condensation when refrigerators or freezers are installed side by side. Installing this refrigerator-freezer next to any other refrigerator or freezer can cause condensation or cause damage to the Liebherr refrigerator-freezer.

Electrical Requirement

If codes require a separate grounding circuit to be used, have a qualified electrician install the circuit.

WARNING

Do not ground to a gas pipe. Check with a qualified electrician if you are not sure the appliance is properly grounded. Do not have a fuse in the neutral or grounding circuit.

WARNING

ELECTRIC SHOCK HAZARD

- Electrically ground the appliance.
- Do not use an extension cord.
- Failure to follow these instructions could result in fire or electric shock.

WARNING

ELECTROCUTION HAZARD

Electrical grounding required. This appliance is equipped with a three-prong (grounding) polarized plug for your protection against possible shock hazards.

- Do not remove the round grounding prong from the plug.
- Do not use a two-prong grounding adapter.
- Do not use an extension cord to connect power to the unit.

CAUTION

To protect the appliance from possible damage, allow the appliance to stand 1/2 to 1 hour in place before turning the electricity on. This allows the refrigerant and system lubrication to reach equilibrium.

Customer's Responsibility

A 115 Volt, 60 Hz, 15 Amp fused electrical supply is required. We recommend using a dedicated circuit for this appliance to prevent electrical overload. Follow the National Electrical Code and local codes and ordinances when installing the receptacle.

Blocking for Safety

WARNING

The anti tipping brackets must be installed to prevent the appliance from tipping after it is installed. Refer to Blocking for Safety.

Unit Venting

Do not restrict the air flow. Air flow must be provided for the unit to operate.

PLANNING INFORMATION

Unit Dimensions CS 1640 - Figure 1

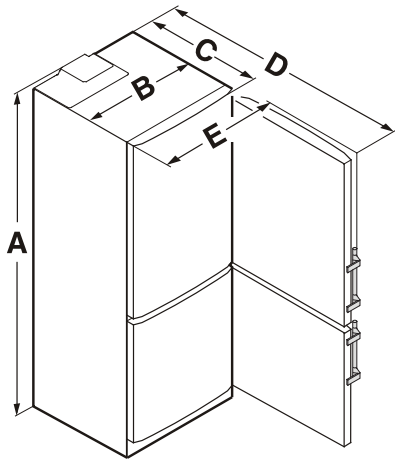

Figure 1

A = 79-1/2" (2020 mm)
 B = 29-3/8" (747 mm)
 C = 24-13/16" (630 mm)
 D = 52-3/8" (1330 mm)
 E = 31-3/32" (790 mm)

Overall height of the appliance can be increased by a maximum of 5/8" (see Leveling the appliance).

Unit Dimensions CS 1400 - Figure 2

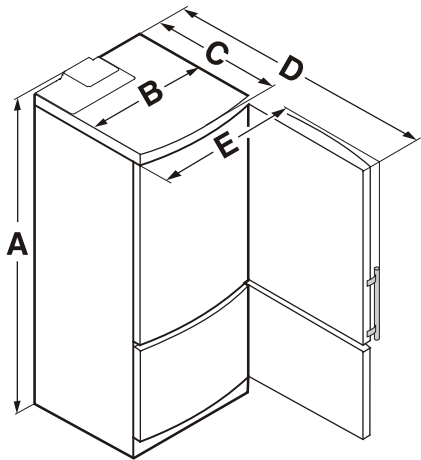

Figure 2

A = 73-1/4" (1860 mm)
 B = 29-3/8" (747 mm)
 C = 24-13/16" (630 mm)
 D = 52-3/8" (1330 mm)
 E = 31-3/32" (790 mm)

Overall height of the appliance can be increased by a maximum of 5/8" (see Leveling the appliance).

Unit Venting - Figure 3

DO NOT restrict the air flow. The opening can either be directly over the appliance ①, above the cabinet and below the ceiling ② or through a vent installed in a soffit ③.

The cabinet height as specified at 80" (2032 mm) will create a 1-5/16" (33 mm) gap above the appliance providing optimal air flow over the top of the appliance for its efficient operation.

To have the same air flow for CS 1400 appliances, the cabinet opening height must be 73-3/4" minimum.

Be sure to consider the possibility of having to raise some of the leveling legs in order to level the appliance when installing. If you adjust the height of the appliance - it will effectively reduce air flow. Therefore leave yourself some room for adjustment.

IMPORTANT

The section below the freezer door and the floor must not be covered.

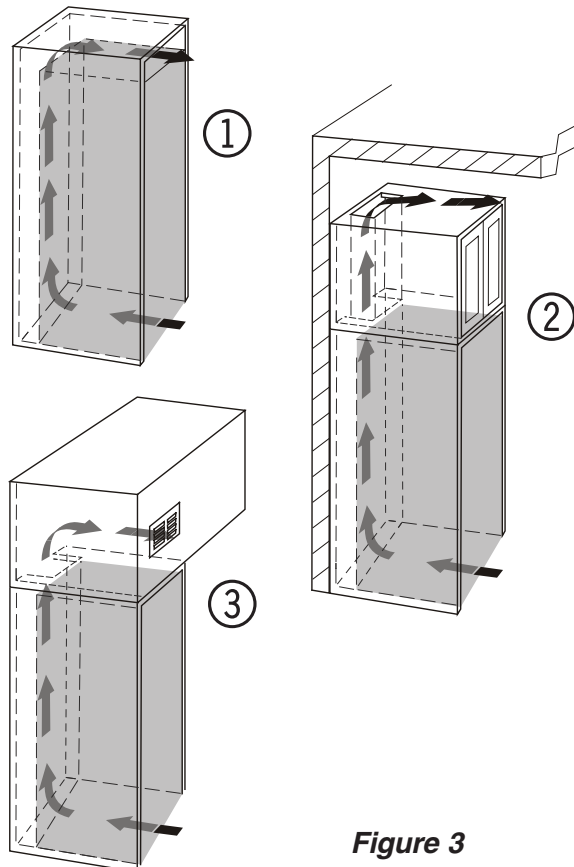

Figure 3

PLANNING INFORMATION

Cabinet Opening Dimensions - Figure 4

The appliance can be used freestanding or semi built-in.

If semi built-in, please consider the cabinet opening dimensions as shown in **Figure 4**.

The power cord comes out of the appliance top.

The location of the electrical outlet can be within a radius of 90 inch from the appliance top center.

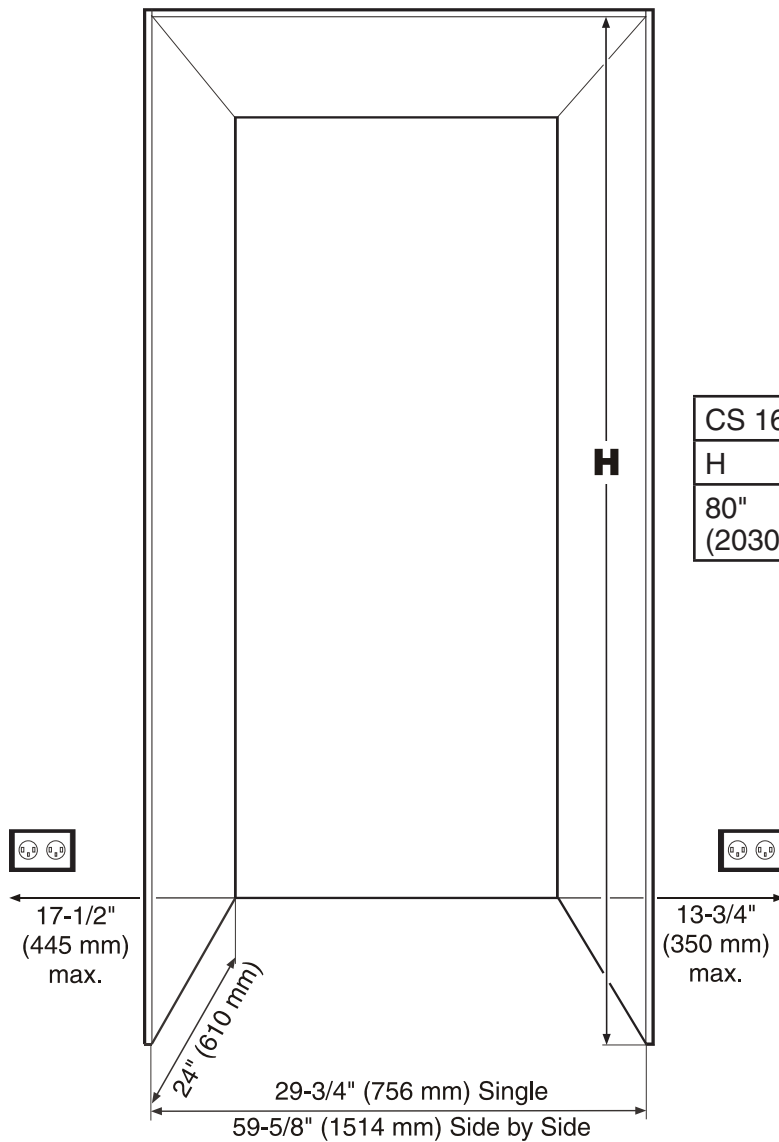

CS 1640	CS 1400
H	H
80" (2030 mm)	73 3/4" 1873 mm



With the electrical outlet at the bottom, please consider the maximum distance left or right.

Figure 4

INSTALLATION

Leveling the appliance - Figure 5

1. The height can be adjusted in front by twisting the leveling feet ①.
2. Twist the adjusting bolt ② to set up the back of the appliance.
3. Align the appliance with sides of kitchen cabinets by adjusting leveling feet ① and the supports ②.

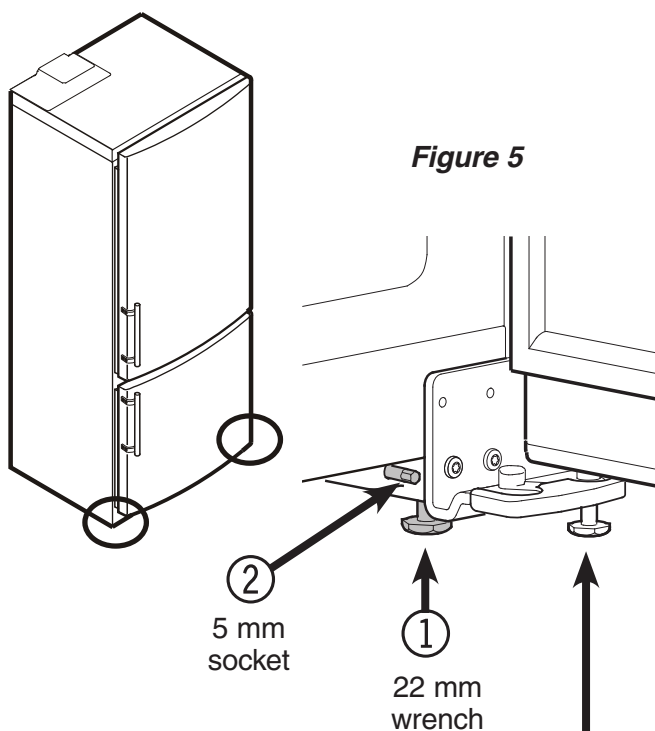

IMPORTANT

After final installation, this screw must be turned down until it has proper floor contact to support the hinge bracket.

Mounting the anti tipping device

⚠ WARNING

The anti tipping brackets must be mounted to prevent the appliance from tipping when the fully stocked door is opened.

⚠ WARNING

Be sure that there is no plumbing or electrical wiring located in this area which screws or drills could damage.

The anti tipping brackets provided can be mounted within 11-3/4 inch to the left and right of the appliance center (Figure 6).

Freestanding applications

1. Mark the center of the appliance on the back wall.
2. Mount the anti tipping brackets within the given area.

IMPORTANT

Locate at least one anti tipping bracket directly in line with a wall stud (Figure 6).

To ensure a secure mounting of the brackets, use any possible mounting option as shown in Figures 8 - 11.

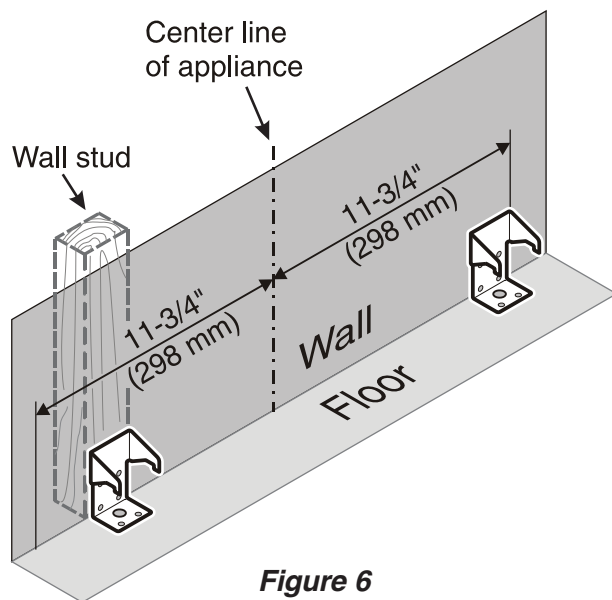

BLOCKING FOR SAFETY

Semi built-in

With semi built-in applications the anti tipping brackets must be mounted with a distance of 22 inches from the appliance housing front to the back of the bracket (**Figure 7**).

The gap to the wall must be filled with a wooden spacer to fasten the bracket.



WARNING

Be sure the wooden spacer is fastened securely to the floor.

1. Mark the center of the appliance on the back wall.
2. Mount the wooden spacer.
3. Mount the anti tipping brackets within 11-3/4 inch to the left and right of the appliance center.

IMPORTANT

*To ensure a secure mounting of the brackets use any possible mounting option as shown in **Figures 8 - 11**.*

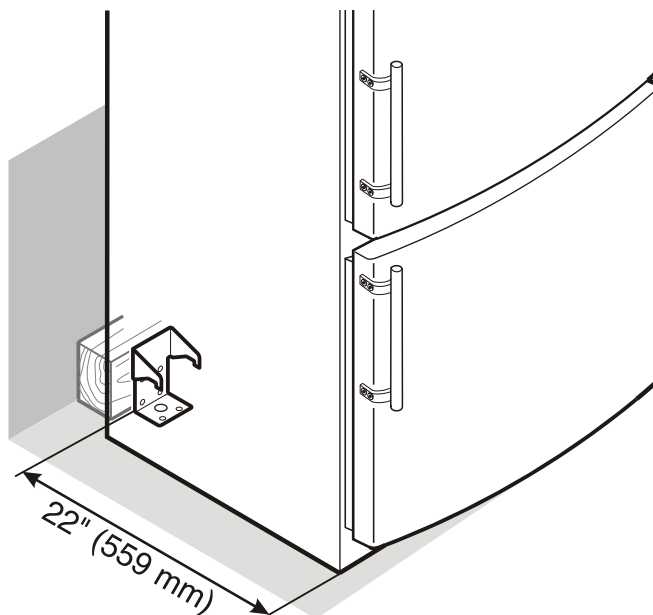

Figure 7

Mounting Options

Mounting the bracket with the wall stud.

Mounting with wall plugs at concrete walls (**Figure 8**).

Screws 6 x 63 mm

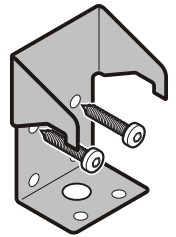

Figure 8

Mounting with the wall plate turning in the screws at an angle (**Figure 9**).

Screws 6 x 63 mm

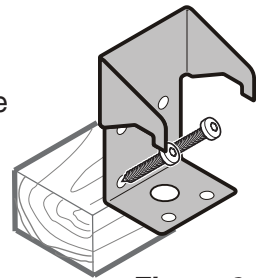

Figure 9

Mounting with wooden floors (**Figure 10**).

Screws 6 x 63 mm

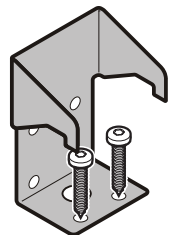

Figure 10

Mounting with concrete floors using the anchors provided (**Figure 11**).

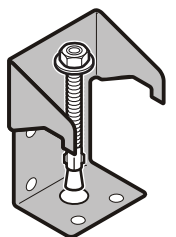

Figure 11

NOTE

If longer or shorter screws are needed, they have to be supplied by the installer.

REVERSING DOOR HINGES

Door hinges should only be changed by a trained expert.
Changing the door hinges must be done by two people.

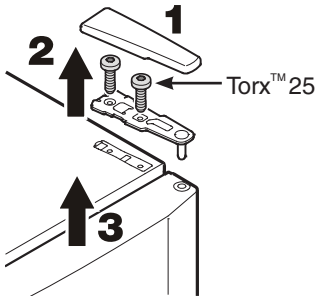
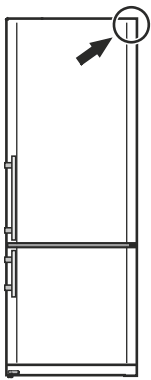

1. Remove cover.
2. Unscrew hinge bracket.
3. Remove top door.

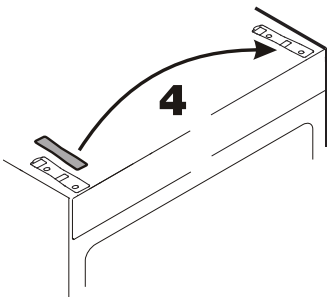
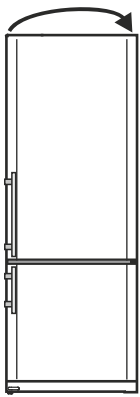

4. Transfer cover plate to the opposite side.

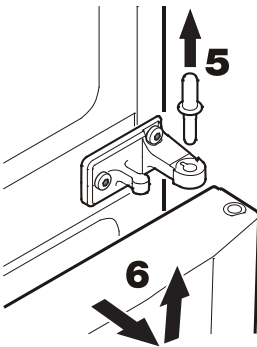
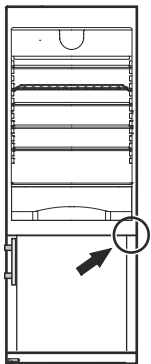

5. Pull out middle hinge pin.
6. Remove bottom door.

7. Transfer plug.
8. Lever out pressure plates at the front and slide away.
9. Transfer door handles and plugs to the other side.

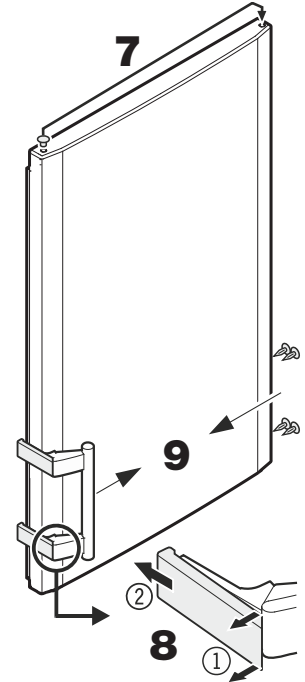

10. Transfer spring clip to the opposite side.

Follow steps 7, 8, 9 and 10 again to transfer the parts of the freezer door.

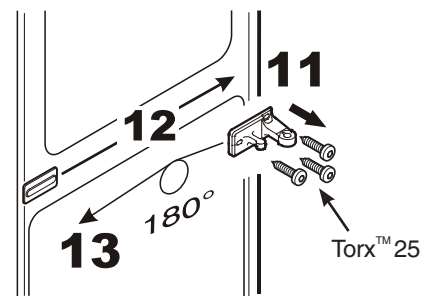
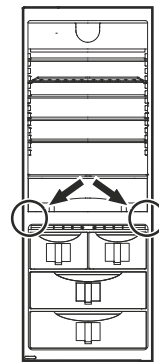
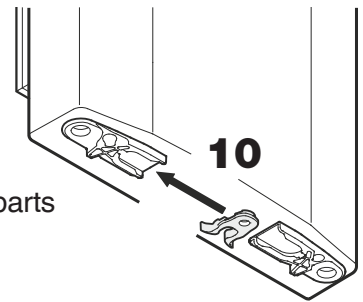

11. Unscrew hinge bracket.
12. Transfer cover plate to the opposite side.
13. Turn hinge bracket through 180° and screw into place.

REVERSING DOOR HINGES

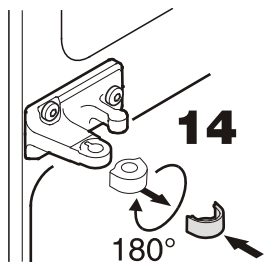
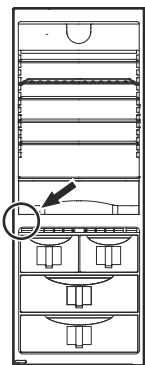

- 14.** Remove hinge bushing, turn through 180° and re-fit.

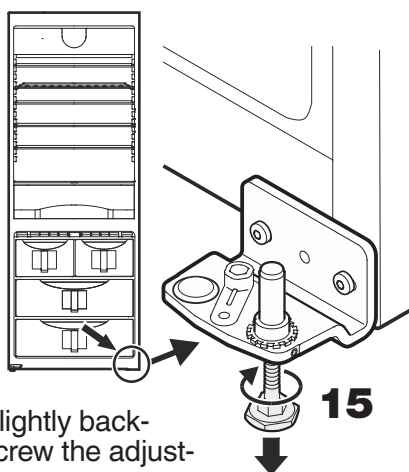

- 15.** Tilt appliance slightly backwards and unscrew the adjustable foot.

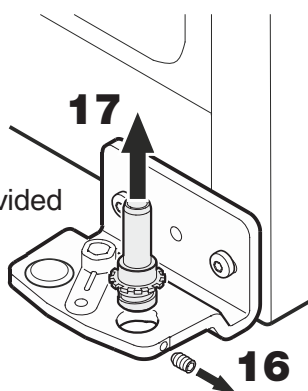

- 16.** Remove the set screw using the Allen key provided (size 2).

- 17.** Remove the bolt.

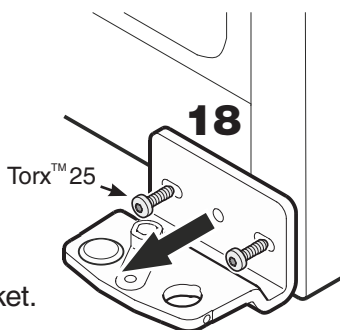

- 18.** Unscrew hinge bracket.

- 19.** Transfer the hinge component on the hinge bracket to the opposite side.

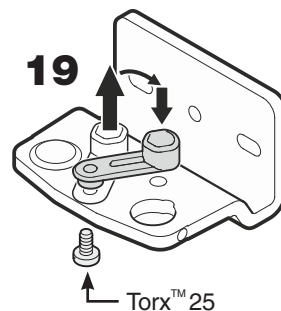

- 20.** Transfer cover to the opposite side.

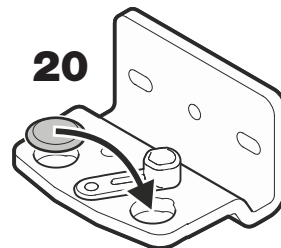

- 21.** Transfer cover plate to the opposite side.

- 22.** Screw hinge bracket into place.

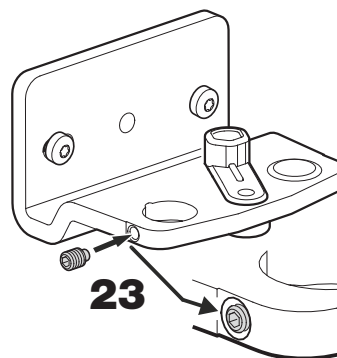
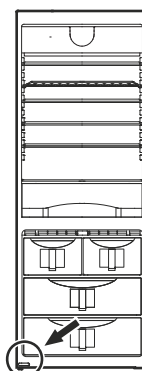
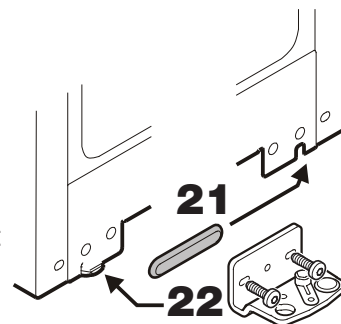

- 23.** Screw in the set screw until the top of the screw is in line with the side surface of the hinge bracket.

REVERSING DOOR HINGES

Side view of the lower hinge bracket

- 24.** Insert the bolt with its cutout in line with the set screw. Then turn the bolt until it is fully inserted in the hinge bracket. Finally tighten the set screw.

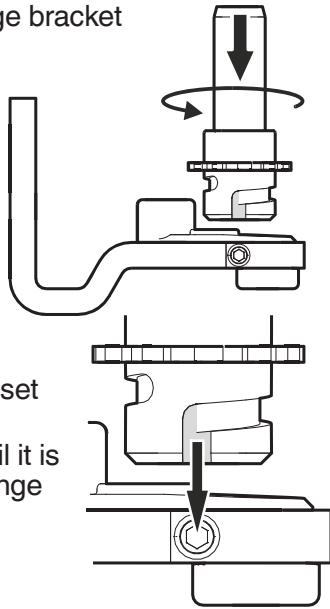

- 27.** Insert middle hinge pin.

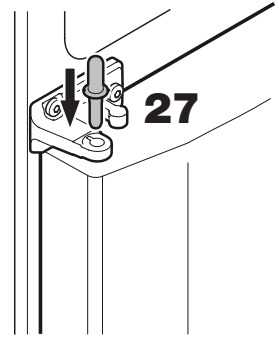

- 28.** Suspend top door on hinge pin and close.

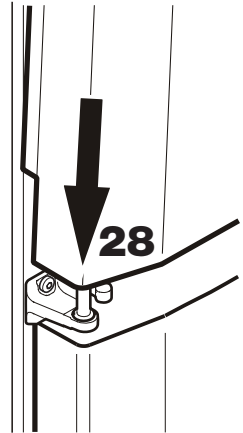

- 25.** Tilt appliance slightly backwards and screw in the adjustable foot.

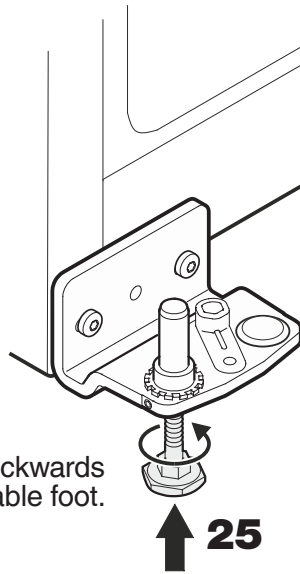

- 29.** Insert hinge bracket and screw into place.

- 30.** Click cover into place.

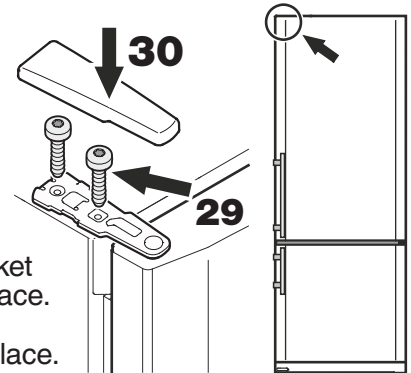

- 26.** Suspend bottom door on hinge pin and close.

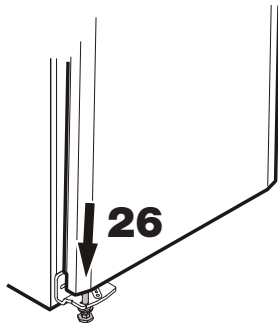

- 31.** Place the appliance in its final position at the place of installation.

Extend the adjustable foot at the bottom hinge bracket until it rests on the floor and then make a further 90° turn. Use the open-ended wrench (size 10) provided.

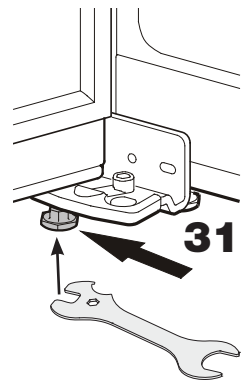

DOOR ADJUSTMENT

The freezer door can be adjusted in height to have the same level. This is especially important when doing side-by-side installations to achieve doors with aligned heights.

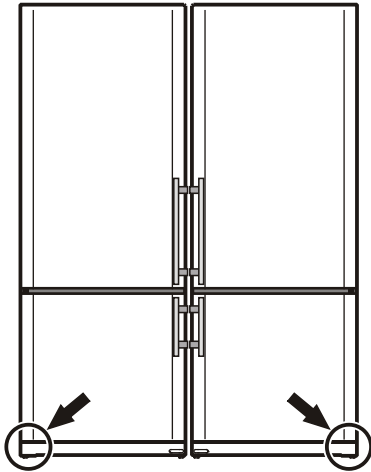

Position of the lower hinge brackets.

1. Loosen the set screw at the side of the lower hinge bracket using the allen key provided.

IMPORTANT

*Only loosen the screw.
Do not turn for more than
1/2 turn.*

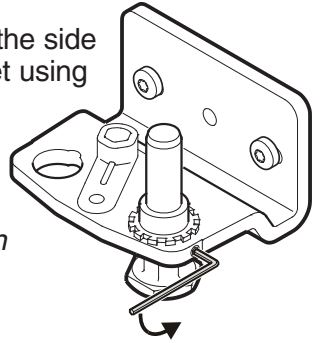

2. Turn the bolt counter-clockwise to raise the door using the special keyed wrench provided.

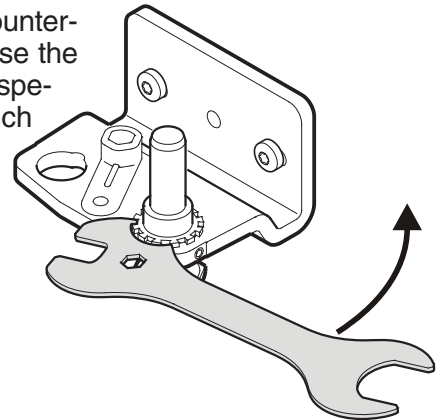

Turn the bolt clockwise to lower the door.

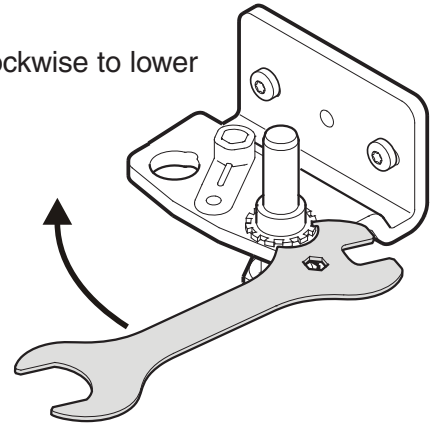

3. Tighten the set screw with the allen key.

IMPORTANT

Do not overtighten.

