

# 36" Counter-Depth 3-Door Refrigerator

**BOSCH**

500 Series – Stainless Steel B36CD52SNS



**B36CD52SNS**  
Stainless Steel

Also available in:

Black Stainless Steel  
B36CD52SNB

**36" 500 Series French Door Bottom Freezer Refrigerator, Counter Depth, External Ice/Water Dispenser, Stainless Steel, Bar Handles**

## Features & Benefits

Never run out of ice – the QuickIce Pro® System produces 12 lbs. of ice per day.<sup>1</sup>

Say goodbye to smudges and fingerprints with new anti-fingerprint stainless steel

Convenient external control panel displays fridge and freezer temperature settings

With Home Connect®, remotely control and monitor your appliance to efficiently manage your day.

UltraClarityPro® water filter reduces >99.9% of sediment that may be found in your water and ice, including harsh elements like chlorine and chloramine.

## Dimensions and Weight

Overall width (inches)	35 5/8"
Overall height (inches)	70"*
Overall depth with doors and handles (inches)	31 1/8"
Overall depth without doors and handles (inches)	25"
Required cutout size (HxWxD) (inches)	70" x 36" x 25"
Net Weight /Gross Weight (approx.) (lbs.)	304 / 331

## Style

Color	Stainless Steel
Door handle type	Bar handle
Interior finish	White and stainless steel back wall
Counter depth	Yes

## Performance

VitaFresh® Plus	Yes
SuperFreeze®	Yes
Evaporators / Compressors	1 / 1
QuickIce Pro®	Yes
Automatic defrosting	Yes
External water dispenser	Yes (ice and water)
One touch bottle fill	Yes

## Capacity and Storage

Total capacity (cu. ft.)	21.6
Refrigerator capacity (cu. ft.)	15.2
Freezer capacity (cu. ft.)	6.4
Full-extension freezer storage drawer	1
2-tiered freezer drawer	Yes
Full width chiller drawer	1
Humidity control drawers	2
Storage shelves	4 Adjustable, 1 Fixed
Small door bins	5
Large gallon door bins	2

## General Features

Anti-fingerprint stainless steel	Yes
External control panel	Yes
Water filter replacement indicator	Yes
Water filter	UltraClarityPro®
Ice maker	Yes
Ice production (24 hrs.), ice cubes (lbs.)	12
Ice storage capacity (lbs.)	2.8
LED interior and drawer lighting	Yes
Independent cooling systems	1
Cooling system	MultiAirFlow™
AirFresh® filter	Yes
Maximum sound level	40 dBA
Wi-Fi-enabled for control with Home Connect® app	Yes

## Energy Efficiency

Energy consumption (kWh/yr)	656
ENERGY STAR® Certified	Yes

## Technical Specs

Required power supply	110-127 V, 60 Hz, 15 amps
Plug type	120V-3 Prong
Power cord length (in.)	91"

## Operating Temperature

Refrigerator: 33°F (1°C) to 43°F (6°C)
Freezer Drawer: -7°F (-22°C) to 6°F (-14°C)
SuperCool: 30°F (-1°C) for approx. 8 Hrs.
SuperFreeze®: -15°F (-26°C) for approx. 8 Hrs.

## Warranty

Limited warranty, parts & labor	1 Year
---------------------------------	--------

## Optional Accessories

Replacement UltraClarityPro® water filter: BORPLFTR55

FreshProtect™ Ethylene Filter Kit: FPETHKT50

Water filter bypass (part no.): 10013297

90 degree door stopper: 10012733

<sup>1</sup>Based on filling 8 oz glasses.

\*When leveling legs are fully extended, add 5/8" to overall height, total 70 5/8".

# BOSCH

## Installation Details

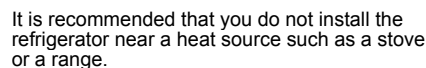
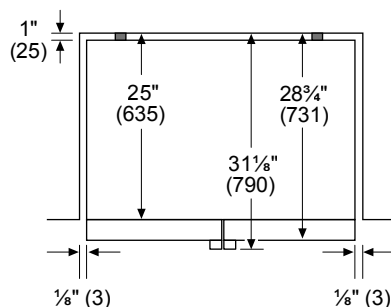
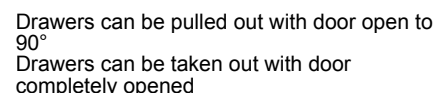
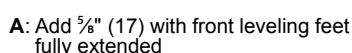
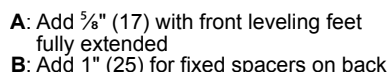

11/24