

# Alfresco™

Open Air Culinary Systems

## GAS SUPPLY CONVERSION AND ORIFICE REPLACEMENT GUIDE

NOTE: SIDE BURNER ASSEMBLIES CAN BE ORDERED AS A WHOLE UNIT (KIT) FOR NATURAL GAS (NG) OR LIQUID PROPANE (LP). CAPS AND ORIFICES CAN BE INDIVIDUALLY REPLACED IF REQUIRED - SEE COMPONENT NUMBER BELOW.

### BILL OF MATERIALS

ITEM	PART NUMBER
1	100-0891
2	100-0892
3	100-0893
4	100-0894
5	100-0895

DESCRIPTION
FIRE BOX MAIN - BOTTOM & SIDES
FIRE BOX FRONT
FIRE BOX REAR SHIELD
FIRE BOX HEAT SHIELD
PIVOT - 1/4" x 20" - OPEN END - (SHOWN PRESSED)
STUD - SPOT WELD - 1/2" x 1/2" x 1/2" L
30" BBQ - RIGHT BASE SUB-ASSEMBLY
30" BBQ - LEFT BASE SUB-ASSEMBLY
SMOKER HOUSING - TOP

MATERIAL	FINISH
18 GA. SS	2B
18 GA. SS	2B
18 GA. SS	2B
18 GA. SS	2B
18 GA. SS	2B
STL	Zn-Fe
SS	2B
SS	2B
18 GA. SS	2B

COMPLETION: 2/28/2008  
DRAWING NO: 200-0071  
PROJECT TITLE: 30" BBQ UNIT  
DRAWING TITLE: SIDE BURNER ASSEMBLY  
DRAWN BY: ADRIAN CRISCI  
CREATED: February 28, 2008 4:00 PM

DRAWING NO: 200-0071  
PROJECT TITLE: 30" BBQ UNIT  
DRAWING TITLE: SIDE BURNER ASSEMBLY  
DRAWN BY: ADRIAN CRISCI  
CREATED: February 28, 2008 4:00 PM

COMPLETION: 2/28/2008  
DRAWING NO: 200-0071  
PROJECT TITLE: 30" BBQ UNIT  
DRAWING TITLE: SIDE BURNER ASSEMBLY  
DRAWN BY: ADRIAN CRISCI  
CREATED: February 28, 2008 4:00 PM

# Gas Supply Conversion and Orifice Replacement Guide

## PURPOSE:

If a barbeque or side burner unit is to be operated with a different gas supply other than the one provided by the factory, a conversion kit is required. This change must be done in order to ensure that:

- The unit is safe to operate.
- The unit has correct combustion of gas.
- The unit outputs the expected heat (BTUH's).
- Your warranty is maintained.

By changing from Natural Gas (NG) to Liquid Propane (LP) or vice versa, the heat output as well as the regulating pressure and oxygen content of the gas/air mixture also changes. Therefore a change in orifice (gas injector) size is required, (usually larger or smaller depending on the application), as well as a change in the main pressure regulator setting to allow for proper gas pressure to the valves and burners.

On the next pages you will find the necessary information to replace orifices, adjust burners and convert pressure regulators to suit your application. This information is generalized due to the different models manufactured, nevertheless it applies to all of them in the same fashion as it indicates the location and how to access orifices and regulators.

For additional information, all conversion kit numbers and components are listed at the end of this guide in the appendix section.

## WARNING:

As the unit will be partially disassembled during gas supply conversion and orifice replacement, it is necessary to remove all power sources to the unit (including but not limited to: barbeques lights, rotisserie motor and igniter module batteries) as well as all gas supplies (Natural gas or Liquid propane).

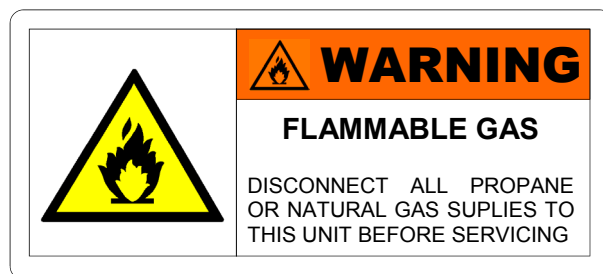
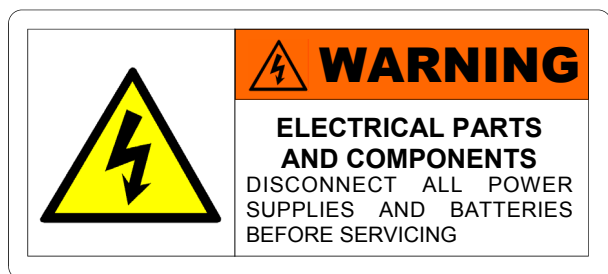

**Alfresco Gourmet Grills** recommends a qualified gas technician to perform this service.

## HOW TO OBTAIN SERVICE:

For warranty, service, contact your local Alfresco Gourmet authorized service agency. Provide him with the Model # and Serial # (located under drip pan), date of installation, and a brief description of the problem. If you need assistance in locating the authorized service agency in your area, contact your local dealer. He will have a listing of authorized service agents in you area.

We want you to remain a satisfied customer. If a problem occurs that cannot be resolved to your satisfaction, please us know. Write Alfresco Gourmet Grills. Customer Service Department. 7039 East Slauson Ave, Commerce, CA 90040. Or call Customer Service/Parts at (888) 383-8800 or (323) 722-7900 or fax us at (323) 726-4700. Visit us at: [www.alfrescogrills.com](http://www.alfrescogrills.com)

## BARBEQUES:

A typical barbeque unit will have the following burner components:

MODEL:	BURNER QUANTITIES:				
	SMOKER	"U" BURNER	SEAR-ZONE™	ROTISSERIE	SIDE BURNER
AGBQ-30	1	2	~	1	~
AGBQ-30SZ	1	1	1	1	~
AGBQ-30IR	1	~	2	1	~
AGBQ-42	1	3	~	1	~
AGBQ-42SZ	1	2	1	1	~
AGBQ-56	1	3	~	1	2
AGBQ-56SZ	1	2	1	1	2
AGBQ-56BFG	1	3	1	1	~
AGSB-2	~	~	~	~	2
AGSB-SZ	~	~	1	~	~

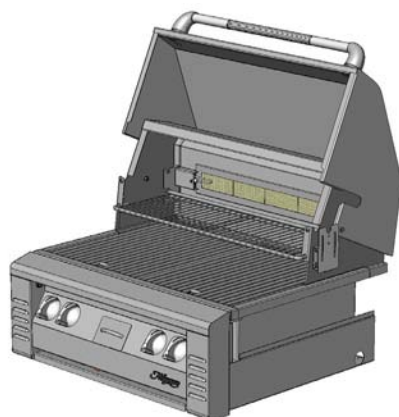

TYPICAL BARBEQUE

*Figure 1*

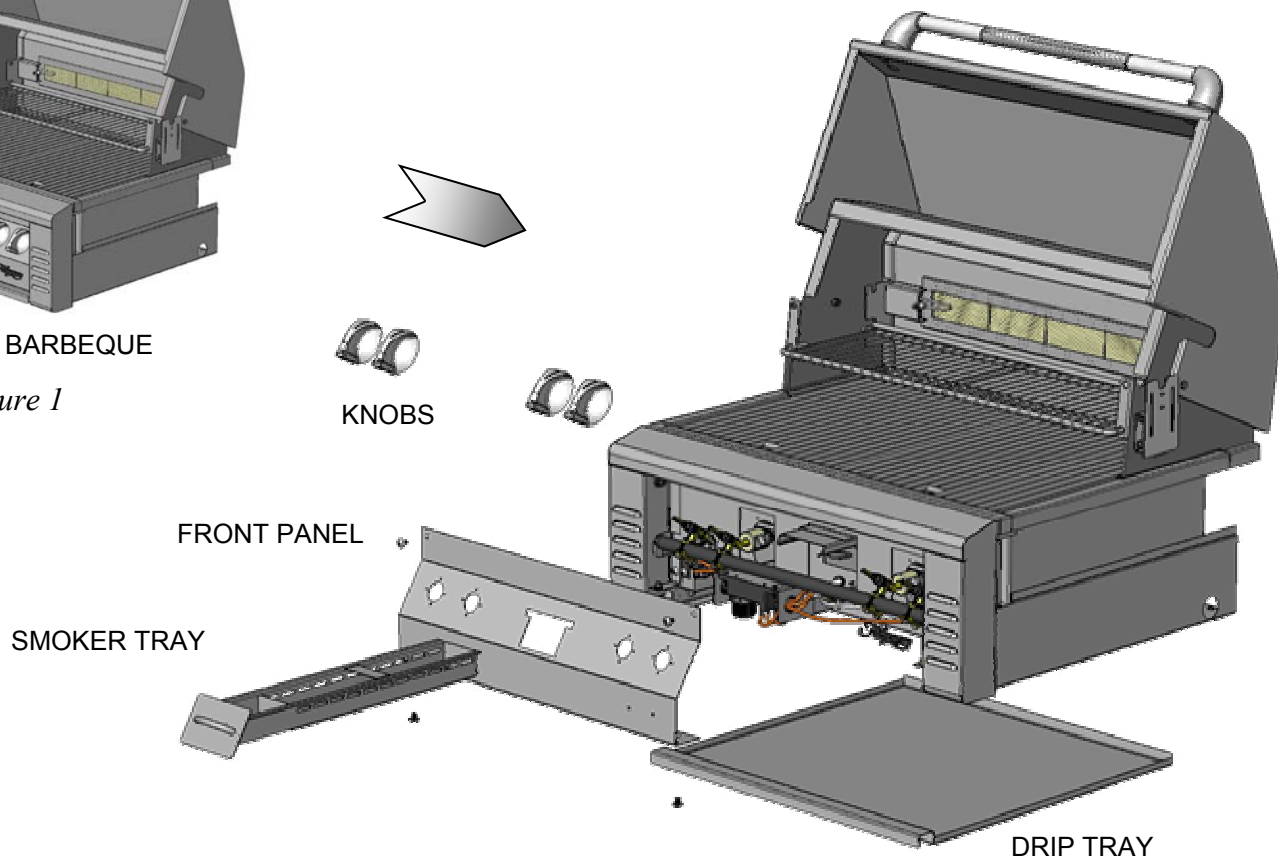

*Figure 2*

## STEPS:

- 1– Remove the knobs from the valve stems by pulling them straight out of the valve stems.
- 2– Remove the smoker and drip trays.
- 3– Remove the front panel screws (4) located at each corner (2 facing down and 2 on the upper corners)
- 4– Remove the front panel to expose valves, gas manifold and igniter assembly. (*Figure 2*)

*Barbeques cont.*

5– Remove warming rack, grills, briquette trays and “U” burners from the barbeque unit. *(Figure 3)*

6– Should your barbeque unit be equipped with a Sear-Zone™ burner, also remove it. *(Figure 4)*

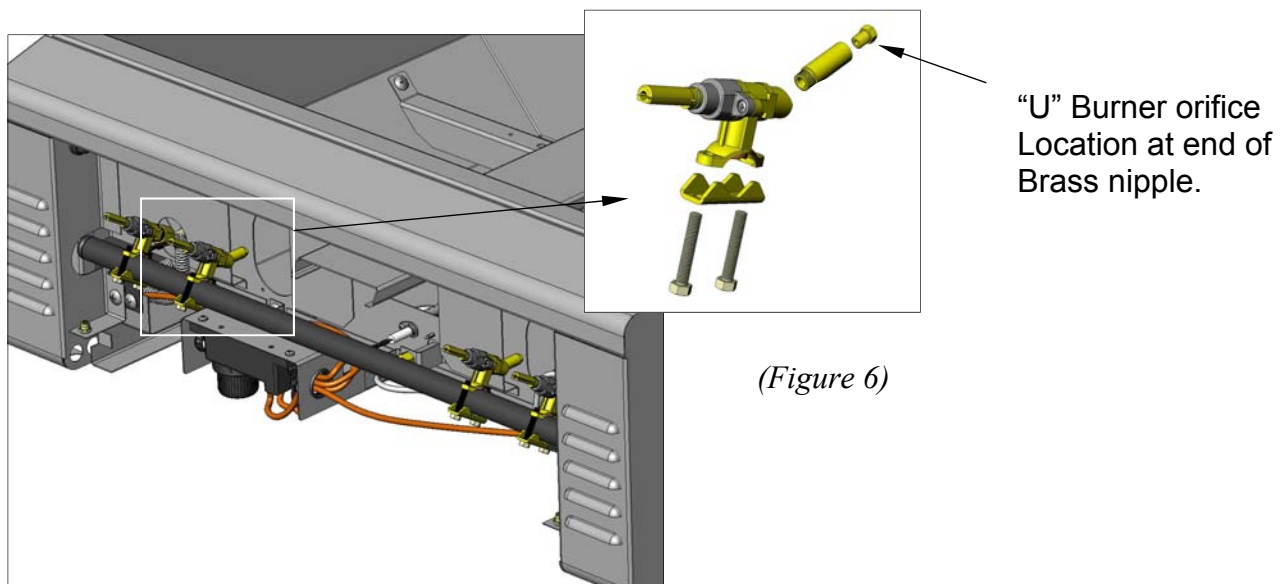
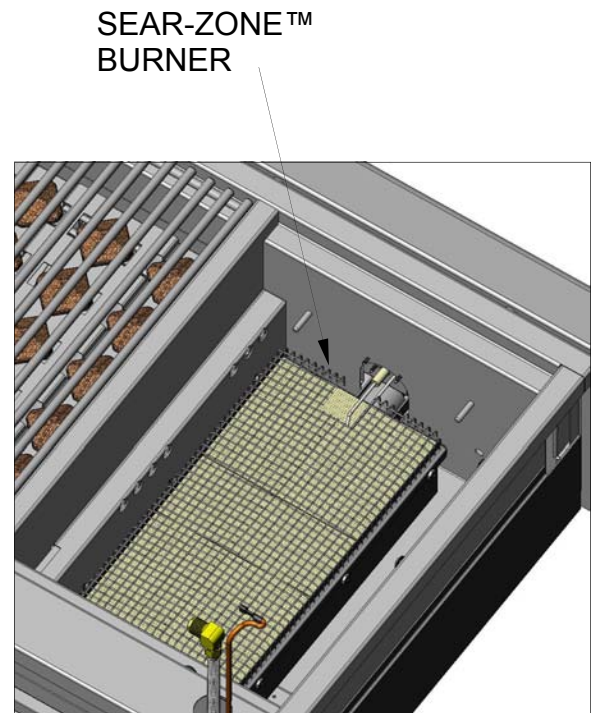
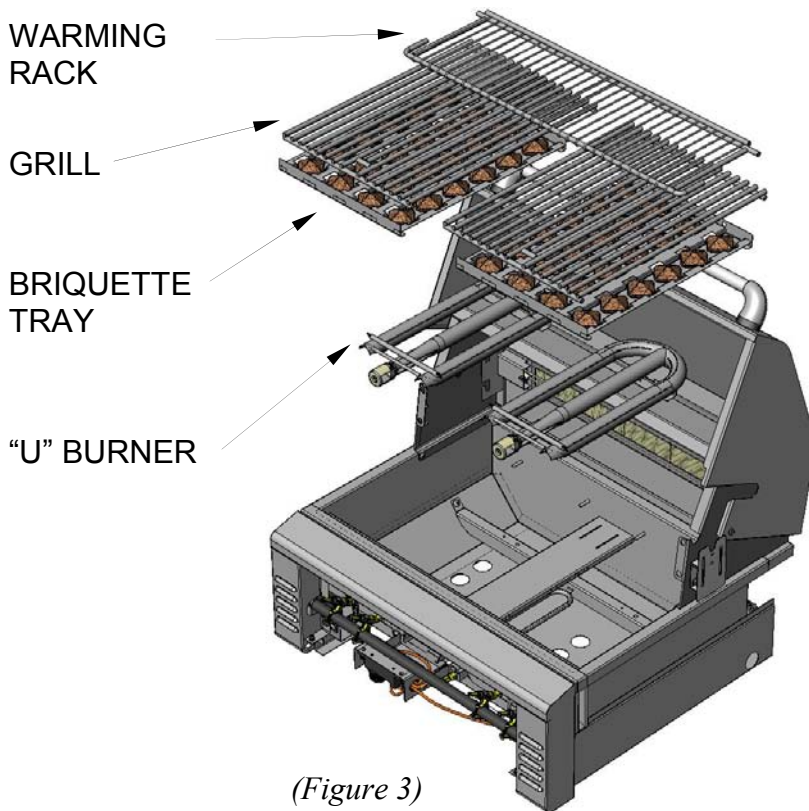

7– Now that the gas manifold and valves are exposed *(Figure 5)*, remove and replace each valve’s orifice for the proper gas supply, Natural Gas or Liquid Propane. Standard “U” burners have an angled valve with an orifice located in the valve’s body, on the back at the end of an adapter nipple. *(Figure 6)*



*Barbeques cont.*

- 8— If your unit is equipped with a Sear-Zone™ burner, the valve has an orifice mounted externally to the valve body. The orifice is directly attached to the barbeque fire box with a bracket and connected to the valve with a flexible stainless tube. (Figure 7)  
It is mounted on this bracket along with the Sear-Zone™ igniter electrode. Remove and replace this orifice from the inside of the firebox. (Figure 8)

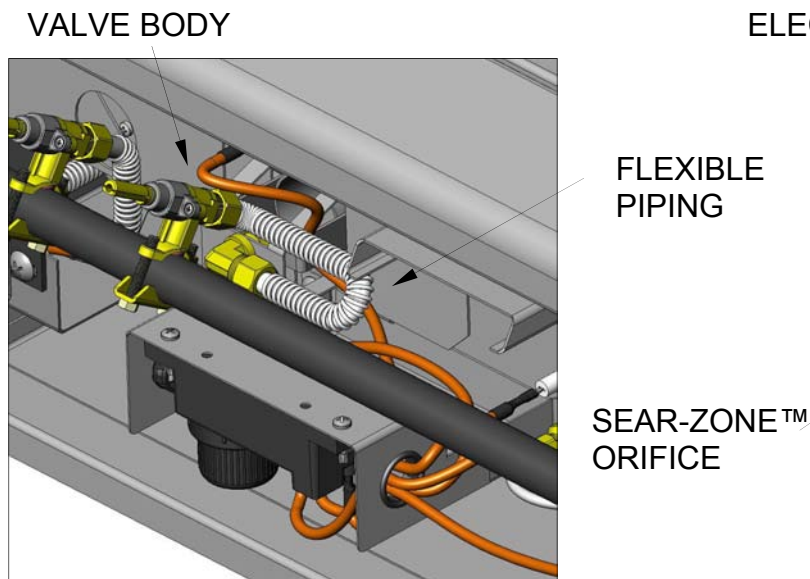

(Figure 7)

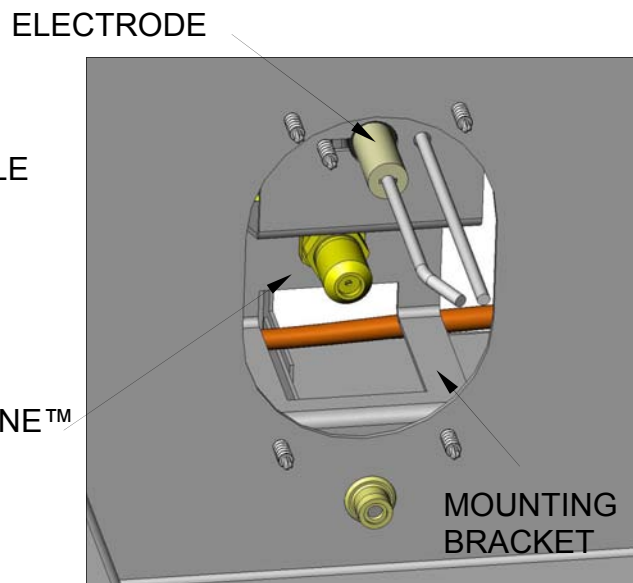

(Figure 8)

- 9— The smoker unit's orifice is also mounted externally from the control valve body. It is connected with a small 3/16" Ø aluminum tube. The orifice is mounted on a bracket attached to the fire box. To replace this orifice, remove the mounting bracket from the fire box and gently bend the aluminum tubing outward to prevent kinks. After replacement, re-install bracket / orifice assembly back into the fire box. (Figure 9)

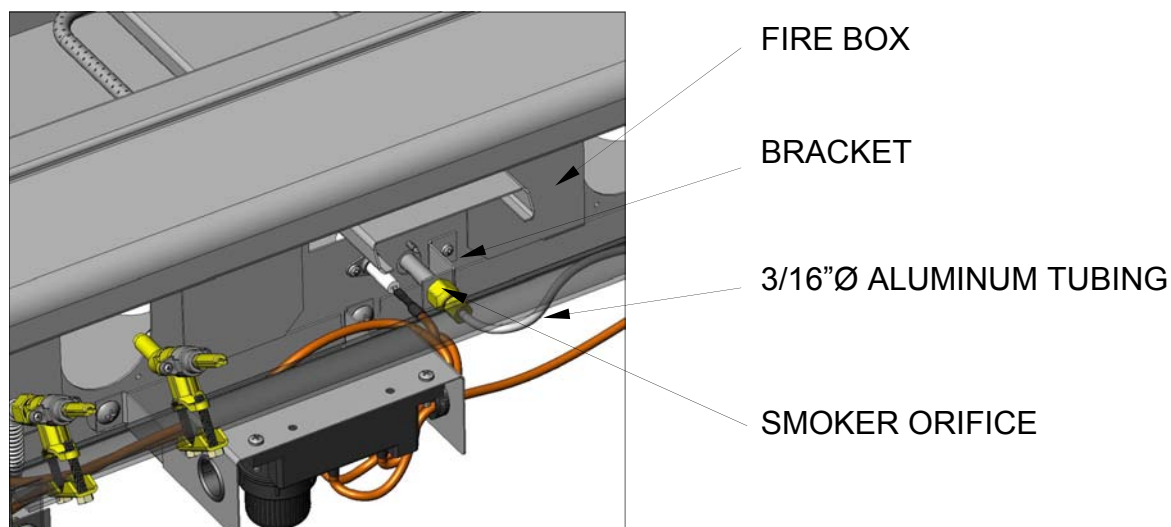

(Figure 9)

## Barbeques cont.

10– To replace the rotisserie orifice, it must be accessed from the back of your barbeque unit.

Just like the Sear-Zone™ and the smoker unit, the rotisserie unit has an externally mounted orifice connected to the valve body with a long flexible stainless tube.

Remove the rear rotisserie access plate (Figure 10) and locate the orifice on the compression fitting that is mounted on the burner bracket (Figure 11). Replace orifice and re-install the access cover.

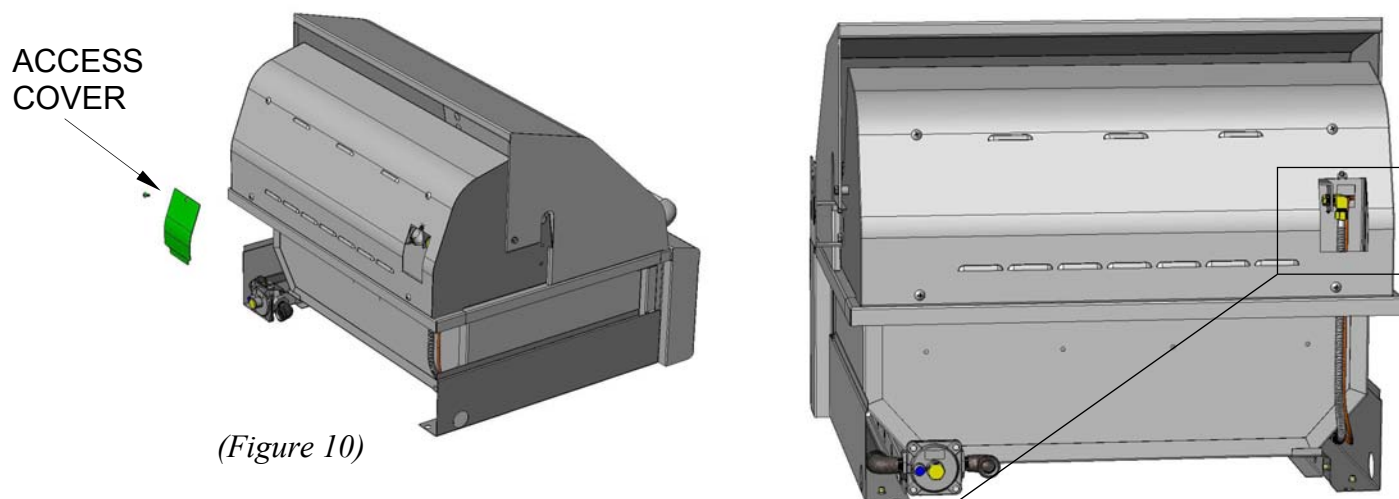

(Figure 10)

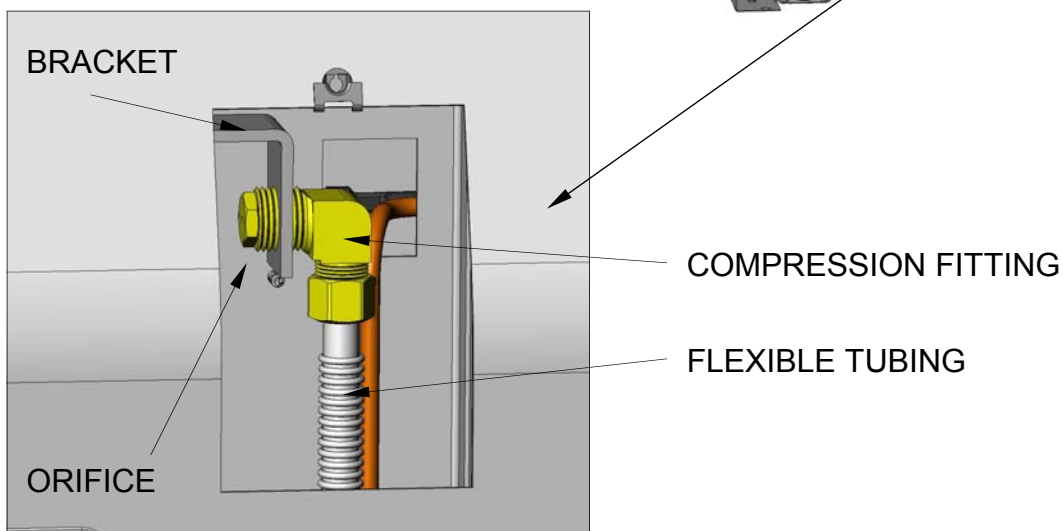

(Figure 11)

## SIDE BURNERS:

Side burners can be found as separate units such as AGSB-2 (2 burner unit) and AGSB-SZ (Sear-Zone™ unit) or built within the frame of the barbeque such as our AGBQ-56 model Deluxe Grill.

In either case, their respective orifices are installed and accessed in the same fashion. If a side burner is part of a barbeque such as the Deluxe Grill, gas will be supplied to the burner from the same manifold that feeds the main unit. All Individual units have their own pressure regulators.

If the side burner is part of a Deluxe Grill, the manifold will be accessed in the same fashion as shown on page# 4 — item # 7. For all other side burners, follow the next few steps.

## AGSB-2 Dual Side Burner

### STEPS:

- 1- A dual side burner unit AGBS-2 (*Figure 12*) has the orifices readily available. Simply remove the top grate, burner external brass caps and inner aluminum caps. (*Figure 13*)
- 2- Orifices are accessible directly from the top (*Figure 14*). Remove and replace each orifice as required and re-assemble the side burners.

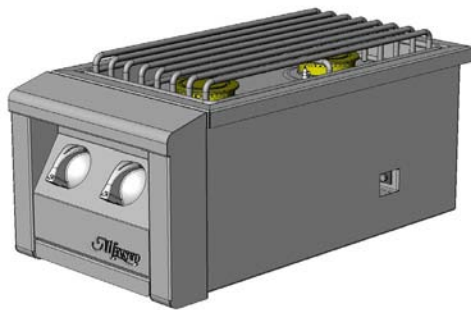

(*Figure 12*)

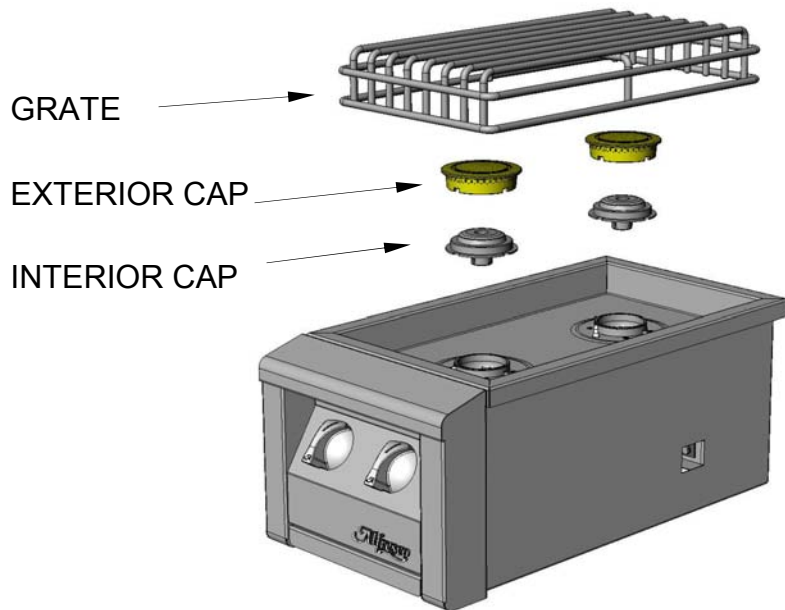

(*Figure 13*)

TOP VIEW



(*Figure 14*)

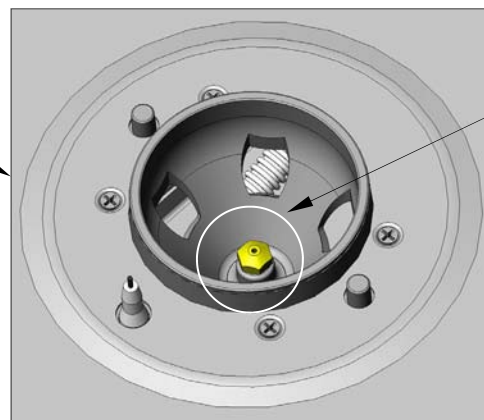

Orifice  
Located inside  
burner body.

## AGSB-SZ Sear-Zone™ Side Burner

### STEPS:

- 1- A Sear-Zone™ side burner unit AGBS-SZ (*Figure 15*) has the orifice located inside the firebox assembly in the same configuration as a barbeque grill. To access the orifice remove the top grate, Sear-Zone™ burner, knob, drip tray and front control panel (*Figure 16*)

Side Burners cont.

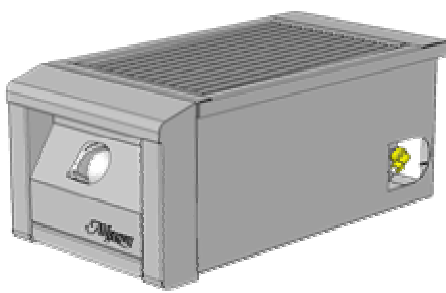

(Figure 15)

GRATE

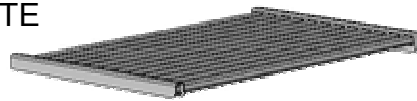

SEAR-ZONE™ BURNER

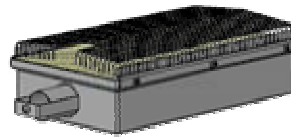

KNOB



FRONT PANEL

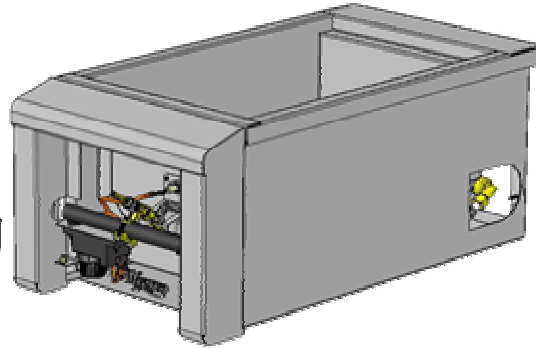
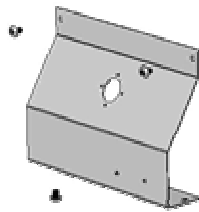

DRIP TRAY

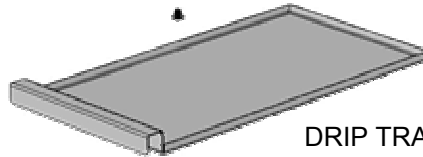

(Figure 16)

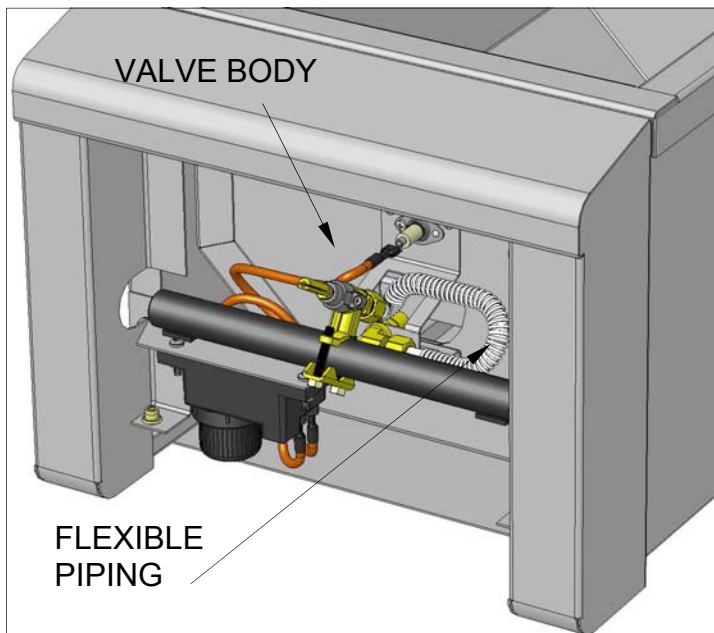

(Figure 17)

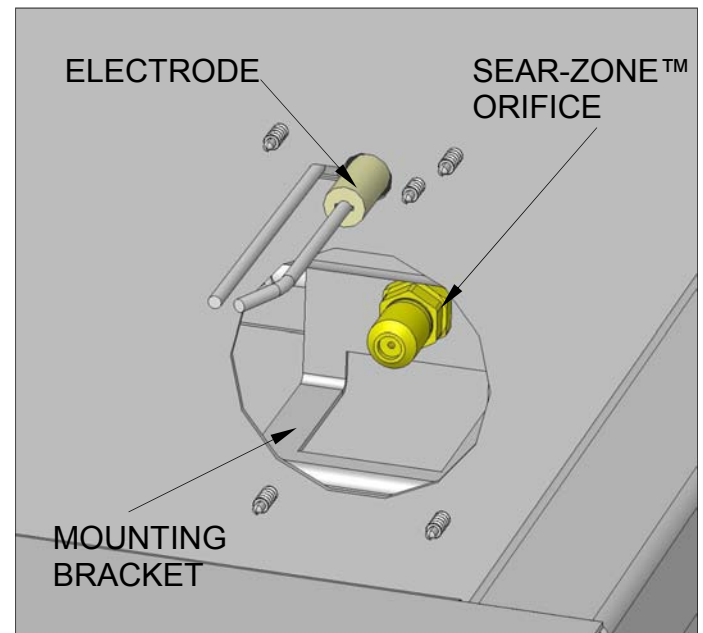

(Figure 18)

2– Once the front panel is removed the Sear-Zone™ orifice will be viewable (Figure 17). It is located externally from the control valve in similar configuration as the barbeque unit. (Refer to page 5 point 8).

It is however, easier to reach the orifice from the inside of the fire box assembly as it is mounted on a support bracket next to the electrode assembly. (Figure 18). Remove and replace. Re-assemble the unit.



## PRESSURE REGULATORS:

Your barbeque grill as well as side burner unit is equipped with a dual gas supply (NG or LP supply) pressure regulator standard from the factory. It is necessary however, to reverse an internal plunger within the regulator to allow for correct pressure to flow to the gas manifold.

Also, when converting from natural gas (NG) to liquid propane (LP) your conversion kit will include a 1/2"Ø MPT to 3/8"Ø Male Compression adapter nipple. This nipple is required to connect your regulator to a standard propane tank and hose kit.

All pressure regulators are located on the back of the units and on the left side. (*Figures 19, 20 & 21*)

BARBEQUE GRILL

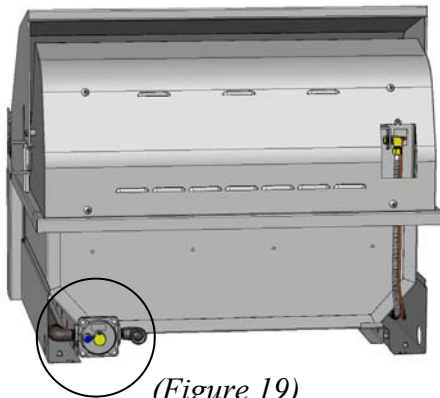

(*Figure 19*)

AGSB-2 SIDE BURNER

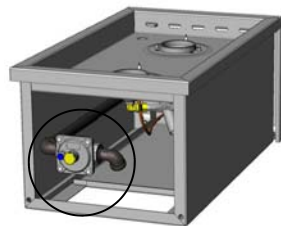

(*Figure 20*)

AGSB-SZ SIDE BURNER

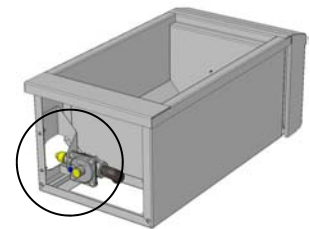

(*Figure 21*)

## STEPS:

- 1— Locate the inlet elbow (1/2" Ø black pipe elbow) and attach the hose regulator nipple using gas approved gas plumbing seal of yellow Teflon® tape. (This step only applies to NG to LP conversion) (*Figure 22*)

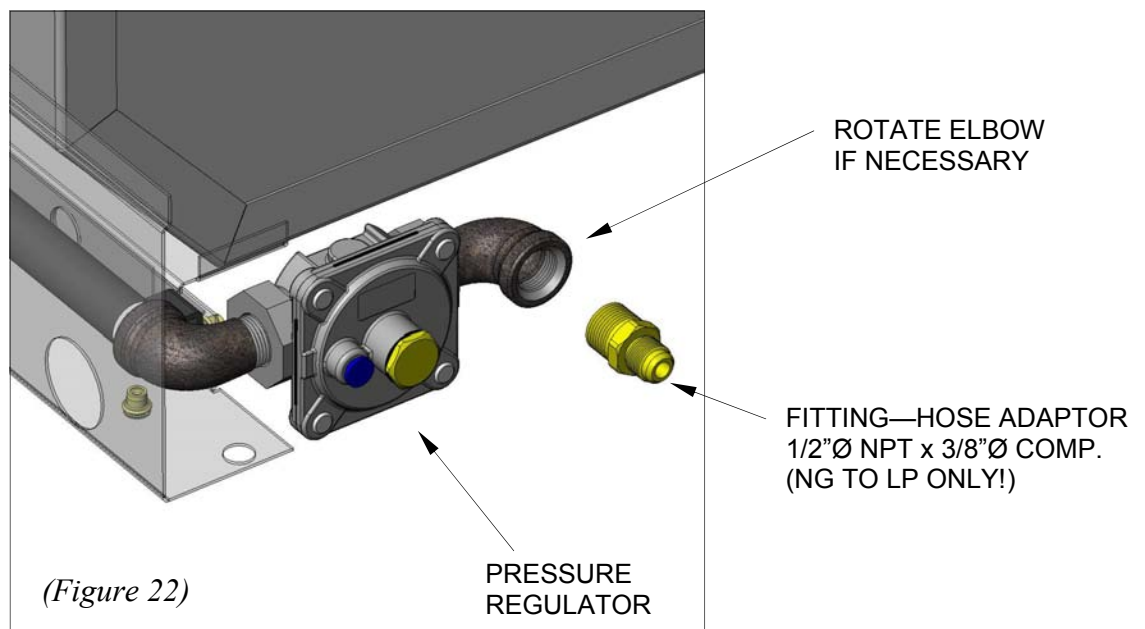

## Pressure Regulators cont.

- 2— To convert to pressure regulator from NG to LP (or vice-versa) , remove the brass cap located on the large round dome of regulator body. The cap has a sealing washer; do not lose or damage this sealing washer as it is required for a gas tight seal. (Figure 23)
- 3— Located on the cap is also a black plastic plunger. This plunger provides the correct pressure to a spring located inside the body of the regulator.  
It is necessary to **reverse** the direction of the plunger so it provides the right amount of pressure to the spring inside the body of the regulator.  
To **reverse** the plunger pull it out of the brass cap by pushing it sideways until it snaps and pops out.
- 4— The plunger is labeled “NAT” or “LP” for natural gas or liquid propane. (Figure 24). The regulator is set to the correct pressure according to the way the plunger faces the regulator body. If the plunger label reads “NAT” towards the body of the regulator , it will be set for natural gas. If it reads “LP” it will be set for liquid propane.

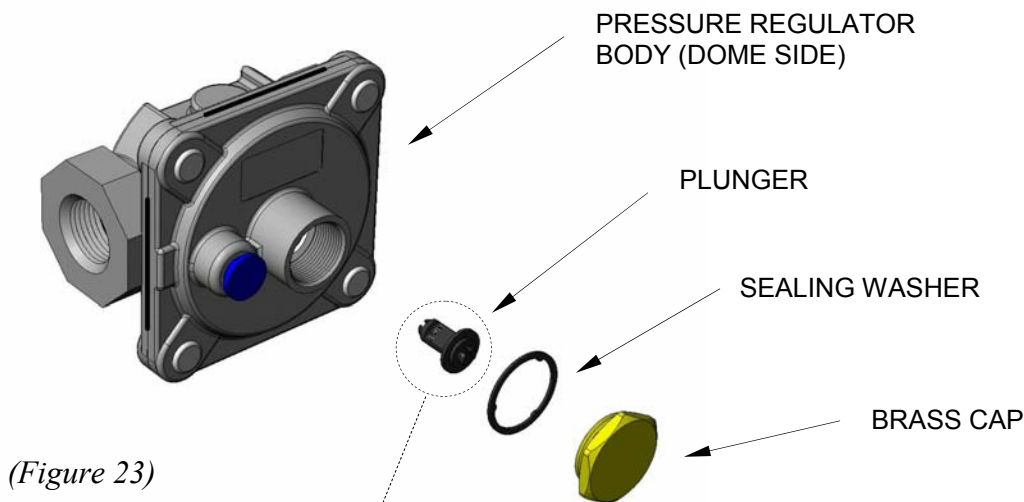

(Figure 23)

### PLUNGER DETAIL:

The regulator plunger is labeled “NAT” for Natural gas or “LP” for liquid propane. (The “LP” side has a wide disk on the end.) The side facing the body of the regulator determines what use is the regulator set for.

*Example:* The image above (Figure 23) is showing a regulator set for natural gas.

- 5— Once the regulator plunger has been reversed for it's appropriate use and snapped back into the brass cap, re-install the cap with the sealing washer back into the body or the regulator.

Your barbeque grill or side burner is now converted to it's new gas supply. Re-check all orifices and seals for proper tightness before applying power, gas supply and lighting your unit to adjust burners.

## BURNER ADJUSTMENT:

As a final step it is now necessary to adjust some burners for the correct air / gas mixture. All burners operate in the same fashion with the exception of the gas valves.

Gas valves for Sear-Zone™ and Rotisserie burners have a direct feeding valves. Gas valves for “U” shaped and Smoker burners have “idling” valves. “Idling” valves permit adjustment for the “LOW” setting in the valve to prevent the flame from going out, so they require adjustment when changing the gas supply type.

“Direct” feed valves do not have a “LOW” adjustment because they are designed for high BTUH and high gas flow operation such a the one required on Sear-Zone™ and Rotisserie burners. These burners will not go out even on their lowest setting. They are designed to run always on HIGH setting, so there is no adjustment necessary after a gas supply change.

To adjust idling valves on “U” burners and Smoker burners follow the next steps:

- 1– Verify that all burner holes are clean and free of debris.
- 2– Turn the valve to “HI” and light up the burner by pressing the igniter button. Let the unit “WARM UP” for 10 minutes.
- 3– Once the burner is lit and warmed up, turn to “LOW” setting. If the flame starts to go out you must adjust the “IDLE” port inside the valve.
- 4– Using a small flat screwdriver, insert the screwdriver blade through the stem of the valve and adjust. Counter clockwise for MORE gas flow, clockwise for less.  
(Figure 25)
- 5– Adjust the flame so the burner is fully lit around the perimeter when the knob is in the LOW position.

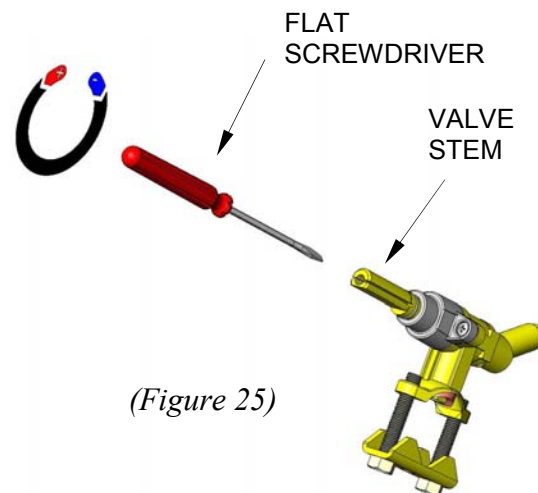

(Figure 25)

- 6- “U” burners also have an AIR INLET adjustment. If the flame around the perimeter of the burner seems to detach from the burner body, too much air is being injected into the burner. Adjust the air / gas mix by loosening the adjustment lock screw and turn clockwise for LESS air, counter clockwise for MORE. (Figure 26)  
If the flame turns yellow in color, there is not enough AIR into the gas mixture. Adjust the air inlet until the flame is light blue in color with small yellow tips for proper burning. You might need to repeat step 4 and 6 a few times to find an adequate balance.

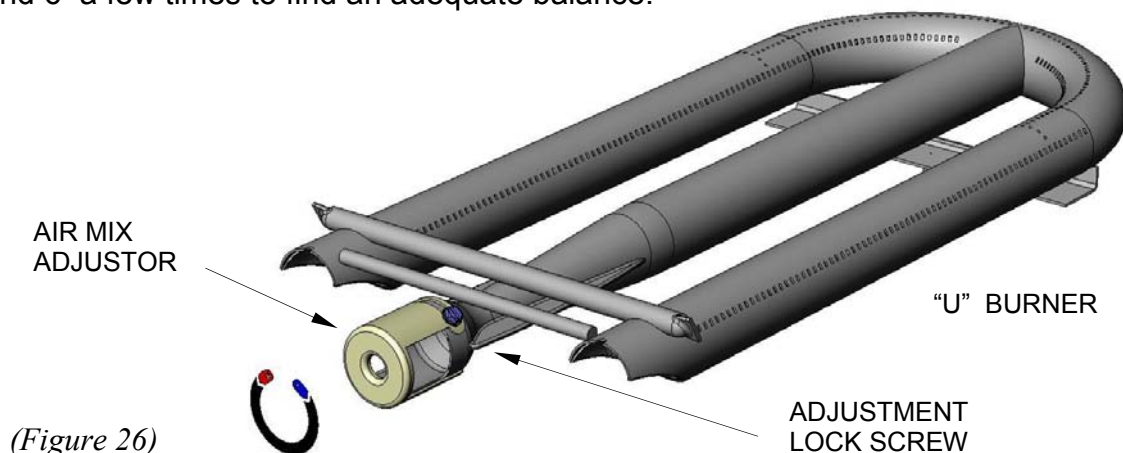

(Figure 26)

**Your unit is now fully converted to a new gas supply and ready for use.**

**APPENDIX:**

- ORIFICE CONVERSION KITS..... PAGE 13 ~20
- PROPANE KIT # 1 (*BARBEQUES WITH AND W/O SIDE BURNERS*) ..... PAGE 21
- PROPANE KIT # 2 (*SIDE BURNERS UNITS ONLY*) ..... PAGE 22



'U' BURNER  
ORIFICE

ZEAR-ZONE™  
BURNER  
ORIFICE

ROTISSERIE  
BURNER  
ORIFICE

SMOKER  
BURNER  
ORIFICE

HOSE ADAPTER  
NIPPLE

FRONT VIEW

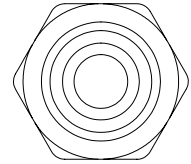
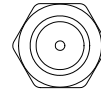
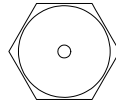
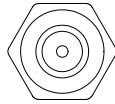

SIDE VIEW

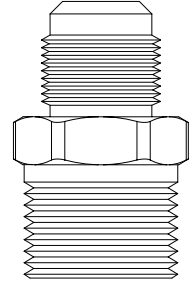
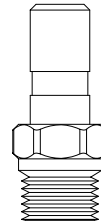
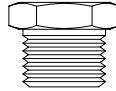
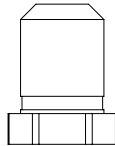

ISO VIEW

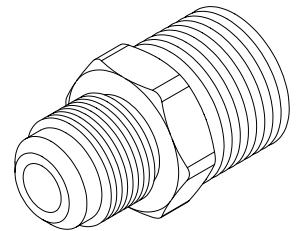
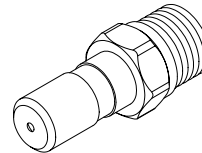
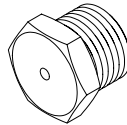
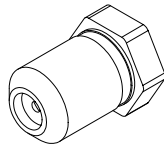

ALL ORIFICES & NIPPLES SHOWN ACTUAL SIZE

MODELS:	USE:	NG → LP		
AGBQ-30 AGBQ-30SZ AGBQ-30IR	KIT DESCRIPTION:	AGCK-30/NG-LP		
	KIT NUMBER:	190-0007		
	ITEM	ORIFICE	PART #	QTY:
	"U" BURNER - LP	1.55 mm	220-0282	2
	SEAR-ZONE™ - LP	52 GA.	220-0290	2
	ROTISSERIE - LP	57 GA.	220-0284	1
	SMOKER - LP	65 GA.	220-0288	1
	HOSE ADAPTER NIPPLE		220-0275	1

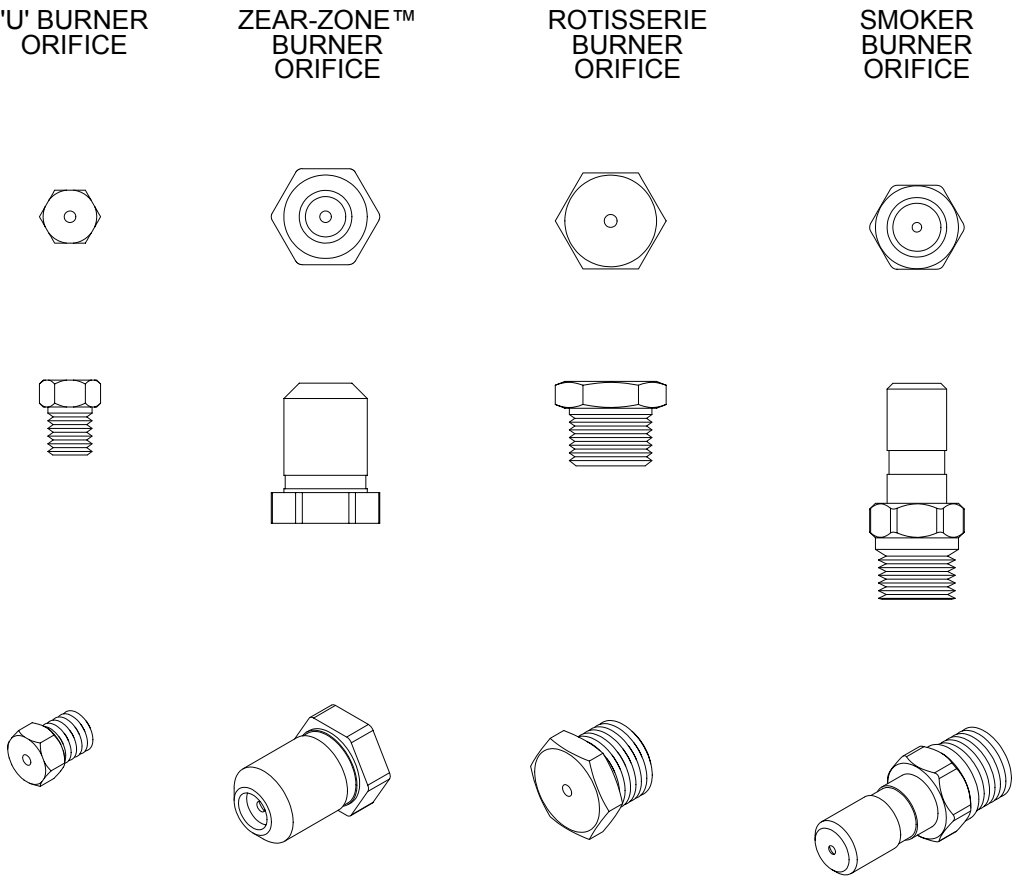

ALL ORIFICES & NIPPLES SHOWN ACTUAL SIZE

MODELS:	USE:	LP → NG		
AGBQ-30 AGBQ-30SZ AGBQ-30IR	KIT DESCRIPTION:	AGCK-30/LP-NG		
	KIT NUMBER:	190-0008		
	ITEM	ORIFICE	PART #	QTY:
	"U" BURNER - NG	2.55 mm	220-0281	2
	SEAR-ZONE™ - NG	39 GA.	220-0891	2
	ROTISSERIE - NG	50 GA	220-0283	1
	SMOKER - NG	60 GA	220-0287	1

'U' BURNER  
ORIFICE

ZEAR-ZONE™  
BURNER  
ORIFICE

ROTISSERIE  
BURNER  
ORIFICE

SIDE  
BURNER  
ORIFICE

SMOKER  
BURNER  
ORIFICE

HOSE ADAPTER  
NIPPLE

FRONT VIEW

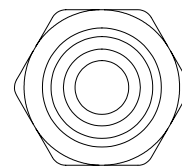
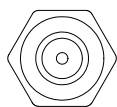

SIDE VIEW

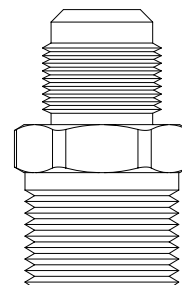
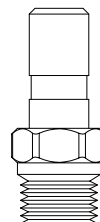
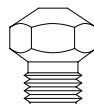
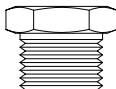
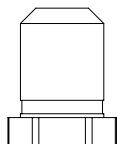

ISO VIEW

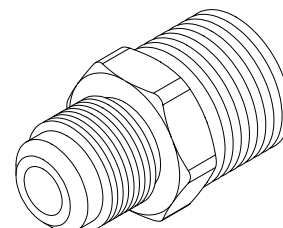
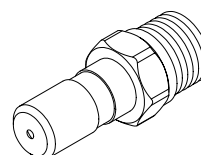
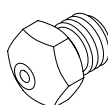
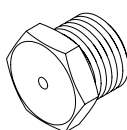
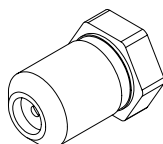

ALL ORIFICES & NIPPLES SHOWN ACTUAL SIZE

MODELS:	USE:	NG → LP		
AGBQ-42	KIT DESCRIPTION:	AGCK-42/56/NG-LP		
AGBQ-42SZ	KIT NUMBER:	190-0009		
AGBQ-56	ITEM	ORIFICE	PART #	QTY:
AGBQ-56SZ	"U" BURNER - LP	1.55 mm	220-0282	3
	SEAR-ZONE™ - LP	52 GA.	220-0290	1
	ROTISSERIE - LP	56 GA	220-0286	1
	SIDE BURNER - LP	1.15 mm	220-0292	2
	SMOKER - LP	65 GA	220-0288	1
	HOSE ADAPTER NIPPLE		220-0275	1

'U' BURNER  
ORIFICE

ZEAR-ZONE™  
BURNER  
ORIFICE

ROTISSERIE  
BURNER  
ORIFICE

SMOKER  
BURNER  
ORIFICE

SIDE  
BURNER  
ORIFICE

FRONT VIEW



SIDE VIEW

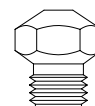
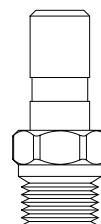
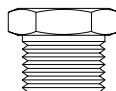
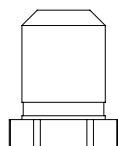

ISO VIEW

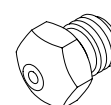
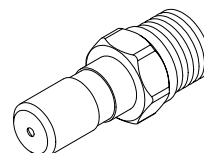
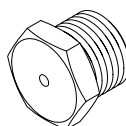
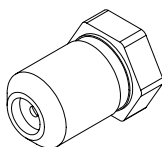

ALL ORIFICES & NIPPLES SHOWN ACTUAL SIZE

MODELS:	USE:	LP → NG		
AGBQ-42	KIT DESCRIPTION:	AGCK-42/56/LP-NG		
AGBQ-42SZ	KIT NUMBER:	190-00010		
AGBQ-56	ITEM	ORIFICE	PART #	QTY:
AGBQ-56SZ	"U" BURNER - NG	2.55 mm	220-0281	3
	SEAR-ZONE™ - NG	39 GA.	220-0891	1
	ROTISSERIE - NG	48 GA.	220-0285	1
	SIDE BURNER - NG	1.78 mm	220-0291	2
	SMOKER - NG	60 GA.	220-0287	1



'U' BURNER  
ORIFICE

ZEAR-ZONE™  
BURNER  
ORIFICE

ROTISSERIE  
BURNER  
ORIFICE

SMOKER  
BURNER  
ORIFICE

HOSE ADAPTER  
NIPPLE

FRONT VIEW

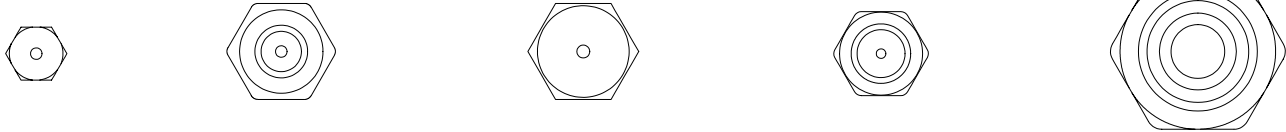

SIDE VIEW

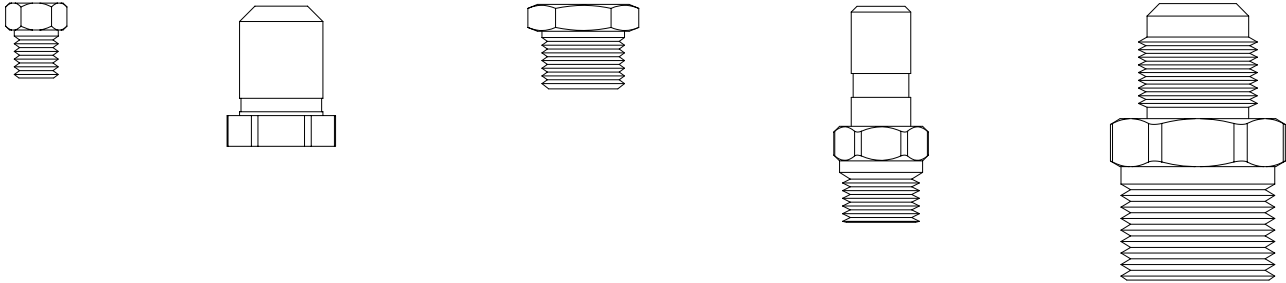

ISO VIEW

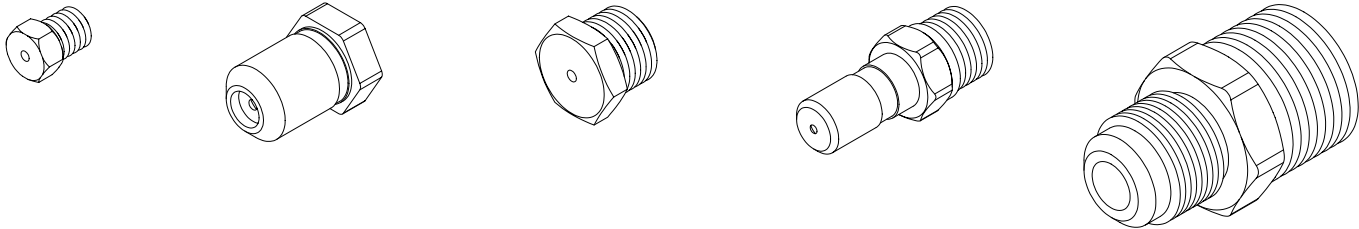

ALL ORIFICES & NIPPLES SHOWN ACTUAL SIZE

MODEL:	USE:	NG → LP		
AGBQ-56BFG	KIT DESCRIPTION:	AGCK-56BFG/NG-LP		
	KIT NUMBER:	190-0011		
	ITEM	ORIFICE	PART #	QTY:
	"U" BURNER - LP	1.55 mm	220-0282	3
	SEAR-ZONE™ - LP	52 GA.	220-0290	1
	ROTISSERIE - LP	57 GA.	220-0284	2
	SMOKER - LP	65 GA.	220-0288	1
	HOSE ADAPTER NIPPLE		220-0275	1

'U' BURNER  
ORIFICE

ZEAR-ZONE™  
BURNER  
ORIFICE

ROTISSERIE  
BURNER  
ORIFICE

SMOKER  
BURNER  
ORIFICE

FRONT VIEW



SIDE VIEW

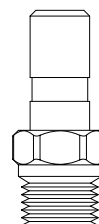
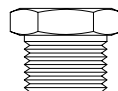
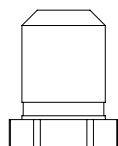

ISO VIEW

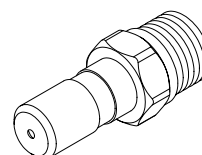
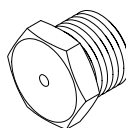
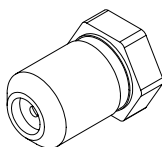

ALL ORIFICES & NIPPLES SHOWN ACTUAL SIZE

MODEL:	USE:	LP → NG		
AGBQ-56BFG	KIT DESCRIPTION:	AGCK-56BFG/LP-NG		
	KIT NUMBER:	190-0012		
	ITEM	ORIFICE	PART #	QTY:
	"U" BURNER - NG	2.55 mm	220-0281	3
	SEAR-ZONE™ - NG	39 GA.	220-0891	1
	ROTISSERIE - NG	50 GA	220-0283	2
	SMOKER - NG	60 GA	220-0287	1

SIDE  
BURNER  
ORIFICE

HOSE ADAPTER  
NIPPLE

FRONT VIEW

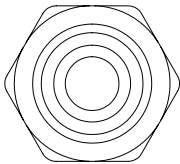

SIDE VIEW

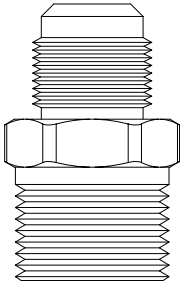

ISO VIEW

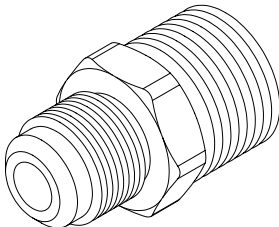
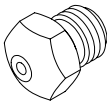

ALL ORIFICES & NIPPLES SHOWN ACTUAL SIZE

MODEL:	USE:	NG ↔ LP		
AGSB-2	KIT DESCRIPTION:	AGCK-SB-2/NG/LP		
	KIT NUMBER:	190-0013		
	ITEM	ORIFICE	PART #	QTY:
	SIDE BURNER - NG	1.78 mm	220-0291	2
	SIDE BURNER - LP	1.15 mm	220-0292	2
	HOSE ADAPTER NIPPLE		220-0275	1

SEAR-ZONE™  
ORIFICE

HOSE ADAPTER  
NIPPLE

FRONT VIEW

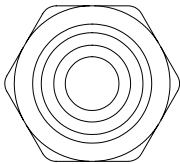
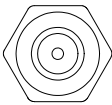

SIDE VIEW

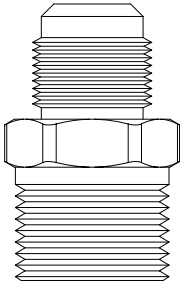
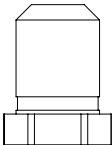

ISO VIEW

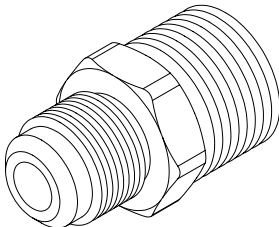
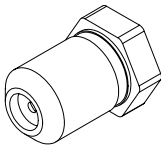

ALL ORIFICES & NIPPLES SHOWN ACTUAL SIZE

MODEL:	USE:	NG ↔ LP		
AGSB-SZ	KIT DESCRIPTION:	AGCK-SB-SZ/NG/LP		
	KIT NUMBER:	190-0014		
	ITEM	ORIFICE	PART #	QTY:
	SEAR-ZONE™ - NG	39 GA.	220-0891	1
	SEAR-ZONE™ - LP	52 GA.	220-0290	1
	HOSE ADAPTER NIPPLE		220-0275	1



BILL OF MATERIAL - PROPANE KIT FOR BARBEQUES WITH OR W/O SIDE BURNERS			
NO.	PART NUMBER	DESCRIPTION	QTY.
1	220-0275	NIPPLE - 1/2" MPT X 3/8" MPT	1
2	220-0300	REGULATOR / HOSE KIT FOR LP GAS	1
3	NONE	PROPANE TANK - GENERIC - CUSTOMER SUPPLIED	1

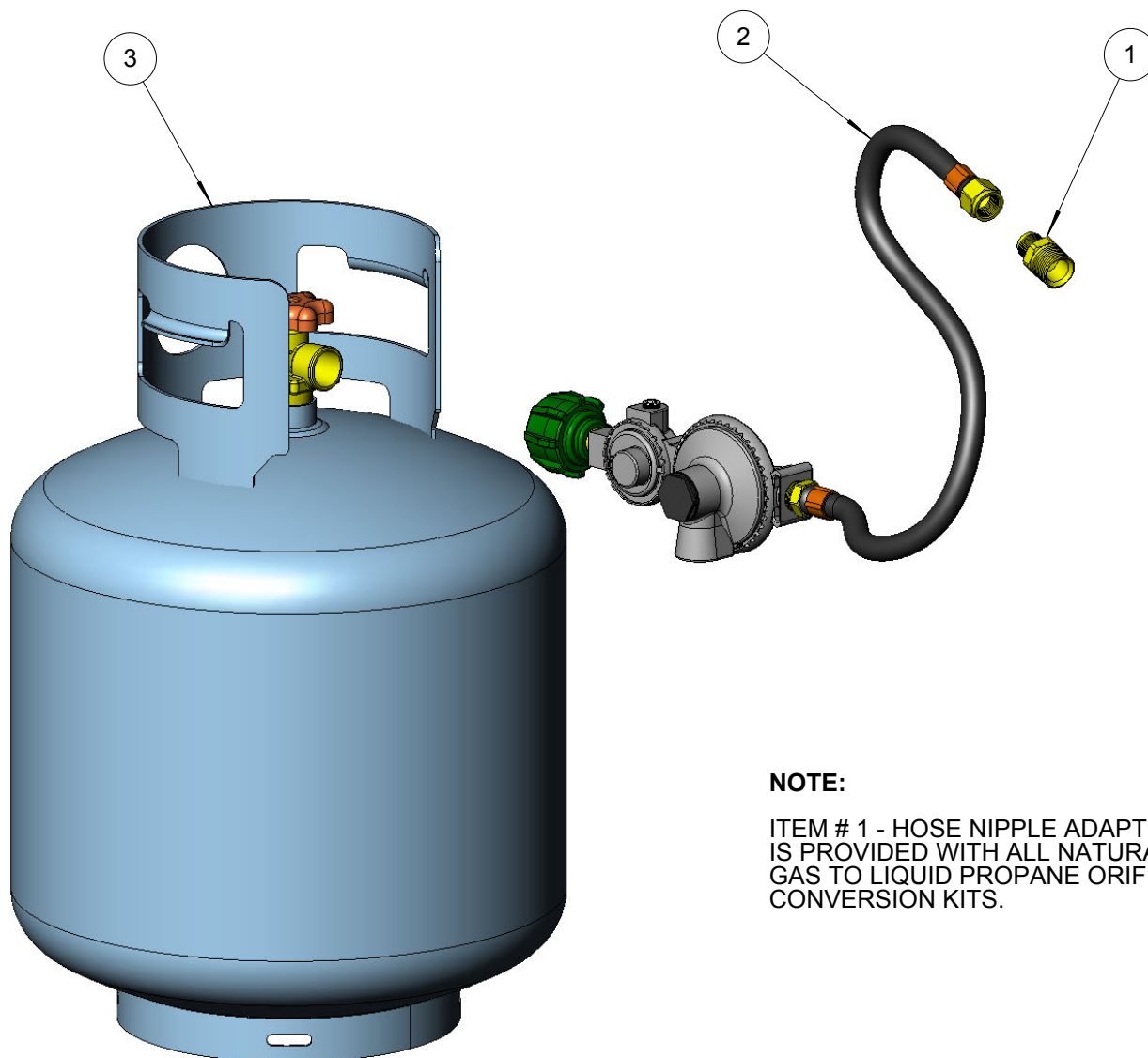

**NOTE:**

ITEM # 1 - HOSE NIPPLE ADAPTER IS PROVIDED WITH ALL NATURAL GAS TO LIQUID PROPANE ORIFICE CONVERSION KITS.

BILL OF MATERIAL - PROPANE KIT FOR SIDE BURNERS ONLY			
NO.	PART NUMBER	DESCRIPTION	QTY.
1	220-0275	NIPPLE - 1/2" MPT X 3/8" MPT	1
2	220-0301	LP GAS - REGULATOR / HOSE KIT	1
3	NONE	PROPANE TANK - GENERIC - CUSTOMER SUPPLIED	1

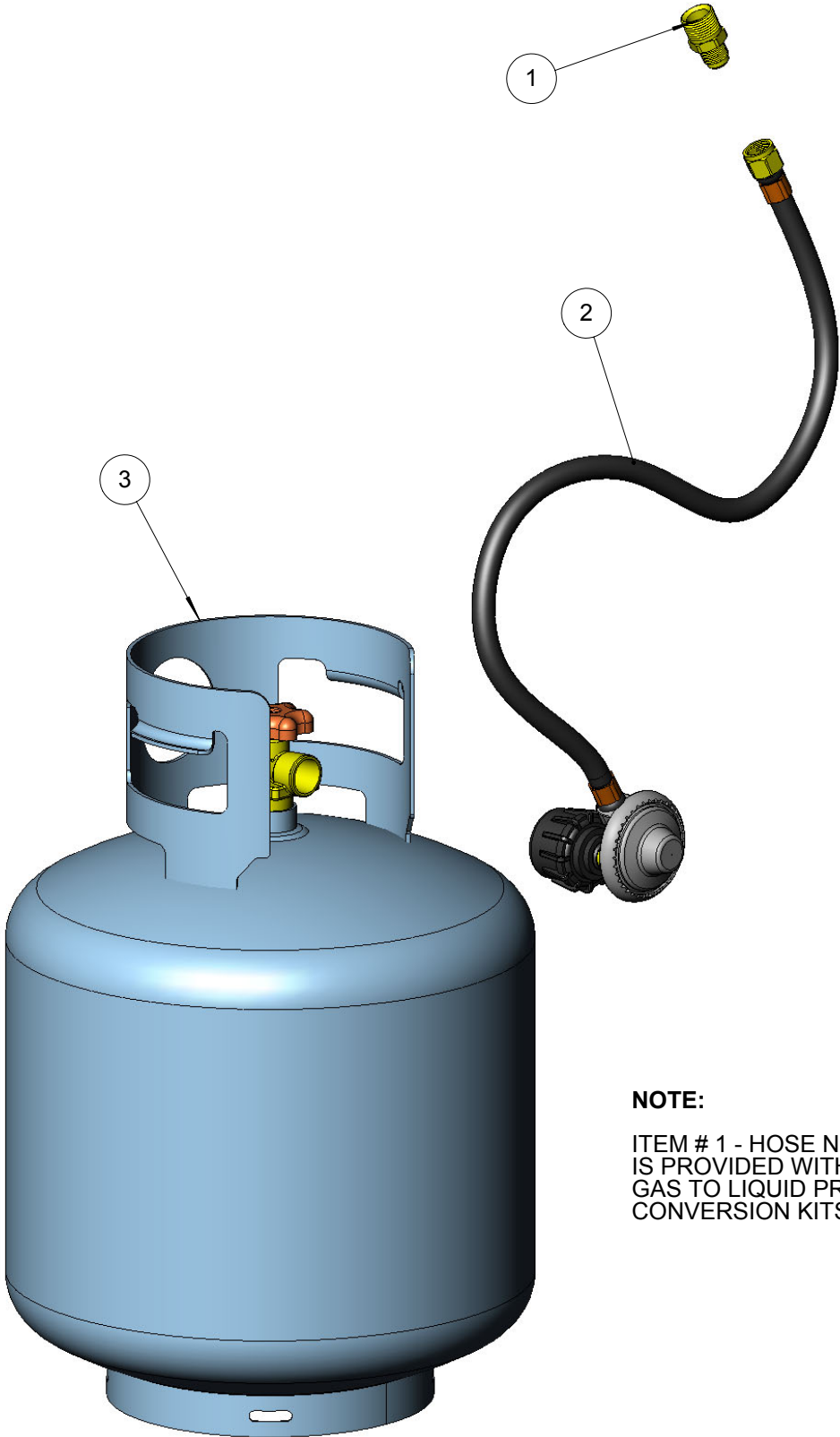

**NOTE:**  
ITEM # 1 - HOSE NIPPLE ADAPTER  
IS PROVIDED WITH ALL NATURAL  
GAS TO LIQUID PROPANE ORIFICE  
CONVERSION KITS.