

Installation Instructions

READ CAREFULLY. KEEP THESE INSTRUCTIONS.

IMPORTANT SAFETY INSTRUCTIONS

WARNING

Before attempting the installation of this kit, be sure to unplug the oven from wall receptacle.

Your oven is designed to be installed under properly constructed, good condition wood or metal cabinets that are sturdy enough to support the items you have in the cabinet, plus an additional 41 kg (90 pounds) from the cabinet bottom.

Empty the contents of your selected cabinet and the delicate items in adjoining cabinets.

(**NOTE:** When drilling the holes, the vibration could cause damage to fragile items such as crystal or china.)

Now, you must inspect your cabinets. If any of the following conditions exist, then it is your personal responsibility to test the cabinets or contact a qualified cabinet maker.

1. Separation of joints between the bottom shelf and the cabinet structure.
2. Splitting, cracking or other signs of deterioration.
3. Check the number of screws used to install your cabinets. If your cabinet is attached to the wall with only two screws at the top, then you must add two screws at the bottom to firmly secure your cabinet to the wall. When adding the screws, be sure that they enter wall studs with at least 1.3 cm (1/2") penetration.
4. On wood cabinets, the bottom shelf must be at least .48 cm (3/16") thick masonite or plywood.
5. Be sure that the underside of the cabinet is at least 50 cm (20") wide and 35.0cm (13 25/32") deep. If the cabinet is less than 35.0cm(13 25/32") deep, follow the cabinet mounting instructions carefully if you desire to mount your oven under cabinet.

To test your cabinets, place a 40 KG(90LB.) load, plus the equivalent weight of items normally stored on the shelf*, for a minimum of five minutes.

*You may consider using jugs of water, bricks or books to obtain the test load.

PLEASE NOTE: If your cabinet is properly constructed and suitably installed it will withstand this test without any damage; however, there is the possibility of damage should the cabinet be incapable of supporting the additional load.

The Maytag Company is NOT RESPONSIBLE FOR ANY DAMAGE OR OTHER CONSEQUENCES resulting from the performance of this test.

If you are unsure that your cabinets are suitable for this type of installation you may use the oven on your countertop.

TOOLS AND PARTS

The following tools are needed for installation of your unit:

- Drill and .64cm (1/4") drill bit
- Phillips and flat blade screwdrivers
- Nail or center punch
- Pencil and ruler
- Scissors
- Hammer

INSTALLATION PARTS LIST

The following is a list of the parts that you may need for installation of your oven.

Remove all parts from the cooking cavity and compare them with the parts list and illustration to be sure that none are missing. Use this time to become familiar with each piece.

PARTS LIST

1. 3 Sets of bolts
2. 4-washers-A
3. 4-washers-B
4. 1-Template

Upon completing your check of the parts list, read all instructions completely before starting the installation. This will help you to become familiar with the process and make installation easier.

(NOTE: It is suggested that you gather all needed tools and installation parts in one location.)

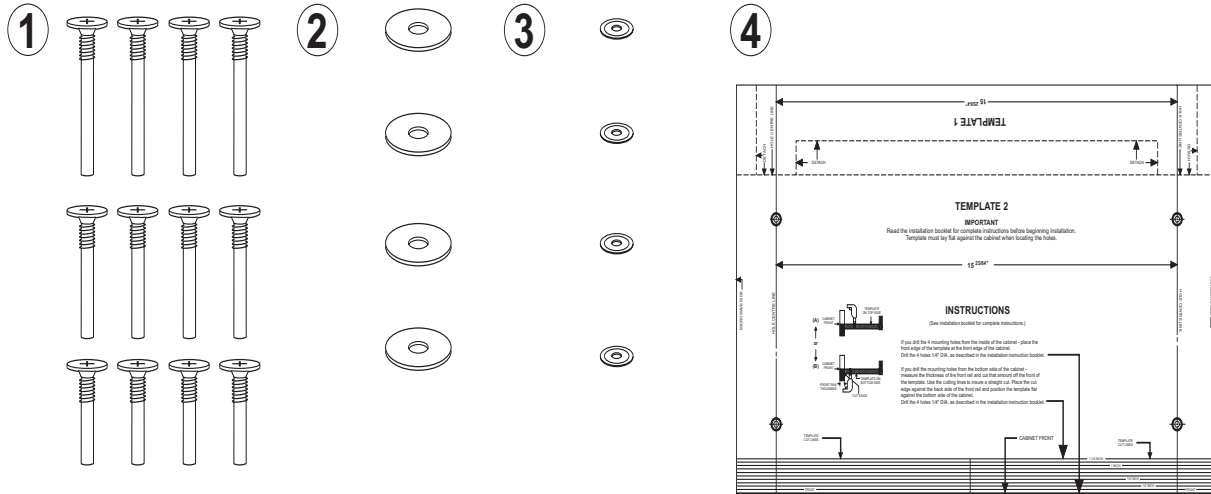

PREPARATIONS

Open the template and detach both segments along the dashed line with scissors. You should have two separate pieces.

- Template 1
- Template 2

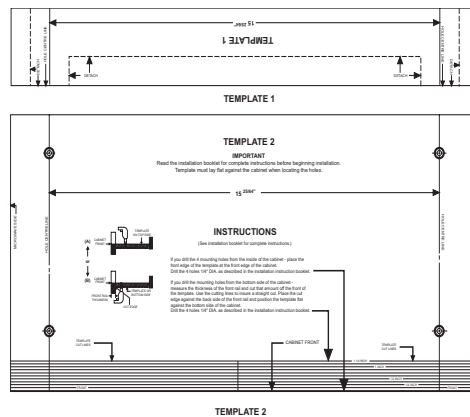

TWO MOUNTING METHODS

There are two mounting methods described in this booklet that can be used.

1. Countertop Method

You can use this method if you decide not to cabinet mount your oven.

To use your oven as a countertop model, simply position the oven on the desired counter and plug the electrical cord into a three prong (grounded) wall receptacle.

2. Cabinet Mounting Method

This method is for mounting your oven under a cabinet and uses the template, 4-washers and one set of screws. Before using this method, the 4 plastic plug buttons on the top of the oven must be removed. This can be done by placing a thin flat blade screwdriver between the plug button and the oven top and raising gently, taking care to avoid scratching the oven top.

OVEN MAY BE MOUNTED TO CABINETS WITH OR WITHOUT A FRONT RAIL.

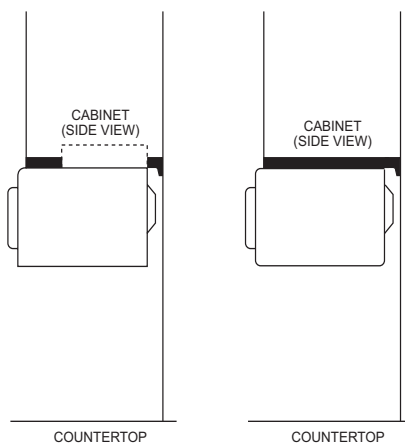

DRILLING APPROACH

You have two options for drilling the mounting holes for your oven.

First, you can drill from inside of the cabinet if you have adequate space and your shelves are removable.

Second, you can drill from the bottom.

If possible, it is generally easier to work from the inside of the cabinet. Use the instructions applicable to the approach you select. Make sure you use the template properly depending whether you drill holes from the inside or bottom side of the cabinet.

INSTRUCTIONS FOR DRILLING FROM INSIDE

If you cannot drill from the inside, go to Instructions for Drilling From Bottom.

1. If your cabinet is less than 35cm(13 25/32") deep, cut off the front edge of Template 2 the amount by which the cabinet depth is less than 35cm(13 25/32"), using the template cut lines as a guide. Place Template 2 inside cabinet. Cut around door jam and if necessary, corners to make template fit. (The front edge of template must be even with the front edge of the cabinet.) Place Template 2 in cabinet.

NOTE: For cabinets with a recessed shelf you must measure the thickness of the front rail and cut that amount off the front edge of Template 2 using the template cut lines as a guide. This will allow Template 2 to lay flat in the shelf.

2. If you have a partition in the cabinet, you must do the following:
 - Cut Template 2 into two pieces to fit each side of the partition.
 - Position one piece of Template 2 inside the cabinet, making sure that the front edge is even with the front edge of cabinet.
 - Position Template 1 on front of the cabinet so that the arrow is aligned with the hole center line on Template 2.

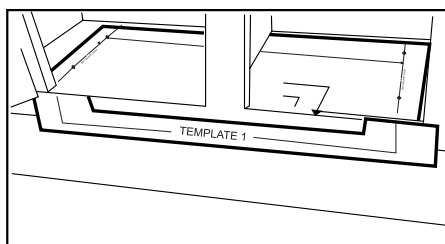

- Position remaining piece of Template 2 inside cabinet and align the hole center lines with arrows on Template 1 so that distance from right hole center to left hole center measures the distance indicated on the template. (You will have to cut excess paper from the middle of Template 2 to make it lay flat.)
- Position the remaining piece of Template 2 inside cabinet.

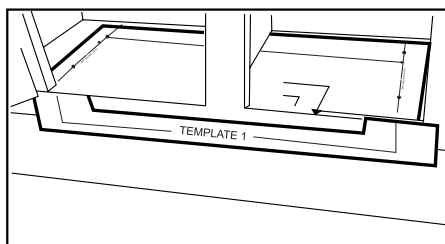

- Check again to make sure that the hole center lines on Template 2 are straight and that the distance from the right to left drilling holes measures the distance indicated on the template.
- Go to Drilling the Mounting Holes.

INSTRUCTIONS FOR DRILLING FROM BOTTOM

1. If you have a front rail, measure the thickness and cut that amount off the front edge of Template 2 using the template cut lines as a guide.

2. Place cut edge of Template 2 against the back side of the front rail and position it flat against the bottom side of the cabinet.

NOTE: On some cabinets a small bracket or glue block is used between the overhang and the underside of the cabinet bottom. If this is true of your cabinets, cut Template 2 to fit around the bracket or glue block so that it will be flat on the cabinet bottom when attached.

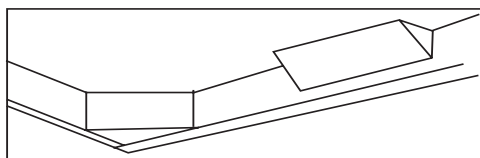

3. If you have a partition you must do the following:
 - Cut Template 2 into two pieces to fit on each side of the partition.
 - Position one piece of Template 2 under the cabinet. (The cut line along the front edge of Template 2 must be placed against the back of the front rail.)
 - Attach Template 1 to rear of cabinet and align arrows with hole center line on Template 2.

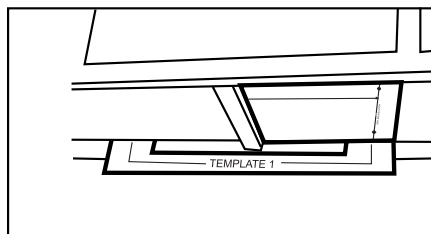

- Position remaining piece of Template 2 under the cabinet and align the hole center lines with arrows on Template 1 so that the distance from right hole center to left hole center measures the distance indicated on the templates. (You may have to cut excess paper from middle of the template to make it lay flat.)
- Position Template 2. (The cut line along the front edge of template must be placed against the back of the front rail.)

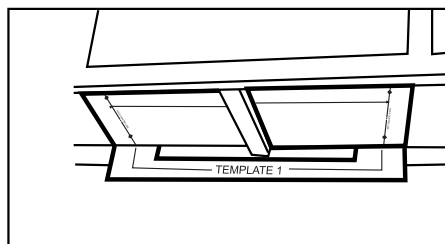

DRILLING THE MOUNTING HOLES

While drilling, it is recommended that safety glasses be worn to prevent possible eye damage from cabinet shavings.

1. Use a center punch or nail to make an indentation for centering the drill bit.
2. Drill through Template 2 at the four black drilling holes indicated on the template. (Drill should be held straight to ensure proper alignment of bolts.)
3. After drilling the four holes, remove the template and clean the drill holes.

SELECTING YOUR MOUNTING BOLTS

1. You should have three sets of bolts of varying lengths in the installation package. select one bolt of each size.
2. Hold each bolt against the cabinet front rail. pick the bolt that extends beyond top of the bottom shelf by 2.54 cm (3/16") to 2.54 cm (1"). this will be the bolt length needed for your cabinets.

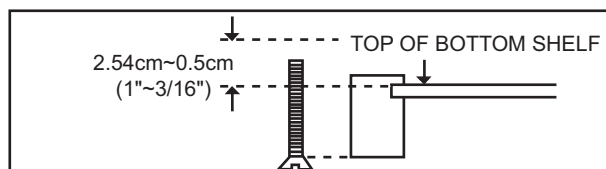

NOTE: It is important to pick the correct bolt length needed for your cabinets. If the bolt is too short it won't reach the oven. If the bolt is too long, it will not permit oven to be drawn up to the cabinet snugly.

3. From inside the cabinet, insert the bolts through the mounting straps and then into the drilled holes.

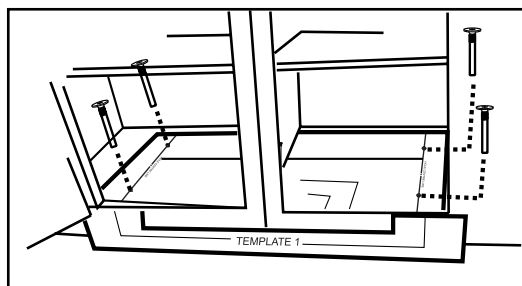

MOUNTING THE OVEN

To aid installation, we suggest that you use some solid support such as books to hold the oven while you are securing it with the mounting bolts.

Make sure that whatever you use is stacked or cut as close as possible to the height needed for the oven to reach the cabinet bottom.

1. Place the oven on the support and move into position. Lift oven, aligning the mounting holes on the oven with the bolts. Do not grip the door handle to help lift the oven.
2. Insert bolts into mounting holes on the oven. Tighten the bolts to secure oven to the bottom of the cabinet. (Alternate between bolts so that oven is drawn up evenly.)
3. Once oven is securely in place, plug power cord into three prong (grounded) wall receptacle.