

### FEATURED MODEL

**441588** XL Single Bowl Only, 9" bowl depth

### FEATURES

- Required outside cabinet: 33"
- Maximum size and utility
- 18 gauge, 304 series stainless steel
- Premium 18/10 chrome/nickel content
- Satin Polished Finish
- Rear drain placement
- Sound deadening pads

### ACCESSORY KITS

- 441641** Kit #1 Organized  
• Includes: Bowl, Stainless Steel Sink Grid & Sink Caddy
- 441643** Kit #2 Safety  
• Includes: Bowl, Stainless Steel Sink Grid & Workstation
- 441642** Kit #3 Prep  
• Includes: Bowl, Cutting Board & Sink Caddy
- 441644** Kit #4 Culinary  
• Includes: Bowl, Cutting Board & Workstation
- 441644** Kit #5 Multi-Level  
• Includes: Includes: Bowl, Sink Grid & Multi-Level Grid

### ONE™ À LA CARTE ACCESSORIES

- Stainless Steel Sink Grid: 230690  
Stainless Steel Multi-Level Grid: 231162  
Magnetic Sink Caddy: 230694  
Ash Ultra Thin Cutting Board: 230427  
Workstation: 441662  
CAPFLOW™ Drain Cover: 517666

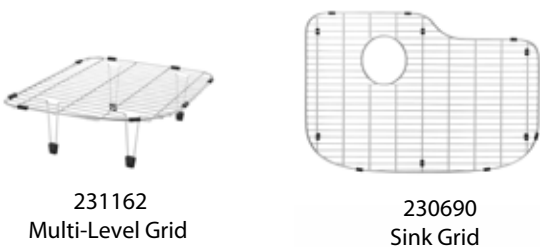

### NOMINAL DIMENSIONS

Model 441588 shown

OVERALL	CUT OUT SIZE	BOWL DEPTH	DRAIN
30" x 20"	Template provided with approximate 1/8" reveal	9"	3-1/2"

DXF cutout templates available on our website.

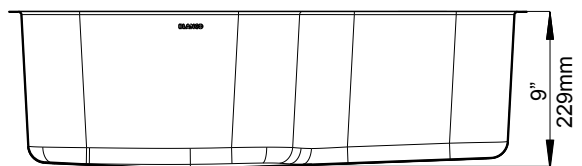
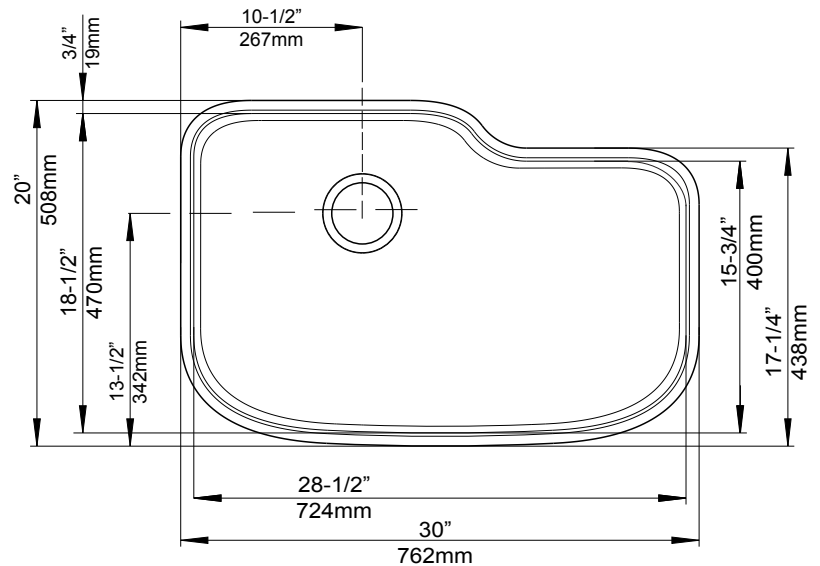

### CODE/STANDARDS COMPLIANCE

ASME 112.19.3-00  
IAPMO/UPC listed

### BLANCO AMERICA

800.451.5782  
www.blancoamerica.com

© 2013 BLANCO AMERICA

12/13

SPEC-003