

## Quick Reference Guide Upright Vacuum Cleaner Guide de référence Aspirateur vertical

**To prevent accidents and machine damage, read the attached operating instructions before installation and use.**

**Afin de prévenir les accidents et d'éviter d'endommager l'appareil, veuillez lire attentivement les instructions d'utilisation ci-jointes avant de l'installer ou de l'utiliser.**

en, fr - US, CA

The illustrations referred to can be found on the following pages.

## **Using the vacuum cleaner**

### **Assembling the vacuum cleaner (see fig. 1)**

If your vacuum cleaner is equipped with an exhaust filter Active AirClean or HEPA AirClean, you will need to activate the exhaust filter change indicator (see Operating Instructions, page 14).

### **Releasing / Rewinding the power cord (see fig. 2)**

### **Align cord with notch (see fig. 3)**

### **Releasing the body of the vacuum cleaner (see fig. 4)**

### **Turning the vacuum cleaner On/Off (see fig. 5)**

### **Selecting the flooring type (see fig. 6 + 7)**

### **Securing the vacuum hose and wand (see fig. 8)**

### **Telescopic wand (see fig. 9 + 10)**

### **Turning the Powerbrush On/Off (see fig. 11)**

### **Included accessories (see fig. 12)**

### **Lifting the vacuum head (see fig. 13)**

## **Maintenance**

### **Airflow indicator (see fig. 14)**

### **Opening the dust compartment (see fig. 15)**

### **Removing the FilterBag (see fig. 16)**

### **Inserting the FilterBag (see fig. 17)**

Please see the Operating Instructions for more information on how to change the FilterBag and exhaust filter.

Vous trouverez les croquis à la fin de ce guide de référence.

## **Utilisation de l'aspirateur**

**Assemblage de l'aspirateur (voir fig. 1)**

**Dérouler/Enrouler le cordon d'alimentation (voir fig. 2)**

**Aligner le cordon avec le cran (voir fig. 3)**

**Retirer le boîtier de l'aspirateur (voir fig. 4)**

**Mettre l'aspirateur en marche et l'éteindre (voir fig. 5)**

**Sélectionner le type de sol (voir fig. 6 + 7)**

**Ajuster le tuyau et le tube de l'aspirateur (voir fig. 8)**

**Tube télescopique (voir fig. 9 + 10)**

**Mettre l'électrobrosse en marche et l'éteindre (voir fig. 11)**

**Accessoires fournis (voir fig. 12)**

**Soulever la tête de l'aspirateur (voir fig. 13)**

## **Entretien**

**Indicateur de circulation d'air (voir fig. 14)**

**Ouvrir le réservoir à poussière (voir fig. 15)**

**Enlever le sac à poussière (voir fig. 16)**

**Insertion du sac à poussière (voir fig. 17)**

Lire attentivement les instructions d'utilisation pour savoir comment changer les filtres d'évacuation.

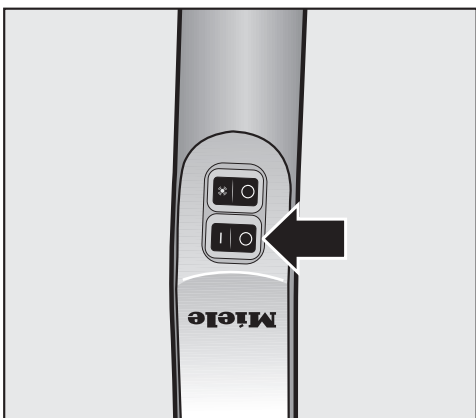
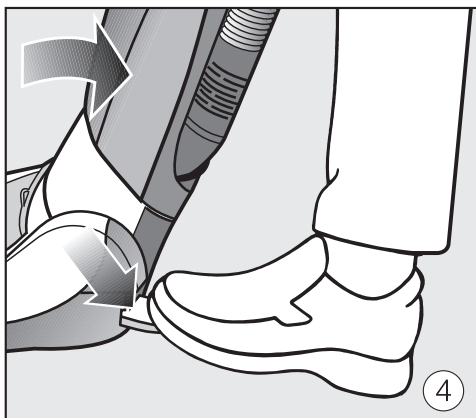
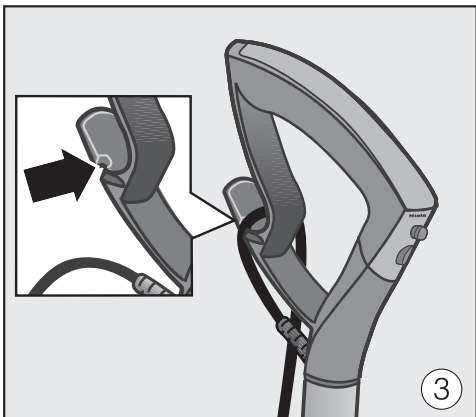
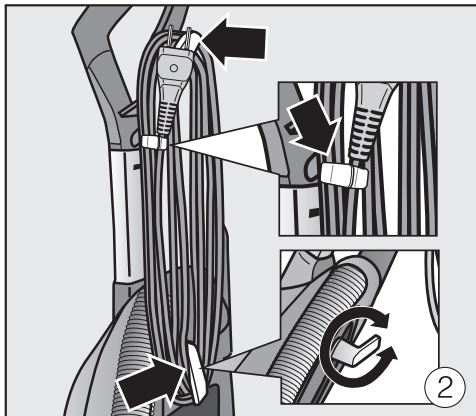
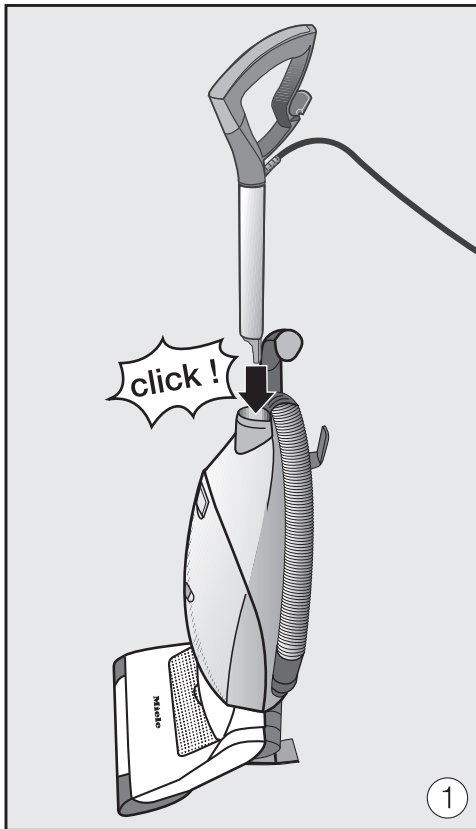

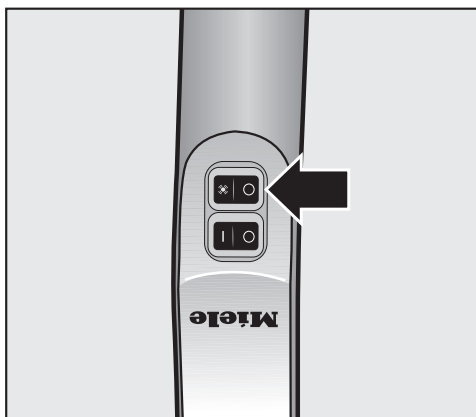
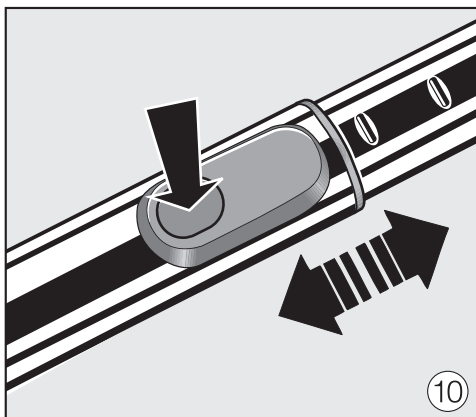
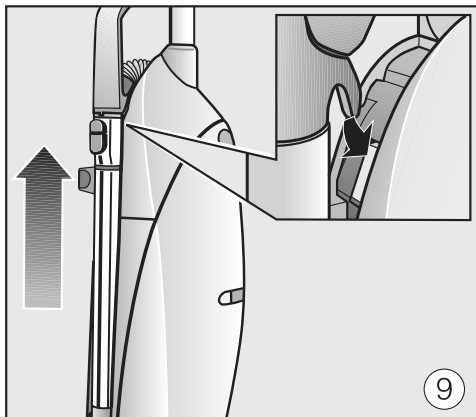
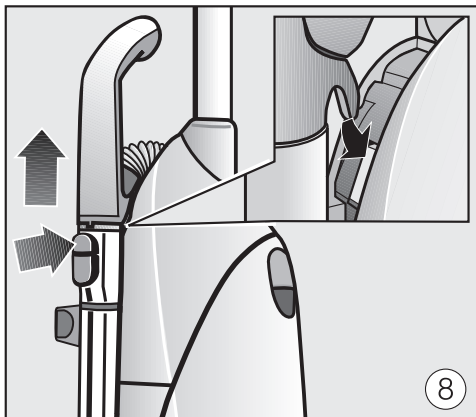
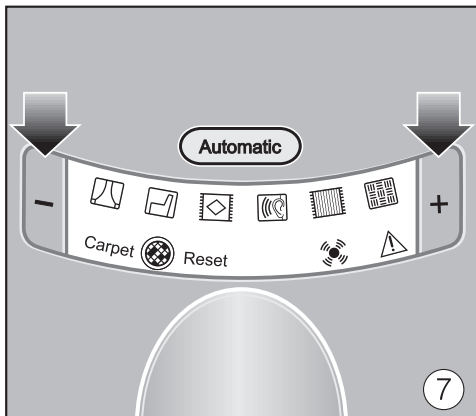
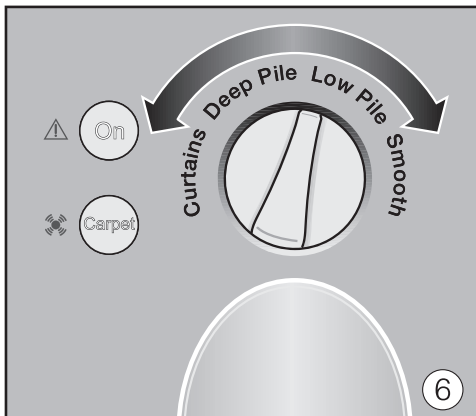

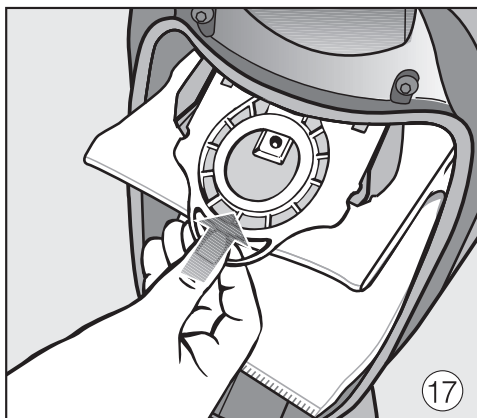
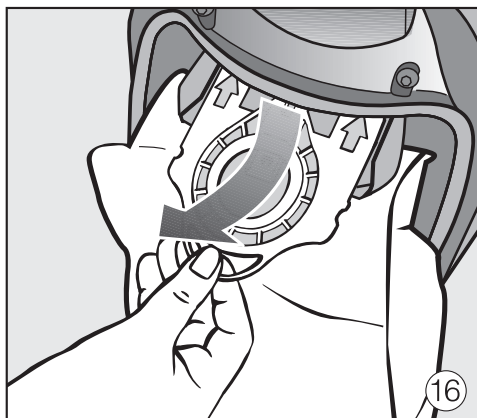
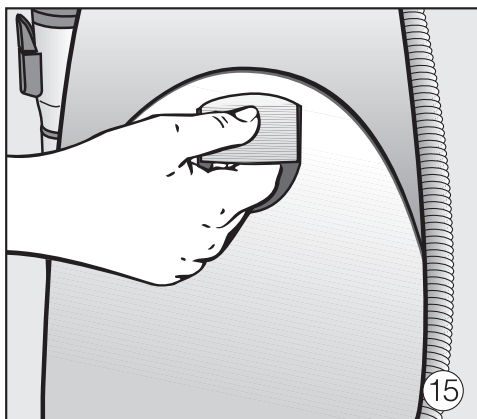
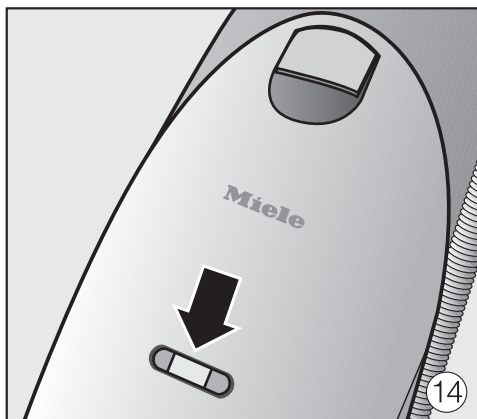
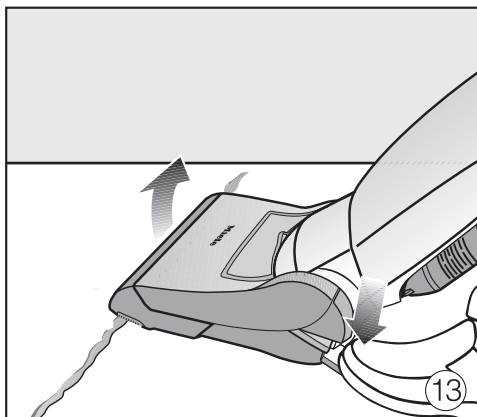



**Canada**  
**Importateur**  
**Miele Limitée**

**Siège social au Canada et Centre Miele**

161 Four Valley Drive  
Vaughan, ON L4K 4V8  
[www.miele.ca](http://www.miele.ca)

**Service à la clientèle**

Téléphone : 800-565-6435  
[customercare@miele.ca](mailto:customercare@miele.ca)

**Allemagne**

**Fabricant**

Miele & Cie. KG  
Carl-Miele-Straße 29  
33332 Gütersloh

Please have the model and serial number  
of your appliance available when  
contacting Technical Service.

---

The Miele logo consists of the word "Miele" in a bold, white, sans-serif font, set against a solid black rectangular background.

## **U.S.A.**

**Miele, Inc.**

### **National Headquarters**

9 Independence Way  
Princeton, NJ 08540  
Phone: 800-843-7231  
Fax: 609-419-4298  
[www.mieleusa.com](http://www.mieleusa.com)

### **Technical Service & Support**

Phone: 800-999-1360  
Fax: 888-586-8056  
[TechnicalService@mieleusa.com](mailto:TechnicalService@mieleusa.com)

### **International Headquarters**

Miele & Cie. KG  
Carl-Miele-Straße 29  
33332 Gütersloh  
Germany

## **Canada**

**Importer**  
**Miele Limited**

### **Headquarters and Miele Centre**

161 Four Valley Drive  
Vaughan, ON L4K 4V8  
[www.miele.ca](http://www.miele.ca)

### **Customer Care Centre**

Phone: 800-565-6435  
905-532-2272  
[customercare@miele.ca](mailto:customercare@miele.ca)