

3000 Series: Overlay Panel, Frame and Toe-Kick Specifications

WINE CAPTAIN® MODELS



- U-3018WCOL-00
- U-3018WCOL-01
- U-3024WCOL-00
- U-3024WCOL-01
- U-3036WCWCOL-00

BEVERAGE CENTERS



- U-3024BEVOL-00
- U-3024BEVOL-01
- U-3036BYWCOL-00

GLASS DOOR REFRIGERATORS



- U-3018RGLOL-00
- U-3018RGLOL-01
- U-3024RGLOL-00
- U-3024RGLOL-01
- U-3036RRGLOL-00

REFRIGERATORS



- U-3018RFOL-00
- U-3018RFOL-01
- U-3024RFOL-00
- U-3024RFOL-01
- U-3036RROL-00

AIMadison
Your Appliance Authority™
800-570-3355

THE MODULAR 3000 SERIES ARE INTENDED FOR BUILT IN INSTALLATIONS ONLY

I 3000 Series Overlays

Overlay / Frame Overlay Panel

IMPORTANT

Due to differences in surrounding cabinetry the panel may not perfectly align with door. The procedure below is designed to provide a finished overlay panel that seamlessly integrates with surrounding cabinetry.

Panel Preparation

A full overlay door panel completely covers the door frame and provides a built-in appearance.

IMPORTANT

- The door panel must not weigh more than 20lbs.
 - It is important to ensure that all drilled holes are drilled to the correct depth in order to avoid splits in the wood when hardware is installed.
 - Appliance will need up to 34 1/2" to the under side of the counter to leave room for leveling adjustments.
1. Cut the panels to the dimensions listed in the appropriate diagram below.
 2. Optional: Stain or Finish panel to desired stain or color. Be sure to closely follow the instructions provided by the manufacturer.

IMPORTANT

If finishing frame overlay, both sides of overlay must be finished in order to prevent warping.

3. Optional: Install handles and hardware.

Overlay & Frame Overlay Panel Dimensions

3018 and 3036 Series

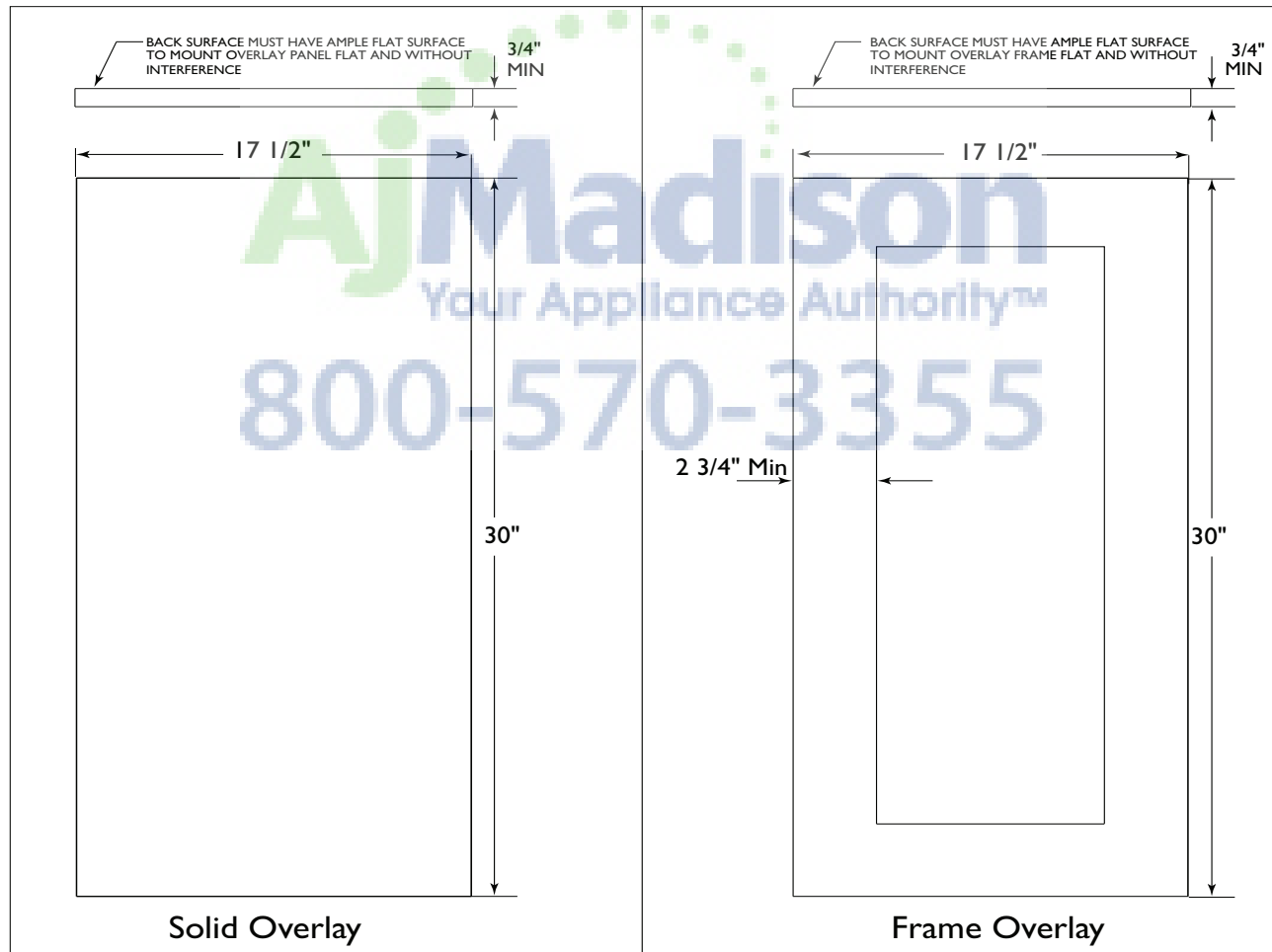

3024 Series

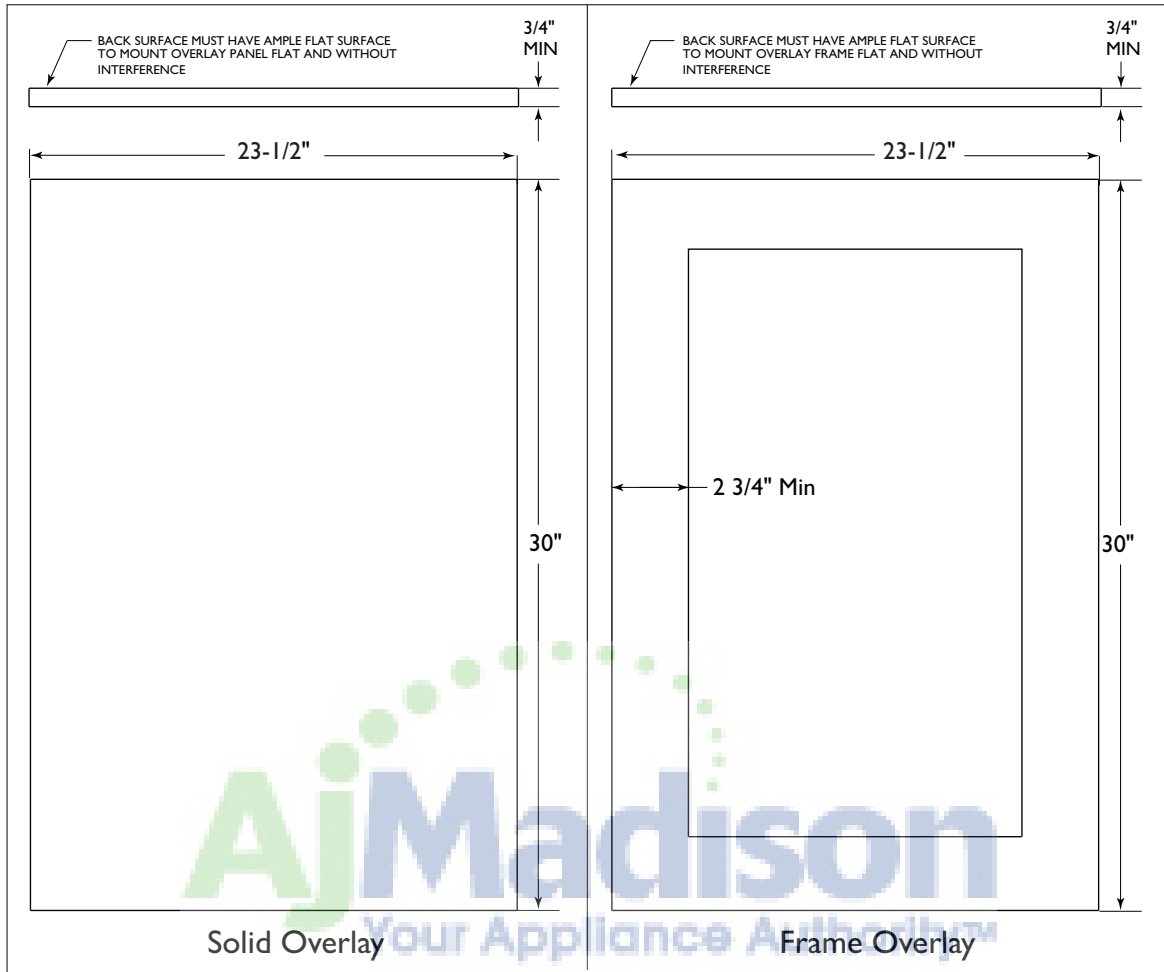

Panel Installation

1. Fully open door,
2. Starting at corner, pull gasket away from door.
3. Continue to pull gasket free from gasket channel.
4. Upon removal, lay gasket down on a flat surface.

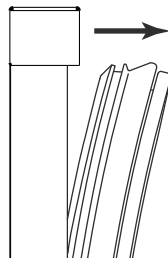

IMPORTANT

If working with the door that houses the display, make certain the display cable remains securely seated in the inner door channel, see below.

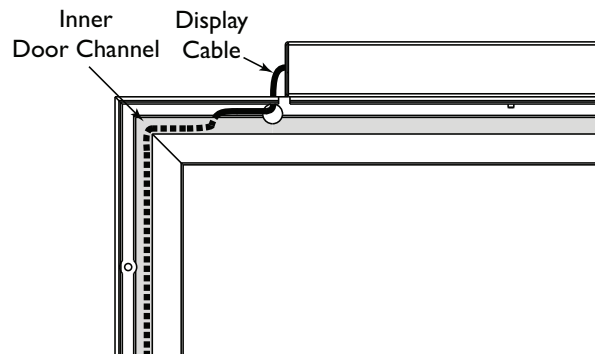

- The frame should be aligned with the outside edge (opposite the hinge) and high enough to align with the highest point in the door.

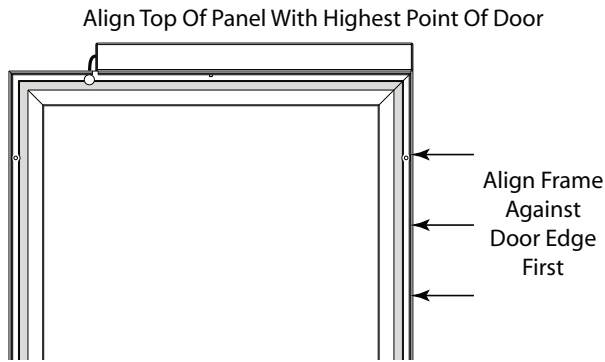

IMPORTANT

Due to differences in floor construction or surrounding cabinetry, the frame may not sit flush with the top of the door.

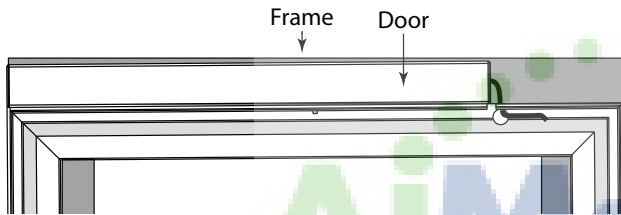

- Secure overlay to door using clamps. A robust tape may also be used. U-Line recommends the use of bar clamps to securely clamp the overlay to the door. If using tape, be certain the tape will not damage overlay finish upon removal.
- Using a 7/64" drill bit, drill 6 pilot holes into the wood panel 1/2" deep using the holes in the door frame as a guide.
- Locate 6 of the #6x 1 1/2" screws provided with your unit
- Using a phillips screwdriver, place one screw into each of the 6 pilot holes and screw down. Do not overtighten screws.

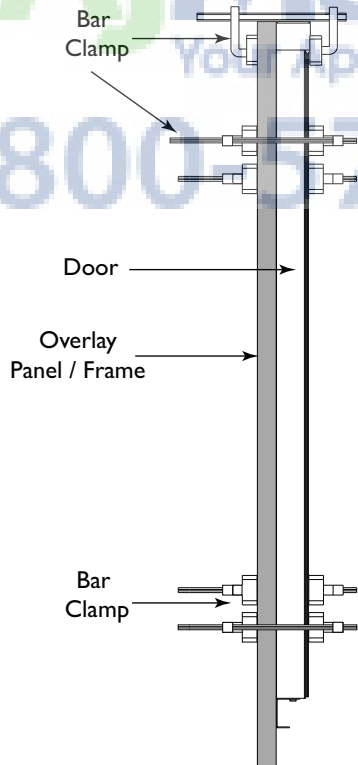

- Be sure the screws force their way past the opening on the gasket channel and sit flush against the bottom of the channel.

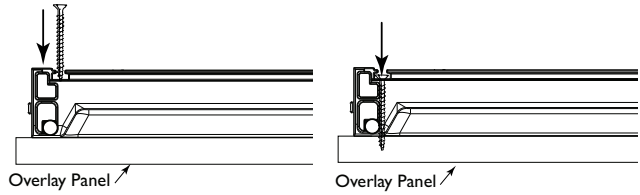

- Remove clamps from door.

IMPORTANT

If frame requires additional adjustment after removing clamps, slightly loosen each screw and adjust frame as necessary. Tighten screws upon completion.

- Starting at the corners, re-install the gasket into the gasket channel in the frame. Make sure the gasket is fully seated. This may take some force.
- If installing an additional overlay on a 36" unit, repeat steps 1 through 12 on the opposite door.

Overlay Grille

The 3000 series grille is fully adjustable and can be set to match your surrounding cabinetry dimensions. In addition to its adjustability, an overlay may also be installed to truly provide a seamless appearance.

Preparing The Overlay

- Use the dimensions provided in the diagram on page 10 to cut and shape your grille overlay. Recommended overlay thickness is between 1/4" and 3/8". Dimension A will vary based on your toe kick height.
- Finish or stain your grille overlay to match your surrounding cabinetry. Both sides require finishing to prevent warping. Be certain to carefully follow the finish manufacturer's recommendations for application and cure times.
- Apply double sided tape to the backside of the overlay grill. Use the diagram below for reference. U-Line recommends 3M™ VHB™ tape, a high strength bonding tape.

Apply Tape To Shaded Area



- Remove backing paper from double sided tape.
- Carefully align grille over overlay and press into position.

Overlay Grille Dimensions

Recommended Overlay Grille Thickness is 1/4" And May Not Exceed 3/8"

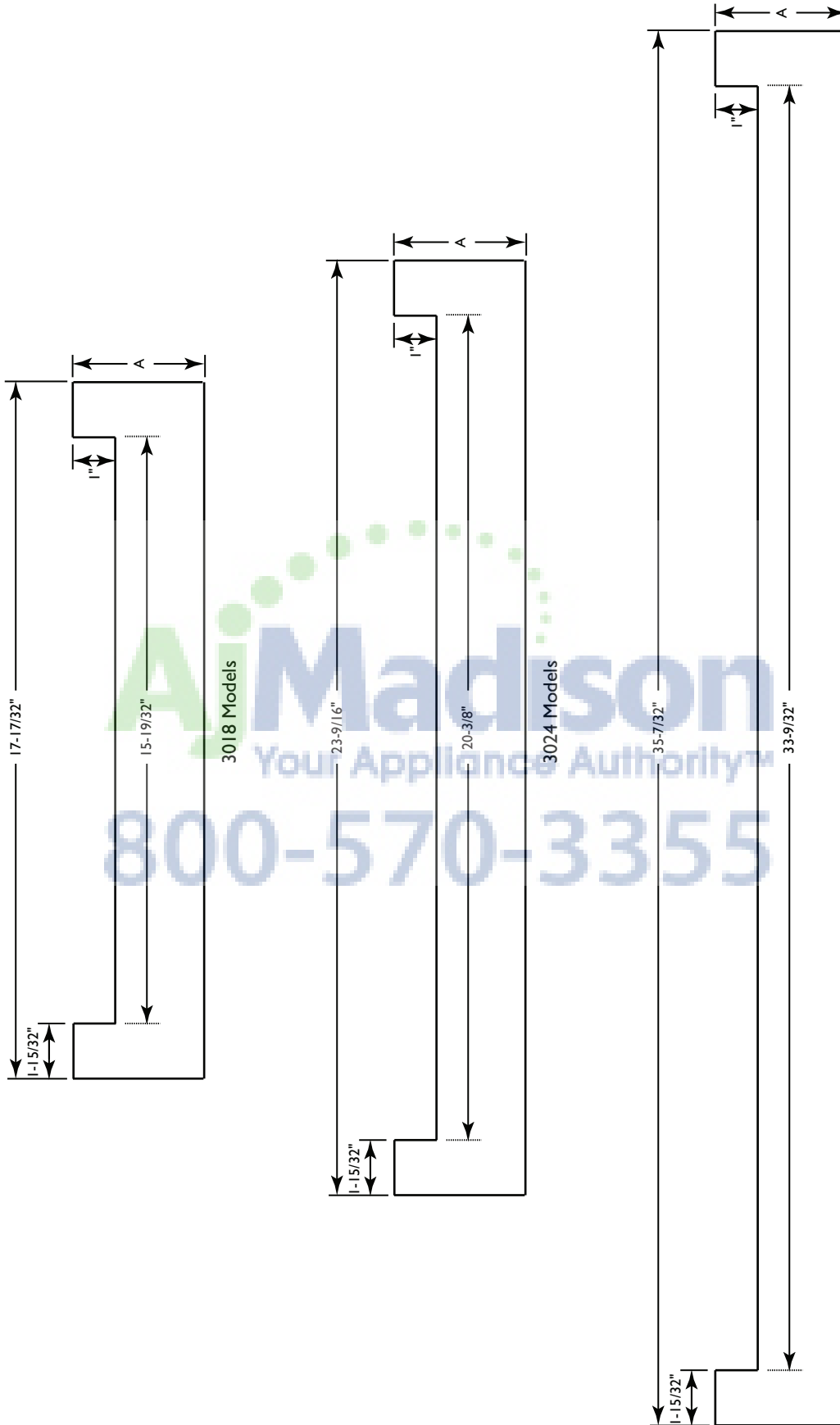

Dimension A may vary from a minimum of 3-1/4" to a maximum 4-1/4" depending on toe kick height. Measure toe kick height and cut overlay to same dimension.

SERVICE INFORMATION

If you have a problem with this appliance, your use and care guide has troubleshooting information to help you quickly identify common problems and provide information on possible cause and remedy. Answers to Customers Frequently Asked Questions are available at www.u-line.com/customer/faq.cfm. You may contact U-Line directly:

GENERAL INQUIRIES:

U-Line Corporation
P.O. Box 245040
Milwaukee, Wisconsin 53224-9540 U.S.A.
Phone (414) 354-0300
FAX (414) 354-7905
Email: sales@u-line.com
www.u-line.com

SERVICE ASSISTANCE:

Phone (800) 779-2547
FAX (414) 354-5696
Email: onlineservice@u-line.com
www.u-lineservice.com

PARTS ASSISTANCE:

E-mail: onlineparts@u-line.com

BUILDING ON THREE GENERATIONS OF INNOVATION

For nearly five decades and three generations, U-Line continues to be the leader in innovation, quality and value in the premium built-in undercounter ice making, refrigeration and wine preservation market. U-Line has captivated those with an appreciation for the finer things with exceptional functionality, style, inspired innovation and attention to even the smallest details. We are known and respected for our unwavering dedication to product design, quality and selection.

In 1962, Henry Uihlein founded U-Line Corporation as an outgrowth of Ben-Hur Freezer Company and was the first to develop and patent an automatic stand-alone undercounter residential ice maker. His foresight and determination to develop new ideas and to succeed when there were no clear guidelines or solutions are evident today. The newest Uihlein generation continues to build upon the family's innovative legacy at the Milwaukee, Wisconsin based business by providing continuity and vision from which new designs and technology continue to be born.

Today the complete U-Line product collection includes Ice Makers, Wine Captain® Models, Combo® Models, a Refrigerator / Freezer, Refrigerators, Drawers and Beverage Centers. The U-Line brand offers products in the 1000 Series, 2000 Series and the Modular 3000 Series. The 1000 Series offers a more targeted priced product with appropriate features, while the 2000 Series offers upscale features, advanced technology and specialized product families. U-Line's approach to its breadth of products, multiple price points and features allows a choice and product that will fit any lifestyle.

DESIGNED, ENGINEERED AND ASSEMBLED IN WISCONSIN, USA