

BIANCO MATT FRONT DOOR PANELS FOR 30” BUILT-IN BOTTOM MOUNT REFRIGERATOR



SP30BMBV



Italian Craftsmanship, Reimagined for the Modern Kitchen

Italy's legacy of artisan metalwork is revered across the globe—defined by exquisite precision, flawless finishes, and timeless elegance. Bertazzoni channels this heritage with unwavering dedication, infusing every product with the same meticulous craftsmanship and uncompromising standards. The result: appliances that transcend utility, becoming refined expressions of design and performance.

Bianco Matt Finish: Understated Luxury

The Bianco Matt Texture paint embodies quiet sophistication. Its velvety, matte surface offers a serene yet striking presence, elevating your kitchen with a refined aesthetic that complements both classic and contemporary interiors.

Defining Kitchen Confidence

Bertazzoni's signature powder coating technique is renowned for its durability and visual depth. This advanced process—ideal for creating rich, matte finishes—graces our Master Series with a texture that is as resilient as it is beautiful.

Engineered for Elegance and Endurance

Behind the beauty lies robust engineering. Our coating process uses pigmented powder composed of premium resins and materials, electrostatically applied and cured at extreme temperatures. As it melts, it forms a seamless "skin"—a hardened surface that resists stains, scratches, and wear far beyond conventional paint.

Harmonized Design: Bianco Matt Panels & Gold-Accented Handles

Complete your Bertazzoni suite with Bianco Matt panels paired with Master Stainless Steel handle kits, adorned with elegant gold finials. This curated combination brings visual unity and elevated style to your kitchen—spanning cooking, ventilation, refrigeration, and dishwashing solutions. It's a statement of taste, precision, and Italian artistry.

TECHNICAL SPECIFICATIONS

Packaging dimensions TBD

Gross weight TBD

COMPATIBLE MODELS

REF30BMBZPNV 30" built-in bottom mount refrigerator, reversible door

REF30BMBPNB 30" built-in bottom mount refrigerator, reversible door

ACCESSORIES

MASHK30PIXG Matching Master stainless steel with gold finials handle kit (sold separately)

BIANCO MATT FRONT DOOR PANELS FOR 30" BUILT-IN BOTTOM MOUNT REFRIGERATOR

SP30BMBV

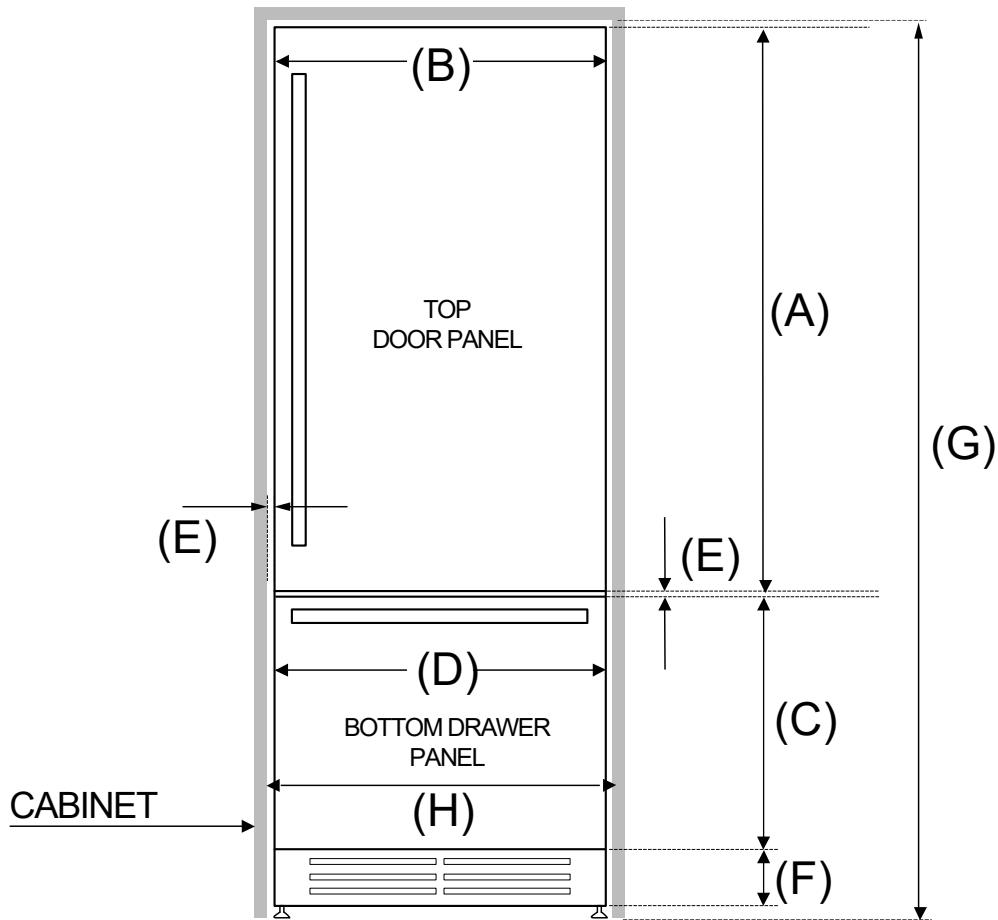

NOTE: For detailed instructions on the cabinet niche and/or installation, please refer to the product-specific installation manual.

DIMENSIONS - INCHES		
(A)	Height of top door panel	51 1/16" (1297)
(B)	Width of top door panel	29 3/4" (756)
(C)	Height of bottom drawer panel	28 11/16" (729)
(D)	Width of bottom drawer panel	29 3/4" (756)
(E)	Gap between door panels and cutout	1/8" (3)
(F)	Toe kick height	4" (101)
(G)	Cutout opening height	84" (2134)
(H)	Cutout opening width	30" (762)
Thickness of panels		3/4" (19)

WEIGHT - POUNDS	
Weight of top door panel	TBD
Weight of bottom drawer panel	TBD

Disclaimer: while every effort has been made to insure the accuracy of the information contained in this document, Fratelli Bertazzoni reserves the right to change any part of the information at any time without notice. For detailed installation specifications consult the installation manual. Fratelli Bertazzoni, Bertazzoni and the winged wheel brand icon are registered trademarks of Bertazzoni Spa.