

ELKAY[®]

SPECIFICATIONS

Undermount Single Bowl Sinks made with CuVerro[®] Antimicrobial Copper Models ELUH9-CU, ELUH12-CU, ELUH16-CU, ELUH12LV-CU and ELUH16LV-CU Lavatory with Overflows

GENERAL

Highest quality sink formed of #18 (1.2mm) gauge, CuVerro antimicrobial copper that combines beauty and performance. It represents the only class of solid surface material registered with the EPA for its inherent ability to kill infectious bacteria.* Undermount.

DESIGN FEATURES

Bowl Depths: See chart on next page.

Finish: Exposed surfaces are hand polished to a lustrous high-lighted satin finish.

Underside: Underside of sink is fully protected by heavy duty Sound Guard™ undercoating to reduce condensation and dampen sound.

Models ELUH12LV-CU and ELUH16LV-CU lavatory sinks include overflow assembly.

OTHER

Drain Opening: 1-1/2" (38mm).

Note: All Elkay undermount sinks are designed to affix to the underside of any solid surface countertop.

Sink complies with IGC-194.



These sinks are listed by the International Association of Plumbing and Mechanical Officials as meeting the requirements of the Uniform Plumbing Code.



All sinks 6" or less in depth are compliant to ADA and ANSI/ICC A117.1 accessibility requirements when installed according to the requirements outlined in these standards.

OPTIONAL ACCESSORIES

Drain: LK174-CU, LK174LO-CU

Mounting Clip: LKUCLIP8

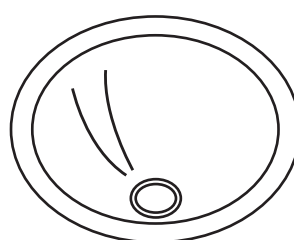

Model ELUH9-CU
Model ELUH12-CU
Model ELUH16-CU

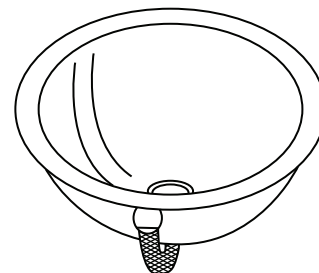

Model ELUH12LV-CU
Model ELUH16LV-CU



*Testing demonstrates effective antibacterial activity against Methicillin-Resistant Staphylococcus aureus, Staphylococcus aureus, Enterobacter aerogenes, Pseudomonas aeruginosa, and E. Coli O157:H7.

Purchaser is aware and informed that the Elkay sink being purchased is made up of a copper-nickel alloy. Some literature reports that some persons may have allergic reactions when exposed to nickel-containing substances. Purchaser should insure that reasonable precautions are taken in this regard. Elkay and purchaser agree that should a claim or litigation arise wherein a person is seeking damages due to an alleged allergic reaction to these substances, that purchaser will indemnify, defend and hold harmless Elkay for any damages and the costs of litigation for any such claim.

Installation Profile

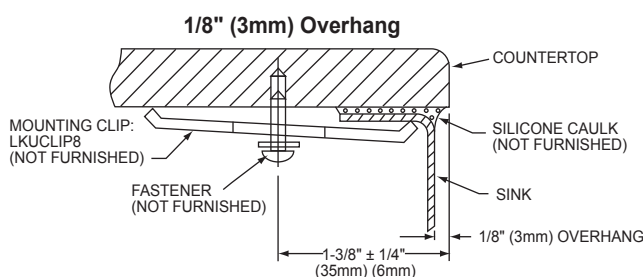
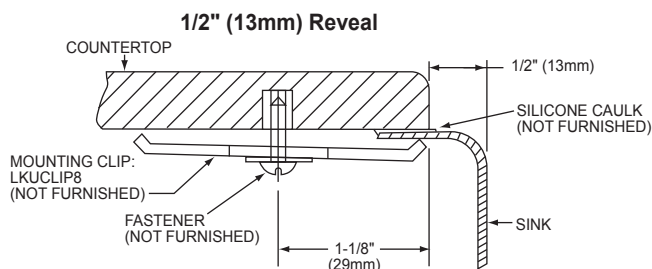

**TEMPLATE IS NOT INCLUDED. PLEASE VISIT ELKAYUSA.COM FOR SINK TEMPLATE.
MAKE SURE THE TEMPLATE YOU CHOOSE WILL GIVE YOU THE DESIRED INSTALLATION LOOK.
ELKAY'S TEMPLATES PROVIDE A 1/2" (13mm) REVEAL OF THE SINK FLANGE.**

SEE OTHER SIDE FOR PRODUCT DIMENSIONS.

In keeping with our policy of continuing product improvement, Elkay reserves the right to change product specifications without notice. Please visit elkayusa.com for the most current version of Elkay product specification sheets.

This specification describes an Elkay product with design, quality and functional benefits to the user. When making a comparison of other producers' offerings, be certain these features are not overlooked.

Undermount Single Bowl Sinks
made with CuVerro® Antimicrobial Copper
Models ELUH9-CU, ELUH12-CU, ELUH16-CU,
ELUH12LV-CU and ELUH16LV-CU Lavatory with Overflows

ELKAY®
SPECIFICATIONS

SINK DIMENSIONS

Model Number	Outside Diameter	Inside Diameter	Depth	Drain Opening	Outout in Countertop	Minimum Cabinet Size	Includes Overflow Assembly
	A	B	C				
ELUH9-CU	11 ³ / ₈ (289mm)	9 (229mm)	4 ³ / ₄ (121mm)	1 ¹ / ₂ (38mm)	See Template*	15 (381mm)	No
ELUH12-CU	14 ³ / ₈ (365mm)	12 (305mm)	6 (152mm)	1 ¹ / ₂ (38mm)		18 (457mm)	No
ELUH12LV-CU	14 ³ / ₈ (289mm)	12 (305mm)	6 (152mm)	1 ¹ / ₂ (38mm)		18 (457mm)	Yes
ELUH16-CU	18 ³ / ₈ (467mm)	16 (406mm)	8 (203mm)	1 ¹ / ₂ (38mm)		24 (610mm)	No
ELUH16LV-CU	18 ³ / ₈ (467mm)	16 (406mm)	8 (203mm)	1 ¹ / ₂ (38mm)		24 (610mm)	Yes

*Visit elkayusa.com for sink template.

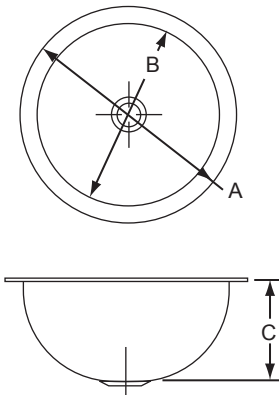

Model ELUH9-CU Illustrated
 Model ELUH12-CU Illustrated
 Model ELUH16-CU Illustrated

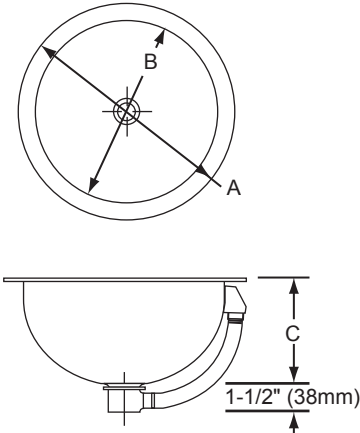

Model ELUH12LV-CU Illustrated
 Model ELUH16LV-CU Illustrated