

ELKAY[®]

SPECIFICATIONS

Gourmet Sink with Perfect Drain[™] Models LR and LRS Series

GENERAL

Highest quality sink formed of #18 (1.2mm) gauge, type 304 (18-8) nickel bearing stainless steel with **Perfect Drain**. Top mount.

DESIGN FEATURES

Bowl Depth: See Chart on next page.

Coved Corners: 1-3/4" (44mm) vertical and horizontal radius.

Rim Height: 5/32" (4mm), or 3/8" (10mm) (LRS3322PD only)

Finish: Exposed surfaces are hand polished to a Lustrous Highlighted Satin finish.

Underside: Fully undercoated to dampen sound and reduce condensation. LR2521PD is fully protected by heavy duty Sound Guard[®] undercoating.

Perfect Drain: Seamlessly welded stainless steel collar eliminates the gap between a traditional drain and the sink for a sanitary and gap free installation. Each sink shipped with one LKPD1 drain kit, or a garbage disposer can be installed on sink bowl for user convenience.

Patent Pending

OTHER

Drain opening: 3-3/8" (86mm)

Waste Fitting complies with ASME A112.18.2/CAN/CSA-B125.2

Sink complies with ASME A112.19.3-2008 / CSA B45.4-08.



These sinks are listed by the International Association of Plumbing and Mechanical Officials as meeting the requirements of the Uniform Plumbing Code and the National Plumbing Code of Canada.

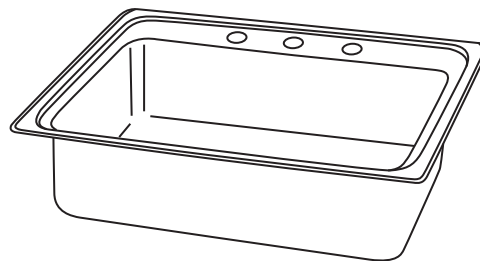

Model LR2219PD3



Installation Profile

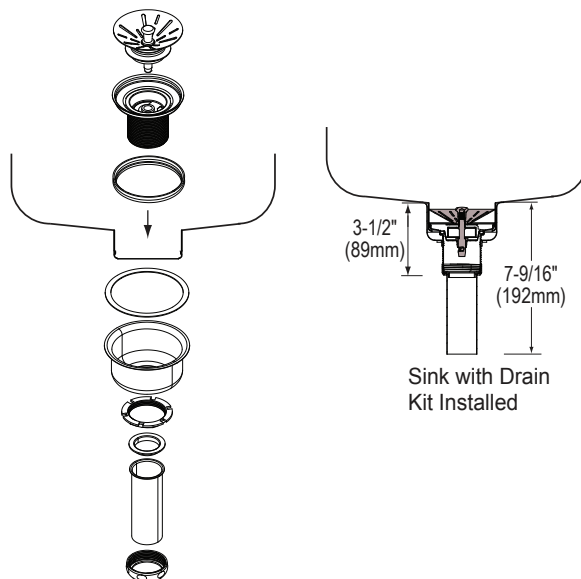
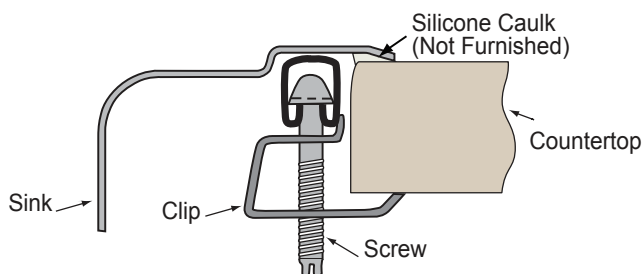

In keeping with our policy of continuing product improvement, Elkay reserves the right to change product specifications without notice. Please visit elkayusa.com for most current version of Elkay product specification sheets.

This specification describes an Elkay product with design, quality and functional benefits to the user. When making a comparison of other producers' offerings, be certain these features are not overlooked.

Elkay

elkayusa.com

2222 Camden Court
Oak Brook, IL 60523

Printed in U.S.A.
©2011 Elkay

(Rev. 7/11)

1-397

ELKAY[®]

SPECIFICATIONS

Gourmet Sink with Perfect Drain™ Models LR and LRS Series

SINK DIMENSIONS*

Model Number	Overall			Inside Bowl			Cutout in Countertop [1 1/2" (38mm) Radius Corners]		No. of 1 1/2" (38mm) Dia. Faucet Holes 4" (102mm) Center	Minimum Cabinet Size
	L	W	D	L	W	D	L	W		
	A	B	C	D	E	F	L	W		
LR1722PD	17 (432mm)	22 (559mm)	9 1/8 (232mm)	13 1/2 (343mm)	16 (406mm)	7 5/8 (194mm)	16 3/8 (422mm)	21 3/8 (543mm)	1, 2, MR2, 3, or OS4	21 (533mm)
LR1919PD	19 1/2 (495mm)	19 (483mm)	9 (229mm)	16 (406mm)	13 1/2 (343mm)	7 1/2 (190mm)	18 7/8 (479mm)	18 3/8 (467mm)	1, 2, MR2, 3, or OS4	24 (610mm)
LR2219PD	22 (559mm)	19 1/2 (495mm)	9 1/8 (232mm)	18 (457mm)	14 (356mm)	7 5/8 (194mm)	21 3/8 (543mm)	18 7/8 (479mm)	1, 2, MR2, 3, 4 or 5	27 (686mm)
LR2521PD	25 (635mm)	21 1/4 (540mm)	9 1/2 (241mm)	21 (533mm)	15 3/4 (400mm)	8 (203mm)	24 3/8 (619mm)	20 5/8 (524mm)	1, 2, MR2, 3, 4 or 5	30 (762mm)
LR3122PD	31 (787mm)	22 (559mm)	9 1/8 (232mm)	28 (711mm)	16 (406mm)	7 5/8 (194mm)	30 3/8 (772mm)	21 3/8 (543mm)	1, 2, MR2, 3, 4 or 5	36 (914mm)
LRS3322PD	33 (838mm)	22 (559mm)	9 1/8 (232mm)	28 (711mm)	16 (406mm)	7 5/8 (194mm)	32 3/8 (822mm)	21 3/8 (543mm)	1, 2, MR2, 3, 4 or 5	36 (914mm)

*Length is left to right. Width is front to back.

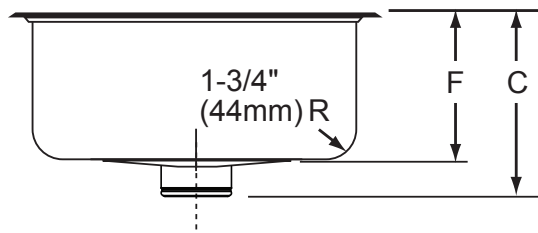
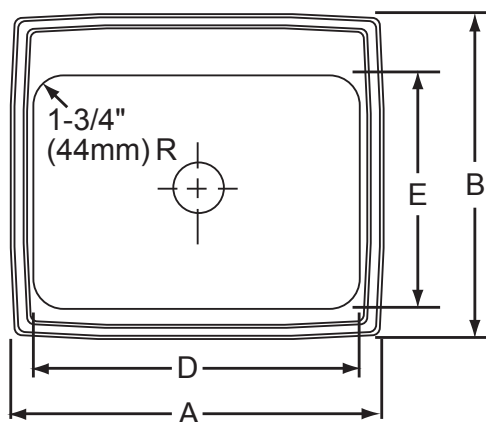

Hole Drilling Configurations 1-1/2" (38mm) Diameter Faucet Holes on 4" (102mm) Centers

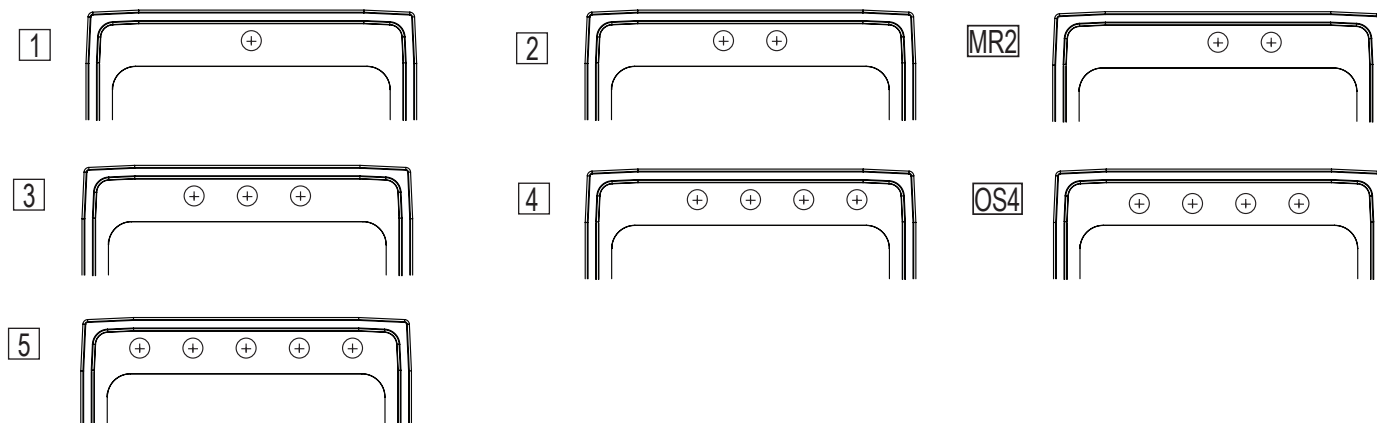

In keeping with our policy of continuing product improvement, Elkay reserves the right to change product specifications without notice. Please visit elkayusa.com for most current version of Elkay product specification sheets.

This specification describes an Elkay product with design, quality and functional benefits to the user. When making a comparison of other producers' offerings, be certain these features are not overlooked.